

0.76/28

★ BM # BY2-209 EL 77.219
27.170m RT -SRD-1- STA 12+65.870



PROJECT REFERENCE NO. R-255244 SHEET NO. 43

ROADWAY DESIGN ENGINEER

HYDRAULICS ENGINEER

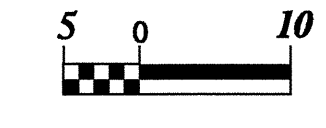

CONST. REV.

R/W REV.

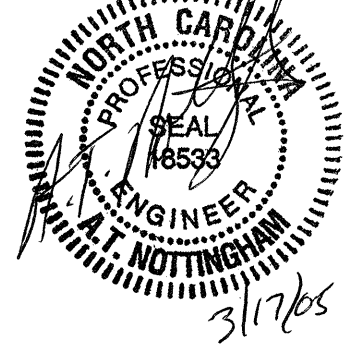

-SRD-1-

PI = 12+25.000
EL = 78.753 m
VC = 50 m
K = 10

PI = 11+10.000
EL = 75.371 m
VC = 75 m
K = 14

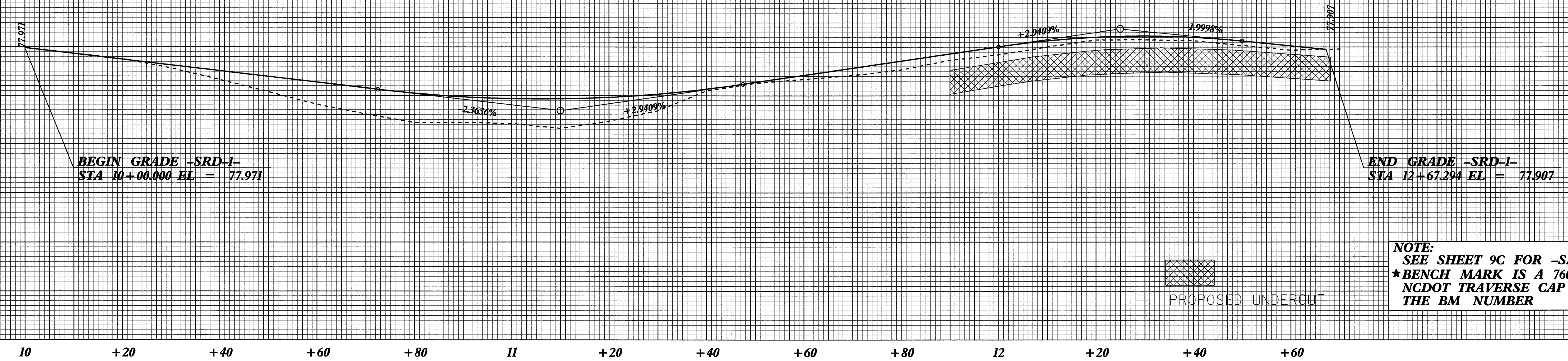

NOTE:
SEE SHEET 9C FOR -SRD-1- ALIGNMENT
★ BENCH MARK IS A 760mm REBAR WITH
NCDOT TRAVERSE CAP STAMPED WITH
THE BM NUMBER

PROPOSED UNDERCUT

26- JAN-2005 10:04
EM Harrison AT 10282888