

ENVIRONMENTALLY SENSITIVE AREAS APPLIED TO BUFFER ZONES 1 AND 2 USE PROJECT SPECIAL PROGRAMS

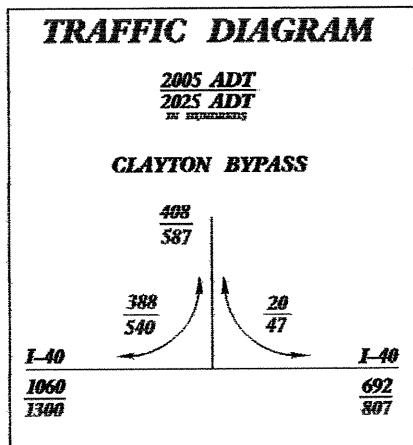

PROJECT REFERENCE NO. R-2552-14	SHEET NO. 20/118
R/W SHEET NO. R/W 118	HYDRAULIC ENGINEER
ROADWAY DESIGN ENGINEER	HYDRAULIC ENGINEER
CONSTR. REV.	R/W REV.

NOTE: PLACE TEMPORARY ROCK BARRIER DRAIN TYPE 2 AND TEMPORARY ROCK SET CHECKS TYPE 4 AT DRAINAGE OUTLETS.

CLEANING AND GULCHING REGION CORNER FOR CONSTRUCTION SHEET 14

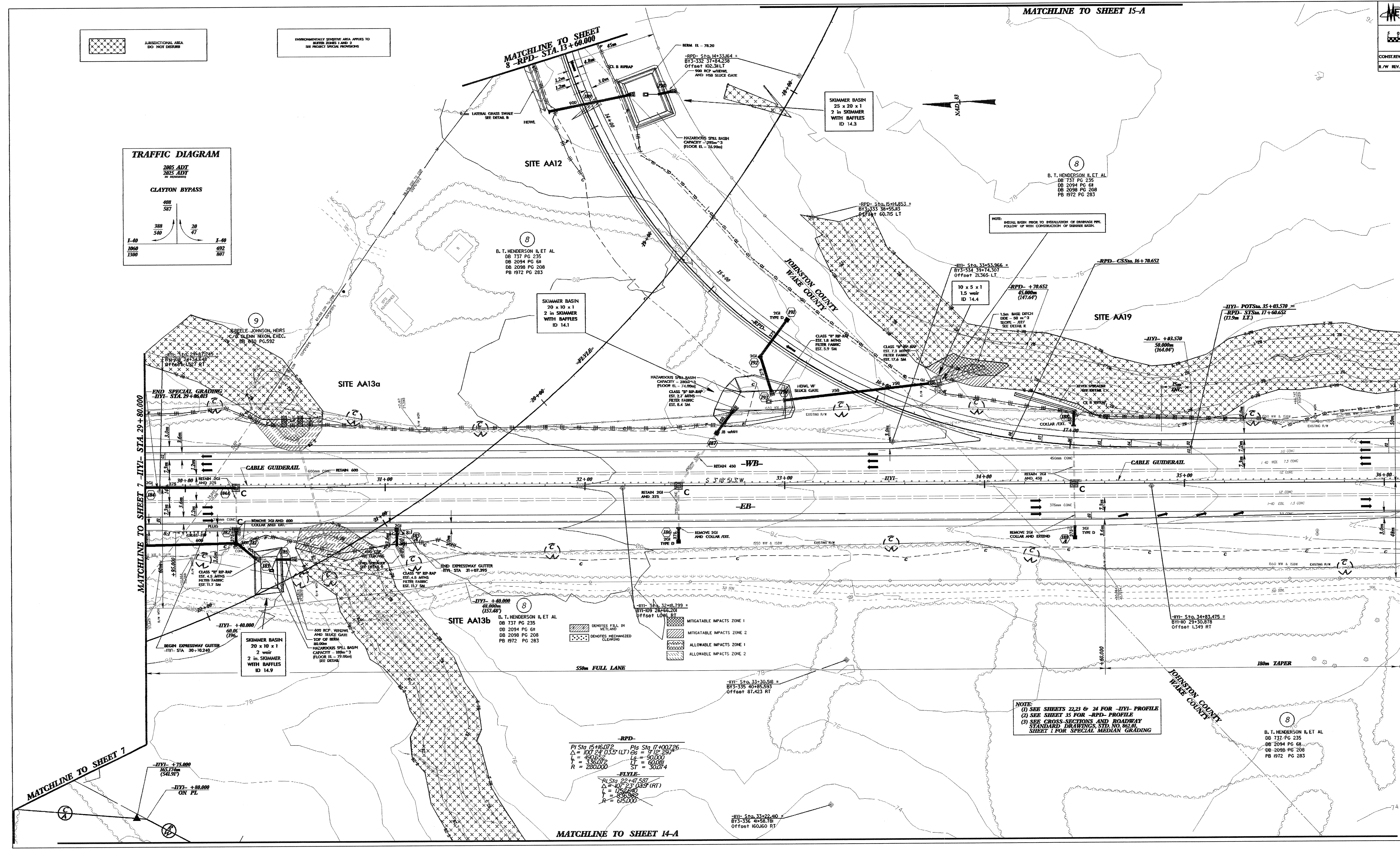

MATCHLINE TO SHEET 7 - JIVL - STA. 29+80.000

MATCHLINE TO SHEET 15 - JIVL - STA. 36+10.000

MATCHLINE TO SHEET 7

MATCHLINE TO SHEET 14-A

NOTE:
(1) SEE SHEETS 223 & 24 FOR JIVL PROFILE
(2) SEE SHEET 15 FROM -RPD- PROFILE
(3) SEE CROSS SECTIONS AND ROADWAY STANDARD DRAWINGS STD. NO. 96.01 SHEET 1 FOR SPECIAL MEDIAN GRADING

RPD
 PLS STA 15+60.72 PLS STA 17+00.726
 $\Delta = 100.21$ (LT) $E = 50.000$
 $L = 450.57$ $LT = 600.81$
 $R = 2260.00$ $ST = 31.074$

JIVL
 PLS STA 22+47.587
 $\Delta = 40.23$ (RT) $E = 17.626$
 $L = 200.00$ $LT = 600.00$
 $R = 605.000$

LOCATION:	COUNTY:
DATE:	DATE:
DESIGNED BY:	DATE:
CHECKED BY:	DATE: