

PROJECT REFERENCE NO. E-255241	SHEET NO. E2-30000274
R/W SHEET NO. B, J, L, H	HYDRAULICS ENGINEER
ROADWAY DESIGN ENGINEER	
CONST. REV.	
R/W REV.	

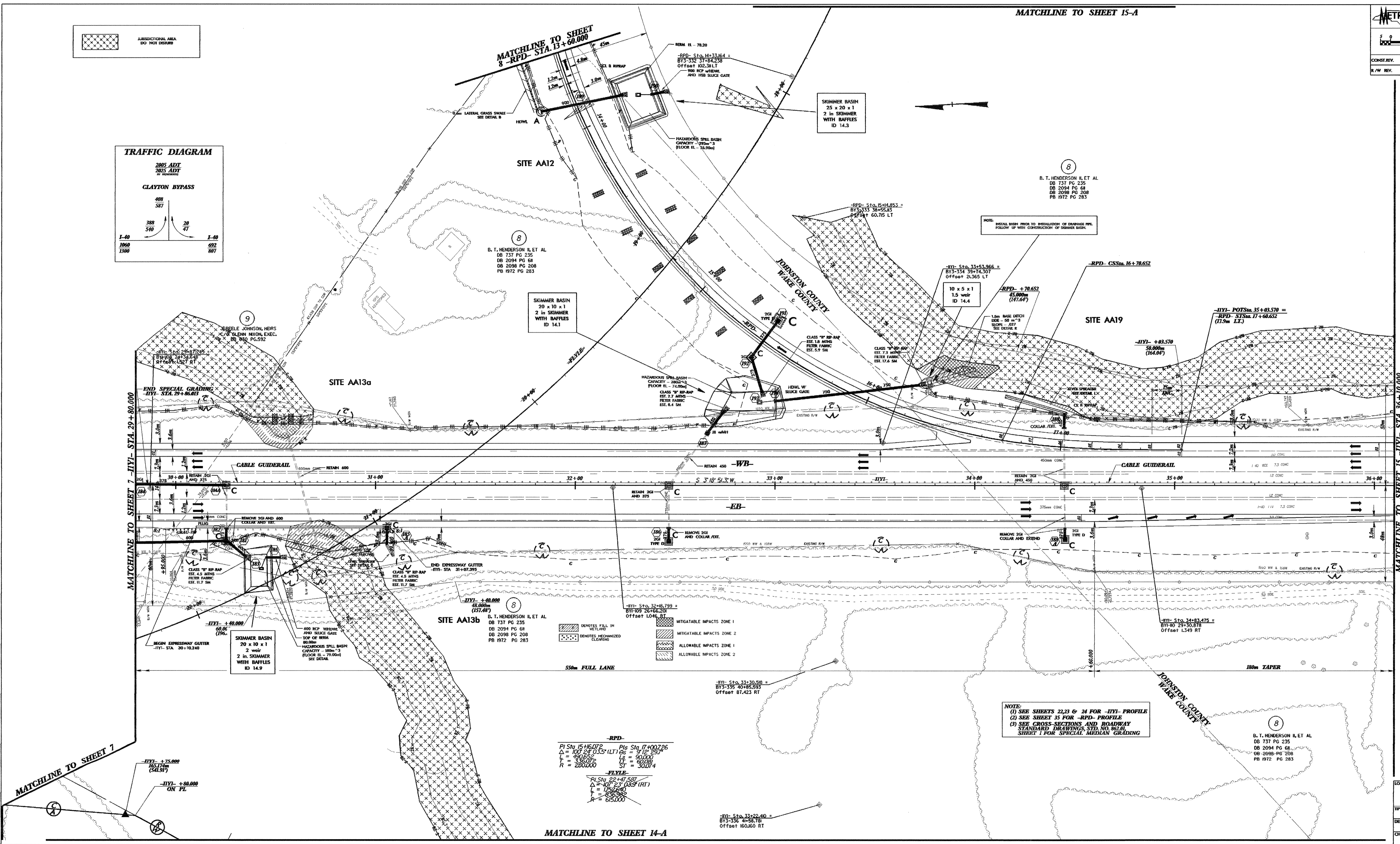

NOTE:
 (1) SEE SHEETS 2123 & 24 FOR JTY PROFILE
 (2) SEE SHEET 35 FOR RPD PROFILE
 (3) SEE CROSS SECTIONS AND ROADWAY STANDARD DRAWINGS, STD NO. 902.01, SHEET 1 FOR SPECIAL MEDIAN GRADING

RPD
 PI Sta 15+16.072 Piv Sta 17+007.26
 $\Delta = 107.27$ (3.5° LT) $L = 91.6$ 291'
 $T = 49.67$ $L = 50.000$
 $R = 280.000$ $ST = 30.074$

FLYLE
 PI Sta 22+47.591
 $\Delta = 107.27$ (3.5° RT) $L = 91.6$ 291'
 $T = 49.67$ $L = 50.000$
 $R = 280.000$

MATCHLINE TO SHEET 15 - JTY - STA. 36+10.000

MATCHLINE TO SHEET 7

MATCHLINE TO SHEET 14-A

MATCHLINE TO SHEET 15-A

LOCATION:	
RP NO.:	COUNTY:
DESIGNED BY:	DATE:
CHECKED BY:	DATE: