

8/17/99

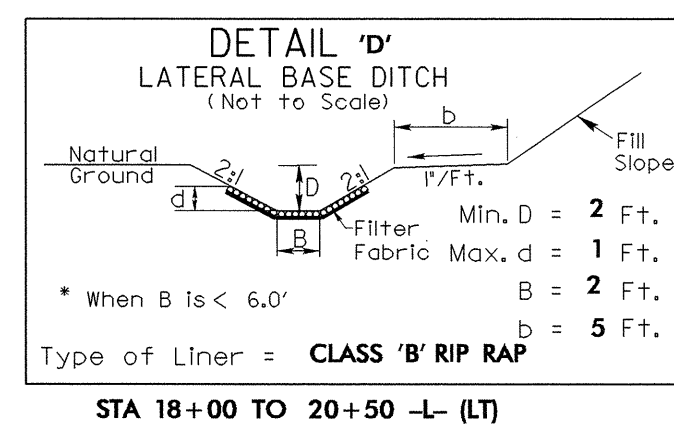

-L-
 PI Sta 19+64.99
 $\Delta = 0^\circ 54' 36.4''$ (LT)
 $D = 0^\circ 42' 58.3''$
 $L = 127.08'$
 $T = 63.54'$
 $R = 8,000.00'$
 $SE = NC$

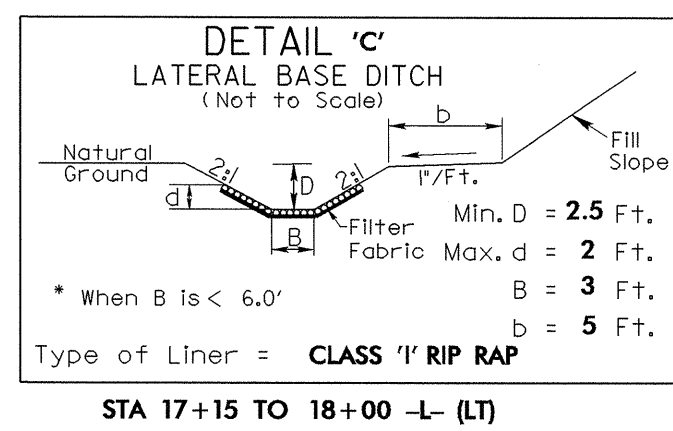
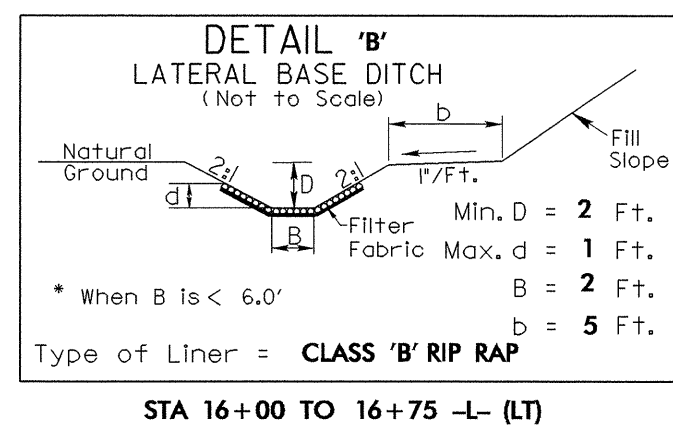
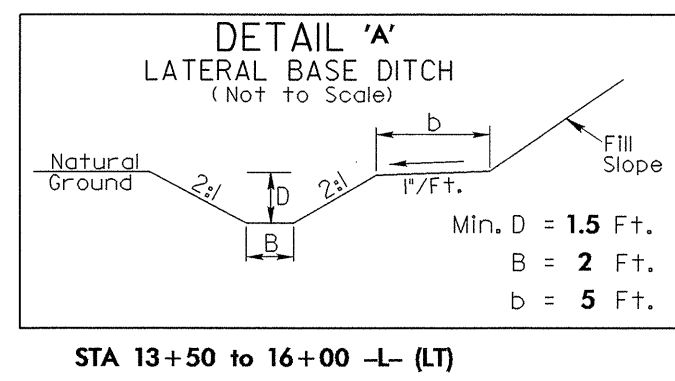
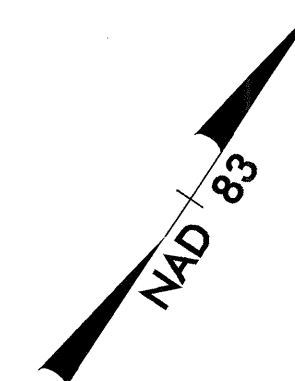

PROJECT REFERENCE NO. B-3700	SHEET NO. 4
RW SHEET NO.	
ROADWAY DESIGN ENGINEER <i>[Signature]</i>	HYDRAULICS ENGINEER <i>[Signature]</i>

STA. 13+05.00 -L- BEGIN STATE PROJECT B-3700

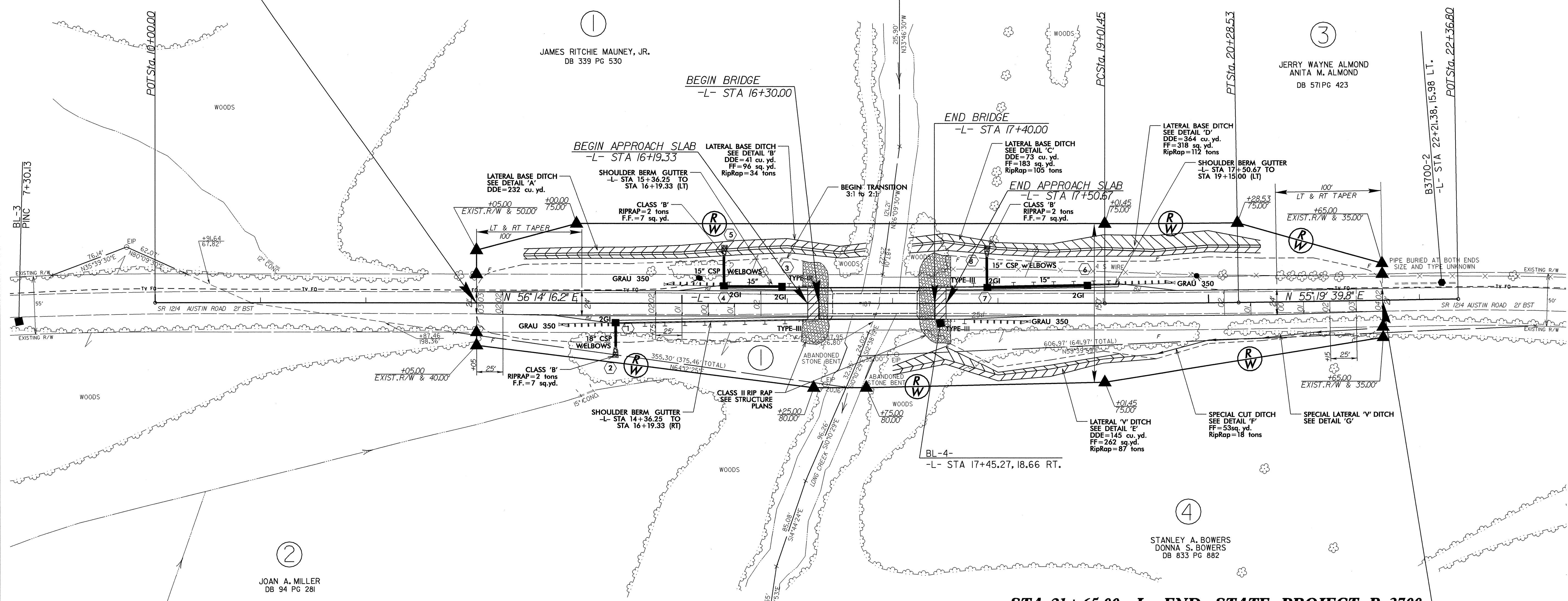

STA. 21+65.00 -L- END STATE PROJECT B-3700

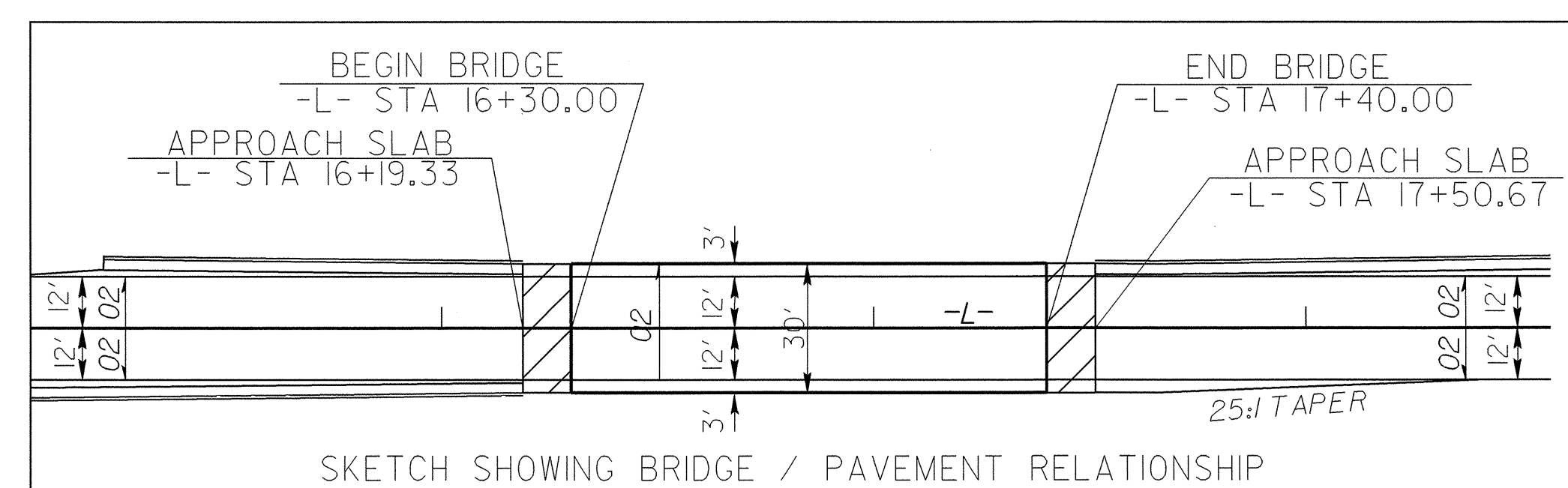
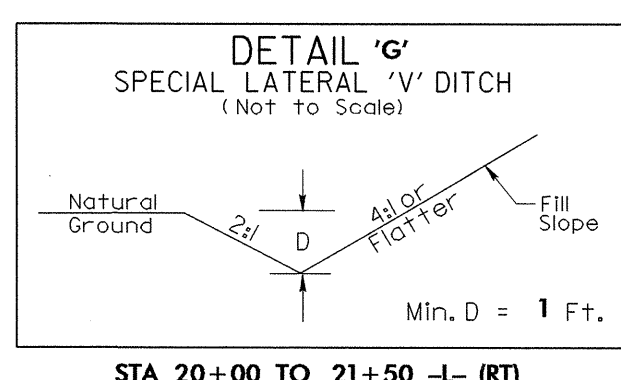
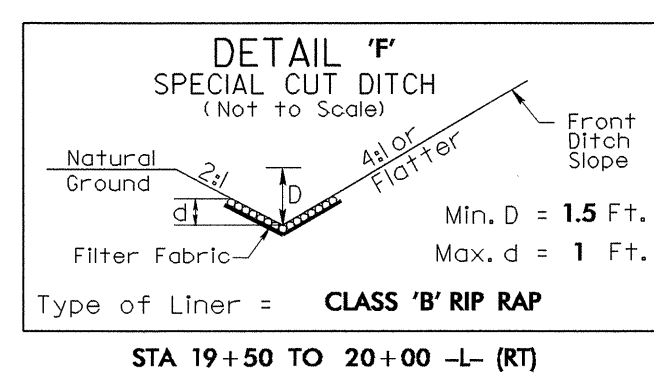
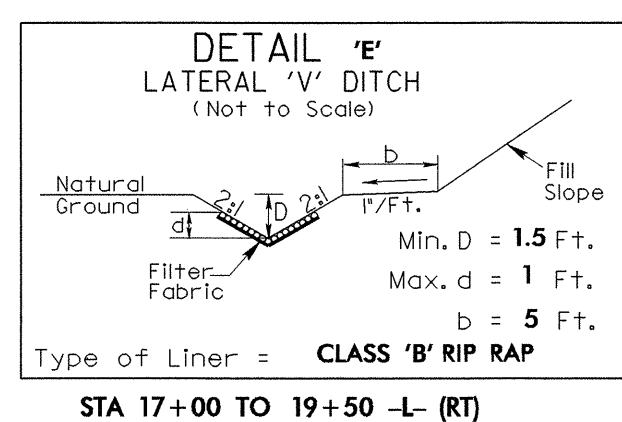

BRIDGE APPROACH SLAB

FOR -L- PROFILE SEE SHEET 5
 FOR STRUCTURE PLANS SEE SHEETS S1 - S

31-MAR-2005 10:31
 P:\11\1103\dwg\11\PROJ\B3700.psh
 RE: 3/1/01

REVISIONS