

**TIP PROJECT: B-3700**

**CONTRACT: C201324**

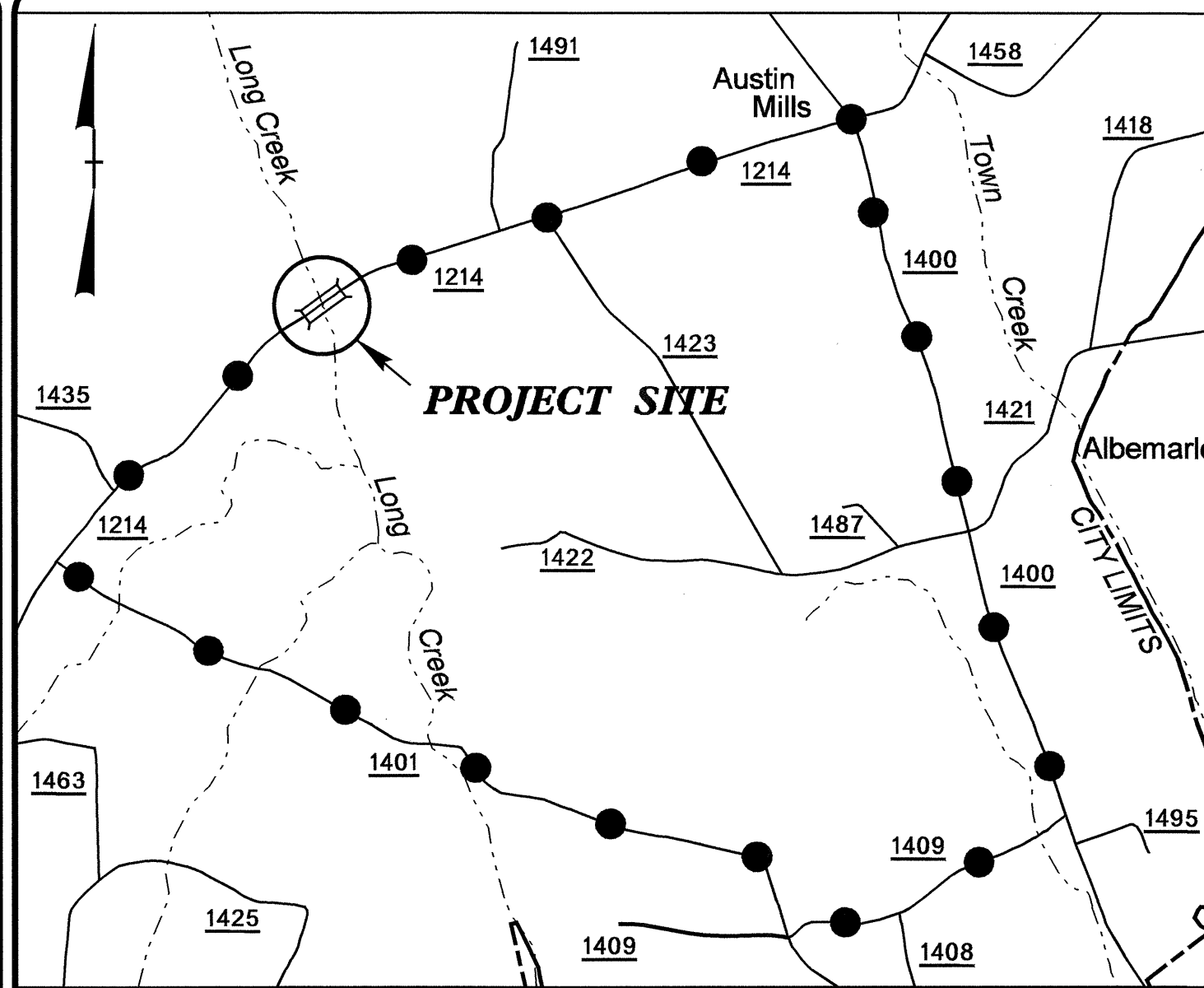

**VICINITY MAP**

**STRUCTURE**

STATE OF NORTH CAROLINA  
DIVISION OF HIGHWAYS

**STANLY COUNTY**

**LOCATION: BRIDGE NO.187 OVER LONG CREEK ON SR 1214 (AUSTIN RD)**

**TYPE OF WORK: GRADING, PAVING, DRAINAGE AND STRUCTURE**

STATE	STATE PROJECT REFERENCE NO.	SHEET NO.	TOTAL SHEETS
N.C.	B-3700	1	
STATE PROJ. NO.	P.A. PROJ. NO.	DESCRIPTION	
33240.1.1	BRZ-1214(3)	PE	
33240.2.2	BRZ-1214(3)	UTIL, RW	
33240.3.1	BRZ-1214(3)	CONST.	

**STA. 13+05.00 -L- BEGIN TIP PROJECT B-3700**

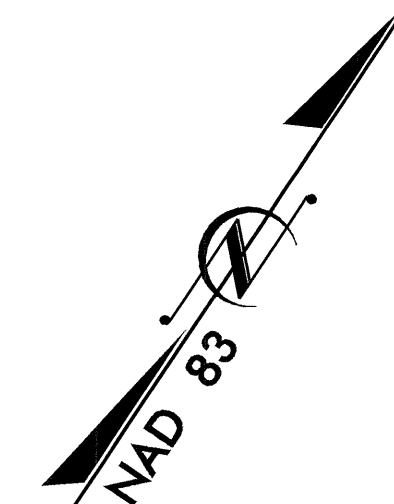
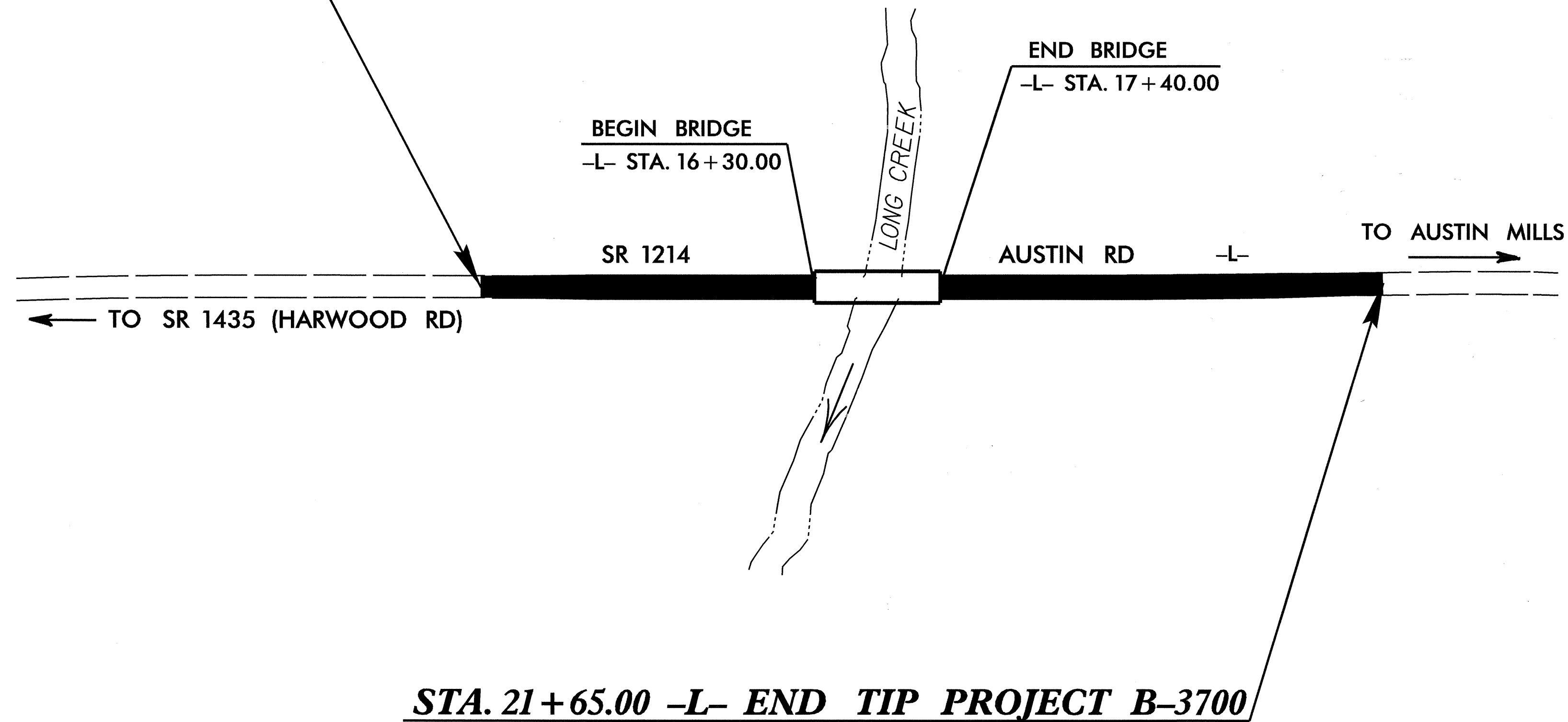

**DESIGN DATA**

ADT 2005 = 2170  
 ADT 2025 = 3400  
 DHV = 11 %  
 D = 60 %  
 T = 4 % \*  
 V = 50 MPH  
 \* TTST 1 % + DUAL 3 %

**PROJECT LENGTH**

LENGTH ROADWAY TIP PROJECT B-3700 = 0.142 MI  
 LENGTH STRUCTURE TIP PROJECT B-3700 = 0.021 MI  
 TOTAL LENGTH TIP PROJECT B-3700 = 0.163 MI

Prepared In the Office of:  
**DIVISION OF HIGHWAYS**  
 1000 Birch Ridge Dr., Raleigh NC, 27610

2002 STANDARD SPECIFICATIONS

**JOHN C. FRYE, PE**  
 PROJECT ENGINEER

**W.A. DAVIS, PE**  
 PROJECT DESIGN ENGINEER

**B.C. HANKS, PE**  
 PROJECT DESIGN ENGINEER

LETTING DATE:  
 MAY 17, 2005

**STRUCTURE DESIGN UNIT**  
 1000 Birch Ridge Dr.,  
 Raleigh NC, 27610

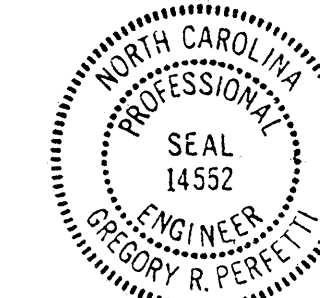

*Gregory R. Perretti*  
 4.4.05

**DIVISION OF HIGHWAYS**  
 STATE OF NORTH CAROLINA

P.E.  
 STATE DESIGN ENGINEER  
**DEPARTMENT OF TRANSPORTATION**  
 FEDERAL HIGHWAY ADMINISTRATION

APPROVED  
 DIVISION ADMINISTRATOR DATE