

CONTRACT: C201457 TIP PROJECT: R-2539C

STATE OF NORTH CAROLINA
DIVISION OF HIGHWAYS

PAMLICO COUNTY

See Sheet 1-A For Index of Sheets
See Sheet 1-B For Conventional Symbols

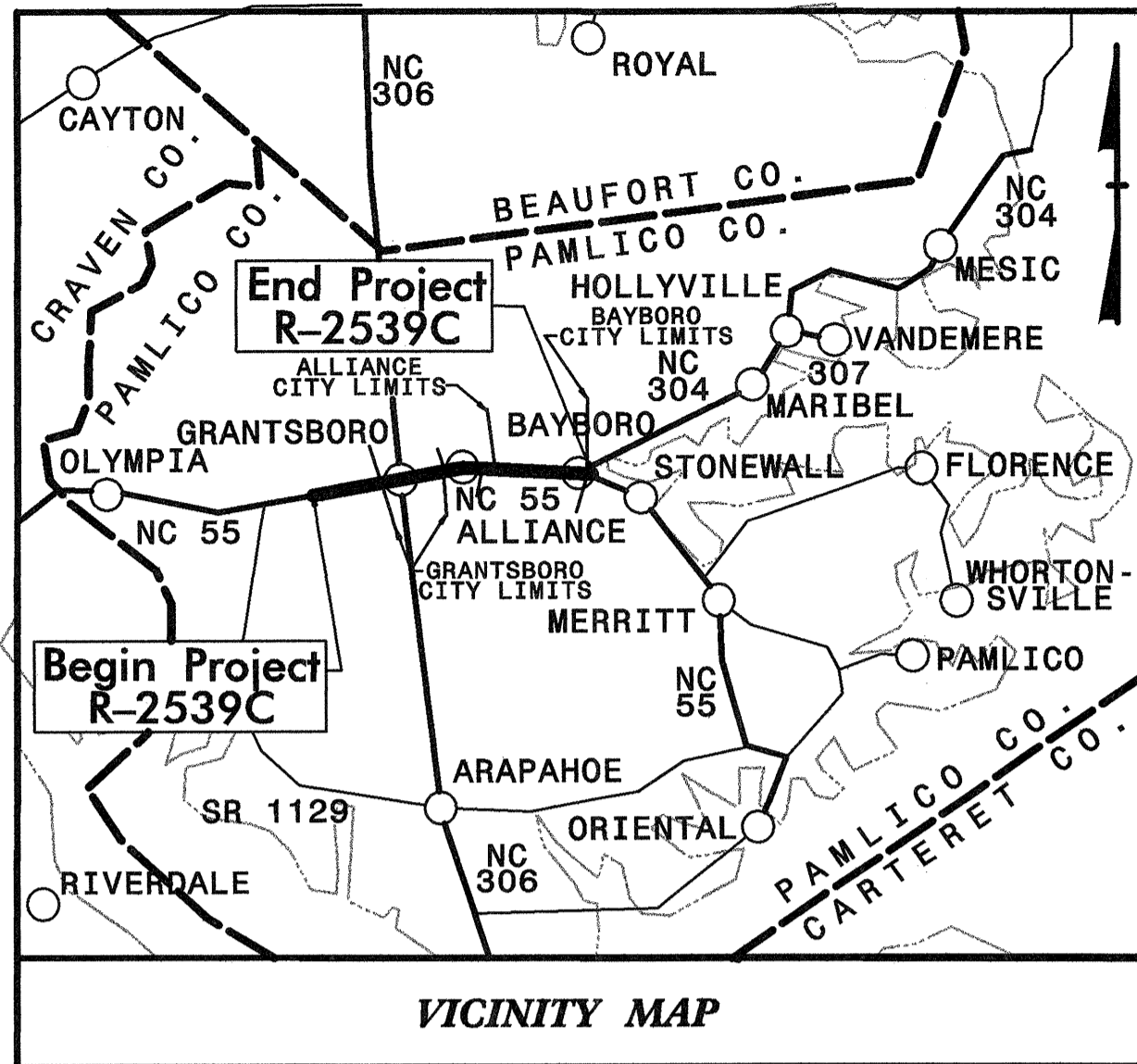

LOCATION: NC 55 FROM EAST OF SR 1129 (BENNETT-TINGLE ROAD) TO NC 304 IN BAYBORO

TYPE OF WORK: GRADING, DRAINAGE, PAVING, CURB & GUTTER, CULVERTS, SIGNALS, & SIGNING

STATE	STATE PROJECT REFERENCE NO.	SHEET NO.	TOTAL SHEETS
N.C.	R-2539C	1	
STATE PROJ. NO.	F.A. PROJ. NO.	DESCRIPTION	
34452.1.1	STP-55(1)	PE	
34452.2.4	STP-55(31)	RW, UTIL.	
34452.3.7	STP-55(33)	CONST.	

ALL DIMENSIONS IN THESE PLANS ARE IN METERS AND/OR MILLIMETERS UNLESS OTHERWISE SHOWN

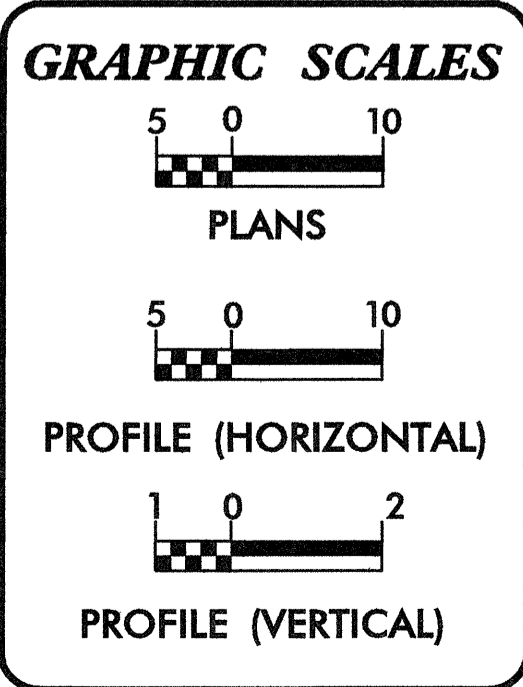
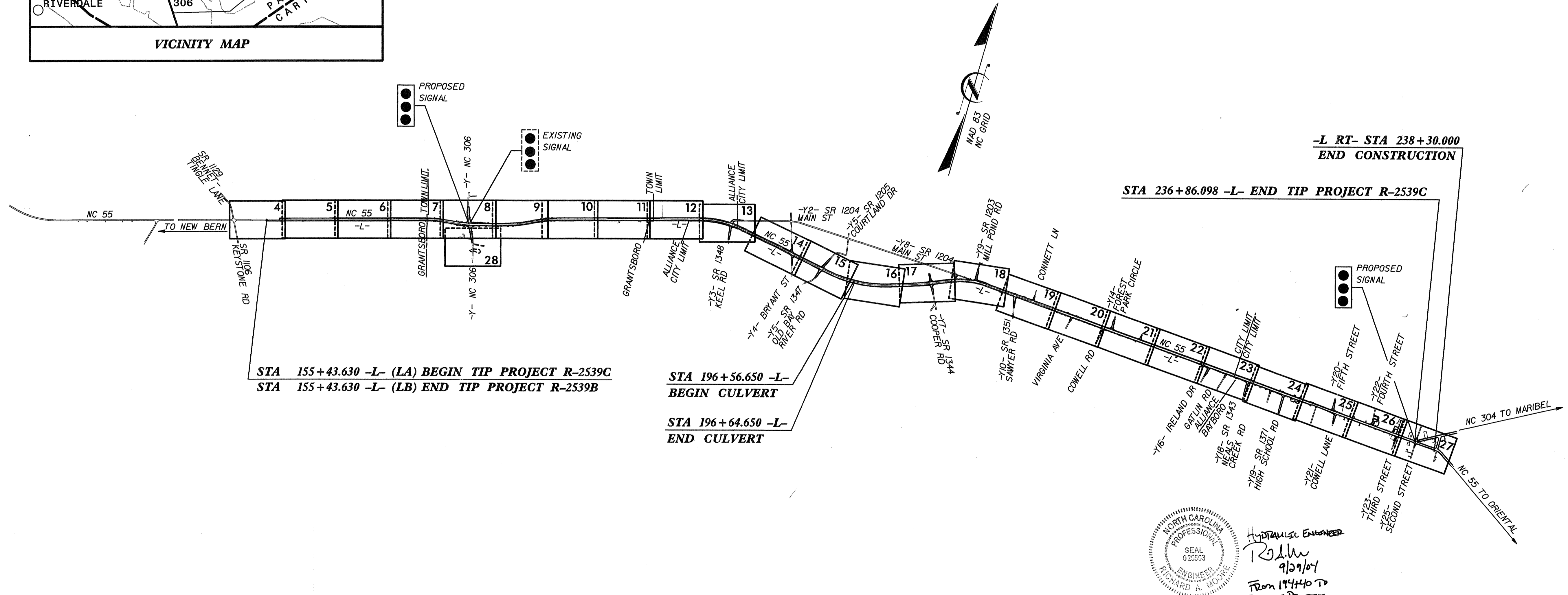

DESIGN DATA

ADT (2005) = 8,100-15,200
ADT (2025) = 12,800-24,100

DHV = 12%
D = 60% / 63%
T = 7% *

V = 100 km/h (SHOULDER SECTION)
V = 80 km/h (CURB & GUTTER SECTION)
* (TTST 2%+ DUAL 5%)

PROJECT LENGTH

LENGTH ROADWAY TIP PROJECT R-2539C = 8.134 Km
LENGTH OF STRUCTURES TIP PROJECT R-2539C = 0.008 Km
TOTAL LENGTH OF TIP PROJECT R-2539C = 8.142 Km

Prepared In the Office of:
GREENHORNE & O'MARA, INC.
5565 CENTERVIEW DRIVE, SUITE 107
RALEIGH, NORTH CAROLINA 27606
(919) 851-1919

FOR THE NORTH CAROLINA DEPARTMENT OF TRANSPORTATION

2002 STANDARD SPECIFICATIONS

RIGHT OF WAY DATE:
JULY 31, 2003

LETTING DATE:
MAY 17, 2005

NC DOT CONTACT: **TERESA BRUTON, P.E.**
PROJECT ENGINEER - PROJECT SERVICES

HYDRAULICS ENGINEER

ROADWAY DESIGN ENGINEER

Professional seals and signatures for the Hydraulics Engineer and Roadway Design Engineer.

**DIVISION OF HIGHWAYS
STATE OF NORTH CAROLINA**

Professional seal and signature of the State Design Engineer.

DEPARTMENT OF TRANSPORTATION
FEDERAL HIGHWAY ADMINISTRATION

APPROVED DIVISION ADMINISTRATOR