

REVISIONS

GREENHORNE & O'MARA, INC.
 5565 CENTERVIEW DRIVE, SUITE 107
 RALEIGH, NORTH CAROLINA 27606
 (919) 851-1919

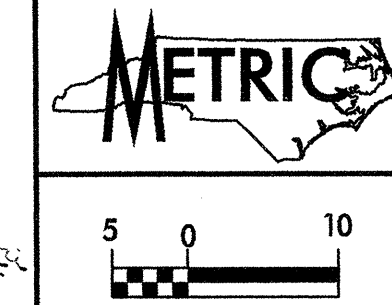

PROJECT REFERENCE NO. R-2539C	SHEET NO. 7
R/W SHEET NO.	
ROADWAY DESIGN ENGINEER	HYDRAULICS ENGINEER
PRELIMINARY PLANS DO NOT USE FOR CONSTRUCTION INCOMPLETE PLANS DO NOT USE FOR R/W ACQUISITION	
CONST. REV.	
R/W REV.	

MYRON M. BANKS, JR., et ux
 DB 213 - PG 857
 MB 11 - PG 93

ARFEGUS JOYNER, SR., et ux
 DB 222 - PG 617

LAWRENCE GARY NORMAN, et ux
 MB 12 - PG 65
 DB 216 - PG 316

UNKNOWN

JEANNETTE BANKS HUDSON, et vir
 DB 213 - PG 853
 MB 11 - PG 93

BL-5
 PINC 12+68.490

BL-6
 PINC 14+69.787

SEE SHEET NO. 6
 MATCHLINE -L- STA. 163 + 80.000

SEE SHEET NO. 8
 MATCHLINE -L- STA. 166 + 40.000

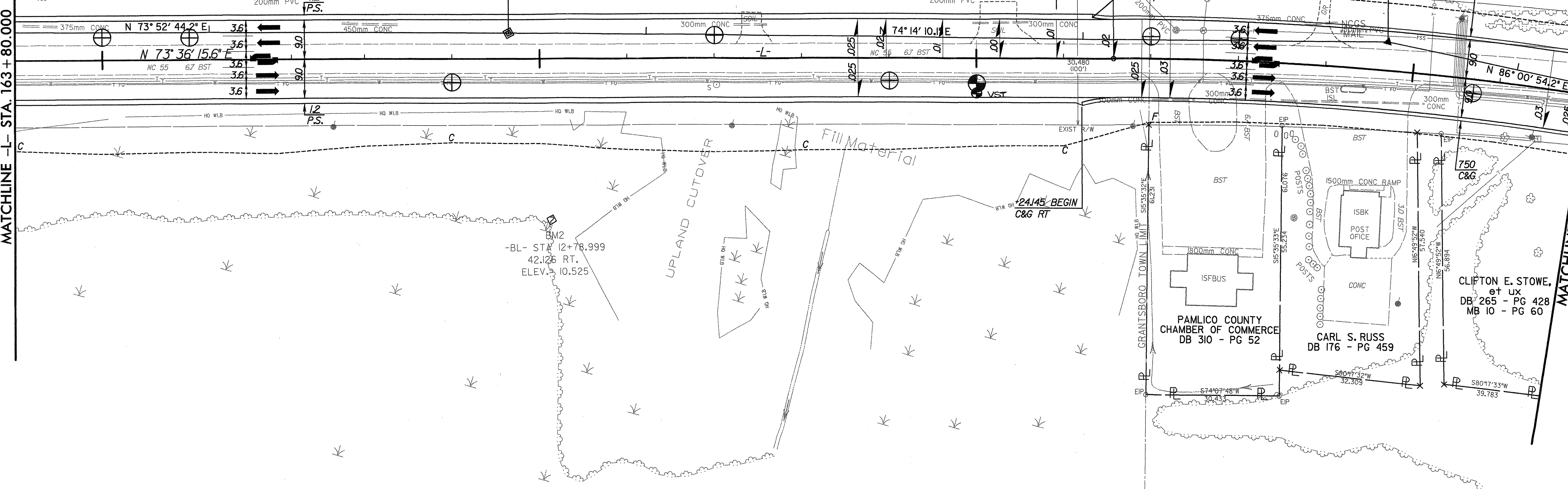

-BL- STA 12+78.999
 42.125 RT.
 ELEV. 10.525

PAMLICO COUNTY
 CHAMBER OF COMMERCE
 DB 310 - PG 52

CARL S. RUSS
 DB 176 - PG 459

CLIFTON E. STOWE,
 et ux
 DB 265 - PG 428
 MB 10 - PG 60

-L-
 PI Sta 166+87.935
 $\Delta = 9^{\circ} 30' 05.5''$ (RT)
 L = 112.766
 T = 56.513
 R = 680.000
 S.E. = .03
 R'OFF = 39.0

SARAH ALICE HARRIS
 DB 209 - PG 146

SEE SHEET NO. 26 FOR -L-
 PROFILE