

BM#10 EL. 3.424
RR SPIKE BST PARKING LOT
110.246m RT -L STA. 225+33.645

GREENHORNE & O'MARA, INC.
5565 CENTERVIEW DRIVE, SUITE 107
RALEIGH, NORTH CAROLINA 27606
(919) 851-1919



PROJECT REFERENCE NO.
R-2539C
ROADWAY DESIGN ENGINEER

SHEET NO.
39
HYDRAULICS ENGINEER

PRELIMINARY PLANS
DO NOT USE FOR CONSTRUCTION
INCOMPLETE PLANS
DO NOT USE FOR R/W ACQUISITION

Soil Sample Test Results

| SAMPLE NO. | STATION | OFFSET | DEPTH INTERVAL | CLASS. | L.L. | P.I. | % BY WEIGHT | | | | % PASSING (SIEVES) | | MOISTURE | ORGANIC |
|------------|---------|---------|----------------|----------|------|------|-------------|-------|------|------|--------------------|------|----------|---------|
| | | | | | | | CSAND | FSAND | SILT | CLAY | 2.0mm | 75um | | |
| SS-59 | 226+00 | 7.5m LT | 0.30-0.45 | A-2-4(0) | 17 | NP | 5.2 | 71.4 | 11.4 | 12.1 | 99 | 98 | 27 | |
| SS-60 | 226+00 | 7.5m LT | 2.25-2.70 | A-2-4(0) | 21 | NP | 2.5 | 59.9 | 3.5 | 12.1 | 100 | 83 | 17 | |
| S-41 | 227+80 | 7.5m LT | 0.45-1.05 | A-4(0) | 26 | S | 3.4 | 58.9 | 15.5 | 22.2 | 100 | 100 | 45 | |
| S-42 | 227+80 | 7.5m LT | 1.05-1.65 | A-6(4) | 31 | LA | 2.2 | 50.8 | 14.7 | 32.3 | 100 | 100 | 52 | 25.9 |
| S-43 | 227+80 | 7.5m LT | 1.65-2.70 | A-2-4(0) | 18 | NP | 9.6 | 73.1 | 4.2 | 13.1 | 100 | 100 | 20 | |

- Ⓒ SOFT BROWN TO GRAY FINE SANDY SILT AND FINE SANDY CLAY, MOIST TO WET
- Ⓓ LOOSE BROWN SILTY FINE TO COARSE SAND, MOIST (PLEISTOCENE)
- Ⓔ ARTIFICIAL FILL LOOSE TO MEDIUM DENSE TAN COARSE SAND AND SHELLS, MOIST

CONST.REV.
R/W REV.

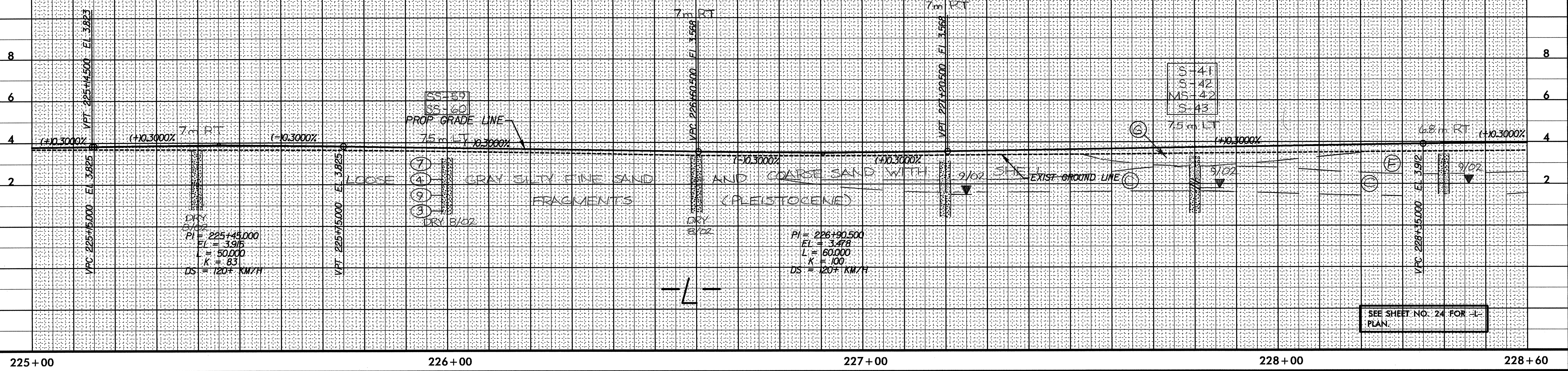

BM#10 EL. 3.424
RR SPIKE BST PARKING LOT
110.246m RT -L STA. 225+33.645

Soil Sample Test Results

| SAMPLE NO. | STATION | OFFSET | DEPTH INTERVAL | CLASS. | L.L. | P.I. | % BY WEIGHT | | | | % PASSING (SIEVES) | | MOISTURE | ORGANIC |
|------------|---------|---------|----------------|----------|------|------|-------------|-------|------|------|--------------------|------|----------|---------|
| | | | | | | | CSAND | FSAND | SILT | CLAY | 2.0mm | 75um | | |
| SS-61 | 230+03 | 7.5m RT | 0.75-1.20 | A-2-4(0) | 19 | NP | 15.3 | 7.4 | 4.7 | 6 | 99 | 97 | 15 | |
| SS-62 | 230+03 | 7.5m RT | 2.25-2.70 | A-2-4(0) | 21 | NP | 1.7 | 55.5 | 4.7 | 10.1 | 100 | 78 | 15 | |
| S-44 | 231+80 | 6.7m RT | 0.50-1.00 | A-4(0) | 23 | S | 0.6 | 61.5 | 19.8 | 18.6 | 100 | 100 | 50 | |

- Ⓒ SOFT BROWN TO GRAY FINE SANDY CLAY AND FINE SANDY SILT, MOIST TO WET (PLEISTOCENE)

