

INLET END ELEVATION NORMAL TO SKEW

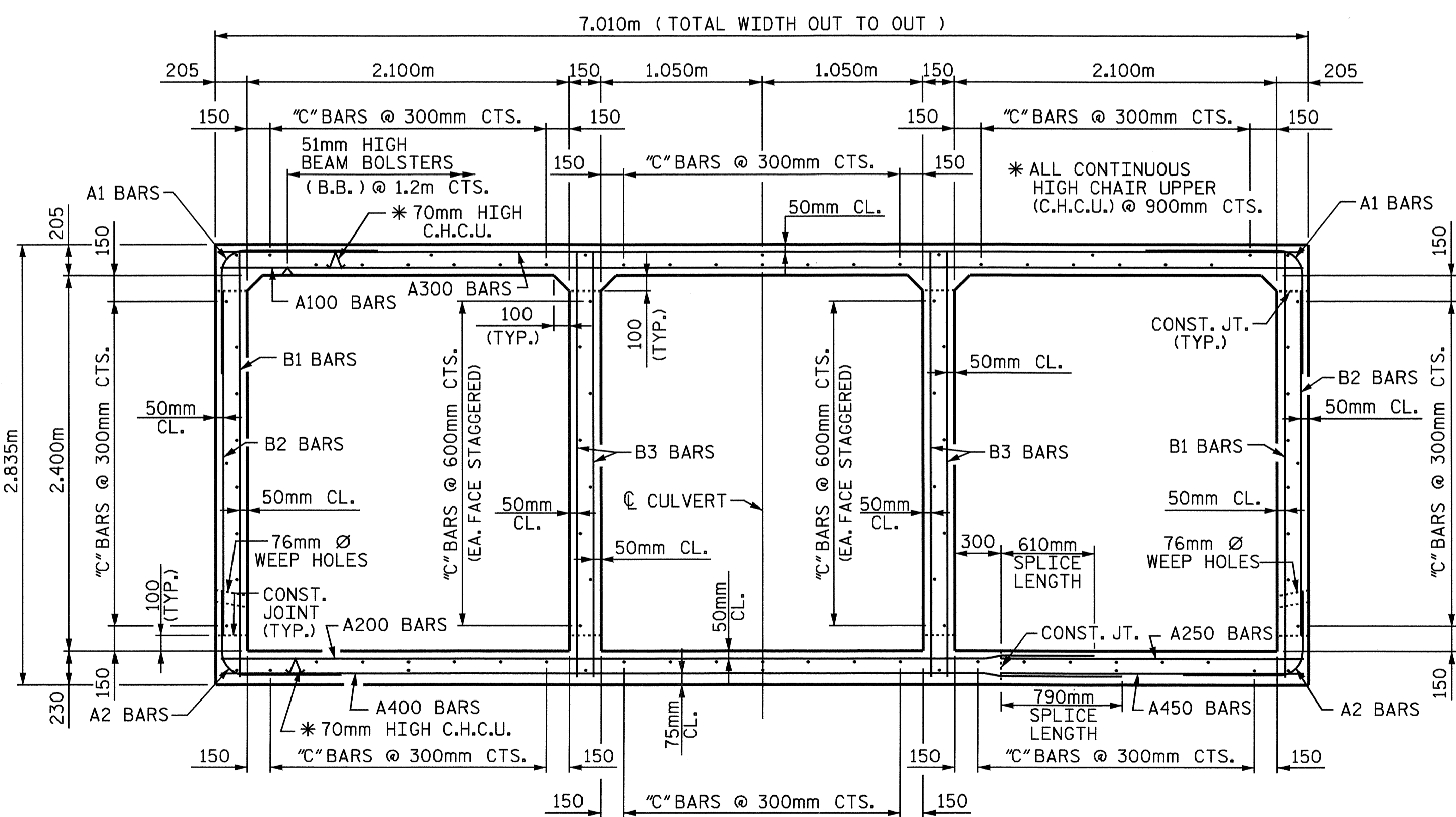

RIGHT ANGLE SECTION OF BARREL

THERE ARE 90 "C" BARS IN SECTION OF BARREL.
(LOOKING DOWNSTREAM)

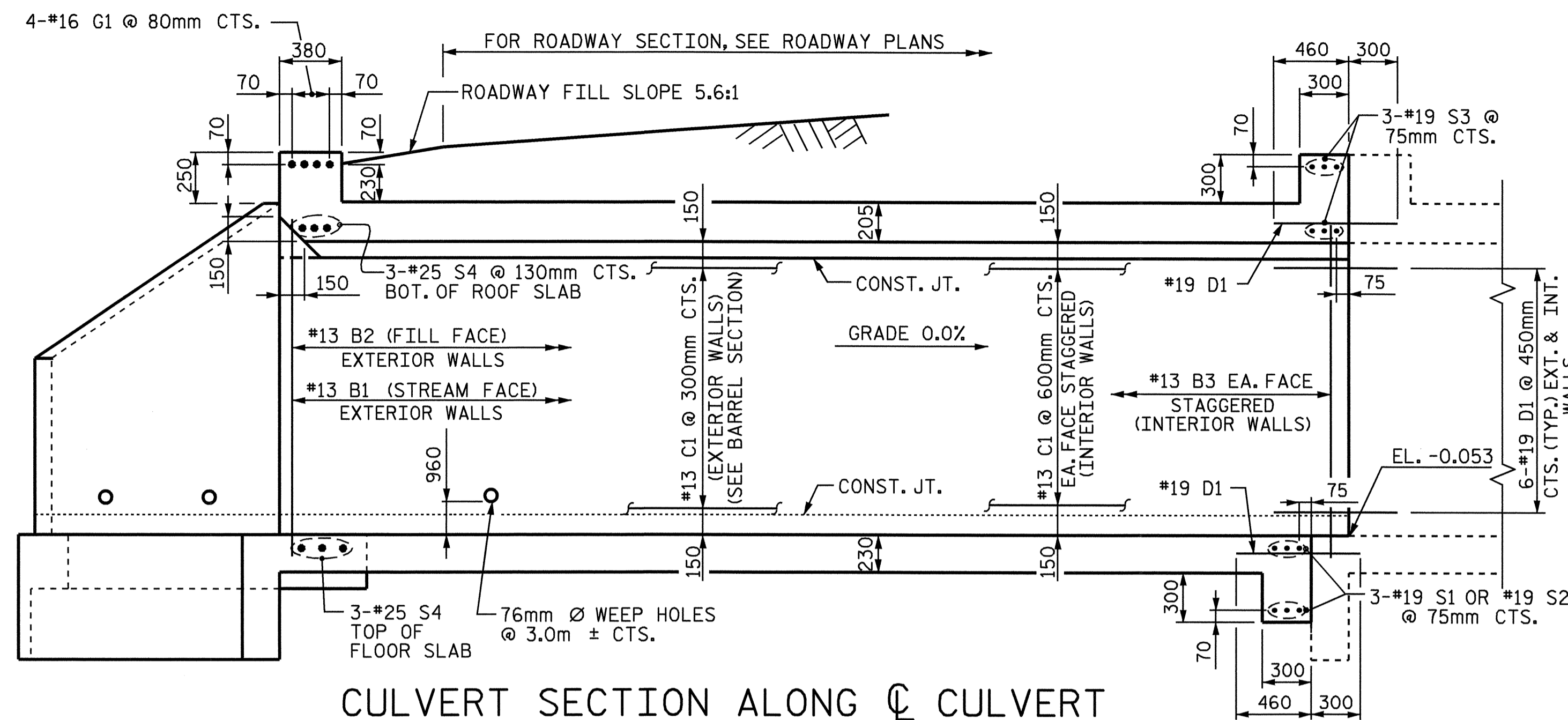

CULVERT SECTION ALONG C CULVERT

(LEFT EXTENSION)

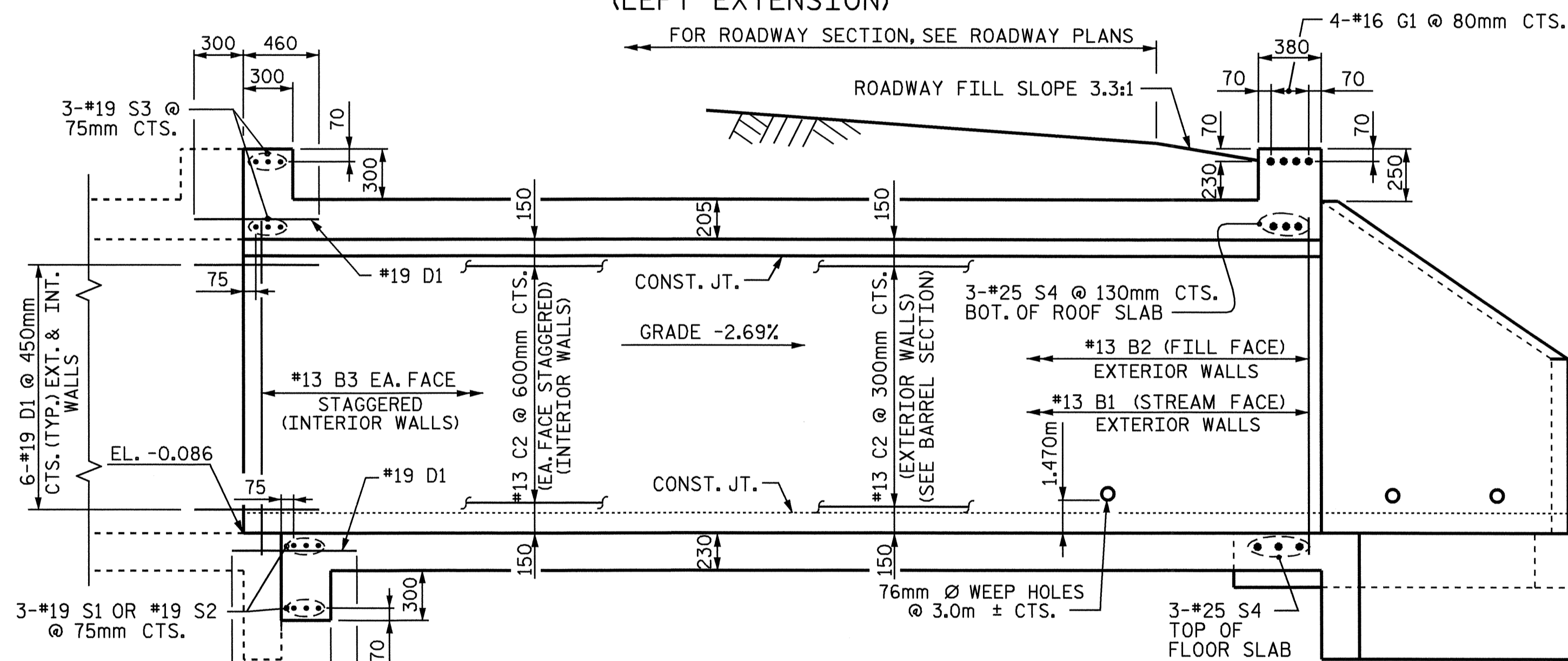

CULVERT SECTION ALONG C CULVERT

(RIGHT EXTENSION)

PROJECT NO. R-2539C
PAMLICO COUNTY
STATION: 196+60.650 -L-

SHEET 2 OF 9

STATE OF NORTH CAROLINA
DEPARTMENT OF TRANSPORTATION
RALEIGH

TRIPLE
2.100m X 2.400m
CONCRETE BOX CULVERT
EXTENSIONS
62° SKEW

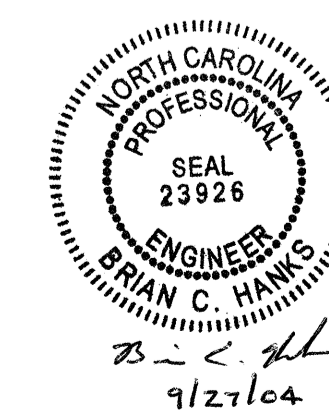

DRAWN BY: KEITH D. LAYNE DATE: 12-10-03
CHECKED BY: A. B. NAIK DATE: 4-6-04

23-SEP-2004 12:21
W:\squadg\R2539c\FINAL_PLANS\R2539C_sd_cu_01.dgn
wparker

REVISIONS						SHEET NO.
NO.	BY:	DATE:	NO.	BY:	DATE:	C-2
1			3			TOTAL SHEETS
2			4			20