

**PROJECT SPECIAL PROVISIONS**  
**PERMITS**

The Contractor's attention is directed to the following permits, which have been issued to the Department of Transportation by the authority granting the permit.

**PERMIT**

**AUTHORITY GRANTING THE PERMIT**

Dredge and Fill and/or  
Work in Navigable Waters (404)

U. S. Army Corps of Engineers

Water Quality (401)

Division of Environmental Management, DENR,  
State of North Carolina

The Contractor shall comply with all applicable permit conditions during construction of this project. Those conditions marked by \* are the responsibility of the department and the Contractor has no responsibility in accomplishing those conditions.

Agents of the permitting authority will periodically inspect the project for adherence to the permits.

The Contractor's attention is also directed to Articles 107-10 and 107-14 of the Standard Specifications and the following:

Should the Contractor propose to utilize construction methods (such as temporary structures or fill in waters and/or wetlands for haul roads, work platforms, cofferdams, etc.) not specifically identified in the permit (individual, general, or nationwide) authorizing the project it shall be the Contractor's responsibility to coordinate with the Engineer to determine what, if any, additional permit action is required. The Contractor shall also be responsible for initiating the request for the authorization of such construction method by the permitting agency. The request shall be submitted through the Engineer. The Contractor shall not utilize the construction method until it is approved by the permitting agency. The request normally takes approximately 60 days to process; however, no extensions of time or additional compensation will be granted for delays resulting from the Contractor's request for approval of construction methods not specifically identified in the permit.

**Where construction moratoriums are contained in a permit condition which restricts the Contractor's activities to certain times of the year, those moratoriums will apply only to the portions of the work taking place in the waters or wetlands provided that activities outside those areas is done in such a manner as to not affect the waters or wetlands.**

DEC 21 2004

U.S. ARMY CORPS OF ENGINEERS  
WILMINGTON DISTRICT  
101

DIVISION OF HIGHWAYS  
PDEA-OFFICE OF NATURAL ENVIRONMENT

Action ID: 200100641

TIP No. B-3682  
W-3413

State Project No. 8.2261201  
8.7326024

County: Onslow

GENERAL PERMIT (REGIONAL AND NATIONWIDE) VERIFICATION

Property Owner: Gregory J. Thorpe, Ph.D.  
Address: Environmental Management Director, PDEA  
N.C. Department of Transportation  
1548 Mail Service Center  
Raleigh, NC 27699-1548

Telephone Number: (910) 733-3141

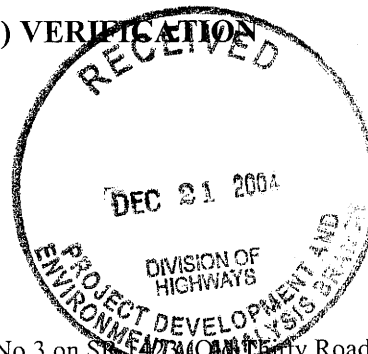

Size and Location of project (waterway, road name/number, town, etc.): Bridge No.3 on SR 1423 (Old Thirty Road) over Little Northeast Creek and an unnamed tributary to Horse Swamp, Onslow County, North Carolina.

Description of Activity: Discharge of fill material permanently impacting a total of 0.15 acres of waters of the United States, including wetlands, and 208 feet of intermittent stream for construction of TIP Project No. B-3682/W-3413 for replacement of Bridge No. 3 on SR 1423 (Old Thirty Road) over Little Northeast Creek and widening of SR 1423 (Old Thirty Road) from SR 1411 (Waters Road) to SR 1427 (Grants Creek Loop) over an unnamed tributary to Horse Swamp, Onslow County, North Carolina, as described in NCDOT letter dated October 27, 2004 and amended November 29, 2004. Bridge No. 3 is 70 feet long and 24 feet wide and has a reinforced concrete deck and timber joists supported on timber caps and piles. It will be replaced, using top down construction methods, with a new bridge on new location a distance of 80 feet south of the existing bridge. The proposed bridge will be 200 feet long with 24 feet of travelway and two travel lanes. Traffic will be maintained on existing Bridge No. 3 during construction. Work associated with the proposed project shall be accomplished in accordance with the attached special conditions.

Applicable Law:  Section 404 (Clean Water Act, 33 U.S.C. 1344)  
 Section 10 (River and Harbor Act of 1899)  
Authorization:  23 Nationwide Permit Number  
 Regional General Permit Number

Your work is authorized by this Regional General (RGP) or Nationwide (NWP) Permit provided it is accomplished in strict accordance with the attached conditions and your submitted plans. If your activity is subject to Section 404 (if Section 404 block above is checked), before beginning work you must also receive a Section 401 water quality certification from the N.C. Division of Environmental Management, telephone (919) 733-1786. For any activity within the twenty coastal counties, before beginning work you must contact the N.C. Division of Coastal Management, telephone (919) 733-2293.

Please read and carefully comply with the attached conditions of the RGP or NWP. Any violation of the conditions of the RGP or NWP referenced above may subject the permittee to a stop work order, a restoration order, and/or appropriate legal action.

This Department of the Army RGP or NWP verification does not relieve the permittee of the responsibility to obtain any other required Federal, State, or local approvals/permits. The permittee may need to contact appropriate State and local agencies before beginning work.

This verification will remain valid until 16 December 2006 unless the nationwide authorization is modified, reissued or revoked. If, prior to 16 December 2006 the nationwide permit authorization is reissued and/or modified, this verification will remain valid until 16 December 2006, provided it complies with all modifications. If the nationwide permit authorization expires or is suspended, revoked, or is modified, such that the activity would no longer comply with the terms and conditions of the nationwide permit, activities which have commenced (i.e., are under construction) or are under contract to commence in reliance upon the nationwide permit, will remain authorized provided the activity is completed within twelve months of the date of the nationwide permit's expiration, modification or revocation, unless discretionary authority has been exercised on a case-by-case basis to modify, suspend or revoke the authorization.

Action ID: 200100641

TIP No. B-3682  
W-3413

**102**

State Project No. 8.2261201  
8.7326024

County: Onslow

If there are any questions regarding this authorization or any of the conditions of the RGP or NWP, please contact Mr. Dave Timpy of the Corps Regulatory Office in Wilmington at the phone number specified below.

Date 16 December 2004

Corps Regulatory Official



Telephone No. (910) 251-4634

CF: NCDOT Division 3, ATTN Mason Herndon.

**103****SPECIAL CONDITIONS**

1. Compensatory mitigation for the 0.15 acres of wetland impacts associated with the proposed project shall be performed as described in the letter from NCDOT dated October 27, 2004 (copy attached) and as detailed in the mitigation plan dated October 22, 2004 (copy attached). This work will restore 0.28 acres of riverine wetlands by removing approximately 300 feet of the existing causeway to Bridge No. 3, restoring the elevation of this area to match adjacent bottomland hardwood wetland areas, and replanting with indigenous wetland vegetation as described in the referenced mitigation plan.
2. Bridge demolition and removal will be accomplished in accordance with "North Carolina Department of Transportation Policy: Bridge Demolition and Removal in Waters of the United States" dated September 20, 1999.
3. No in-water work shall be conducted within waters of Little Northeast Creek from February 15 thru September 30 of any year to protect anadromous fish and primary nursery area activity.
4. All work must be performed as shown on the attached plans, which are a part of this permit. Failure to institute and carry out the details of the following special conditions, below, will result in a directive to cease all ongoing and permitted work within waters and/or wetlands associated with the permitted project, or such other remedies and/or fines as the District Engineer or his authorized representatives may seek.
5. The temporary placement or double handling of excavated or fill material or construction equipment and materials within waters and wetlands are not authorized.
6. One copy of the final construction drawings shall be furnished to the District Engineer prior to the pre-construction meeting. Written verification shall be provided that the final construction drawings comply with the attached permit drawings. The permittee shall ensure that the construction design plans for this project do not deviate from the permit plans attached to this authorization. Any deviation in the construction design plans, including bridge demolition, shall be brought to the attention of the Corps of Engineers, Mr. Dave Timpy, Wilmington Regulatory Field Office prior to any active construction in waters or wetlands.
7. The permittee shall schedule a preconstruction meeting between its representatives, the contractor's representatives, and the Corps of Engineers, Wilmington Regulatory Field Office NCDOT Regulatory Project Manager, prior to any work within jurisdictional waters and wetlands to ensure that there is a mutual understanding of all of the terms and conditions contained within this Department of the Army Permit. The permittee shall notify the Corps of Engineers Project Manager a minimum of thirty (30) days in advance of the scheduled meeting in order to provide that individual with ample opportunity to schedule and participate in the required meeting.

**104****SPECIAL CONDITIONS**

8. The permittee shall require its contractors and/or agents to comply with the terms and conditions of this permit in the construction and maintenance of this project, and shall provide each of its contractors and/or agents associated with the construction or maintenance of this project with a copy of this permit. Copies of this permit and any modifications authorized by the USACE shall be available for review at the construction site at all times. All violations, including non-compliance of these conditions, of the authorized permit shall be reported to the District Engineer within 24 hours of the violation.
9. The permittee shall remove all sediment and erosion control measures placed in wetlands or waters, and restore natural grades in those areas.
10. All fill material must be adequately stabilized at the earliest practicable date to prevent erosion of fill material into adjacent waters or wetlands.
11. The permittee and its contractors and/or agents shall not excavate, fill, or perform mechanized landclearing at any time in the construction or maintenance of this project within waters and/or wetlands, or cause the degradation of waters and/or wetlands, except as authorized by this permit, or any modification to this permit. There shall be no excavation from, waste disposal into, or degradation of, jurisdictional wetlands or waters associated with this permit without appropriate modification of this permit, including appropriate compensatory mitigation. This prohibition applies to all borrow and fill activities connected with this project.
12. To ensure that all borrow and waste activities occur on high ground and do not result in the degradation of adjacent wetlands and streams, except as authorized by this permit, the permittee shall require its contractors and/or agents to identify all areas to be used to borrow material, or to dispose of dredged, fill, or waste material. The permittee shall ensure that all such areas comply with the preceding condition (11.) of this permit, and shall require and maintain documentation of the location and characteristics of all borrow and disposal sites associated with this project. This information will include data regarding soils, vegetation and hydrology sufficient to clearly demonstrate compliance with the preceding condition (11.). All information will be available to the Corps of Engineers upon request. NCDOT shall require its contractors to complete and execute reclamation plans for each waste and borrow site and provide written documentation that the reclamation plans have been implemented and all work is completed. This documentation will be provided to the Corps of Engineers within 30 days of the completion of the reclamation work. All jurisdictional wetland lines on borrow and waste sites shall be verified by the Corps of Engineers and shown on the approved reclamation plans.

# NORTH CAROLINA

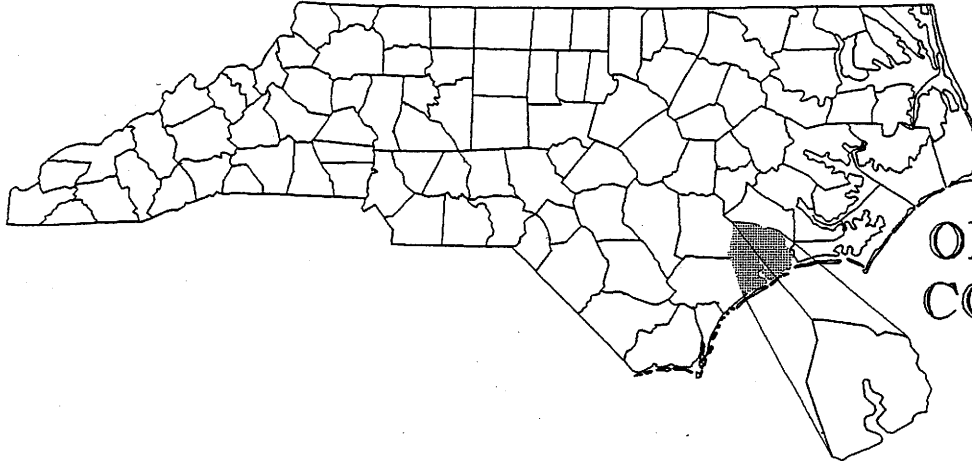

**ONSLOW  
COUNTY**

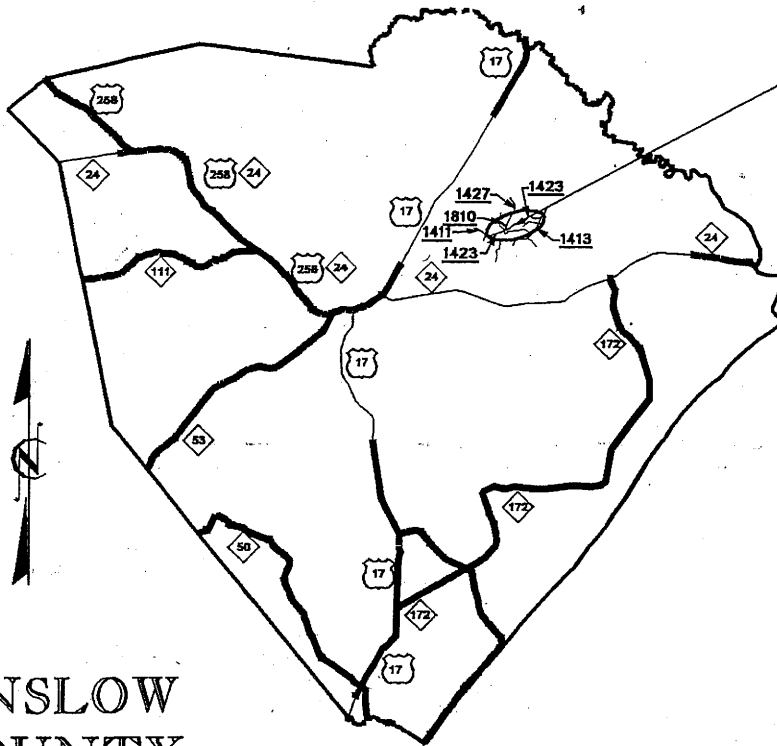

**PROJECT  
SITE**

**ONSLOW  
COUNTY**

## VICINITY MAP

**(WETLANDS  
&  
SURFACE WATERS)**

## NCDOT

DIVISION OF HIGHWAYS

ONSLOW COUNTY

PROJECTS: 33224.1.1 (B-3682)  
& 35052.1.1 (W-3413)

REPLACEMENT OF BRIDGE NO.3  
ON SR 1423 OVER LITTLE NE CREEK



— END PROJECT

(NO SCALE)



BEGIN — PROJECT

**SITE  
MAP**

**(WETLANDS  
&  
SURFACE WATERS)**

**NCDOT**  
 DIVISION OF HIGHWAYS  
 ONSLOW COUNTY  
 PROJECTS: 33224.1.1 (B-3682)  
 & 35052.1.1 (W-3413)  
 REPLACEMENT OF BRIDGE NO. 3  
 ON SR 1423 OVER LITTLE NE CREEK

SHEET 2 OF 12

8 JUL 04

# WETLAND LEGEND

 WETLAND BOUNDARY

 WETLAND

 DENOTES FILL IN WETLAND

 DENOTES FILL IN SURFACE WATER

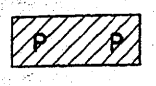
 DENOTES FILL IN SURFACE WATER (POND)

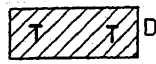
 DENOTES TEMPORARY FILL IN WETLAND

 DENOTES EXCAVATION IN WETLAND

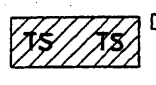
 DENOTES TEMPORARY FILL IN SURFACE WATER

 DENOTES MECHANIZED CLEARING

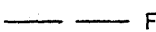
 FLOW DIRECTION

 TOP OF BANK

 EDGE OF WATER

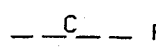
 PROP. LIMIT OF CUT

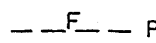
 PROP. LIMIT OF FILL

 PROP. RIGHT OF WAY

 NATURAL GROUND

 PROPERTY LINE

 TEMP. DRAINAGE EASEMENT

 PERMANENT DRAINAGE EASEMENT

 EXIST. ENDANGERED ANIMAL BOUNDARY

 EXIST. ENDANGERED PLANT BOUNDARY

 WATER SURFACE

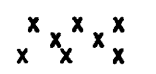
 LIVE STAKES

 BOULDER

 CORE FIBER ROLLS

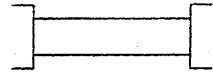

PROPOSED BRIDGE

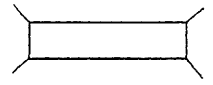

PROPOSED BOX CULVERT



PROPOSED PIPE CULVERT

12"-48" PIPES

54" PIPES & ABOVE

(DASHED LINES DENOTE EXISTING STRUCTURES)



SINGLE TREE

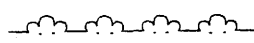

WOODS LINE

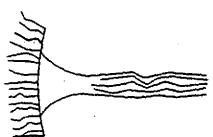

DRAINAGE INLET

ROOTWAD



RIP RAP



ADJACENT PROPERTY OWNER OR PARCEL NUMBER IF AVAILABLE



PREFORMED SCOUR HOLE (PSH)

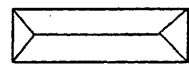

LEVEL SPREADER (LS)



GRASS SWALE

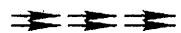

BASE GRASS SWALE

**NCDOT**  
 DIVISION OF HIGHWAYS  
 ONSLOW COUNTY  
 PROJECTS: 33224.1.1 (B-3682)  
 & 35052.1.1 (W-3413)  
 REPLACEMENT OF BRIDGE NO. 3  
 ON SR 1423 OVER LITTLE NE CREEK  
 SHEET 3 OF 12 8 JUL 04



## PROPERTY OWNERS

NAMES AND ADDRESSES

PARCEL NO.	NAMES	ADDRESSES
5	John W. Banks, et. ux.	1075 Lullwater Circle McDonough, GA 30253
6	Thomas J. Marshall and Kathleen H. Marshall	207 Brentwood Ave. Jacksonville, NC 28540
7	Marijennie B. Warlick	1009 Country Club Drive Jacksonville, NC 28540
11	Marjorie Padgett	619 Old Thirty Road Jacksonville, NC 28546
15	Kathleen M. Leone	602 Old Thirty Road Jacksonville, NC 28546
16	John S. Martin	145 Harbord Drive Midway Park, NC 28544
22	Charles E. Franklin	237 Western Boulevard Jacksonville, NC 28546
23	Donald R. Croom	170 Croom Lane Jacksonville, NC 28546
24	Jeffery L. Lambert	816 Old Thirty Road Jacksonville, NC 28546
28	James V. Rose	828 Old Thirty Road Jacksonville, NC 28546
36	Joseph H. Henderson	1601 Pagan Road Raleigh, NC 27603

NCDOT

DIVISION OF HIGHWAYS

ONSLow COUNTY

PROJECTS: 33224.1.1 (B-3682)

&amp; 35052.1.1 (W-3413)

REPLACEMENT OF BRIDGE NO. 3  
ON SR 1423 OVER LITTLE NE CREEK

MATCHLINE T-31+00.00 SEE SHEET 6

B-3682 & W-3413  
 HW SHEET NO. 5  
 HYDRAULICS ENGINEER  
 PRELIMINARY PLANS  
 DO NOT USE FOR CONSTRUCTION



PROP. PAINTED ISLAND. SEE TRAFFIC CONTROL PLANS  
 PAVEMENT REMOVAL & OBLITERATION

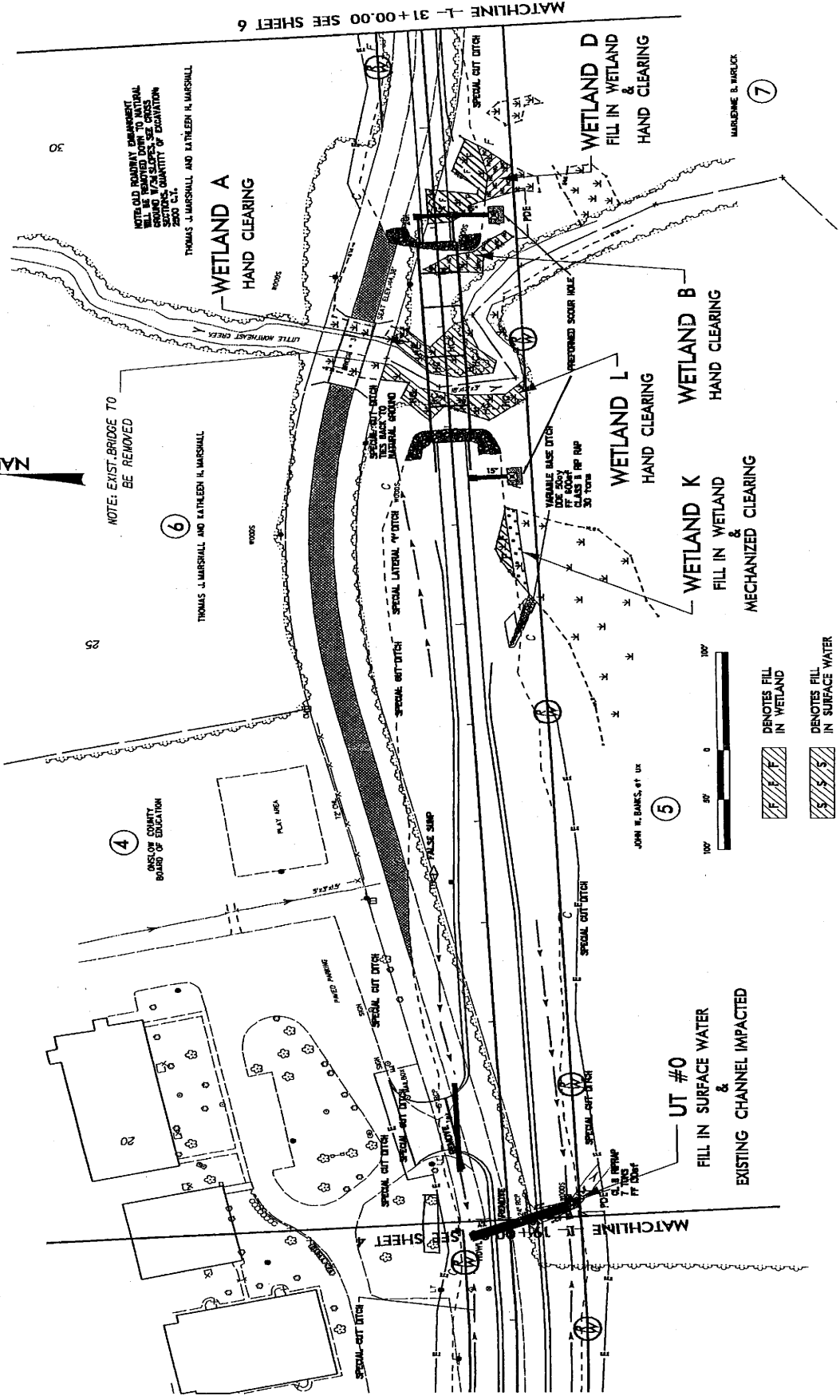
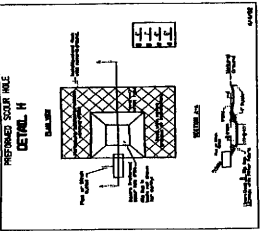
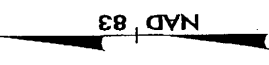
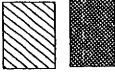

NOTE: EXIST. BRIDGE TO BE REMOVED

NOTE: OLD ROADWAY FURNISHMENT WILL BE RELOCATED TO ORIGINAL POSITION. SEE CROSS SECTION. QUANTITY OF EXCAVATION 2500 C.Y.  
 THOMAS J. MARSHALL AND KATHLEEN H. MARSHALL

ONCLOW COUNTY BOARD OF EDUCATION  
 PLAY AREA

WETLAND D  
 FILL IN WETLAND & HAND CLEARING

WETLAND B  
 HAND CLEARING

WETLAND K  
 FILL IN WETLAND & MECHANIZED CLEARING

WETLAND L  
 HAND CLEARING

UT #0  
 FILL IN SURFACE WATER & EXISTING CHANNEL IMPACTED

JOHN W. BARKER, P.E. ILL.



- DENOTES FILL IN WETLAND
- DENOTES FILL IN SURFACE WATER
- DENOTES MECHANIZED CLEARING
- DENOTES HAND CLEARING

7

MARLENE S. BURCK

PROJECT REFERENCE NO. B-3682 & W-343  
 SHEET NO. 5A  
 HYDRAULICS ENGINEER  
 ROADWAY DESIGN ENGINEER  
 PRELIMINARY PLANS  
 DO NOT USE FOR CONSTRUCTION



PROP. PAINTED ISLAND.  
 SEE TRAFFIC CONTROL PLANS  
 PAVEMENT REMOVAL & OBLITERATION

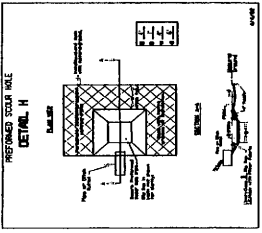

110

NAD 83

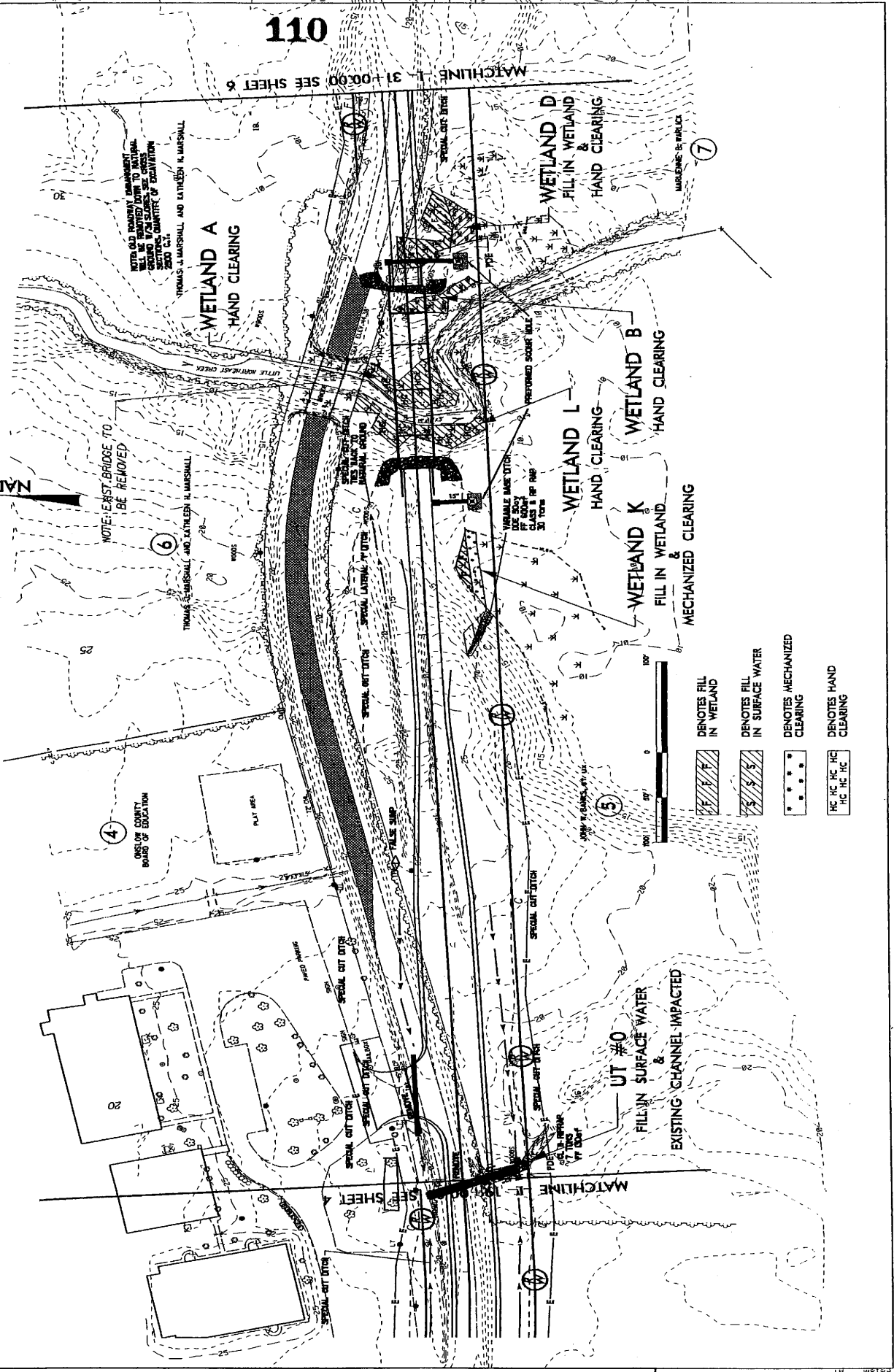

- DENOTES FILL IN WETLAND
- DENOTES FILL IN SURFACE WATER
- DENOTES MECHANIZED CLEARING
- DENOTES HAND CLEARING

PROJECT REFERENCE NO. B-3682 & W-3413  
 SHEET NO. 6  
 HYDRAULICS ENGINEER  
 PRELIMINARY PLANS  
 NO POST USE FOR CONSTRUCTION



PAVEMENT REMOVAL & OBLITERATION

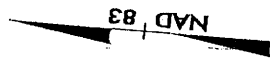

111

MATCHLINE L-44+00.00 SEE SHEET 7

MATCHLINE L-31+00.00 SEE SHEET 5

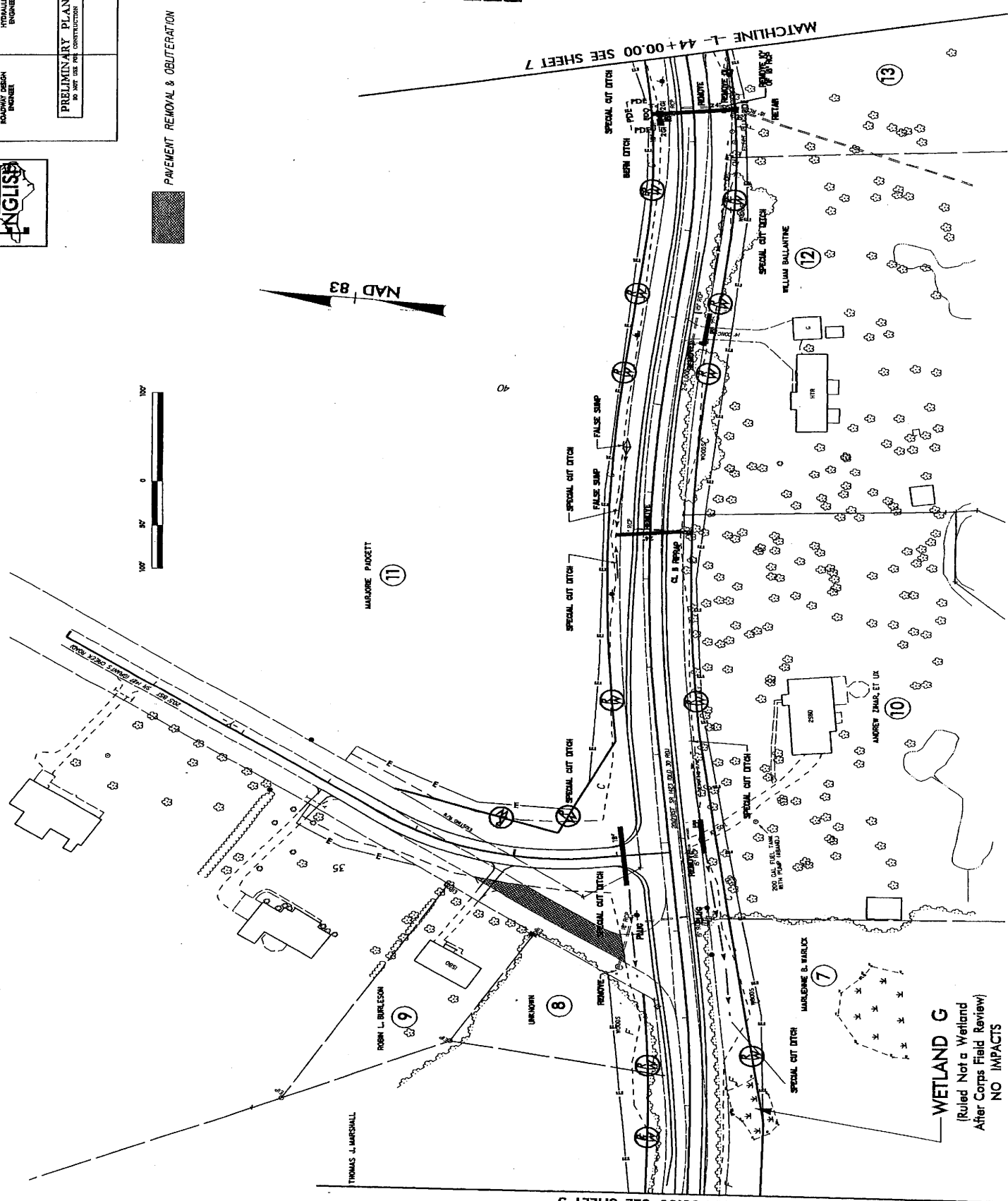

**WETLAND C**  
 (Ruled Not a Wetland  
 After Corps Field Review)  
 NO IMPACTS

See sheet 12, 13 for L-Profile

PROJECT REFERENCE NO. B-3682 & W-343	SHEET NO. 6A
BY ROADWAY DESIGN ENGINEER	CHECKED BY HYDRAULICS ENGINEER
PRELIMINARY PLANS FOR REVIEW AND CONSTRUCTION	



PAVEMENT REMOVAL & OBLITERATION

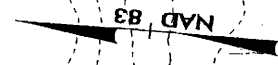

112

MATCHLINE L-44+00.00 SEE SHEET 7

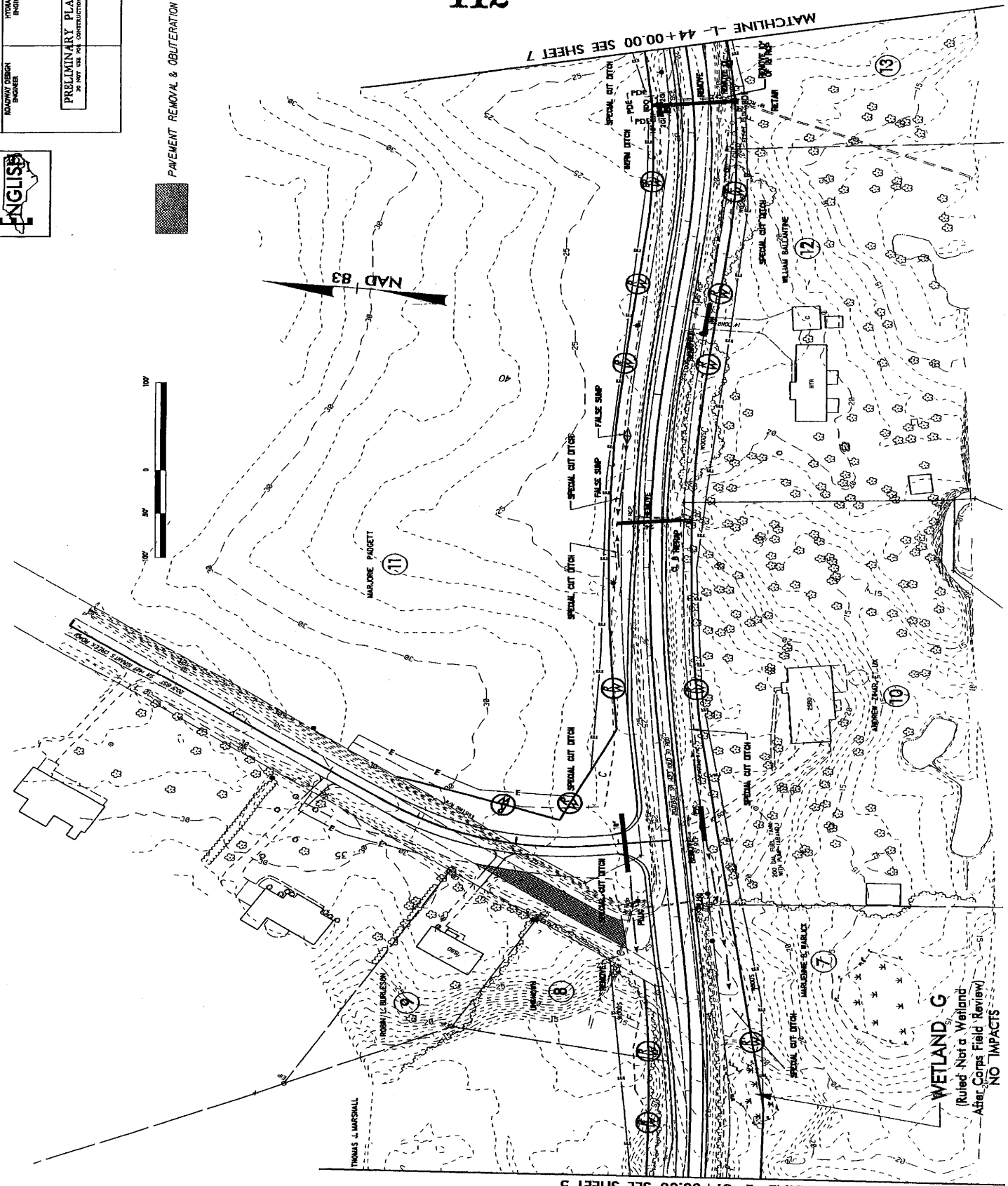

MATCHLINE L-31+00.00 SEE SHEET 5

**WETLAND G**  
(Ruled - Not a Wetland)  
After Corps Field Review  
NO IMPACTS

See sheet 12, 13 for L- Profile

8/17/99

REVISIONS

18-NOV-2004 14:50  
c:\highway\1\cadd\permits\b3682p-3.dwg  
p1

PROJECT REFERENCE NO. B-3682 & W-3413  
 SHEET NO. 7  
 HYDRAULICS ENGINEER  
 PRELIMINARY PLANS  
 DO NOT USE FOR CONSTRUCTION

RESURFACE AND WIDEN  
 FROM STA. 56+50 TO STA. 84+50  
 (SEE TYPICAL SECTION "5")

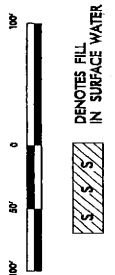
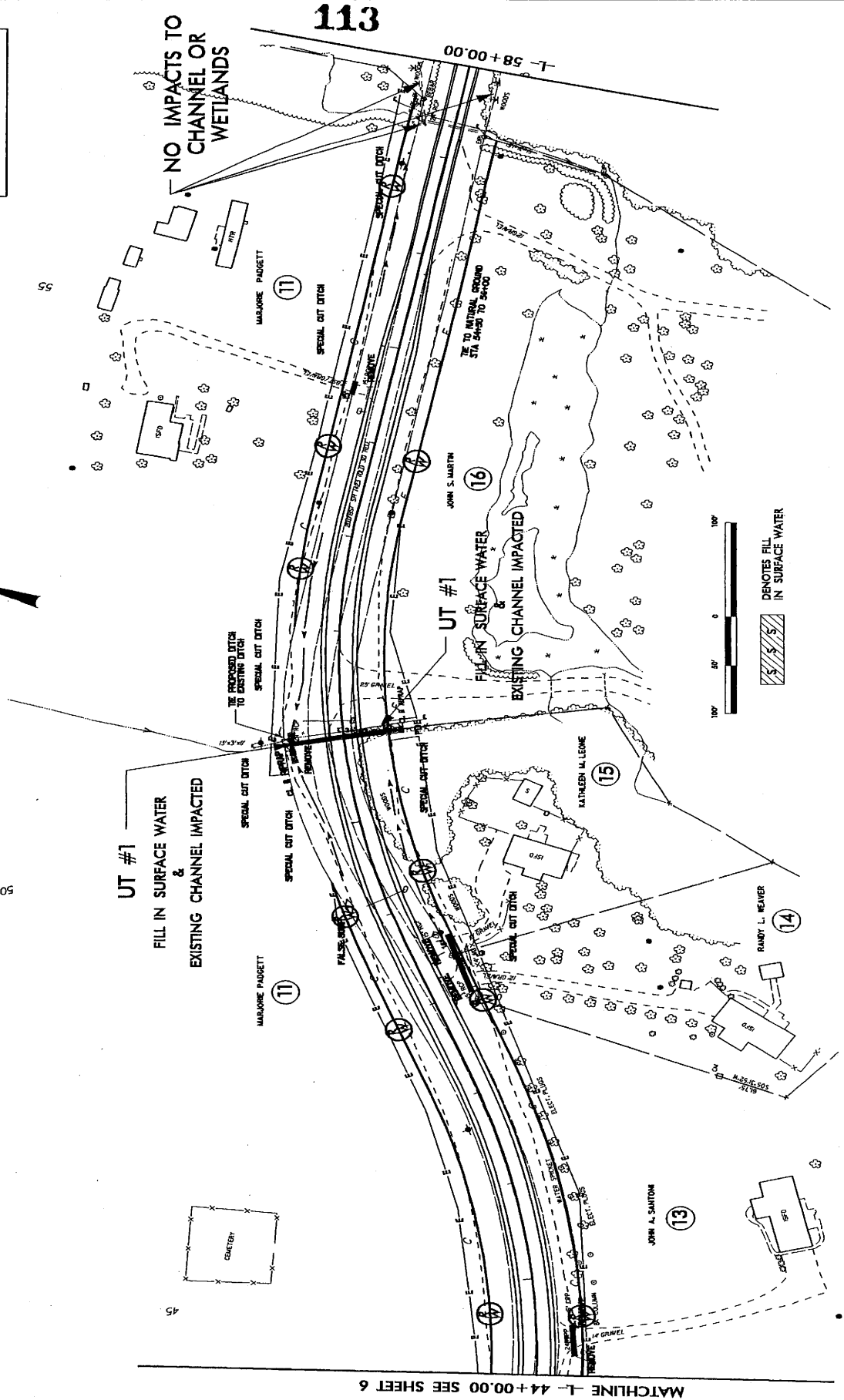
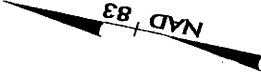

50

45

MATCHLINE L-44+00.00 SEE SHEET 6

See sheet 13 for L- Profile

13-Nov-2004 14:32 I:\projects\add\permits\b3682p-4.rpt 8/17/99

REVISIONS

PROJECT REFERENCE NO. B-3682 & W-3413  
 SHEET NO. 7A  
 HYDRAULICS ENGINEER  
 PRELIMINARY PLANS  
 DO NOT USE FOR CONSTRUCTION



RESURFACE AND WIDEN  
 FROM STA. 56+50 TO STA. 84+50  
 (SEE TYPICAL SECTION #5)

114

L-58+00.00

NAD 83

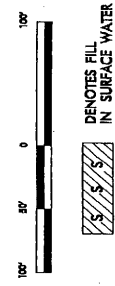
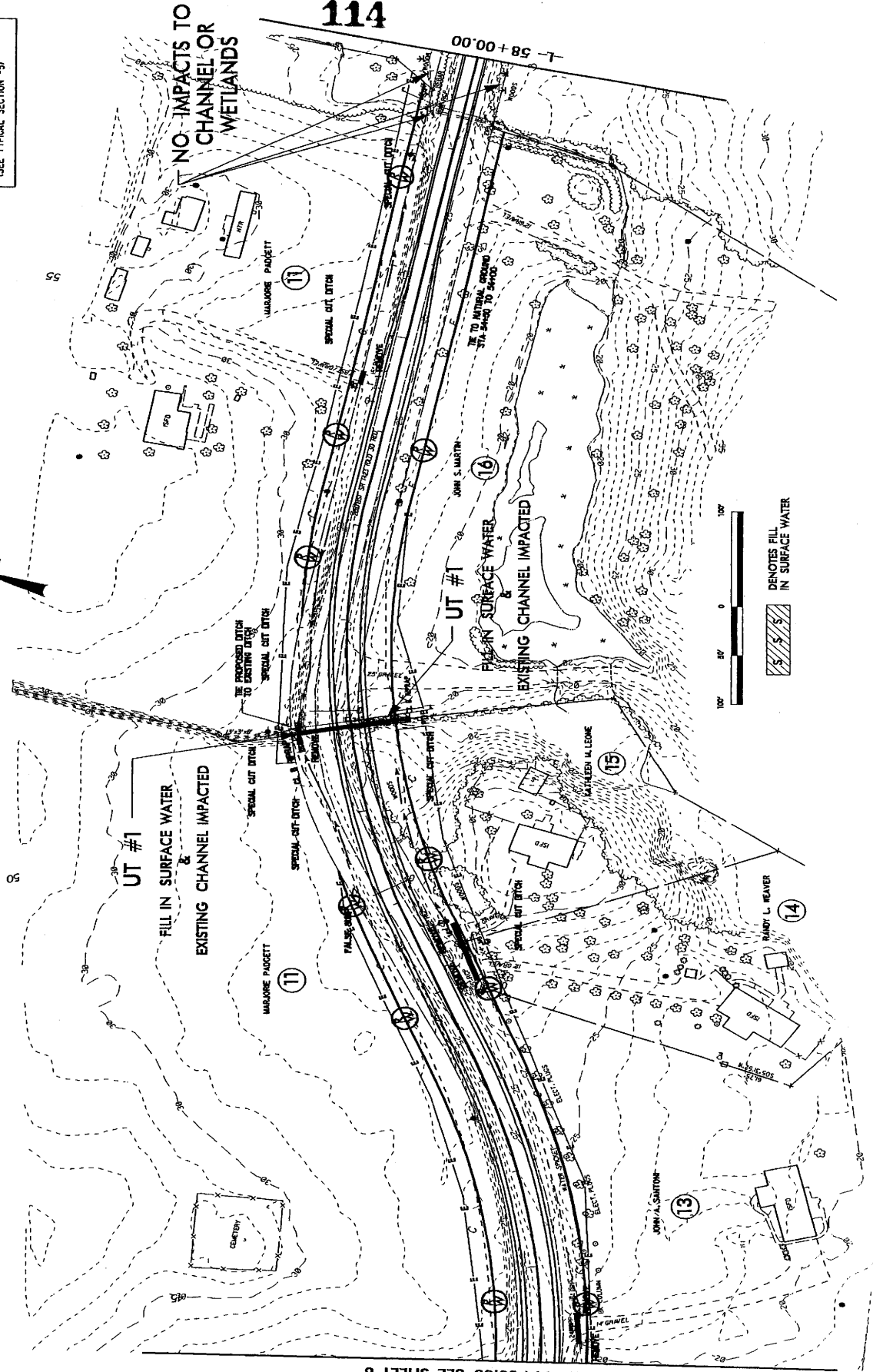

MATCHLINE L-44+00.00 SEE SHEET 6

See sheet 13 for L- Profile

REVISIONS

B/17/99

11-Nov-2004 14:54  
 I:\Hydr\en\lcedd\perm\ms\bb8p-1psh

PROJECT REFERENCE NO. B-3682 & W-3413  
 SHEET NO. 9  
 HYDRAULICS ENGINEER  
 PRELIMINARY PLANS  
 DO NOT USE FOR CONSTRUCTION



115

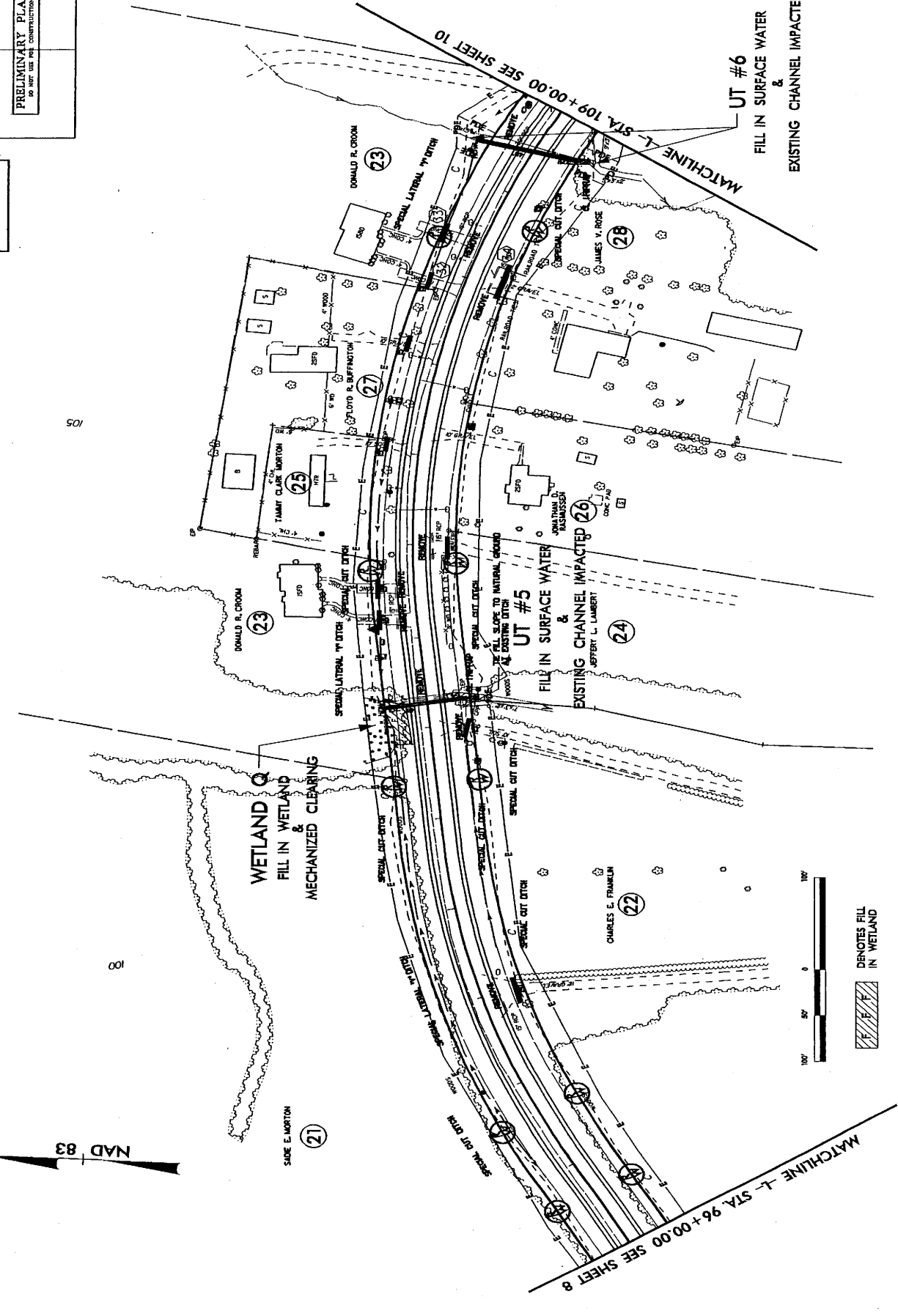

501

100

NAD 83

100' 50' 0' 50' 100'

- DENOTES FILL IN WETLAND
- DENOTES FILL IN SURFACE WATER
- DENOTES MECHANIZED CLEARING

UT #6  
 FILL IN SURFACE WATER  
 &  
 EXISTING CHANNEL IMPACTED

UT #5  
 FILL IN SURFACE WATER  
 &  
 EXISTING CHANNEL IMPACTED

WETLAND  
 FILL IN WETLAND  
 &  
 MECHANIZED CLEARING

See sheet 15 for -L- Profile

B/17/99

1:100-2004 1436  
 1:100-2004 1436  
 1:100-2004 1436

REVISIONS



PROJECT REFERENCE NO. B-3682 & W-3413  
 SHEET NO. 9A  
 CIVIL ENGINEER  
 PRELIMINARY PLANS  
 DO NOT USE FOR CONSTRUCTION



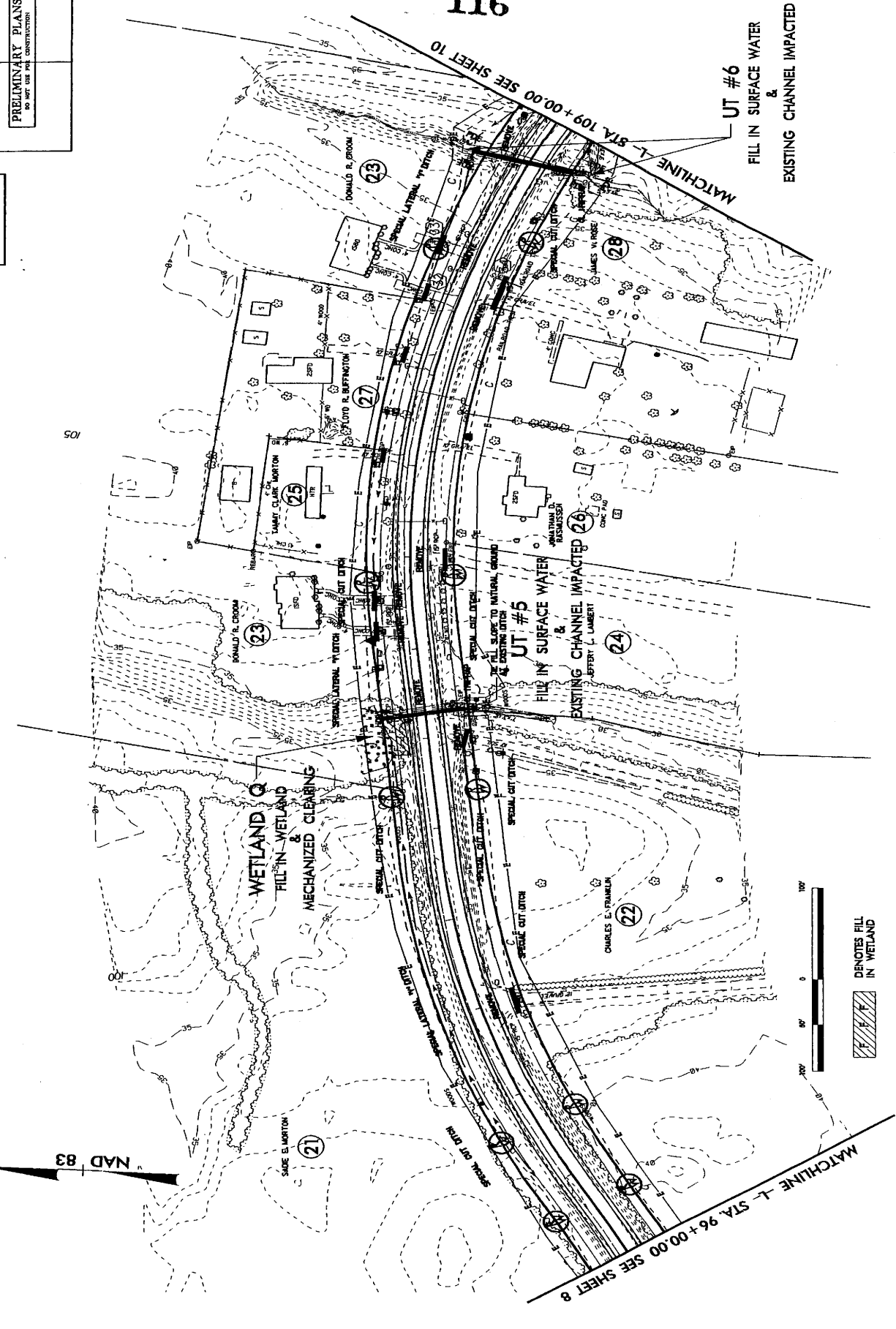

116



UT #6  
 FILL IN SURFACE WATER  
 &  
 EXISTING CHANNEL IMPACTED

UT #5  
 FILL IN SURFACE WATER  
 &  
 EXISTING CHANNEL IMPACTED

WETLAND  
 FILL IN WETLAND  
 &  
 MECHANIZED CLEANING

-  DENOTES FILL IN WETLAND
-  DENOTES FILL IN SURFACE WATER
-  DENOTES MECHANIZED CLEANING



NAD 83

See sheet 15 for -L- Profile

8/17/99

11-1001-2004 1457  
 r:\indiv\enr\l\cadd\perms\es\b31f07-1.ppt  
 67

REVISIONS

PROJECT REFERENCE NO. B-3682 & W-343	SHEET NO. 10
DESIGNER HYDRAULIC ENGINEER	
PRELIMINARY PLANS DO NOT USE FOR CONSTRUCTION	



DENOTES FILL  
IN WETLAND

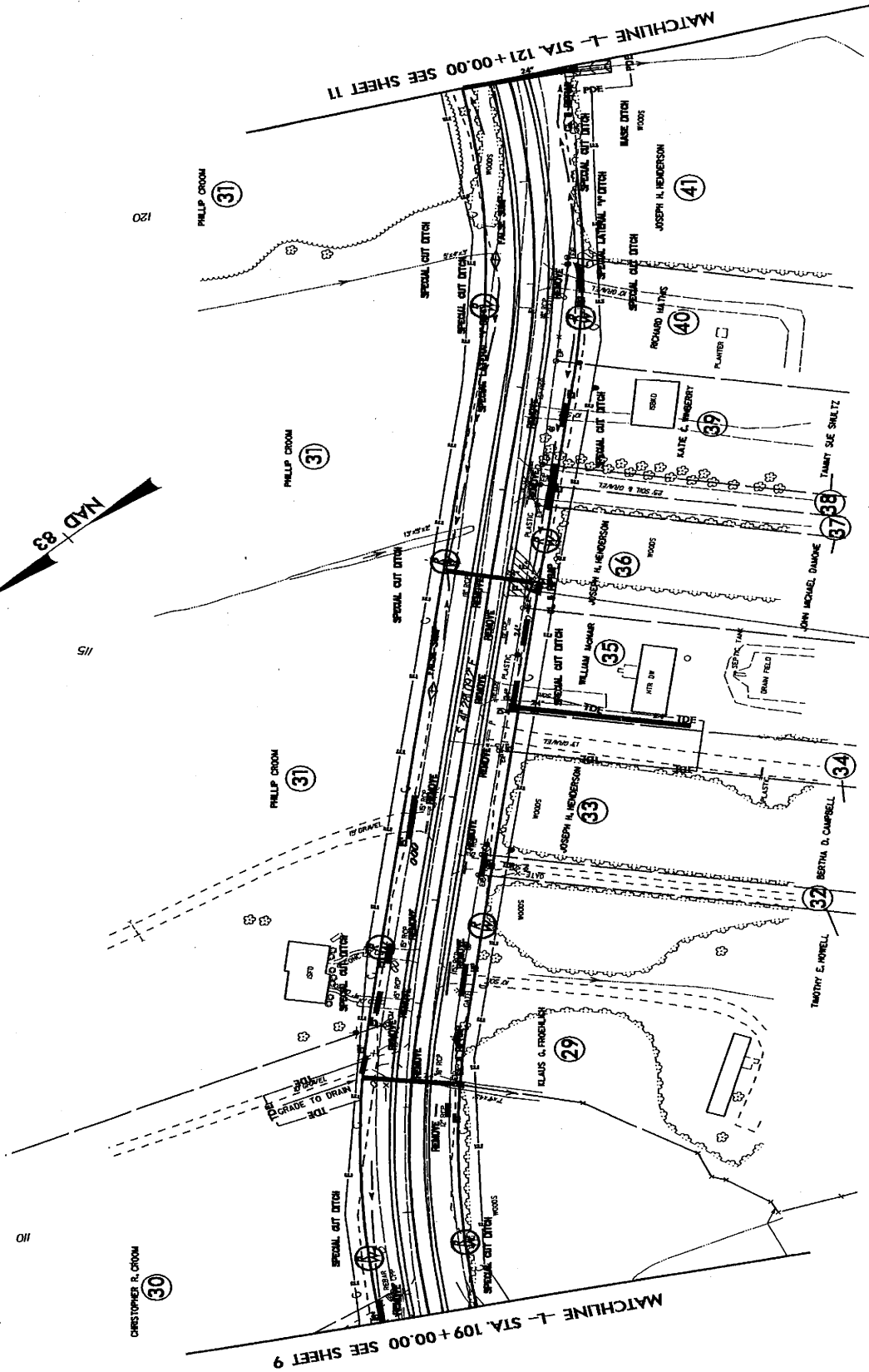
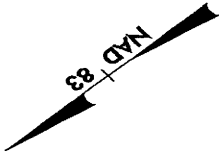

WETLAND P  
FILL IN WETLAND

See Sheet 15 for -L- Profile

REVISIONS	22-Nov-2004 10:51 P:\rindou\l\cadd\perm\ta\B239b-1\psd
-----------	---

PROJECT REFERENCE NO. B-3682 & W-343  
 SHEET NO. 10A  
 HYDRAULICS ENGINEER  
 PRELIMINARY PLANS  
 TO BE USED FOR PERMITS



118



DIKNOTES FILL IN WETLAND

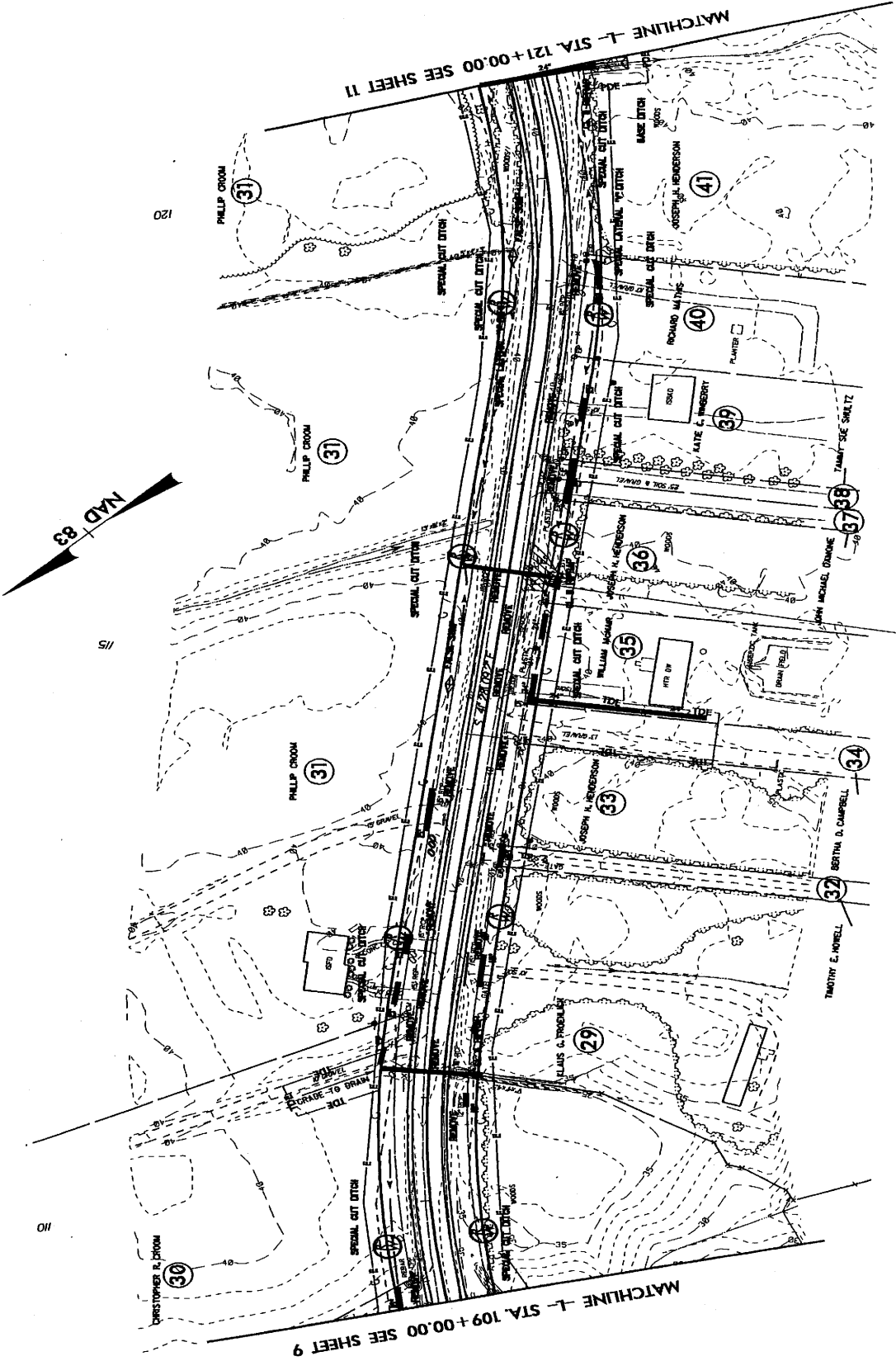

WETLAND P  
 FILL IN WETLAND

See Sheet 15 for -L- Profile

8/17/99

REVISIONS

23-NOV-2004 10:49  
 C:\p04\1\road\perm\ts\B323b-1.pnt  
 91

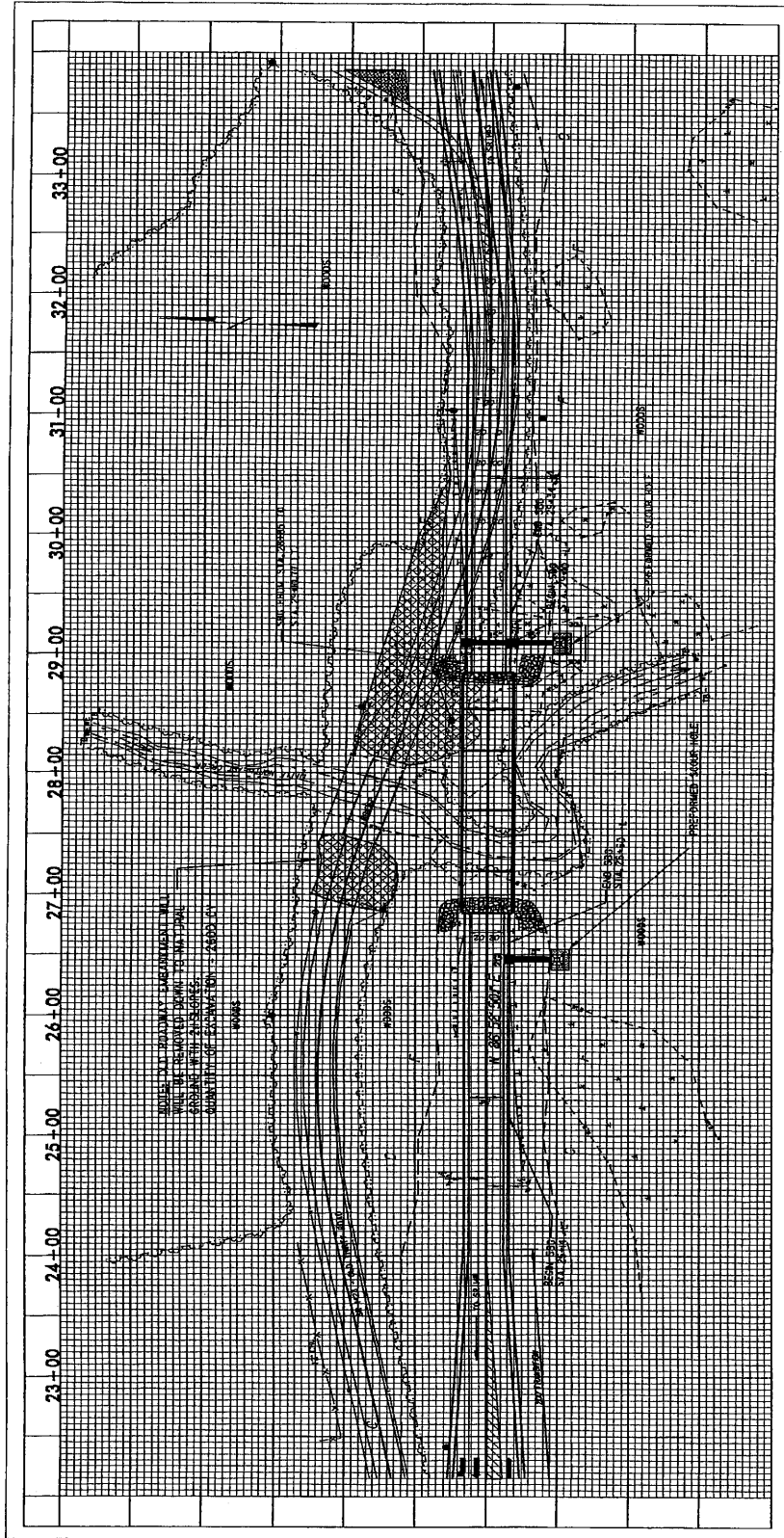

WETLAND PERMIT IMPACT SUMMARY

Site No.	Station (From/To)	Structure Size / Type	WETLAND IMPACTS					SURFACE WATER IMPACTS						
			Fill In Wetlands (ac)	Temp. Fill In Wetlands (ac)	Excavation In Wetlands (ac)	Mechanized Clearing (Method III) (ac)	Hand Clearing (ac)	Fill In SW (ac)	Temp. Fill In SW (ac)	Existing Channel Impacted (ft)	Natural Stream Design (ft)			
UT #0	-L- 19+00 Rt	2 @ 42in RCP								0.02			47	
WL A	-L- 27+70 Lt & Rt	Bridge						0.07						
WL B	-L- 28+60 Lt & Rt	Bridge						0.03						
WL D	-L- 29+50 Rt	Roadway Fill	0.05					0.02						
WL K	-L- 25+50 Rt	Roadway Fill	0.01				0.02							
WL L	-L- 27+20 Lt & Rt	Bridge						0.05						
WL G	-L- 32+00 Rt	Roadway Fill												
UT #1	-L- 51+00 Lt & Rt	1 @ 36in RCP								0.01			60	
WL Q	-L- 102+10 Lt	Roadway Fill & 48in RCP			0.02		0.03							
UT #5	-L- 102+30 Rt	Roadway Fill & 48in RCP								0.01			35	
UT #6	-L- 108+50 Lt & Rt	Roadway Fill & 48in RCP								0.01			66	
TOTALS, THIS SHEET:			0.06	0	0.02		0.05	0.16		0.05	0		208	0

RULED NOT A WETLAND BY CORPUS.

ACOE has determined UT 1, 5, and 6, 0 are intermittent streams requiring no mitigation

NC DEPARTMENT OF TRANSPORTATION  
DIVISION OF HIGHWAYS

ONSLOW COUNTY  
PROJECT 33224.1.1 (B-3682) &  
PROJECT 35052.1.1 (W-3413)  
SHEET 11 OF 12 9/29/04

WETLAND PERMIT IMPACT SUMMARY

Site No.	Station (From/To)	Structure Size / Type	WETLAND IMPACTS							SURFACE WATER IMPACTS									
			Fill In Wetlands (ac)	Temp. Fill In Wetlands (ac)	Excavation In Wetlands (ac)	Mechanized Clearing (Method III) (ac)	Hand Clearing (ac)	Fill In SW (ac)	Temp. Fill In SW (ac)	Existing Channel Impacted (ft)	Natural Stream Design (ft)								
WL P	-L- 116+15 Rt	Roadway Fill & 24in RCP			0.02														
TOTALS, THIS SHEET:			0	0	0.02	0	0	0	0	0	0	0	0	0	0	0	0	0	0
PROJECT TOTALS:			0.06	0	0.04	0.05	0.16	0.05	0	0.05	0	0	0	208	0	0	0	0	0

NC DEPARTMENT OF TRANSPORTATION  
 DIVISION OF HIGHWAYS  
 ONSLOW COUNTY  
 PROJECT 33224.1.1 (B-3682) &  
 PROJECT 35052.1.1 (W-3413)  
 SHEET 12 OF 12 9/29/04

**On-site Mitigation Plan**

Proposed Replacement of Bridge No. 3 on SR 1423 over Little Northeast Creek and SR 1423 from SR 1411 to SR 1413 in Onslow County, North Carolina.

TIP No. B-3682/W-3413

October 22, 2004

***Overview***

Roadway improvement project W-3413 is located adjacent to the proposed bridge replacement project and will be included with B-3682 for permitting purposes. This 2.0 mile project proposes to improve the horizontal curvature of SR 1423 from SR 1427 to SR 1413 in Onslow County. Bridge No. 3 will be removed and replaced at a new location in conjunction with this proposed alignment. The NCDOT will replace the existing 70-foot long bridge over Little Northeast Creek with a new bridge approximately 200 feet in length, therefore, spanning a large portion of the existing wetlands. Moving the bridge to a new location approximately 80 feet downstream will allow for the removal of approximately 300 linear feet of causeway in previously filled wetlands beginning left of station 26+95-L- to left of station 30+50-L-, not including the bridge over Little Northeast Creek. The existing causeway will be removed and returned to an elevation resembling that of the adjacent wetlands.

***Existing Conditions***

Bridge No. 3 is currently a causeway, which fills wetland habitat adjacent to Little Northeast Creek. The adjacent community consists of green ash (*Fraxinus pennsylvanica*), river birch (*Betula nigra*), willow oak (*Quercus phellos*) and water oak (*Quercus nigra*).

***Proposed Mitigation Activity: Causeway Removal***

The removal of the old causeway will mean that approximately 0.28 acres of fill will be removed from wetlands associated with Little Northeast Creek. Approximately 300 feet of existing causeway will be lifted, restoring the palustrine broad leaved wetland underneath. It is anticipated that after the causeway is removed, existing wetlands will again be connected, allowing the natural wetland hydrology to return. Therefore, NCDOT proposes 0.28 acre of riverine wetland restoration credit.

The causeway should be removed to an elevation representative of the adjacent wetlands, not to the wetland delineation line. The elevation at the delineation line is the uppermost point of the wetland, consequently acting as the boundary between wetland conditions and upland dry conditions. Excavating the causeway to a representative elevation prevents a levee effect around the existing wetlands. The wetlands must be connected for hydrology to return. If the uncovered causeway soils are slightly lower than the adjacent wetlands, it is anticipated that organic materials carried by the wind, rain and/or brought in and out by the flushing of the adjacent wetlands will settle into the restored area. This will create the desired upper layer of natural material. It will also create small areas of micro-habitat for fish, amphibians, and small mammals.

***Proposed Vegetation:***

The NCDOT proposes to replant with indigenous vegetation. The area to be restored will be planted with green ash (*Fraxinus pennsylvanica*), river birch (*Betula nigra*), willow oak (*Quercus phellos*) and water oak (*Quercus nigra*). The NCDOT also expects natural colonization of native flora to occur around the removed causeway.

The proposed restoration area is currently a standing palustrine forested broad-leaved deciduous wetland community. The canopy of this area is dominated by willow oak, water



oak, American beech (*Fagus grandifolia*), green ash, red maple (*Acer rubrum*), and American elm (*Ulmus americana*).

***Proposed Hydrology:***

The proximity of the restoration areas to Little Northeast Creek ensures that area will be saturated and/or inundated for extended periods of time. It is anticipated that after the causeway is removed, existing wetlands will again be connected, allowing the natural wetland hydrology to return.

***Monitoring***

As requested by the Army Corps of Engineers, the NCDOT will perform 3 years of photo monitoring with a site visit to determine if jurisdictional status has been met.

STATE	PROJECT NUMBER	DATE	SHEET
N.C.	B-3682/W-3413	RE-1	
SHEET NUMBER		DESCRIPTION	

# PLANTING DETAILS

## SEEDLING / LINER BARERoot PLANTING DETAIL

### HEALING IN

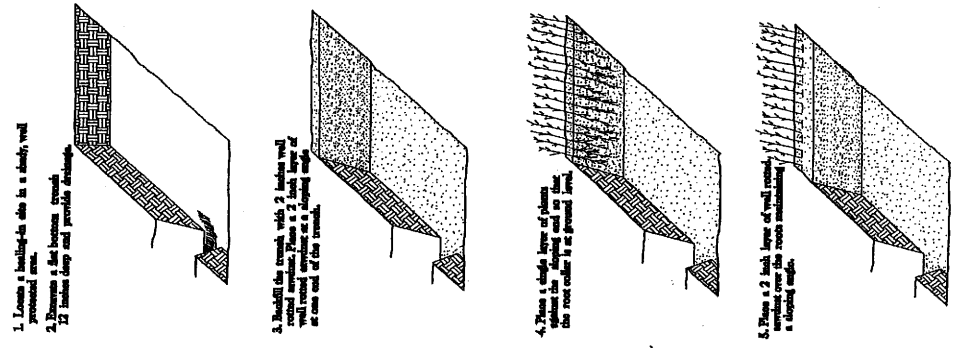

### DIBBLE PLANTING METHOD USING THE IBC PLANTING BAR

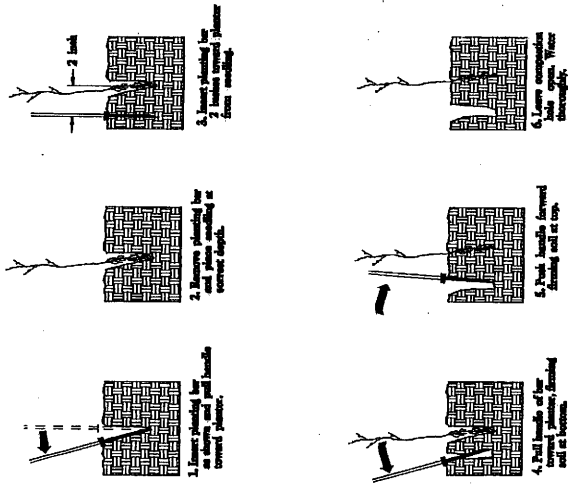

### PLANTING NOTES:

- PLANTING BAG**  
Dibble planting method should be used in sandy soil to prevent the seedling from being damaged by the soil.
- IBC PLANTING BAR**  
Planting bar should have a hole with a rectangular opening that will fit the dibble. The hole should be 2 inches wide and 1 inch thick at center.
- ROOT PRUNING**  
All seedlings shall be root pruned, if necessary, to fit the hole. The root collar shall be 20 inches below the root collar.

# REFORESTATION

□ TREE REFORESTATION SHALL BE PLANTED 6 FT. TO 10 FT. ON CENTER, RANDOM SPACING, AVERAGING 8 FT. ON CENTER, APPROXIMATELY 680 PLANTS PER ACRE.

REFORESTATION MIXTURE, TYPE, SIZE, AND FURNISH SHALL CONFORM TO THE FOLLOWING:	
25% QUERCUS NIGRA	WATER OAK 12 in. - 18 in ER
25% QUERCUS PHELLOS	WILLOW OAK 12 in. - 18 in ER
25% BETULA NIGRA	RIVER BIRCH 12 in. - 18 in ER
25% FRAXINUS PENNSYLVANICA	GREEN ASH 12 in. - 18 in ER

# REFORESTATION DETAIL SHEET

N.C.D.O.T. - ROADSIDE ENVIRONMENTAL UNIT

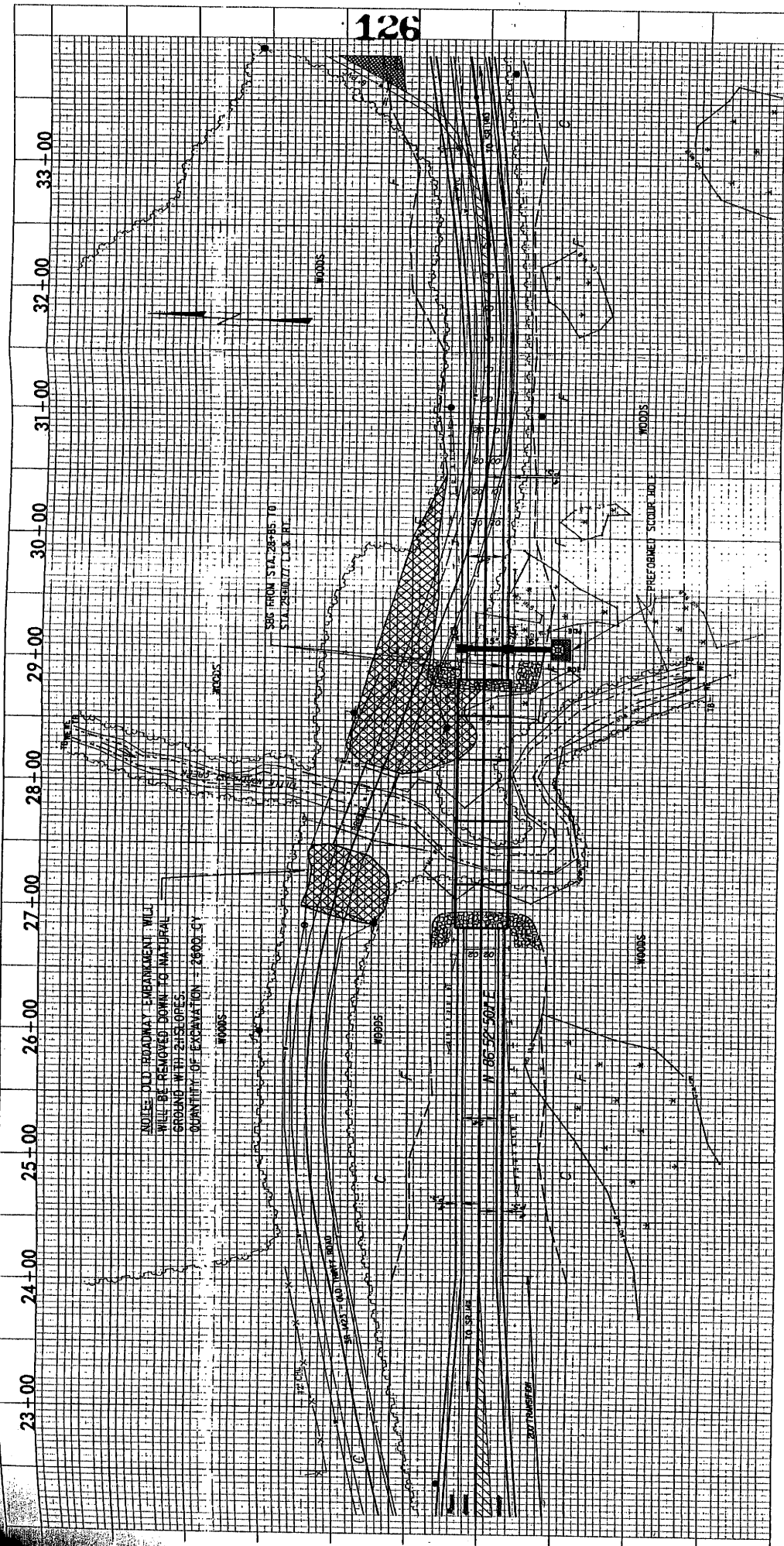

NOTE: OLD ROADWAY EMBANKMENT WILL  
 BE REMOVED DOWN TO NATURAL  
 GRADING WITH 2:1 SLOPES.  
 QUANTITY OF EXCAVATION - 2600 CY

SUB FROM STA. 28+85 TO  
 STA. 29+07.7 (L.S. & R.)

PREFORMED SCOUR HOLE

WOODS

WOODS

WOODS

TO SOLAR

TO SOLAR

TO TRANSFER

WB9985

23+00

24+00

25+00

26+00

27+00

28+00

29+00

30+00

31+00

32+00

33+00

NATIONWIDE PERMIT 23  
DEPARTMENT OF THE ARMY  
CORPS OF ENGINEERS  
FINAL NOTICE OF ISSUANCE AND MODIFICATION OF NATIONWIDE PERMITS  
FEDERAL REGISTER  
AUTHORIZED MARCH 18, 2002

**Approved Categorical Exclusions:** Activities undertaken, assisted, authorized, regulated, funded, or financed, in whole or in part, by another Federal agency or department where that agency or department has determined, pursuant to the Council on Environmental Quality Regulation for Implementing the Procedural Provisions of the National Environmental Policy Act (NEPA) (40 CFR part 1500 et seq.), that the activity, work, or discharge is categorically excluded from environmental documentation because it is included within a category of actions which neither individually nor cumulatively have a significant effect on the human environment, and the Office of the Chief of Engineers (ATTN: CECW-OR) has been furnished notice of the agency's or department's application for the categorical exclusion and concurs with that determination. Before to approval for purposes of this nationwide permit of any agency's categorical exclusions, the Chief of Engineers will solicit public comment. In addressing these comments, the Chief of Engineers may require certain conditions for authorization of an agency's categorical exclusions under this nationwide permit. (Sections 10 and 404)

**NATIONWIDE PERMIT GENERAL CONDITIONS**

The following General Conditions must be followed in order for any authorization by a NWP to be valid:

1. Navigation. No activity may cause more than a minimal adverse effect on navigation.
2. Proper Maintenance. Any structure or fill authorized shall be properly maintained, including maintenance to ensure public safety.
3. Soil Erosion and Sediment Controls. Appropriate soil erosion and sediment controls must be used and maintained in effective operating condition during construction, and all exposed soil and other fills, as well as any work below the ordinary high water mark or high tide line, must be permanently stabilized at the earliest practicable date. Permittees are encouraged to perform work within waters of the United States during periods of low-flow or no-flow.
4. Aquatic Life Movements. No activity may substantially disrupt the necessary life-cycle movements of those species of aquatic life indigenous to the waterbody, including those species that normally migrate through the area, unless the activity's primary purpose is to impound water. Culverts placed in streams must be installed to maintain low flow conditions.
5. Equipment. Heavy equipment working in wetlands must be placed on mats, or other measures must be taken to minimize soil disturbance.
6. Regional and Case-By-Case Conditions. The activity must comply with any regional conditions that may have been added by the Division Engineer (see 33 CFR 330.4(e)) and with any case specific conditions added by the Corps or by the state or tribe in its Section 401 Water Quality Certification and Coastal Zone Management Act consistency determination.
7. Wild and Scenic Rivers. No activity may occur in a component of the National Wild and Scenic River System; or in a river officially designated by Congress as a 'study river" for possible inclusion in the system, while the river is in an official study status; unless the appropriate Federal agency, with direct management responsibility for such river, has determined in writing that the proposed activity will not adversely affect the Wild and Scenic River designation, or study status. Information on Wild and Scenic Rivers may be obtained from the appropriate Federal land management agency in the area (e.g., National Park Service, U.S. Forest Service, Bureau of Land Management, U.S. Fish and Wildlife Service).
8. Tribal Rights. No activity or its operation may impair reserved tribal rights, including, but not limited to, reserved water rights and treaty fishing and hunting rights.
9. Water Quality.

a. In certain states and tribal lands an individual 401 Water Quality Certification must be obtained or waived (See 33 CFR 330.4(c)).

b. For NWPs 12, 14, 17, 18, 32, 39, 40, 42, 43, and 44, where the state or tribal 401 certification (either generically or individually) does not require or approve water quality management measures, the permittee must provide water quality management measures that will ensure that the authorized work does not result in more than minimal degradation of water quality (or the Corps determines that compliance with state or local standards, where applicable, will ensure no more than minimal adverse effect on water quality). An important component of water quality management includes stormwater management that minimizes degradation of the downstream aquatic system, including water quality (refer to General Condition 21 for stormwater management requirements). Another important component of water quality management is the establishment and maintenance of vegetated buffers next to open waters, including streams (refer to General Condition 19 for vegetated buffer requirements for the NWPs).

This condition is only applicable to projects that have the potential to affect water quality. While appropriate measures must be taken, in most cases it is not necessary to conduct detailed studies to identify such measures or to require monitoring.

10. Coastal Zone Management. In certain states, an individual state coastal zone management consistency concurrence must be obtained or waived (see 33 CFR 330.4(d)).

#### 11. Endangered Species.

a. No activity is authorized under any NWP which is likely to jeopardize the continued existence of a threatened or endangered species or a species proposed for such designation, as identified under the Federal Endangered Species Act (ESA), or which will destroy or adversely modify the critical habitat of such species. Non-federal permittees shall notify the District Engineer if any listed species or designated critical habitat might be affected or is in the vicinity of the project, or is located in the designated critical habitat and shall not begin work on the activity until notified by the District Engineer that the requirements of the ESA have been satisfied and that the activity is authorized. For activities that may affect Federally-listed endangered or threatened species or designated critical habitat, the notification must include the name(s) of the endangered or threatened species that may be affected by the proposed work or that utilize the designated critical habitat that may be affected by the proposed work. As a result of formal or informal consultation with the FWS or NMFS the District Engineer may add species-specific regional endangered species conditions to the NWPs.

b. Authorization of an activity by a NWP does not authorize the "take" of a threatened or endangered species as defined under the ESA. In the absence of separate authorization (e.g., an ESA Section 10 Permit, a Biological Opinion with "incidental take" provisions, etc.) from the USFWS or the NMFS, both lethal and non-lethal "takes" of protected species are in violation of the ESA. Information on the location of threatened and endangered species and their critical

habitat can be obtained directly from the offices of the USFWS and NMFS or their World Wide Web pages at <http://www.fws.gov/r9endspp/endspp.html> and <http://www.nfms.noaa.gov/protres/overview/es.html> respectively.

12. Historic Properties. No activity that may affect historic properties listed, or eligible for listing, in the National Register of Historic Places is authorized, until the District Engineer has complied with the provisions of 33 CFR part 325, Appendix C.\* The prospective permittee must notify the District Engineer if the authorized activity may affect any historic properties listed, determined to be eligible, or which the prospective permittee has reason to believe may be eligible for listing on the National Register of Historic Places, and shall not begin the activity until notified by the District Engineer that the requirements of the National Historic Preservation Act have been satisfied and that the activity is authorized. Information on the location and existence of historic resources can be obtained from the State Historic Preservation Office and the National Register of Historic Places (see 33 CFR 330.4(g)). For activities that may affect historic properties listed in, or eligible for listing in, the National Register of Historic Places, the notification must state which historic property may be affected by the proposed work or include a vicinity map indicating the location of the historic property.

\* 13. Notification.

a. Timing; where required by the terms of the NWP, the prospective permittee must notify the District Engineer with a preconstruction notification (PCN) as early as possible. The District Engineer must determine if the notification is complete within 30 days of the date of receipt and can request additional information necessary to make the PCN complete only once. However, if the prospective permittee does not provide all of the requested information, then the District Engineer will notify the prospective permittee that the notification is still incomplete and the PCN review process will not commence until all of the requested information has been received by the District Engineer. The prospective permittee shall not begin the activity:

1. Until notified in writing by the District Engineer that the activity may proceed under the NWP with any special conditions imposed by the District or Division Engineer; or

2. If notified in writing by the District or Division Engineer that an Individual Permit is required; or

3. Unless 45 days have passed from the District Engineer's receipt of the complete notification and the prospective permittee has not received written notice from the District or Division Engineer. Subsequently, the permittee's right to proceed under the NWP may be modified, suspended, or revoked only in accordance with the procedure set forth in 33 CFR 330.5(d)(2).

b. Contents of Notification: The notification must be in writing and include the following information:

1. Name, address and telephone numbers of the prospective permittee;

2. Location of the proposed project;

3. Brief description of the proposed project; the project's purpose; direct and indirect adverse environmental effects the project would cause; any other NWP(s), Regional General Permit(s), or Individual Permit(s) used or intended to be used to authorize any part of the proposed project or any related activity. Sketches should be provided when necessary to show that the activity complies with the terms of the NWP (Sketches usually clarify the project and when provided result in a quicker decision.);

4. For NWPs 7, 12, 14, 18, 21, 34, 38, 39, 40, 41, 42, and 43, the PCN must also include a delineation of affected special aquatic sites, including wetlands, vegetated shallows (e.g., submerged aquatic vegetation, seagrass beds), and riffle and pool complexes (see paragraph 13(f));

5. For NWP 7 (Cutfall Structures and Maintenance), the PCN must include information regarding the original design capacities and configurations of those areas of the facility where maintenance dredging or excavation is proposed;

6. For NWP 14 (Linear Transportation Projects), the PCN must include a compensatory mitigation proposal to offset permanent losses of waters of the US and a statement describing how temporary losses of waters of the US will be minimized to the maximum extent practicable;

7. For NWP 21 (Surface Coal Mining Activities), the PCN must include an Office of Surface Mining (OSM) or state-approved mitigation plan, if applicable. To be authorized by this NWP, the District Engineer must determine that the activity complies with the terms and conditions of the NWP and that the adverse environmental effects are minimal both individually and cumulatively and must notify the project sponsor of this determination in writing;

8. For NWP 27 (Stream and Wetland Restoration Activities), the PCN must include documentation of the prior condition of the site that will be reverted by the permittee;

9. For NWP 29 (Single-Family Housing), the PCN must also include:

i. Any past use of this NWP by the Individual Permittee and/or the permittee's spouse;

ii. A statement that the single-family housing activity is for a personal residence of the permittee;

iii. A description of the entire parcel, including its size, and a delineation of wetlands. For the purpose of this NWP, parcels of land measuring  $\frac{1}{4}$ -acre or less will not require a formal on-site delineation. However, the applicant shall provide an indication of where the wetlands are and the amount of wetlands that exists on the property. For parcels greater than



\1/4\-acre in size, formal wetland delineation must be prepared in accordance with the current method required by the Corps. (See paragraph 13(f));

iv. A written description of all land (including, if available, legal descriptions) owned by the prospective permittee and/or the prospective permittee's spouse, within a one mile radius of the parcel, in any form of ownership (including any land owned as a partner, corporation, joint tenant, co-tenant, or as a tenant-by-the-entirety) and any land on which a purchase and sale agreement or other contract for sale or purchase has been executed;

10. For NWP 31 (Maintenance of Existing Flood Control Facilities), the prospective permittee must either notify the District Engineer with a PCN prior to each maintenance activity or submit a five-year (or less) maintenance plan. In addition, the PCN must include all of the following:

i. Sufficient baseline information identifying the approved channel depths and configurations and existing facilities. Minor deviations are authorized, provided the approved flood control protection or drainage is not increased;

ii. A delineation of any affected special aquatic sites, including wetlands; and,

iii. Location of the dredged material disposal site;

11. For NWP 33 (Temporary Construction, Access, and Dewatering), the PCN must also include a restoration plan of reasonable measures to avoid and minimize adverse effects to aquatic resources;

12. For NWPs 39, 43 and 44, the PCN must also include a written statement to the District Engineer explaining how avoidance and minimization for losses of waters of the US were achieved on the project site;

13. For NWP 39 and NWP 42, the PCN must include a compensatory mitigation proposal to offset losses of waters of the US or justification explaining why compensatory mitigation should not be required. For discharges that cause the loss of greater than 300 linear feet of an intermittent stream bed, to be authorized, the District Engineer must determine that the activity complies with the other terms and conditions of the NWP, determine adverse environmental effects are minimal both individually and cumulatively, and waive the limitation on stream impacts in writing before the permittee may proceed;

14. For NWP 40 (Agricultural Activities), the PCN must include a compensatory mitigation proposal to offset losses of waters of the US. This NWP does not authorize the relocation of greater than 300 linear feet of existing serviceable drainage ditches constructed in non-tidal streams unless, for drainage ditches constructed in intermittent nontidal streams, the District Engineer waives this criterion in writing, and the District Engineer has determined that the project complies with all terms and conditions of this NWP, and that any adverse impacts of the project on the aquatic environment are minimal, both individually and cumulatively;

15. For NWP 43 (Stormwater Management Facilities), the PCN must include, for the construction of new stormwater management facilities, a maintenance plan (in accordance with state and local requirements, if applicable) and a compensatory mitigation proposal to offset losses of waters of the US. For discharges that cause the loss of greater than 300 linear feet of an intermittent stream bed, to be authorized, the District Engineer must determine that the activity complies with the other terms and conditions of the NWP, determine adverse environmental effects are minimal both individually and cumulatively, and waive the limitation on stream impacts in writing before the permittee may proceed;

16. For NWP 44 (Mining Activities), the PCN must include a description of all waters of the US adversely affected by the project, a description of measures taken to minimize adverse effects to waters of the US, a description of measures taken to comply with the criteria of the NWP, and a reclamation plan (for all aggregate mining activities in isolated waters and non-tidal wetlands adjacent to headwaters and any hard rock/mineral mining activities);

17. For activities that may adversely affect Federally-listed endangered or threatened species, the PCN must include the name(s) of those endangered or threatened species that may be affected by the proposed work or utilize the designated critical habitat that may be affected by the proposed work; and

18. For activities that may affect historic properties listed in, or eligible for listing in, the National Register of Historic Places, the PCN must state which historic property may be affected by the proposed work or include a vicinity map indicating the location of the historic property.

c. Form of Notification: The standard Individual Permit application form (Form ENG 4345) may be used as the notification but must clearly indicate that it is a PCN and must include all of the information required in (b) (1)-(18) of General Condition 13. A letter containing the requisite information may also be used.

d. District Engineer's Decision: In reviewing the PCN for the proposed activity, the District Engineer will determine whether the activity authorized by the NWP will result in more than minimal individual or cumulative adverse environmental effects or may be contrary to the public interest. The prospective permittee may submit a proposed mitigation plan with the PCN to expedite the process. The District Engineer will consider any proposed compensatory mitigation the applicant has included in the proposal in determining whether the net adverse environmental effects to the aquatic environment of the proposed work are minimal. If the District Engineer determines that the activity complies with the terms and conditions of the NWP and that the adverse effects on the aquatic environment are minimal, after considering mitigation, the District Engineer will notify the permittee and include any conditions the District Engineer deems necessary. The District Engineer must approve any compensatory mitigation proposal before the permittee commences work. If the prospective permittee is required to submit a compensatory mitigation proposal with the PCN, the proposal may be either conceptual or detailed. If the prospective permittee elects to submit a compensatory mitigation plan with the

PCN, the District Engineer will expeditiously review the proposed compensatory mitigation plan. The District Engineer must review the plan within 45 days of receiving a complete PCN and determine whether the conceptual or specific proposed mitigation would ensure no more than minimal adverse effects on the aquatic environment. If the net adverse effects of the project on the aquatic environment (after consideration of the compensatory mitigation proposal) are determined by the District Engineer to be minimal, the District Engineer will provide a timely written response to the applicant. The response will state that the project can proceed under the terms and conditions of the NWP.

If the District Engineer determines that the adverse effects of the proposed work are more than minimal, then the District Engineer will notify the applicant either:

1. That the project does not qualify for authorization under the NWP and instruct the applicant on the procedures to seek authorization under an Individual Permit;
2. that the project is authorized under the NWP subject to the applicant's submission of a mitigation proposal that would reduce the adverse effects on the aquatic environment to the minimal level; or
3. that the project is authorized under the NWP with specific modifications or conditions. Where the District Engineer determines that mitigation is required to ensure no more than minimal adverse effects occur to the aquatic environment, the activity will be authorized within the 45-day PCN period. The authorization will include the necessary conceptual or specific mitigation or a requirement that the applicant submit a mitigation proposal that would reduce the adverse effects on the aquatic environment to the minimal level. When conceptual mitigation is included, or a mitigation plan is required under item (2) above, no work in waters of the US will occur until the District Engineer has approved a specific mitigation plan.

e. Agency Coordination: The District Engineer will consider any comments from Federal and state agencies concerning the proposed activity's compliance with the terms and conditions of the NWPs and the need for mitigation to reduce the project's adverse environmental effects to a minimal level.

For activities requiring notification to the District Engineer that result in the loss of greater than 1/2-acre of waters of the US, the District Engineer will provide immediately (e.g., via facsimile transmission, overnight mail, or other expeditious manner) a copy to the appropriate Federal or state offices (USFWS, state natural resource or water quality agency, EPA, State Historic Preservation Officer (SHPO), and, if appropriate, the NMFS). With the exception of NWP 37, these agencies will then have 10 calendar days from the date the material is transmitted to telephone or fax the District Engineer notice that they intend to provide substantive, site-specific comments. If so contacted by an agency, the District Engineer will wait an additional 15 calendar days before making a decision on the notification. The District Engineer will fully consider agency comments received within the specified time frame, but will provide no response to the resource agency, except as provided below. The District Engineer will indicate in the administrative record associated with each notification that the resource agencies'

concerns were considered. As required by section 305(b)(4)(B) of the Magnuson-Stevens Fishery Conservation and Management Act, the District Engineer will provide a response to NMFS within 30 days of receipt of any Essential Fish Habitat conservation recommendations. Applicants are encouraged to provide the Corps multiple copies of notifications to expedite agency notification.

f. Wetland Delineations: Wetland delineations must be prepared in accordance with the current method required by the Corps (For NWP 29 see paragraph (b)(9)(iii) for parcels less than  $\frac{1}{4}$ -acre in size). The permittee may ask the Corps to delineate the special aquatic site. There may be some delay if the Corps does the delineation. Furthermore, the 45-day period will not start until the wetland delineation has been completed and submitted to the Corps, where appropriate.

\* 14. Compliance Certification. Every permittee who has received NWP verification from the Corps will submit a signed certification regarding the completed work and any required mitigation. The certification will be forwarded by the Corps with the authorization letter and will include:

a. A statement that the authorized work was done in accordance with the Corps authorization, including any general or specific conditions;

b. A statement that any required mitigation was completed in accordance with the permit conditions; and

c. The signature of the permittee certifying the completion of the work and mitigation.

15. Use of Multiple Nationwide Permits. The use of more than one NWP for a single and complete project is prohibited, except when the acreage loss of waters of the US authorized by the NWPs does not exceed the acreage limit of the NWP with the highest specified acreage limit (e.g. if a road crossing over tidal waters is constructed under NWP 14, with associated bank stabilization authorized by NWP 13, the maximum acreage loss of waters of the US for the total project cannot exceed  $\frac{1}{3}$ -acre).

16. Water Supply Intakes. No activity, including structures and work in navigable waters of the US or discharges of dredged or fill material, may occur in the proximity of a public water supply intake except where the activity is for repair of the public water supply intake structures or adjacent bank stabilization.

17. Shellfish Beds. No activity, including structures and work in navigable waters of the US or discharges of dredged or fill material, may occur in areas of concentrated shellfish populations, unless the activity is directly related to a shellfish harvesting activity authorized by NWP 4.

18. Suitable Material. No activity, including structures and work in navigable waters of the US or discharges of dredged or fill material, may consist of unsuitable material (e.g., trash,

debris, car bodies, asphalt, etc.) and material used for construction or discharged must be free from toxic pollutants in toxic amounts (see section 307 of the CWA).

19. Mitigation. The District Engineer will consider the factors discussed below when determining the acceptability of appropriate and practicable mitigation necessary to offset adverse effects on the aquatic environment that are more than minimal.

a. The project must be designed and constructed to avoid and minimize adverse effects to waters of the US to the maximum extent practicable at the project site (i.e., on site).

b. Mitigation in all its forms (avoiding, minimizing, rectifying, reducing or compensating) will be required to the extent necessary to ensure that the adverse effects to the aquatic environment are minimal.

c. Compensatory mitigation at a minimum one-for-one ratio will be required for all wetland impacts requiring a PCN, unless the District Engineer determines in writing that some other form of mitigation would be more environmentally appropriate and provides a project-specific waiver of this requirement. Consistent with National policy, the District Engineer will establish a preference for restoration of wetlands as compensatory mitigation, with preservation used only in exceptional circumstances.

d. Compensatory mitigation (i.e., replacement or substitution of aquatic resources for those impacted) will not be used to increase the acreage losses allowed by the acreage limits of some of the NWPs. For example,  $\frac{1}{4}$ -acre of wetlands cannot be created to change a  $\frac{3}{4}$ -acre loss of wetlands to a  $\frac{1}{2}$ -acre loss associated with NWP 39 verification. However,  $\frac{1}{2}$ -acre of created wetlands can be used to reduce the impacts of a  $\frac{1}{2}$ -acre loss of wetlands to the minimum impact level in order to meet the minimal impact requirement associated with NWPs.

e. To be practicable, the mitigation must be available and capable of being done considering costs, existing technology, and logistics in light of the overall project purposes. Examples of mitigation that may be appropriate and practicable include, but are not limited to: reducing the size of the project; establishing and maintaining wetland or upland vegetated buffers to protect open waters such as streams; and replacing losses of aquatic resource functions and values by creating, restoring, enhancing, or preserving similar functions and values, preferably in the same watershed.

f. Compensatory mitigation plans for projects in or near streams or other open waters will normally include a requirement for the establishment, maintenance, and legal protection (e.g., easements, deed restrictions) of vegetated buffers to open waters. In many cases, vegetated buffers will be the only compensatory mitigation required. Vegetated buffers should consist of native species. The width of the vegetated buffers required will address documented water quality or aquatic habitat loss concerns. Normally, the vegetated buffer will be 25 to 50 feet wide on each side of the stream, but the District Engineers may require slightly wider vegetated buffers to address documented water quality or habitat loss concerns. Where both wetlands and

open waters exist on the project site, the Corps will determine the appropriate compensatory mitigation (e.g., stream buffers or wetlands compensation) based on what is best for the aquatic environment or, a watershed basis. In cases where vegetated buffers are determined to be the most appropriate form of compensatory mitigation, the District Engineer may waive or reduce the requirement to provide wetland compensatory mitigation for wetland impacts.

g. Compensatory mitigation proposals submitted with the " notification" may be either conceptual or detailed. If conceptual plans are approved under the verification, then the Corps will condition the verification to require detailed plans be submitted and approved by the Corps prior to construction of the authorized activity in waters of the US.

h. Permittees may propose the use of mitigation banks, in-lieu fee arrangements or separate activity-specific compensatory mitigation. In all cases that require compensatory mitigation, the mitigation provisions will specify the party responsible for accomplishing and/or complying with the mitigation plan.

20. Spawning Areas. Activities, including structures and work in navigable waters of the US or discharges of dredged or fill material, in spawning areas during spawning seasons must be avoided to the maximum extent practicable. Activities that result in the physical destruction (e.g., excavate, fill, or smother downstream by substantial turbidity) of an important spawning area are not authorized.

21. Management of Water Flows. To the maximum extent practicable, the activity must be designed to maintain preconstruction downstream flow conditions (e.g., location, capacity, and flow rates). Furthermore, the activity must not permanently restrict or impede the passage of normal or expected high flows (unless the primary purpose of the fill is to impound waters) and the structure or discharge of dredged or fill material must withstand expected high flows. The activity must, to the maximum extent practicable, provide for retaining excess flows from the site, provide for maintaining surface flow rates from the site similar to preconstruction conditions, and provide for not increasing water flows from the project site, relocating water, or redirecting water flow beyond preconstruction conditions. Stream channelizing will be reduced to the minimal amount necessary, and the activity must, to the maximum extent practicable, reduce adverse effects such as flooding or erosion downstream and upstream of the project site, unless the activity is part of a larger system designed to manage water flows. In most cases, it will not be a requirement to conduct detailed studies and monitoring of water flow.

This condition is only applicable to projects that have the potential to affect waterflows. While appropriate measures must be taken, it is not necessary to conduct detailed studies to identify such measures or require monitoring to ensure their effectiveness. Normally, the Corps will defer to state and local authorities regarding management of water flow.

22. Adverse Effects From Impoundments. If the activity creates an impoundment of water, adverse effects to the aquatic system due to the acceleration of the passage of water, and/or the restricting its flow shall be minimized to the maximum extent practicable. This includes

structures and work in navigable waters of the US, or discharges of dredged or fill material.

23. Waterfowl Breeding Areas. Activities, including structures and work in navigable waters of the US or discharges of dredged or fill material, into breeding areas for migratory waterfowl must be avoided to the maximum extent practicable.

24. Removal of Temporary Fills. Any temporary fills must be removed in their entirety and the affected areas returned to their preexisting elevation.

25. Designated Critical Resource Waters. Critical resource waters include, NOAA-designated marine sanctuaries, National Estuarine Research Reserves, National Wild and Scenic Rivers, critical habitat for Federally listed threatened and endangered species, coral reefs, state natural heritage sites, and outstanding national resource waters or other waters officially designated by a state as having particular environmental or ecological significance and identified by the District Engineer after notice and opportunity for public comment. The District Engineer may also designate additional critical resource waters after notice and opportunity for comment.

a. Except as noted below, discharges of dredged or fill material into waters of the US are not authorized by NWP's 7, 12, 14, 16, 17, 21, 29, 31, 35, 39, 40, 42, 43, and 44 for any activity within, or directly affecting, critical resource waters, including wetlands adjacent to such waters. Discharges of dredged or fill materials into waters of the US may be authorized by the above NWP's in National Wild and Scenic Rivers if the activity complies with General Condition 7. Further, such discharges may be authorized in designated critical habitat for Federally listed threatened or endangered species if the activity complies with General Condition 11 and the USFWS or the NMFS has concurred in a determination of compliance with this condition.

b. For NWP's 3, 8, 10, 13, 15, 18, 19, 22, 23, 25, 27, 28, 30, 33, 34, 36, 37, and 38, notification is required in accordance with General Condition 13, for any activity proposed in the designated critical resource waters including wetlands adjacent to those waters. The District Engineer may authorize activities under these NWP's only after it is determined that the impacts to the critical resource waters will be no more than minimal.

26. Fills Within 100-Year Floodplains. For purposes of this General Condition, 100-year floodplains will be identified through the existing Federal Emergency Management Agency's (FEMA) Flood Insurance Rate Maps or FEMA-approved local floodplain maps.

a. Discharges in Floodplain; Below Headwaters. Discharges of dredged or fill material into waters of the US within the mapped 100-year floodplain, below headwaters (i.e. five cfs), resulting in permanent above-grade fills, are not authorized by NWP's 39, 40, 42, 43, and 44.

b. Discharges in Floodway; Above Headwaters. Discharges of dredged or fill material into waters of the US within the FEMA or locally mapped floodway, resulting in permanent above-grade fills, are not authorized by NWP's 39, 40, 42, and 44.

c. The permittee must comply with any applicable FEMA-approved state or local

floodplain management requirements.

27. **Construction Period.** For activities that have not been verified by the Corps and the project was commenced or under contract to commence by the expiration date of the NWP (or modification or revocation date), the work must be completed within 12-months after such date (including any modification that affects the project).

For activities that have been verified and the project was commenced or under contract to commence within the verification period, the work must be completed by the date determined by the Corps.

For projects that have been verified by the Corps, an extension of a Corps approved completion date maybe requested. This request must be submitted at least one month before the previously approved completion date.

### **FURTHER INFORMATION**

1. District Engineers have authority to determine if an activity complies with the terms and conditions of a NWP.
2. NWPs do not obviate the need to obtain other Federal, State, or local permits, approvals, or authorizations required by law.
3. NWPs do not grant any property rights or exclusive privileges.
4. NWPs do not authorize any injury to the property or rights of others.
5. NWPs do not authorize interference with any existing or proposed Federal project.

### **DEFINITIONS**

***Best Management Practices (BMPs):*** BMPs are policies, practices, procedures, or structures implemented to mitigate the adverse environmental effects on surface water quality resulting from development. BMPs are categorized as structural or nonstructural. A BMP policy may affect the limits on a development.

***Compensatory Mitigation:*** For purposes of Section 10/404, compensatory mitigation is the restoration, creation, enhancement, or in exceptional circumstances, preservation of wetlands and/or other aquatic resources for the purpose of compensating for unavoidable adverse impacts, which remain, after all appropriate and practicable avoidance and minimization has been achieved.

***Creation:*** The establishment of a wetland or other aquatic resource where one did not formerly



exist.

*Enhancement:* Activities conducted in existing wetlands or other aquatic resources that increase one or more aquatic functions.

*Ephemeral Stream:* An ephemeral stream has *flowing* water only during and for a short duration after, precipitation events in a typical year. Ephemeral stream beds are located above the water table year-round. Groundwater is not a source of water for the stream. Runoff from rainfall is the primary source of water for stream flow.

*Farm Tract:* A unit of contiguous land under one ownership that is operated as a farm or part of a farm.

*Flood Fringe:* That portion of the 100-year floodplain outside of the floodway (often referred to as “floodway fringe”).

*Floodway:* The area regulated by Federal, state, or local requirements to provide for the discharge of the base flood so the cumulative increase in water surface elevation is no more than a designated amount (not to exceed one foot as set by the National Flood Insurance Program) within the 100-year floodplain.

*Independent Utility:* A test to determine what constitutes a single and complete project in the Corps regulatory program. A project is considered to have independent utility if it would be constructed absent the construction of other projects in the project area. Portions of a multi-phase project that depend upon other phases of the project do not have independent utility. Phases of a project that would be constructed even if the other phases were not built can be considered as separate single and complete projects with independent utility.

Intermittent Stream: An intermittent stream has flowing water during certain times of the year, when groundwater provides water for stream flow. During dry periods, intermittent streams may not have flowing water. Runoff from rainfall is a supplemental source of water for stream flow.

Loss of waters of the US: Waters of the US that include the filled area and other waters that are permanently adversely affected by flooding, excavation, or drainage because of the regulated activity. Permanent adverse effects include permanent above-grade, at-grade, or below-grade fills that change an aquatic area to dry land, increase the bottom elevation of a waterbody, or change the use of a waterbody. The acreage of loss of waters of the US is the threshold measurement of the impact to existing waters for determining whether a project may qualify for a NWP; it is not a net threshold that is calculated after considering compensatory mitigation that may be used to offset losses of aquatic functions and values. The loss of stream bed includes the linear feet of stream bed that is filled or excavated. Waters of the US temporarily filled, flooded, excavated, or drained, but restored to preconstruction contours and elevations after construction, are not included in the measurement of loss of waters of the US. Impacts to ephemeral waters are only not included in the acreage or linear foot measurements of loss of waters of the US or loss of stream bed, for the purpose of determining compliance with the threshold limits of the NWPs.

Non-tidal Wetland: An area that, during a year with normal patterns of precipitation has standing or flowing water for sufficient duration to establish an ordinary high water mark. Aquatic vegetation within the area of standing or flowing water is either non-emergent, sparse, or absent. Vegetated shallows are considered to be open waters. The term "open water" includes rivers, streams, lakes, and ponds. For the purposes of the NWPs, this term does not include ephemeral waters.

Perennial Stream: A perennial stream has flowing water year-round during a typical year. The water table is located above the stream bed for the most of the year. Groundwater is the primary source of water for stream flow. Runoff from rainfall is a supplemental source of water for stream flow.

Permanent Above-grade Fill: A discharge of dredged or fill material into waters of the US, including wetlands, that results in a substantial increase in ground elevation and permanently converts part or all of the waterbody to dry land. Structural fills authorized by NWPs 3, 25, 36, etc. are not included.

Preservation: The protection of ecologically important wetlands or other aquatic resources in perpetuity through the implementation of appropriate legal and physical mechanisms. Preservation may include protection of upland areas adjacent to wetlands as necessary to ensure protection and/or enhancement of the overall aquatic ecosystem.

Restoration: Re-establishment of wetland and/or other aquatic resource characteristics and function(s) at a site where they have ceased to exist, or exist in a substantially degraded state.

Riffle and Pool Complex: Riffle and pool complexes are special aquatic sites under the

404(b)(1) Guidelines. Riffle and pool complexes sometimes characterize steep gradient sections of streams. Such stream sections are recognizable by their hydraulic characteristics. The rapid movement of water over a coarse substrate in riffles results in a rough flow, a turbulent surface and high dissolved oxygen levels in the water. Pools are deeper areas associated with riffles. A slower stream velocity, a streaming flow, a smooth surface, and a finer substrate characterize pools.

**Single and Complete Project:** The term “single and complete project” is defined at 33 CFR 330.2(i) as the total project proposed or accomplished by one owner/developer or partnership or other association of owners/developers (see definition of independent utility). For linear projects, the “single and complete project” (i.e., a single and complete crossing) will apply to each crossing of a separate water of the US (i.e., a single waterbody) at that location. An exception is for linear projects crossing a single waterbody several times at separate and distant locations; each crossing is considered a single and complete project. However, individual channels in a braided stream or river, or individual arms of a large, irregularly shaped wetland or lake, etc., are not separate waterbodies.

**Stormwater Management:** Stormwater management is the mechanism for controlling stormwater runoff for the purposes of reducing downstream erosion, water quality degradation, and flooding and mitigating the adverse effects of changes in land use on the aquatic environment.

**Stormwater Management Facilities:** Stormwater management facilities are those facilities, including but not limited to, stormwater retention and detention ponds and BMPs, which retain water for a period of time to control runoff and/or improve the quality (i.e., by reducing the concentration of nutrients, sediments, hazardous substances and other pollutants) of stormwater runoff.

**Stream Channelization:** The manipulation of a stream channel to increase the rate of water flow through the stream channel. Manipulation may include deepening, widening, straightening, armoring, or other activities that change the stream cross-section or other aspects of stream channel geometry to increase the rate of water flow through the stream channel. A channelized stream remains a water of the US, despite the modifications to increase the rate of water flow.

**Tidal Wetland:** A tidal wetland is a wetland (i.e., water of the US) that is inundated by tidal waters. The definitions of a wetland and tidal waters can be found at 33 CFR 328.3(b) and 33 CFR 328.3(f), respectively. Tidal waters rise and fall in a predictable and measurable rhythm or cycle due to the gravitational pulls of the moon and sun. Tidal waters end where the rise and fall of the water surface can no longer be practically measured in a predictable rhythm due to masking by other waters, wind, or other effects. Tidal wetlands are located channelward of the high tide line (i.e., spring high tide line) and are inundated by tidal waters two times per lunar month, during spring high tides.

**Vegetated Buffer:** A vegetated upland or wetland area next to rivers, streams, lakes, or other open waters, which separates the open water from developed areas, including agricultural land. Vegetated buffers provide a variety of aquatic habitat functions and values (e.g., aquatic habitat

for fish and other aquatic organisms, moderation of water temperature changes, and detritus for aquatic food webs) and help improve or maintain local water quality. A vegetated buffer can be established by maintaining an existing vegetated area or planting native trees, shrubs, and herbaceous plants on land next to openwaters. Mowed lawns are not considered vegetated buffers because they provide little or no aquatic habitat functions and values. The establishment and maintenance of vegetated buffers is a method of compensatory mitigation that can be used in conjunction with the restoration, creation, enhancement or preservation of aquatic habitats to ensure that activities authorized by NWP result in minimal adverse effects to the aquatic environment. (See General Condition 19.)

***Vegetated Shallows:*** Vegetated shallows are special aquatic sites under the 404(b)(1) Guidelines. They are areas that are permanently inundated and under normal circumstances have rooted aquatic vegetation, such as seagrasses in marine and estuarine systems and a variety of vascular rooted plants in freshwater systems.

***Waterbody:*** A waterbody is any area that in a normal year has water flowing or standing above ground to the extent that evidence of an ordinary high water mark is established. Wetlands contiguous to the waterbody are considered part of the waterbody.

### **FINAL REGIONAL CONDITIONS FOR NATIONWIDE PERMITS IN THE WILMINGTON DISTRICT**

#### 1. Waters Excluded from NWP or Subject to Additional Notification Requirements:

a. The Corps identified waters that will be excluded from use of this NWP. These waters are:

1. Discharges into Waters of the United States designated by either the North Carolina Division of Marine Fisheries (NCDMF) or the North Carolina Wildlife Resources Commission (NCWRC) as anadromous fish spawning area are prohibited during the period between February 15 and June 30, without prior written approval from NCDMF or NCWRC and the Corps.

2. Discharges into Waters of the United States designated as sturgeon spawning areas are prohibited during the period between February 1 and June 30, without prior written approval from the National Marine Fisheries Service (NMFS).

\* b. The Corps identified waters that will be subject to additional notification requirements for activities authorized by this NWP. These waters are:

1. Prior to the use of any NWP in any of the following North Carolina *designated waters*, applicants must comply with Nationwide Permit General Condition 13. In addition, the applicant must furnish a written statement of compliance with all of the conditions of the applicable Nationwide Permit. The North Carolina *designated waters* that require additional notification requirements are "Outstanding Resource Waters" (ORW) and "High Quality

Waters” (HQW) (as defined by the North Carolina Division of Water Quality), or “Inland Primary Nursery Areas” (IPNA) (as defined by the North Carolina Wildlife Resources Commission), or contiguous wetlands (as defined by the North Carolina Division of Water Quality), or “Primary Nursery Areas” (PNA) (as defined by the North Carolina Division of Marine Fisheries).

2. Applicants for any NWP in a designated “Area of Environmental Concern” (AEC) in the twenty (20) coastal counties of Eastern North Carolina covered by the North Carolina Coastal Area Management Act (CAMA), must also obtain the required CAMA permit. Construction activities may not commence until a copy of the approved CAMA permit is furnished to the appropriate Wilmington District Regulatory Field Office (Wilmington Field Office – P.O. Box 1890, Wilmington, NC 28402 or Washington Field Office – P.O. Box 1000, Washington, NC 27889) for authorization to begin work.

3. Prior to the use of any NWP on a Barrier Island of North Carolina, applicants must comply with Nationwide Permit General Condition 13. In addition, the applicant shall furnish a written statement of compliance with all of the conditions listed of the applicable Nationwide Permit.

4. Prior to the use of any NWP in a “Mountain or Piedmont Bog” of North Carolina, applicants shall comply with Nationwide Permit General Condition 13. In addition, the applicant shall furnish a written statement of compliance with all of the conditions listed of the applicable NWP.

Note: The following wetland community types identified in the N.C. Natural Heritage Program document, “Classification of Natural communities of North Carolina (Michael P. Schafale and Alan S. Weakley, 1990), are subject to this regional condition.

Mountain Bogs

Swamp Forest-Bog Complex  
Swamp Forest-Bog Complex (Spruce Subtype)  
Southern Appalachian Bog (Northern Subtype)  
Southern Appalachian Bog (Southern Subtype)  
Southern Appalachian Fen

Piedmont Bogs

Upland Depression Swamp Forest

5. Prior to the use of any NWP in Mountain Trout Waters within twenty-five (25) designated counties of North Carolina, applicants shall comply with Nationwide General Condition 13. In addition, the applicant shall furnish a written statement of compliance with all of the conditions listed of the applicable NWP. Notification will include a letter of comments and recommendations from the North Carolina Wildlife Resources Commission (NCWRC), the

location of work, a delineation of wetlands, a discussion of alternatives to working in the Mountain Trout Waters, why other alternatives were not selected, and a plan to provide compensatory mitigation for all unavoidable adverse impacts to the Mountain Trout Waters. To facilitate coordination with the NCWRC, the proponent may provide a copy of the notification to the NCWRC concurrent with the notification to the District Engineer. The NCWRC will respond both to the proponent and directly to the Corps of Engineers.

The twenty-five (25) designated counties are:

Alleghany	Ashe	Avery	Yancey
Buncombe	Burke	Caldwell	Wilkes
Cherokee	Clay	Graham	Swain
Haywood	Henderson	Jackson	Surry
Macon	Madison	McDowell	Stokes
Mitchell	Polk	Rutherford	
Transylvania	Watauga		

6. Applicants shall notify the NCDENR Shellfish Sanitation Section prior to dredging in or removing sediment from an area closed to shell fishing where the effluent may be released to an area open for shell fishing or swimming in order to avoid contamination of the disposal area and allow a temporary shellfish closure to be made. Any disposal of sand to the beach should occur between November 1 and April 30 when recreational usage is low. Only clean sand should be used and no dredged sand from closed shell fishing areas. If beach disposal was to occur at times other than stated above or if sand from a closed shell fishing area is to be used, a swim advisory shall be posted and a press release shall be made. NCDENR Shellfish Sanitation Section must be notified before commencing this activity.

2. List of Final Corps Regional Modifications and Conditions for All Nationwide Permits

a. Individual or multiple NWPs may not be used for activities that result in the cumulative loss or degradation of greater than 300 total linear feet of perennial streambed or intermittent streambed that exhibits important aquatic function(s).

b. Prior to the use of any NWP (except 13, 27, and 39) for any activity that has more than a total of 150 total linear feet of perennial streambed impacts or intermittent streambed impacts (if the intermittent stream has important aquatic function), the applicant must comply with Nationwide Permit General Condition 13. In addition, the applicant shall furnish a written statement of compliance with all of the conditions listed of the applicable NWP. Compensatory mitigation is typically required for any impact that requires such notification. [Note: The Corps uses the Intermittent Channel Evaluation Form, located with Permit Information on the Regulatory Program Web Site, to aid in the determination of the intermittent channel stream status. Also, NWPs 13, 27 and 39 have specific reporting requirements.]

c. For all Nationwide Permits which allow the use of concrete as a building material, measures will be taken to prevent live or fresh concrete, including bags of uncured concrete, from coming into contact with waters of the state until the concrete has hardened.

d. For all Nationwide Permits that allow for the use of riprap material for bank stabilization, filter cloth must be placed underneath the riprap as an additional requirement of its use in North Carolina waters.

e. For all NWP's that involve the construction of culverts, measures will be included in the construction that will promote the safe passage of fish and other aquatic organisms. All culverts in the 20 CAMA coastal counties must be buried to a depth of one foot below the

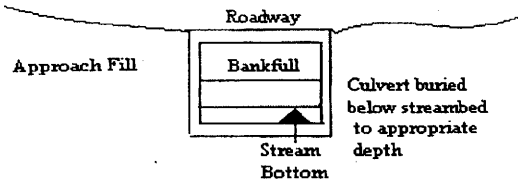

bed of the stream or wetland. For all culvert construction activities, the dimension, pattern, and profile of the stream, (above and below a pipe or culvert), should not be modified by widening the stream channel or by reducing the depth of the stream. Culvert inverts will be buried at least one foot below the bed of the stream for culverts greater than 48 inches in diameter. For culverts 48 inches in diameter or smaller, culverts must be buried below the bed of the stream to a depth equal to or greater than 20 percent of the diameter of the culvert. Bottomless arch culverts will satisfy this condition. A waiver from the depth specifications in this Regional Condition may be requested in writing. The waiver will only be issued if it can be demonstrated that the impacts of complying with this Regional Condition would result in more adverse impacts to the aquatic environment.

**NORTH CAROLINA DIVISION OF WATER QUALITY**  
**GENERAL CERTIFICATION CONDITIONS**

**GC3361**

- \*1. Proposed fill or substantial modification of wetlands or waters (including streams) under this General Certification requires notification to the Division of Water Quality. Two copies shall be submitted to DWQ at the time of notification in accordance with 15A NCAC 2H .0501(a). Written concurrence from DWQ is not required unless any standard conditions of this Certification cannot be met;
2. Appropriate sediment and erosion control practices which equal or exceed those outlined in the most recent version of the "North Carolina Sediment and Erosion Control Planning and Design Manual" or the "North Carolina Surface Mining Manual" whichever is more appropriate (available from the Division of Land Resources (DLR) in the DENR Regional or Central Offices) shall be in full compliance with all specifications governing the proper design, installation and operation and maintenance of such Best Management Practices in order to assure compliance with the appropriate turbidity water quality standard;

3. In accordance with 15A NCAC 2H .0506 (h) compensatory mitigation may be required for impacts to 150 linear feet or more of streams and/or one acre or more of wetlands. In addition, buffer mitigation may be required for any project with Buffer Rules in effect at the time of application for buffer impacts resulting from activities classified as "allowable with mitigation" within the "Table of Uses" section of the Buffer Rules or require a variance under the Buffer Rules. A determination of buffer, wetland and stream mitigation requirements shall be made for any Certification for this Nationwide Permit. The most current design and monitoring protocols from DWQ shall be followed and written plans submitted for DWQ approval as required in those protocols. When compensatory mitigation is required for a project, the mitigation plans must be approved by DWQ in writing before the impacts approved by the Certification occur. The mitigation plan must be implemented and/or constructed before any permanent building or structure on site is occupied. In the case of public road projects, the mitigation plan must be implemented before the road is opened to the traveling public;
4. Compensatory stream mitigation shall be required at a 1:1 ratio for all perennial and intermittent stream impacts equal to or exceeding 150 feet and that require application to DWQ in watersheds classified as ORW, HQW, Tr, WS-I and WS-II;
5. All sediment and erosion control measures placed in wetlands or waters shall be removed and the original grade restored within two months after the Division of Land Resources has released the project;
6. Measures shall be taken to prevent live or fresh concrete from coming into contact with waters of the state until the concrete has hardened;
7. In accordance with North Carolina General Statute Section 143-215.3D(e), any request for written concurrence for a 401 Water Quality Certification must include the appropriate fee. If a project also requires a CAMA Permit, one payment to both agencies shall be submitted and will be the higher of the two fees;
- \* 8. Impacts to any stream length in the Neuse, Tar-Pamlico, Randleman and Catawba River Basins (or any other river basins with Riparian Area Protection Rules [Buffer Rules] in effect at the time of application) requires written concurrence from DWQ in accordance with 15A NCAC 2B.0200. Activities listed as "exempt" from these rules do not need to apply for written concurrence under this Certification. New development activities located in the protected 50-foot wide riparian areas (whether jurisdictional wetlands or not) within the Neuse, Tar-Pamlico, Randleman and Catawba River Basins shall be limited to "uses" identified within and constructed in accordance with 15A NCAC 2B .0200. All new development shall be located, designed, constructed, and maintained to have minimal disturbance to protect water quality to the maximum extent practicable through the use of best management practices;
9. Additional site-specific conditions may be added to projects for which written concurrence is required or requested under this Certification in order to ensure compliance with all applicable water quality and effluent standards;



10. Concurrence from DWQ that this Certification applies to an individual project shall expire three years from the date of the cover letter from DWQ or on the same day as the expiration date of the corresponding Nationwide and Regional General Permits, whichever is sooner;

11. When written concurrence is required, the applicant is required to use the most recent version of the Certification of Completion form to notify DWQ when all work included in the 401 Certification has been completed.

**NORTH CAROLINA DIVISION OF COASTAL MANAGEMENT**  
**STATE CONSISTENCY**

Consistent.

Citations:

2002 Nationwide Permits - Federal Register Notice 15 Jan 2002

2002 Nationwide Permits Corrections - Federal Register Notice 13 Feb 2002

2002 Regional Conditions – Authorized 17 May 2002

**GENERAL CERTIFICATION FOR PROJECTS ELIGIBLE FOR CORPS OF ENGINEERS NATIONWIDE PERMIT NUMBER 23 (APPROVED CATEGORICAL EXCLUSIONS) AND RIPARIAN AREA PROTECTION RULES (BUFFER RULES)**

This General Certification is issued in conformity with the requirements of Section 401, Public Laws 92-500 and 95-217 of the United States and subject to the North Carolina Division of Water Quality Regulations in 15A NCAC 2H, Section .0500 and 15A NCAC 2B .0200 for the discharge of fill material to waters and wetland areas as described in 33 CFR 330 Appendix A (B) (23) and for the Riparian Area Protection Rules (Buffer Rules) in 15A NCAC 2B .0200. This Certification replaces Water Quality Certification Number 2670 issued on January 21, 1992, Certification Number 2734 issued on May 1 1993, Certification Number 3107 issued on February 11, 1997 and Water Quality Certification Number 3361 issued March 18, 2002. This WQC is rescinded when the Corps of Engineers re-authorizes Nationwide Permit 23 or when deemed appropriate by the Director of the DWQ.

The State of North Carolina certifies that the specified category of activity will not violate applicable portions of Sections 301, 302, 303, 306 and 307 of the Public Laws 92-500 and 95-217 if conducted in accordance with the conditions hereinafter set forth.

Conditions of Certification:

- \* 1. Proposed fill or substantial modification of wetlands or waters (including streams) under this General Certification requires notification to the Division of Water Quality. Two copies shall be submitted to DWQ at the time of notification in accordance with 15A NCAC 2H .0501(a). Written concurrence from DWQ is not required unless any standard conditions of this Certification cannot be met;
2. Appropriate sediment and erosion control practices which equal or exceed those outlined in the most recent version of the "North Carolina Sediment and Erosion Control Planning and Design Manual" or the "North Carolina Surface Mining Manual" whichever is more appropriate (available from the Division of Land Resources (DLR) in the DENR Regional or Central Offices) shall be in full compliance with all specifications governing the proper design, installation and operation and maintenance of such Best Management Practices in order to assure compliance with the appropriate turbidity water quality standard;
3. In accordance with 15A NCAC 2H .0506 (h) compensatory mitigation may be required for impacts to 150 linear feet or more of streams and/or one acre or more of wetlands. In addition, buffer mitigation may be required for any project with Buffer Rules in effect at the time of application for buffer impacts resulting from activities classified as "allowable with mitigation" within the "Table of Uses" section of the Buffer Rules or require a variance under the Buffer Rules. A determination of buffer, wetland and stream mitigation requirements shall be made for any Certification for this Nationwide Permit. The most current design and monitoring protocols from DWQ shall be followed and written plans submitted for DWQ approval as required in those protocols. When compensatory mitigation is required for a project, the mitigation plans must be approved by DWQ in writing before the impacts approved by the Certification occur. The mitigation plan must be implemented and/or constructed before any permanent building or structure on

## WQC #3403

site is occupied. In the case of public road projects, the mitigation plan must be implemented before the road is opened to the travelling public;

4. Compensatory stream mitigation shall be required at a 1:1 ratio for not only perennial but also intermittent stream impacts equal to or exceeding 150 feet and that require application to DWQ in watersheds classified as ORW, HQW, Tr, WS-I and WS-II unless the project is a linear, publicly-funded transportation project, which has a 150-foot per-stream impact allowance;
5. All sediment and erosion control measures placed in wetlands or waters shall be removed and the original grade restored within two months after the Division of Land Resources has released the project;
6. Measures shall be taken to prevent live or fresh concrete from coming into contact with freshwaters of the state until the concrete has hardened;
7. In accordance with North Carolina General Statute Section 143-215.3D(e), any request for written concurrence for a 401 Water Quality Certification must include the appropriate fee. If a project also requires a CAMA Permit, one payment to both agencies shall be submitted and will be the higher of the two fees;
- \* 8. Impacts to any stream length in the Neuse, Tar-Pamlico, Randleman and Catawba River Basins (or any other river basins with Riparian Area Protection Rules [Buffer Rules] in effect at the time of application) requires written concurrence from DWQ in accordance with 15A NCAC 2B.0200. Activities listed as "exempt" from these rules do not need to apply for written concurrence under this Certification. New development activities located in the protected 50-foot wide riparian areas (whether jurisdictional wetlands or not) within the Neuse, Tar-Pamlico, Randleman and Catawba River Basins shall be limited to "uses" identified within and constructed in accordance with 15A NCAC 2B .0200. All new development shall be located, designed, constructed, and maintained to have minimal disturbance to protect water quality to the maximum extent practicable through the use of best management practices;
9. Additional site-specific conditions may be added to projects for which written concurrence is required or requested under this Certification in order to ensure compliance with all applicable water quality and effluent standards;
10. Concurrence from DWQ that this Certification applies to an individual project shall expire three years from the date of the cover letter from DWQ or on the same day as the expiration date of the corresponding Nationwide and Regional General Permits, whichever is sooner;
11. When written concurrence is required, the applicant is required to use the most recent version of the Certification of Completion form to notify DWQ when all work included in the 401 Certification has been completed.

Non-compliance with or violation of the conditions herein set forth by a specific fill project shall result in revocation of this Certification for the project and may result in criminal and/or civil penalties.

**WQC #3403**

The Director of the North Carolina Division of Water Quality may require submission of a formal application for individual certification for any project in this category of activity that requires written concurrence under this certification, if it is determined that the project is likely to have a significant adverse effect upon water quality or degrade the waters so that existing uses of the wetland, stream or downstream waters are precluded.

Public hearings may be held for specific applications or group of applications prior to a Certification decision if deemed in the public's best interest by the Director of the North Carolina Division of Water Quality.

Effective date: March 2003

DIVISION OF WATER QUALITY

By

Alan W. Klimek, P.E.

Director

WQC # 3403