

TIP PROJECT: B-3682

CONTRACT: C201465

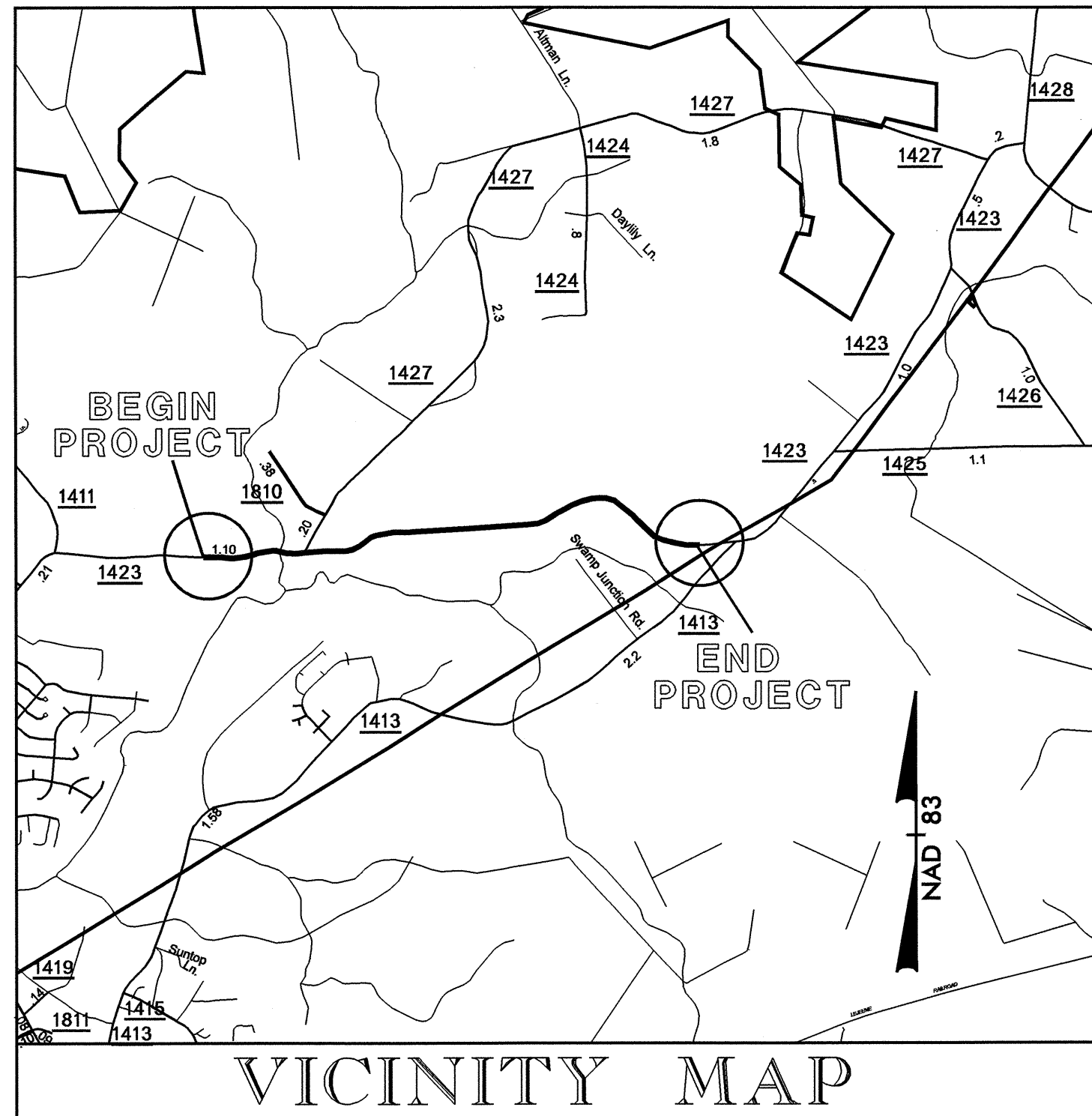

STATE OF NORTH CAROLINA
DIVISION OF HIGHWAYS
ONSLOW COUNTY

LOCATION: BRIDGE No. 3 OVER LITTLE NORTHEAST CREEK ON SR 1423
**TYPE OF WORK: GRADING, PAVING, WIDENING, RESURFACING,
DRAINAGE, STRUCTURE AND STRUCTURE REMOVAL**

| STATE | STATE PROJECT REFERENCE NO. | SHEET NO. | TOTAL SHEETS |
|-----------------|-----------------------------|--------------|--------------|
| N.C. | B-3682 | | |
| STATE PROJ. NO. | F.A. PROJ. NO. | DESCRIPTION | |
| 33224.1.1 | BRSTP-1423(2) | PE | |
| 33224.1.1 | BRSTP-1423(3) | ROW | |
| 33224.3.2 | BRSTP-1423(5) | CONSTRUCTION | |
| | | | |
| | | | |
| | | | |



STRUCTURE

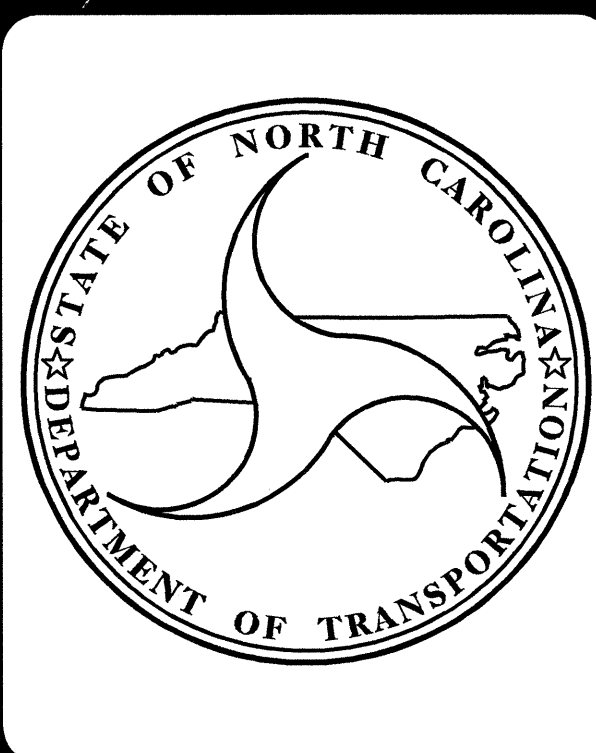
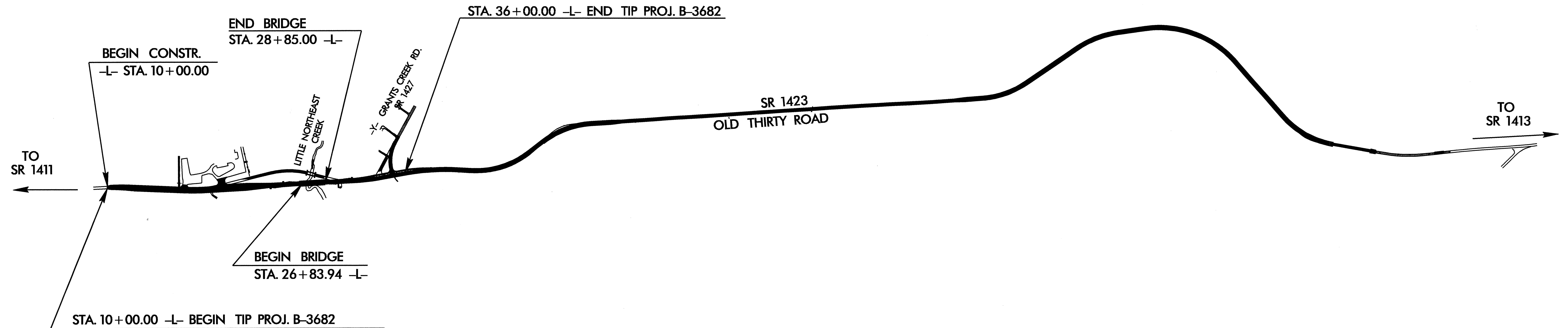

DESIGN DATA

| | |
|--------------|----------|
| ADT 2004 = | 3,680 |
| ADT 2024 = | 6,080 |
| DHV = | 9 % |
| D = | 55 % |
| T = | 3 % * |
| V = | 50 MPH |
| * TTST 1 % | DUAL 2 % |
| FUNC CLASS = | LOCAL |

PROJECT LENGTH

| | | |
|-------------------------------------|---|----------|
| LENGTH ROADWAY TIP PROJECT B-3682 | = | 0.454 mi |
| LENGTH STRUCTURE TIP PROJECT B-3682 | = | 0.038 mi |
| TOTAL LENGTH TIP PROJECT B-3682 | = | 0.492 mi |

Prepared In the Office of:
**DEPARTMENT OF TRANSPORTATION
DIVISION OF HIGHWAYS**
1000 Birch Ridge Drive, Raleigh, N. C. 27610

2002 STANDARD SPECIFICATIONS

| | |
|---|---|
| <p>LETTING DATE : MAY 17, 2005</p> | <p>B.S. COX, P.E. PROJECT ENGINEER</p> <hr/> <p>D.E. PETREY, P.E. PROJECT DESIGN ENGINEER</p> |
|---|---|

STRUCTURE DESIGN

Gregory R. Perffetti
1-28-05

DIVISION OF HIGHWAYS
STATE OF NORTH CAROLINA

P.E.
STATE HIGHWAY ENGINEER - DESIGN
**DEPARTMENT OF TRANSPORTATION
FEDERAL HIGHWAY ADMINISTRATION**

APPROVED FOR
DIVISION ADMINISTRATOR

DATE