

8/17/99

PROJECT REFERENCE NO. B-3866	SHEET NO. 4
ROADWAY DESIGN ENGINEER NORTH CAROLINA PROFESSIONAL ENGINEER SEAL 14493 J. J. [Signature]	HYDRAULICS ENGINEER NORTH CAROLINA PROFESSIONAL ENGINEER SEAL [Signature] F. FISHER

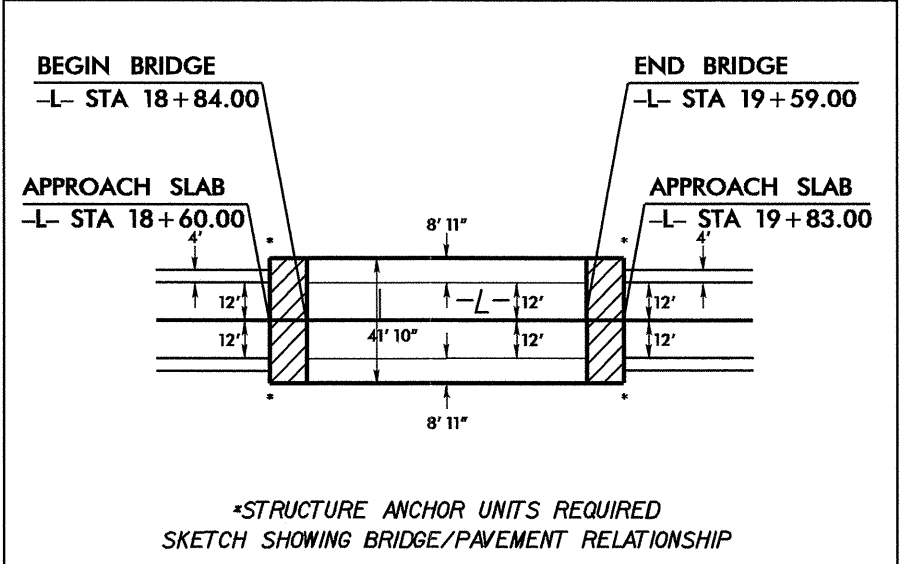

For structure plans see sheet S-1 thru S-19

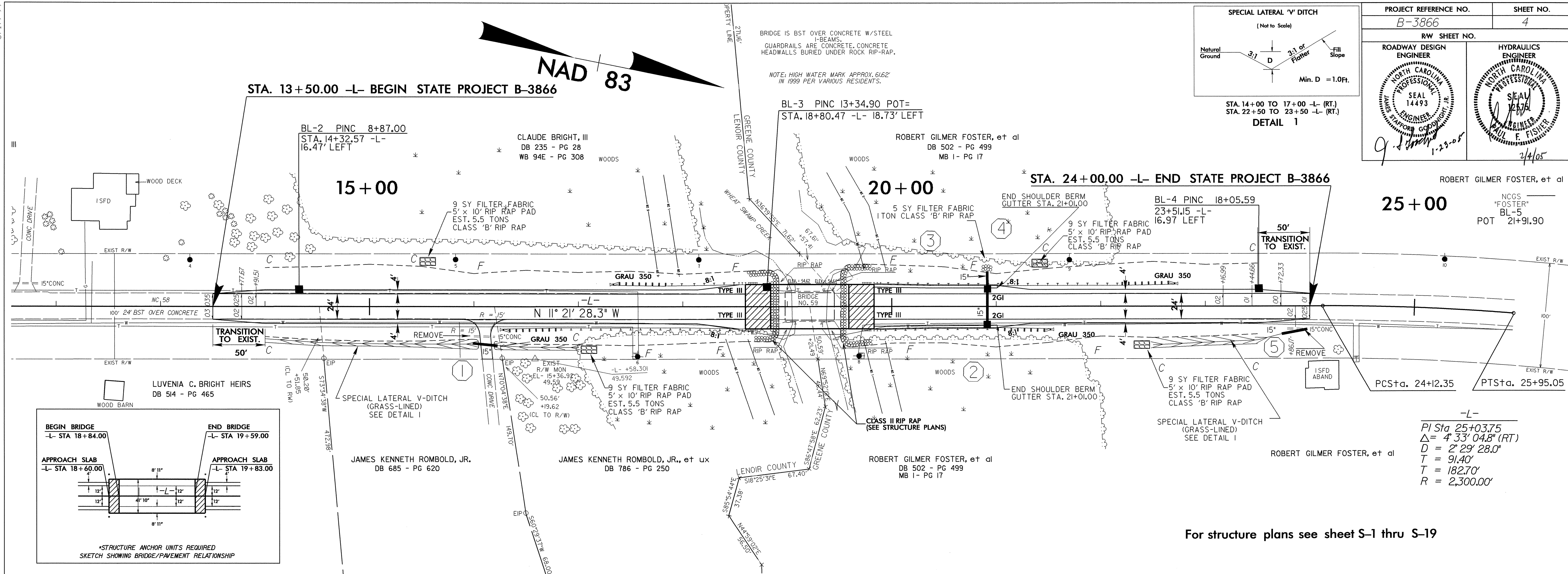
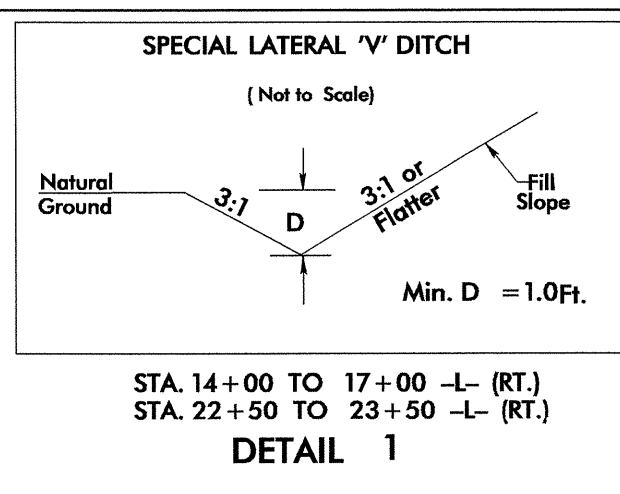
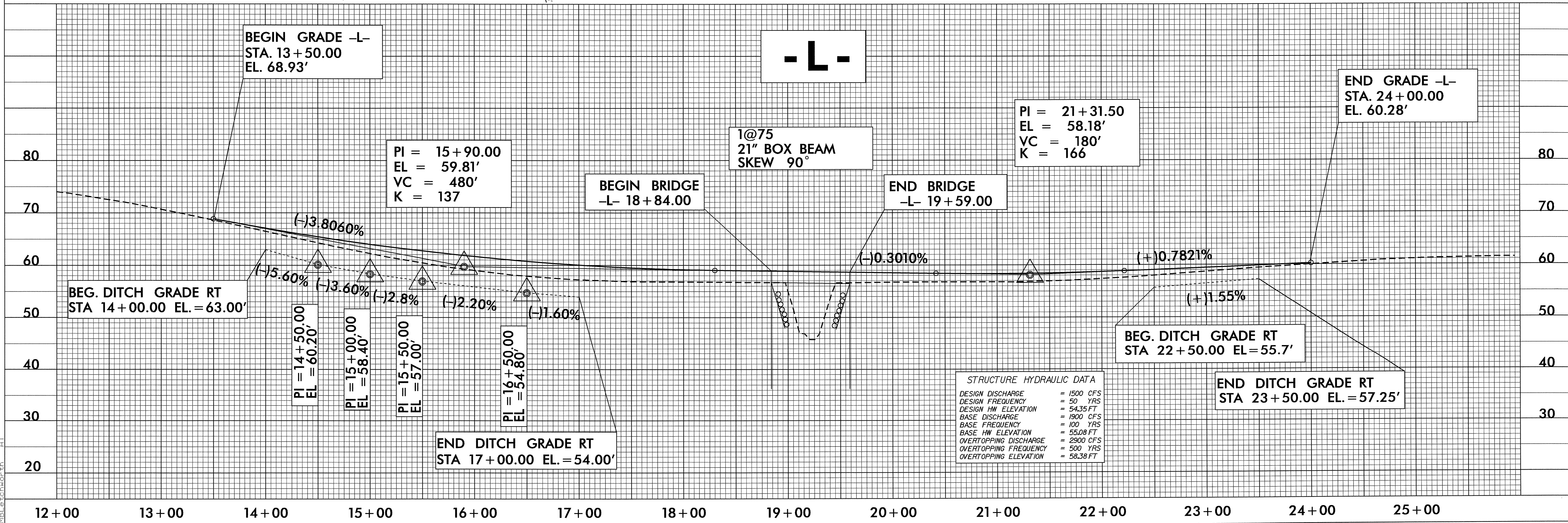

STRUCTURE HYDRAULIC DATA	
DESIGN DISCHARGE	= 1500 CFS
DESIGN FREQUENCY	= 50 YRS
DESIGN HW ELEVATION	= 54.35 FT
BASE DISCHARGE	= 1800 CFS
BASE FREQUENCY	= 100 YRS
BASE HW ELEVATION	= 55.08 FT
OVERTOPPING DISCHARGE	= 2900 CFS
OVERTOPPING FREQUENCY	= 500 YRS
OVERTOPPING ELEVATION	= 58.38 FT

01-FEB-2005 08:48  
r:\yordk\proj\b3866\_rdy\_psh.dgn  
MBLetchworth