

-Y4-

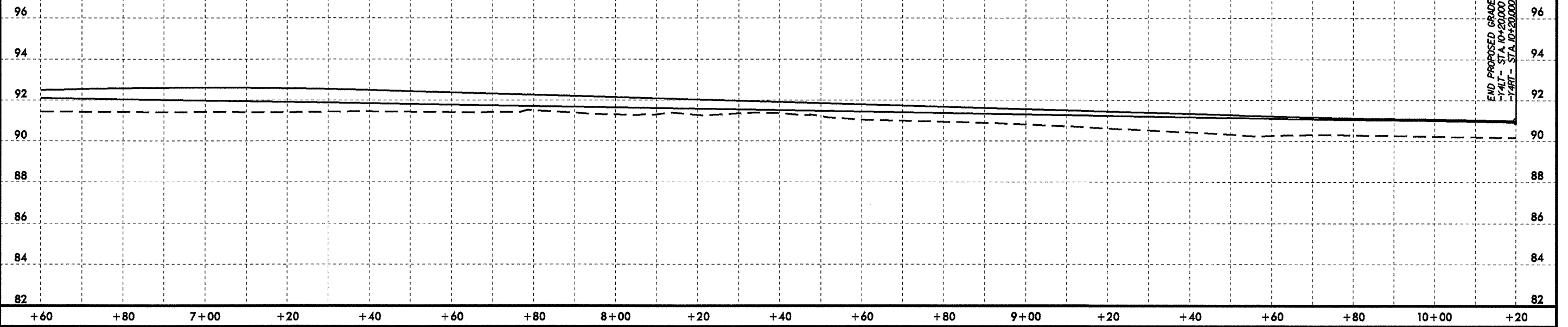

END PROPOSED GRADE
-Y4IT - STA. 10+20.000 (ELEV. 90.915)
-Y4RT - STA. 10+20.000 (ELEV. 90.987)

-Y4-

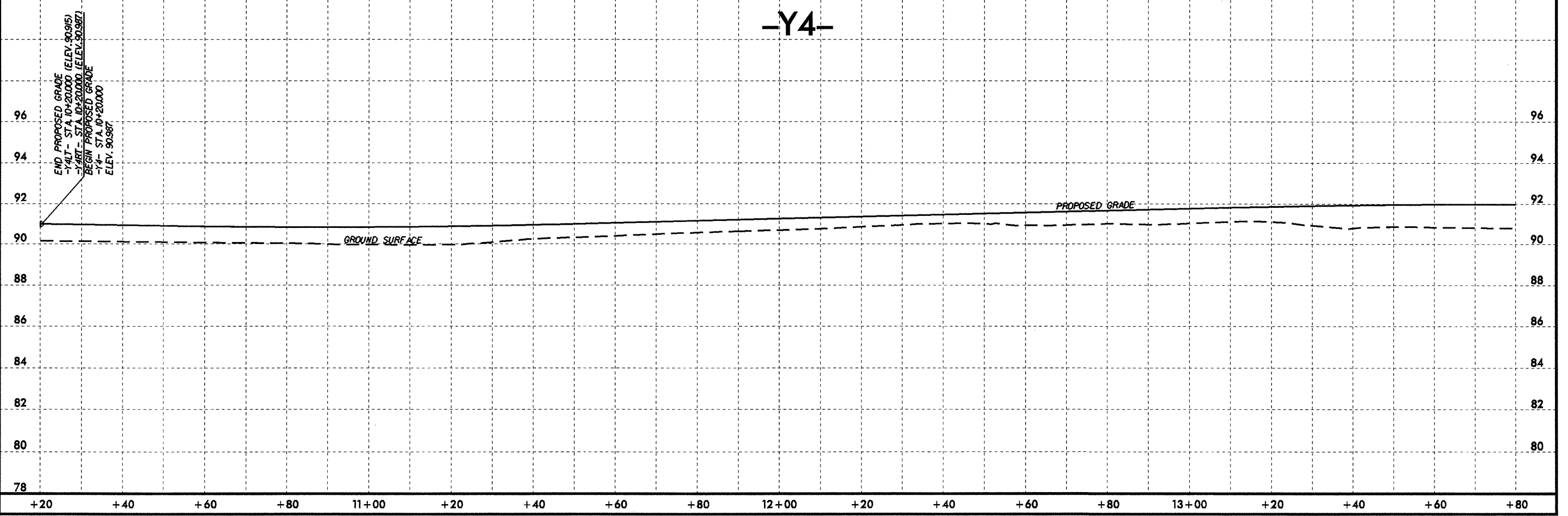

END PROPOSED GRADE
-Y4IT - STA. 10+20.000 (ELEV. 90.915)
-Y4RT - STA. 10+20.000 (ELEV. 90.987)
BEGIN PROPOSED GRADE
-Y4 - STA. 10+20.000
ELEV. 90.987

PROPOSED GRADE

GROUND SURFACE