

BM. #BL-6 - RR SPIKE DRIVEN VERTICALLY IN THE BASE OF 16" HOLLY TREE, BL STA. 121+98.037, 95.454 LT, ELEV.= 68.758

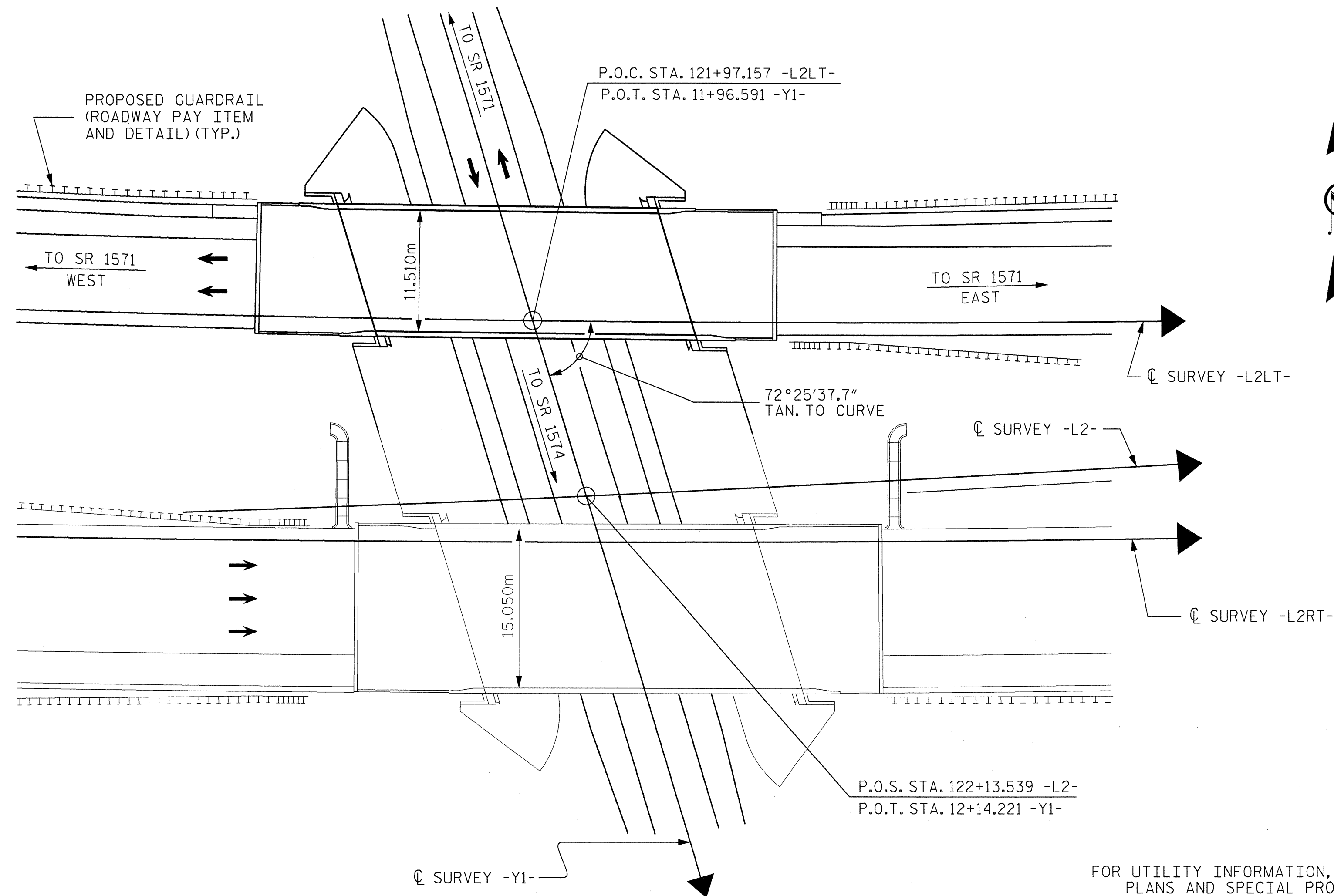

— LOCATION SKETCH —

— TOTAL BILL OF MATERIAL —

	REINFORCED CONCRETE DECK SLAB	GROOVING BRIDGE FLOORS	CLASS "AA" CONCRETE	CLASS "A" CONCRETE	BRIDGE APPROACH SLABS	REINFORCING STEEL	EPOXY COATED REINFORCING STEEL	MODIFIED 1600 mm PRESTRESSED CONCRETE GIRDERS	HP 310 x79 STEEL PILES	CONCRETE BARRIER RAIL	100mm SLOPE PROTECTION	ELASTOMERIC BEARINGS	
	SQ. METERS	SQ. METERS	CU. METERS	CU. METERS	LUMP SUM	kg	kg	METERS	No.	METERS	METERS	SQ. METERS	LUMP SUM
SUPERSTRUCTURE	390.1	538.4	69.6		LUMP SUM	1,932	408	122.760			62.3		LUMP SUM
END BENT 1				18.3		2,898			12	267.6		381	
END BENT 2				18.3		2,911			12	240.0		392	
TOTAL	390.1	538.4	69.6	36.6	LUMP SUM	7,741	408	122.760	24	507.6	62.3	773	LUMP SUM

NOTES

- ALL DIMENSIONS ARE IN MILLIMETERS UNLESS OTHERWISE NOTED.
- ALL ELEVATIONS ARE IN METERS.
- ASSUMED LIVE LOAD = MS 18 OR ALTERNATE LOADING.
- FOR OTHER DESIGN DATA AND GENERAL NOTES, SEE SHEET SNSM.
- FOR EROSION CONTROL MEASURES SEE EROSION CONTROL PLANS.
- THIS BRIDGE HAS BEEN DESIGNED BY STRENGTH DESIGN METHOD AS SPECIFIED IN AASHTO SPECIFICATIONS.
- THIS BRIDGE HAS BEEN DESIGNED IN ACCORDANCE WITH THE REQUIREMENTS OF THE "STANDARD SPECIFICATIONS FOR SEISMIC DESIGN OF HIGHWAY BRIDGES" FOR SEISMIC PERFORMANCE CATEGORY A.
- NEEDLE BEAMS WILL NOT BE ALLOWED UNLESS OTHERWISE CALLED FOR ON THE PLANS OR APPROVED BY THE ENGINEER.
- THE CLASS AA CONCRETE IN THE BRIDGE DECK SHALL CONTAIN FLY ASH OR GROUND GRANULATED BLAST FURNACE SLAG AT THE SUBSTITUTION RATE SPECIFIED IN ARTICLE 1024-1 AND IN ACCORDANCE WITH ARTICLES 1024-5 AND 1024-6 OF THE STANDARD SPECIFICATIONS. NO PAYMENT WILL BE MADE FOR THIS SUBSTITUTION AS IT CONSIDERED INCIDENTAL TO THE COST OF THE REINFORCED CONCRETE DECK SLAB.
- FOR SUBMITTAL OF WORKING DRAWINGS, SEE SPECIAL PROVISIONS.
- ALL PILES FOR END BENT NOS. 1 AND 2 SHALL BE DRIVEN TO A MINIMUM BEARING CAPACITY OF 530 kN EACH.
- FOR FALSEWORK AND FORMS OVER OR ADJACENT TO TRAFFIC, SEE SPECIAL PROVISIONS.
- FOR MAINTENANCE AND PROTECTION OF TRAFFIC BENEATH PROPOSED STRUCTURE, SEE SPECIAL PROVISIONS.
- FOR CRANE SAFETY, SEE SPECIAL PROVISIONS.
- REMOVABLE FORMS MAY BE USED IN LIEU OF METAL STAY-IN-PLACE FORMS IN ACCORDANCE WITH ARTICLE 420-3 OF THE STANDARD SPECIFICATIONS.
- FOR FABRICATED METAL STAY-IN-PLACE FORMS, SEE SPECIAL PROVISIONS.
- FOR METRIC STRUCTURAL STEEL, SEE SPECIAL PROVISIONS.

PROJECT NO. R-2552C

JOHNSTON COUNTY

STATION: 121+97.157 -L2LT-

SHEET 4 OF 4

STATE OF NORTH CAROLINA  
DEPARTMENT OF TRANSPORTATION  
RALEIGH

GENERAL DRAWING  
FOR LEFT LANE BRIDGE ON  
US 70 (CLAYTON BYPASS)  
OVER SR 1563  
BETWEEN SR 1571 (WEST)  
AND SR 1571 (EAST)

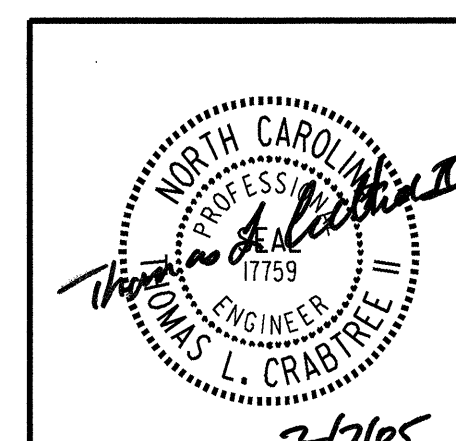

REVISIONS						SHEET NO.	
NO.	BY:	DATE:	NO.	BY:	DATE:	TOTAL SHEETS	
1			3			5	269
2			4			431	

R.N. LTB1-4

DRAWN BY : LAH DATE : 07/04  
CHECKED BY : TLC DATE : 01/05  
APPROVED BY : DATE :