

NOTES

1. ALL PILES ARE STEEL HP310 x 79.
2. PILE DIMENSIONS ARE SHOWN TO THE CENTERLINE OF THE PILES.
3. PILES FOR BOTH END BENTS SHALL BE DRIVEN TO A MINIMUM BEARING CAPACITY OF 530KN EACH.
4. WHEN DRIVING PILES, THE MAXIMUM BLOW COUNT SHALL NOT BE EXCEEDED.

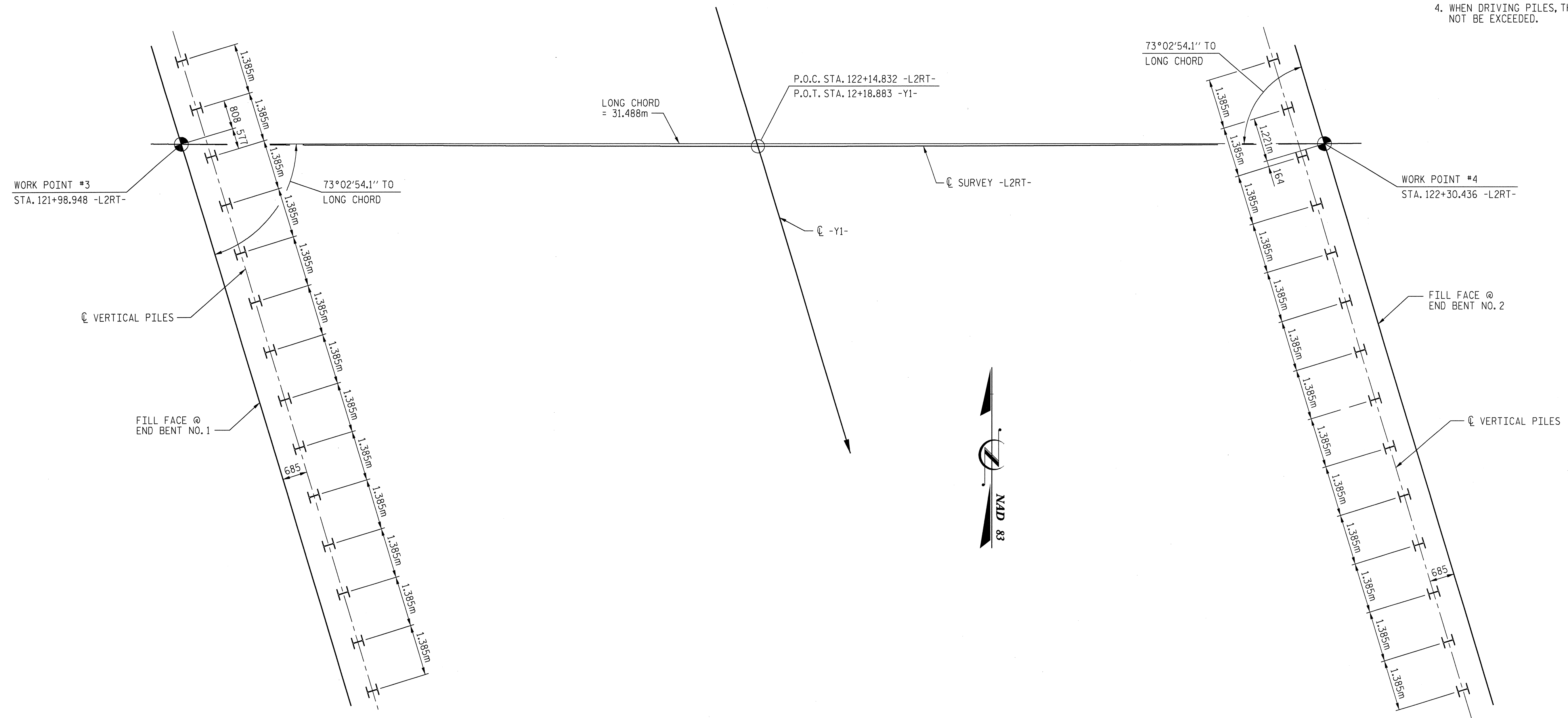

FOUNDATION LAYOUT



PROJECT NO. R-2552C
JOHNSTON COUNTY
 STATION: 122+14.832 -L2RT-

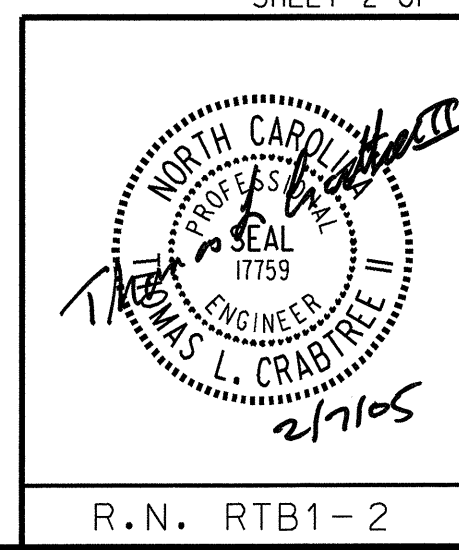

STATE OF NORTH CAROLINA
 DEPARTMENT OF TRANSPORTATION
 RALEIGH
 GENERAL DRAWING
 FOR RIGHT LANE BRIDGE ON
 US 70 (CLAYTON BYPASS)
 OVER SR 1563
 BETWEEN SR 1571 (WEST)
 AND SR 1571 (EAST)

REVISIONS						SHEET NO.	
NO.	BY:	DATE:	NO.	BY:	DATE:	TOTAL SHEETS	
1			3			5-295	
2			4			431	

DRAWN BY : MTB DATE : 11/04
 CHECKED BY : TLC DATE : 12/04
 APPROVED BY : _____ DATE : _____

USER: R:\m\johnston DGN: K:\78762\RT_Bridge\CADD\Found_R1.dgn DATE: 2/4/2005 TIME: 11:08:21
 USER: R:\m\johnston DGN: K:\78762\RT_Bridge\CADD\Found_R1.dgn DATE: 2/4/2005 TIME: 11:08:21

R.N. RTB1-2