

BM. #BL-6 - RR SPIKE DRIVEN VERTICALLY IN THE BASE OF 16" HOLLY TREE, BL STA. 121+98.037, 95.454 LT, ELEV.= 68.758

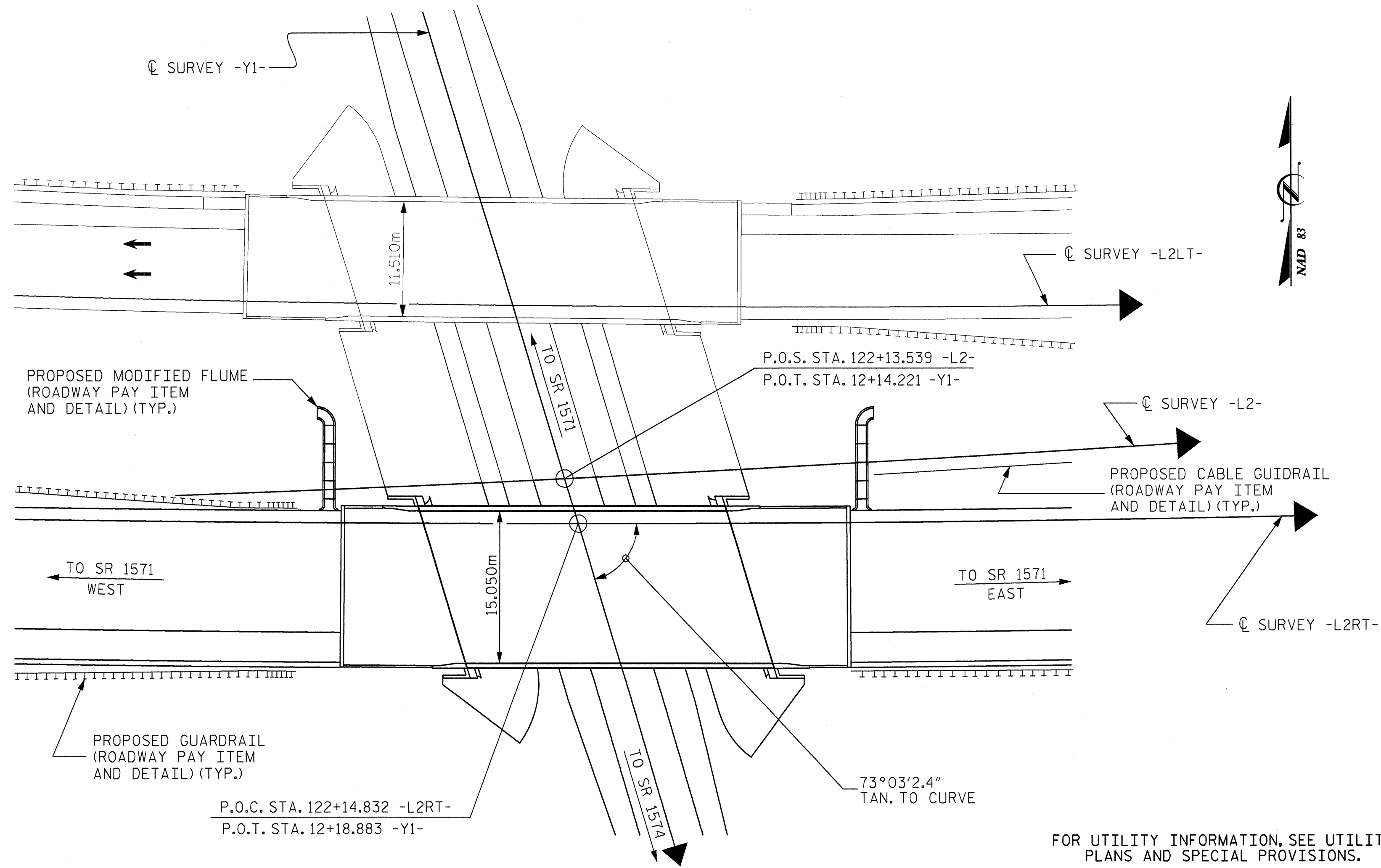

— LOCATION SKETCH —

NOTES

- ALL DIMENSIONS ARE IN MILLIMETERS UNLESS OTHERWISE NOTED.
- ALL ELEVATIONS ARE IN METERS.
- ASSUMED LIVE LOAD = MS 18 OR ALTERNATE LOADING.
- FOR OTHER DESIGN DATA AND GENERAL NOTES, SEE SHEET SNSM.
- FOR EROSION CONTROL MEASURES SEE EROSION CONTROL PLANS.
- THIS BRIDGE HAS BEEN DESIGNED BY STRENGTH DESIGN METHOD AS SPECIFIED IN AASHTO SPECIFICATIONS.
- THIS BRIDGE HAS BEEN DESIGNED IN ACCORDANCE WITH THE REQUIREMENTS OF THE "STANDARD SPECIFICATIONS FOR SEISMIC DESIGN OF HIGHWAY BRIDGES" FOR SEISMIC PERFORMANCE CATEGORY A.
- NEEDLE BEAMS WILL NOT BE ALLOWED UNLESS OTHERWISE CALLED FOR ON THE PLANS OR APPROVED BY THE ENGINEER.
- THE CLASS AA CONCRETE IN THE BRIDGE DECK SHALL CONTAIN FLY ASH OR GROUND GRANULATED BLAST FURNACE SLAG AT THE SUBSTITUTION RATE SPECIFIED IN ARTICLE 1024-1 AND IN ACCORDANCE WITH ARTICLES 1024-5 AND 1024-6 OF THE STANDARD SPECIFICATIONS. NO PAYMENT WILL BE MADE FOR THIS SUBSTITUTION AS IT IS CONSIDERED INCIDENTAL TO THE COST OF THE REINFORCED CONCRETE DECK SLAB.
- FOR SUBMITTAL OF WORKING DRAWINGS, SEE SPECIAL PROVISIONS.
- ALL PILES FOR END BENT NOS. 1 AND 2 SHALL BE DRIVEN TO A MINIMUM BEARING CAPACITY OF 530 kN EACH.
- FOR FALSEWORK AND FORMS OVER OR ADJACENT TO TRAFFIC, SEE SPECIAL PROVISIONS.
- FOR MAINTENANCE AND PROTECTION OF TRAFFIC BENEATH PROPOSED STRUCTURE, SEE SPECIAL PROVISIONS.
- FOR CRANE SAFETY, SEE SPECIAL PROVISIONS.
- REMOVABLE FORMS MAY BE USED IN LIEU OF METAL STAY-IN-PLACE FORMS IN ACCORDANCE WITH ARTICLE 420-3 OF THE STANDARD SPECIFICATIONS.
- FOR FABRICATED METAL STAY-IN-PLACE FORMS, SEE SPECIAL PROVISIONS.
- FOR METRIC STRUCTURAL STEEL, SEE SPECIAL PROVISIONS.

— TOTAL BILL OF MATERIAL —

	REINFORCED CONCRETE DECK SLAB	GROOVING BRIDGE FLOORS	CLASS "AA" CONCRETE	CLASS "A" CONCRETE	BRIDGE APPROACH SLABS	REINFORCING STEEL	EPOXY REINFORCING STEEL	MODIFIED 1600mm PRESTRESSED CONCRETE GIRDER	HP 310 x79 STEEL PILES	CONCRETE BARRIER RAIL	100mm SLOPE PROTECTION	ELASTOMERIC BEARINGS
	SQ. METERS	SQ. METERS	CU. METERS	CU. METERS	LUMP SUM	kg	kg	METERS	No.	METERS	SQ. METERS	LUMP SUM
SUPERSTRUCTURE	497.4	725.7	89.5		LUMP SUM	2,416	520	152.500		61.9		LUMP SUM
END BENT 1				22.5		3,617			14	294.0	455	
END BENT 2				22.5		3,615			14	308.0	418	
TOTAL	497.4	725.7	89.5	45.0	LUMP SUM	9,648	520	152.500	28	602.0	873	LUMP SUM



PROJECT NO. R-2552C

JOHNSTON COUNTY

STATION: 122+14.832 -L2RT-

SHEET 4 OF 4

STATE OF NORTH CAROLINA
DEPARTMENT OF TRANSPORTATION
RALEIGH

GENERAL DRAWING
FOR RIGHT LANE BRIDGE ON
US 70 (CLAYTON BYPASS)
OVER SR 1563
BETWEEN SR 1571 (WEST)
AND SR 1571 (EAST)

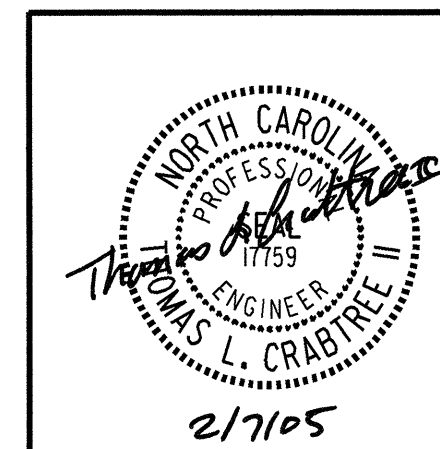

REVISIONS						SHEET NO.
NO.	BY:	DATE:	NO.	BY:	DATE:	TOTAL SHEETS
1			3			4(3)
2			4			

R.N. RTB1-4

DRAWN BY : LAH DATE : 07/04
CHECKED BY : TLC DATE : 01/05
APPROVED BY : DATE :