

- DEBONDING LEGEND**
- FULLY BONDED STRANDS
 - ▲ STRANDS DEBONDED FOR 0.600m FROM END OF GIRDER
 - ▣ STRANDS DEBONDED FOR 1.220m FROM END OF GIRDER
 - ◆ STRANDS DEBONDED FOR 3.050m FROM END OF GIRDER

* FOR S7 BARS, SEE DETAIL "C" OF PRESTRESSED CONCRETE GIRDER CONTINUOUS FOR LIVE LOAD DETAILS SHEET.

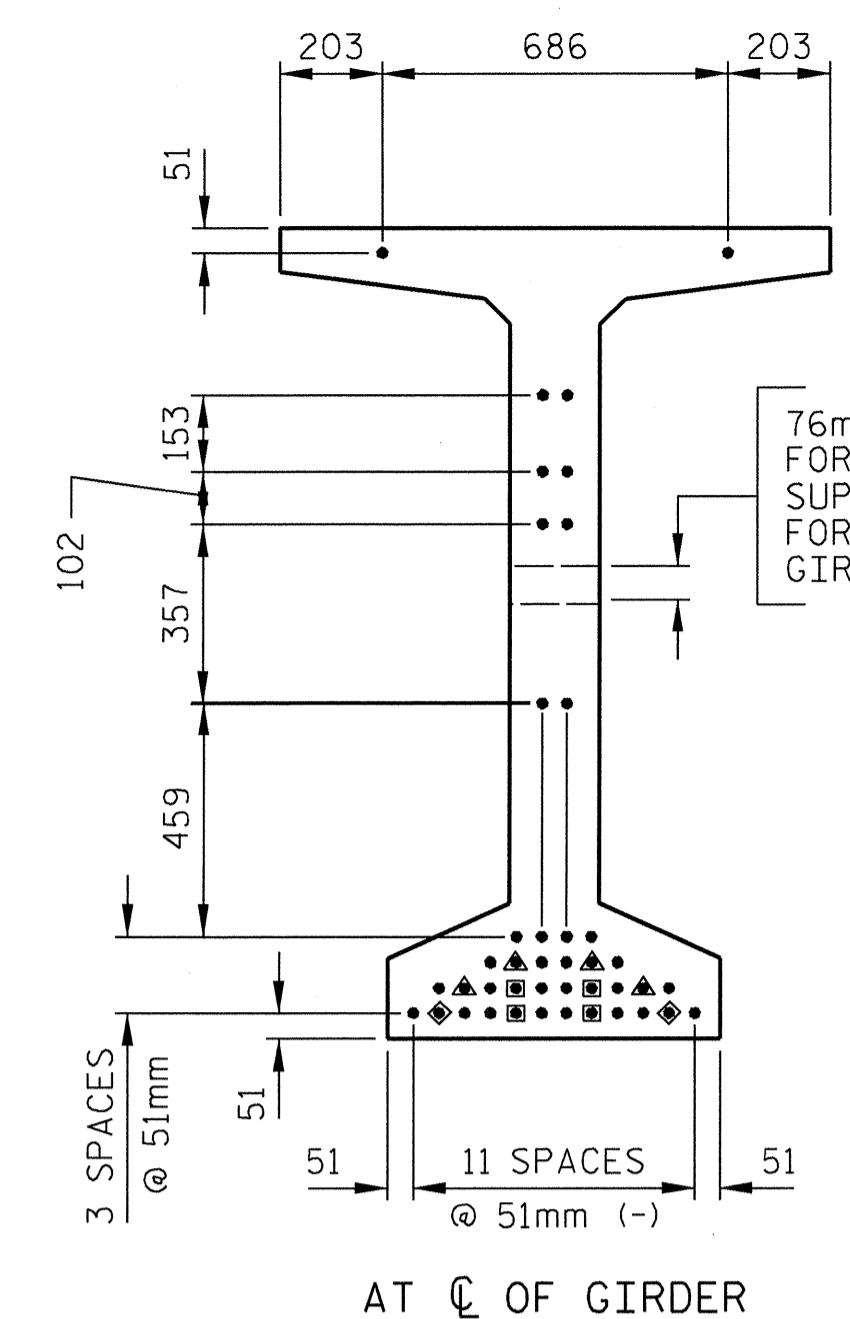

76mm Ø FORMED OR CORED HOLES FOR 31.75mm Ø TIE RODS. SEE SUPERSTRUCTURE "FRAMING PLAN" FOR LOCATIONS. (1 HOLE EXTERIOR GIRDER, 2 HOLES INTERIOR GIRDERS.)

NOTES
SEE SHEET 3 OF 3 FOR NOTES.

42 - 15.24mm Ø LOW RELAXATION STRAND LAYOUT

15.24mm Ø L. R. GRADE 270 STRANDS		
AREA (mm ²)	ULTIMATE STRENGTH (KN PER STRAND)	APPLIED PRESTRESS (KN PER STRAND)
140.0	260.7	195.5

REINFORCING STEEL FOR ONE GIRDER					
BAR	NUMBER	SIZE	TYPE	LENGTH	WEIGHT
S1	198	#13	1	1925	379
S2	24	#16	1	1925	72
S3	12	#13	2	2560	31
S4	84	#13	3	920	77
S6	222	#16	1	1200	413
* S7	20	#16	STR	1120	35
S8	2	#16	2	2740	9
S9	40	#16	STR	980	61

* NOTE: S7 BARS SHALL BE BENT BEFORE SHIPMENT. HEAT BENDING SHALL NOT BE ALLOWED.

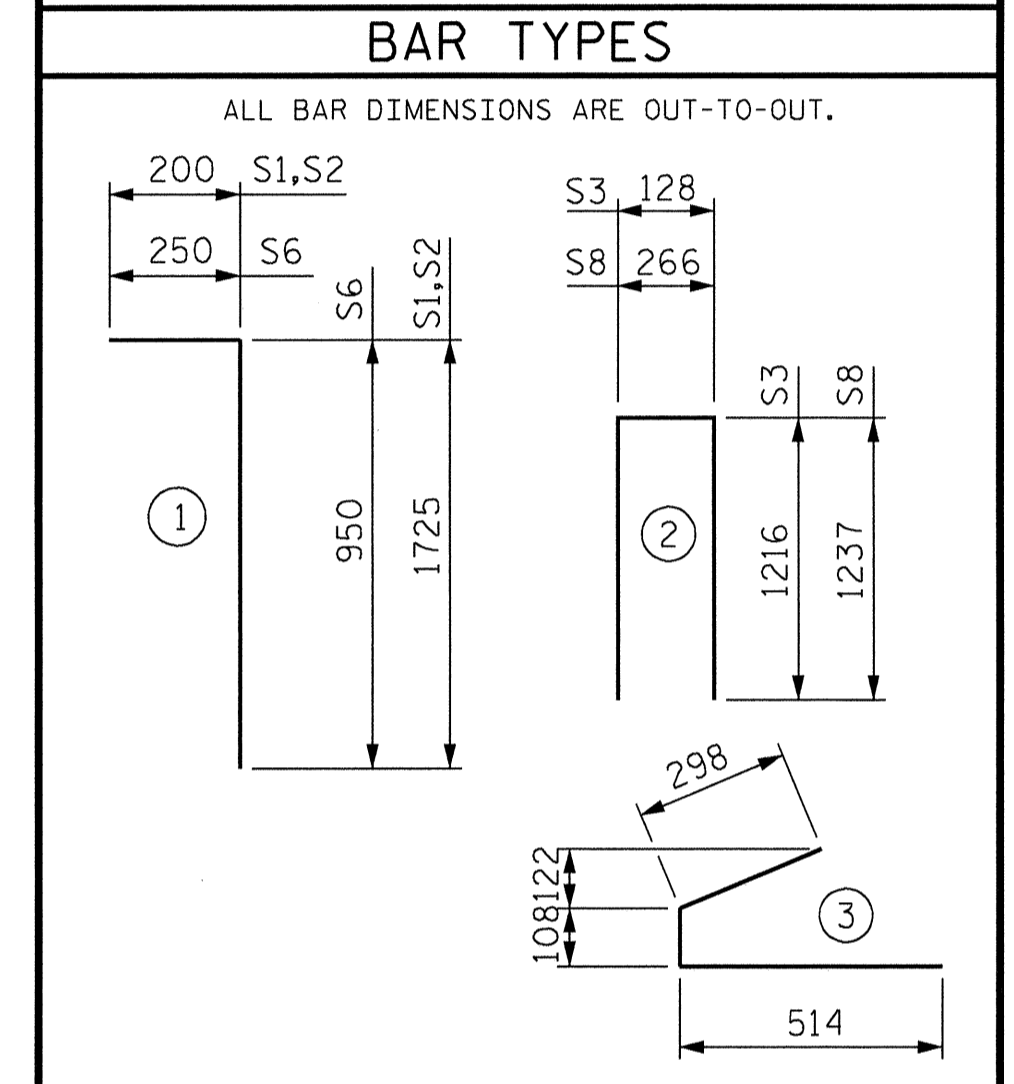

QUANTITIES FOR ONE GIRDER			
	REINFORCING STEEL (kg)	55.2 MPa CONCRETE (m ³)	15.24mm Ø L.R. STRANDS (No.)
SPAN A	1,077	15.2	42

GIRDERS REQUIRED			
LOCATION	NUMBER	LENGTH	TOTAL LENGTH
SPAN A	5	30.500m	152.500m

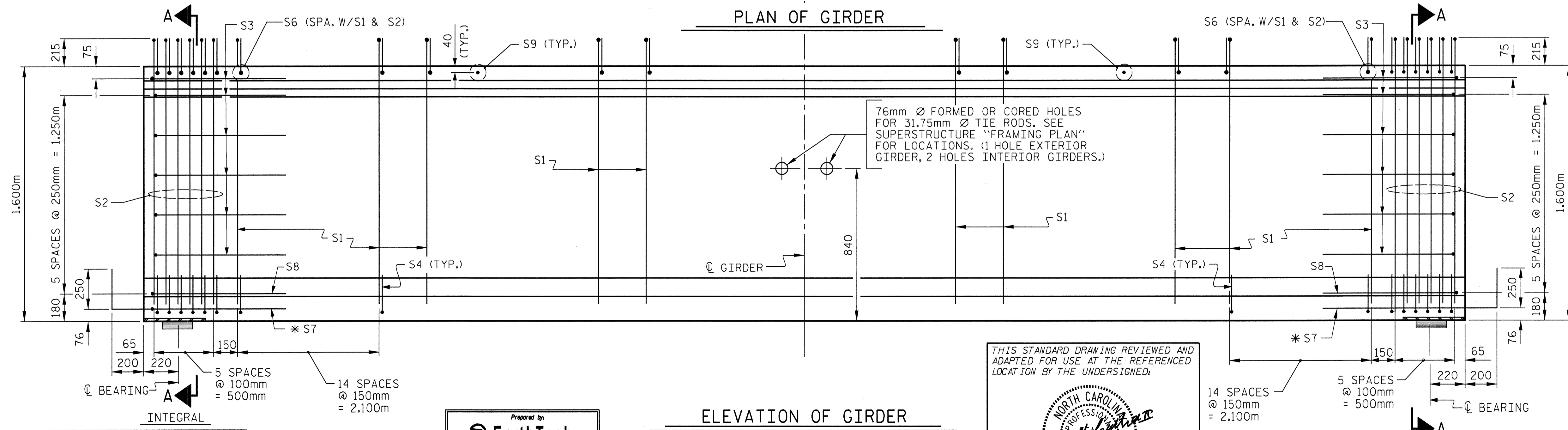
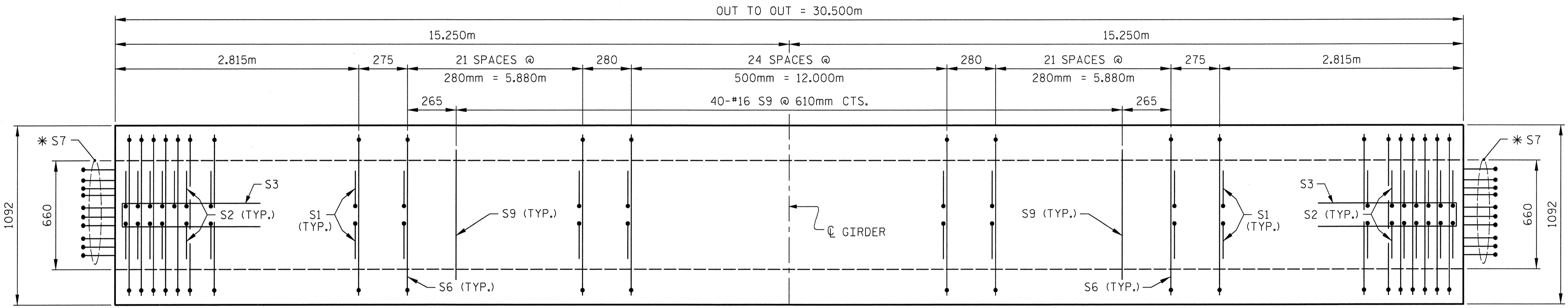

76mm Ø FORMED OR CORED HOLES FOR 31.75mm Ø TIE RODS. SEE SUPERSTRUCTURE "FRAMING PLAN" FOR LOCATIONS. (1 HOLE EXTERIOR GIRDER, 2 HOLES INTERIOR GIRDERS.)

THIS STANDARD DRAWING REVIEWED AND ADAPTED FOR USE AT THE REFERENCED LOCATION BY THE UNDERSIGNED:

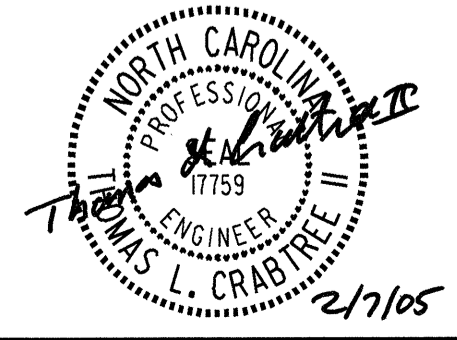

ASSEMBLED BY : LOFTON DATE : 12/04
 CHECKED BY : TLC DATE : 12/04
 DRAWN BY : RWW 9/19/02 ADDED 9/19/02
 CHECKED BY : GM 9/19/02

PROJECT NO. R-2552C
 JOHNSTON COUNTY
 STATION: 122+14.832 -L2RT-
 SHEET 2 OF 3

STATE OF NORTH CAROLINA
 DEPARTMENT OF TRANSPORTATION
 RALEIGH
 OPTIONAL
 1600mm PRESTRESSED
 CONCRETE MODIFIED BULB TEE
 CONTINUOUS FOR LIVE LOAD
 (RIGHT BRIDGE)

REVISIONS						SHEET NO.
NO.	BY:	DATE:	NO.	BY:	DATE:	TOTAL SHEETS
1			3			431
2			4			

R.N. RTB1-11
 STD. No. PCGD9SM

DATE: 2/4/2005
 TIME: 13:39:30
 USER: klmloffton
 DGN: K378762/RT_Bridge/CADD/pcgd9sm.dgn