

10:30:52 AM

n:\proj\309-300\ustration\struct\final\309-300-span_b.dgn

02/23/2005 david.lowery

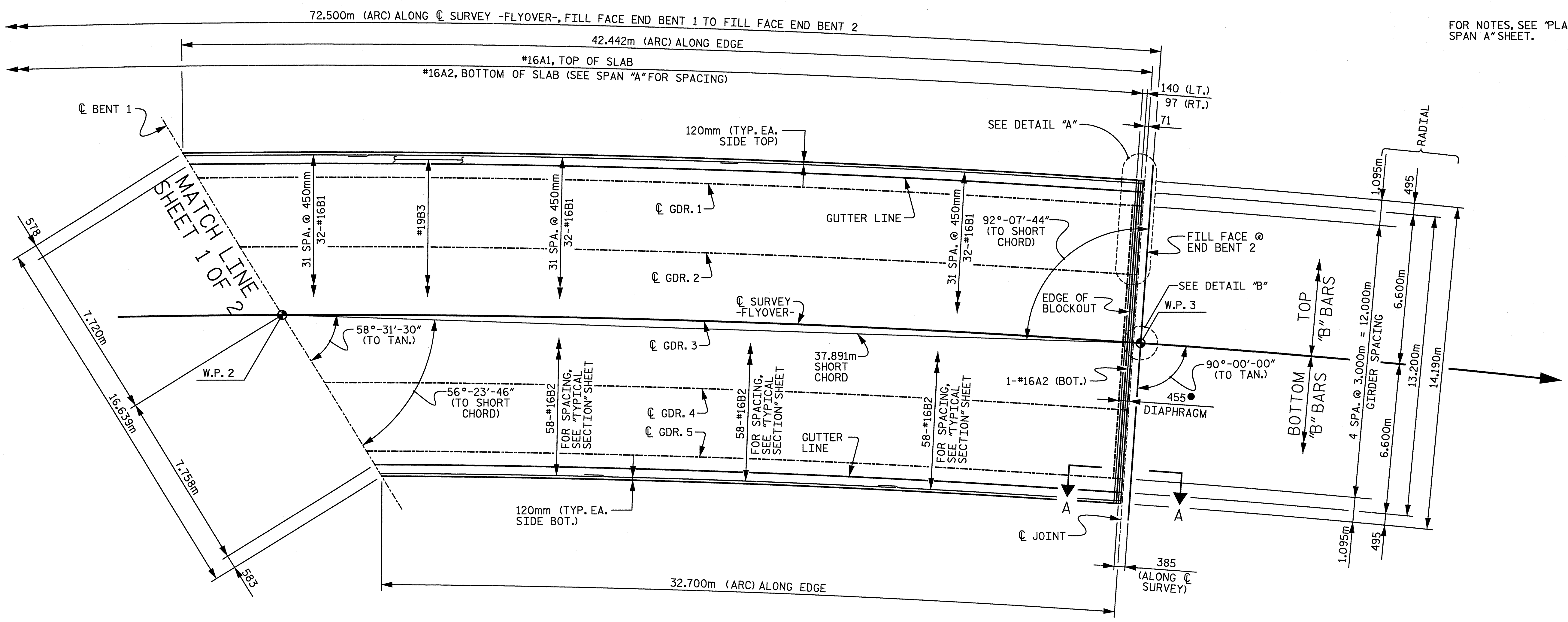

FOR NOTES, SEE "PLAN OF SPANS SPAN 'A' SHEET."

SPAN "B"

• AT 16°C

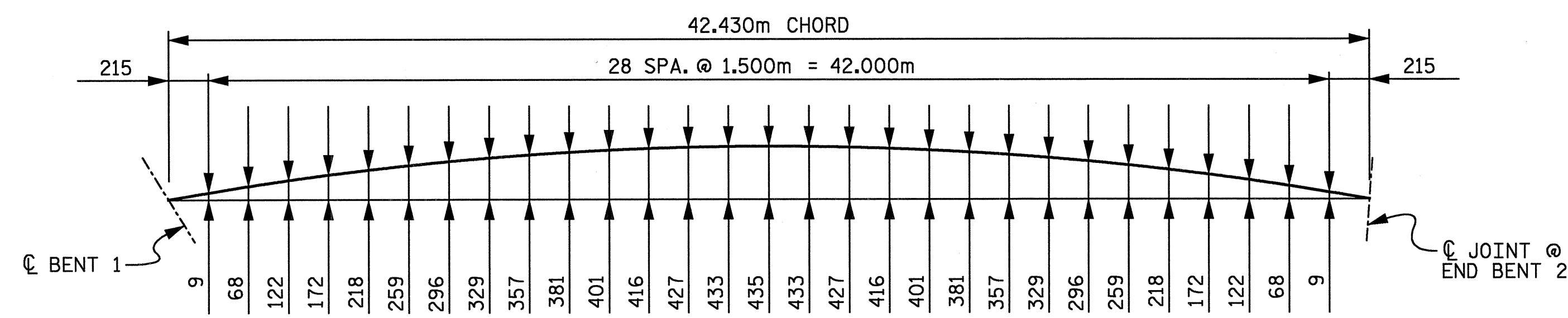

LEFT SIDE - EDGE OF SLAB

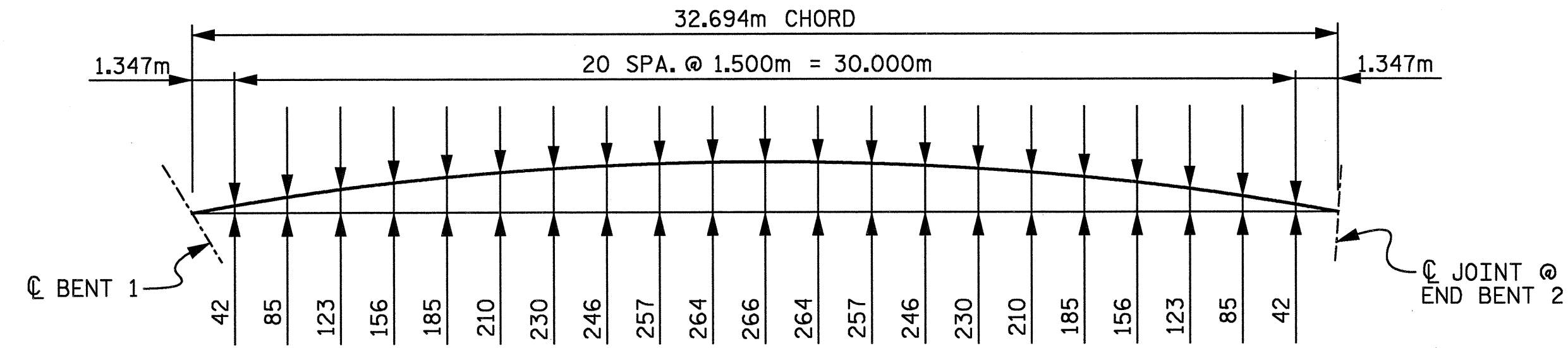

RIGHT SIDE - EDGE OF SLAB

ARC OFFSETS - SPAN "B"

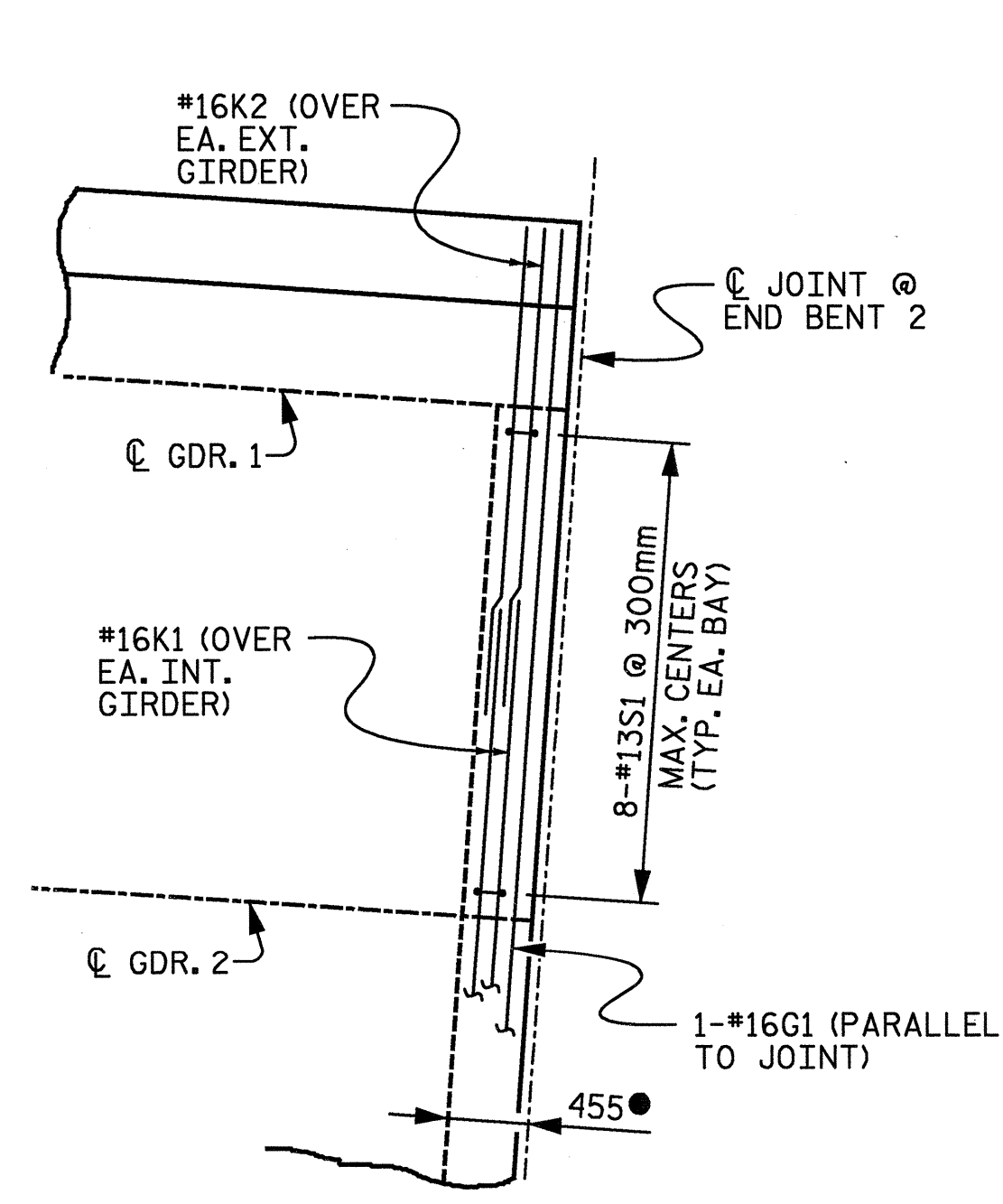

DETAIL "A"

"A" AND "B" BARS NOT SHOWN

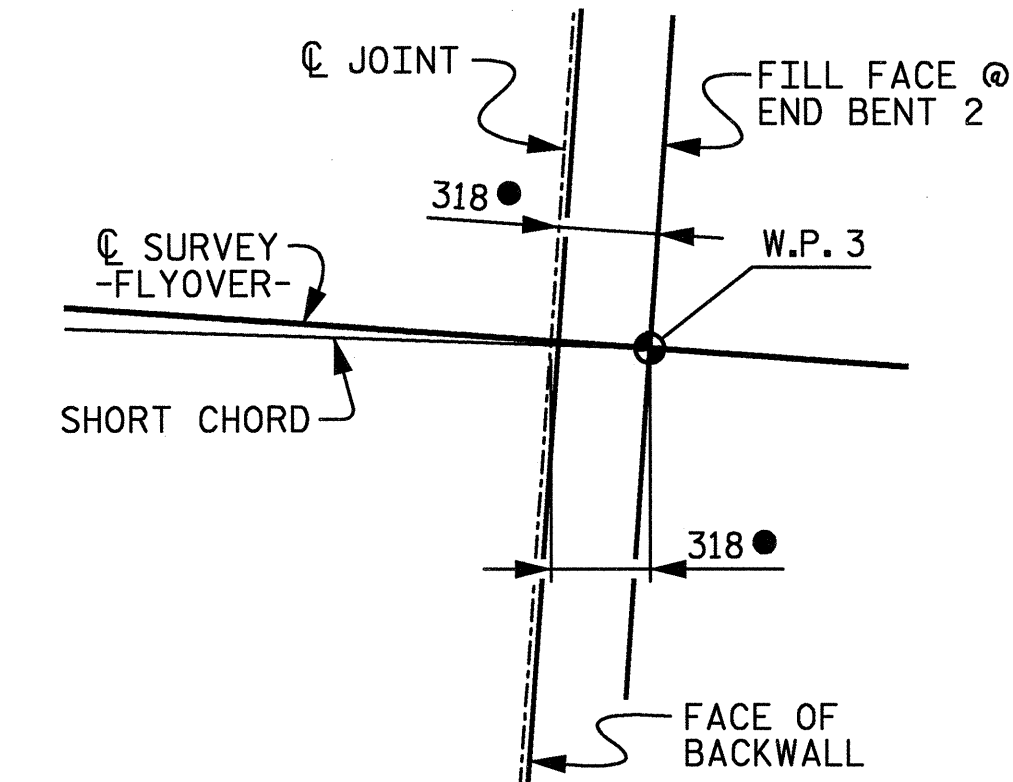

DETAIL "B"

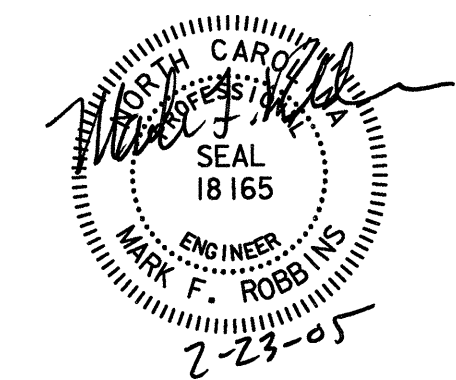

RALPH WHITEHEAD ASSOCIATES, INC.
CONSULTING ENGINEERS
P.O. BOX 35624 CHARLOTTE, N.C. 28235

DRAWN BY LGH, DDL DATE 8-04 DWG. NO. D-1748.07
CHECKED BY TVR DATE 9-04

REVISIONS			
NO.	BY	DATE	DATE
1	3		
2	7		

PROJECT No. R-2552C
JOHNSTON COUNTY
STATION: POS 16+52.599 -Y4-
POC 9+28.021 -FLYOVER-

STATE OF NORTH CAROLINA
DEPARTMENT OF TRANSPORTATION
RALEIGH
PLAN OF SPANS
SPAN "B"

SHEET NO. 5102
TOTAL SHEETS 431