

PLAN - OUTLET WINGS

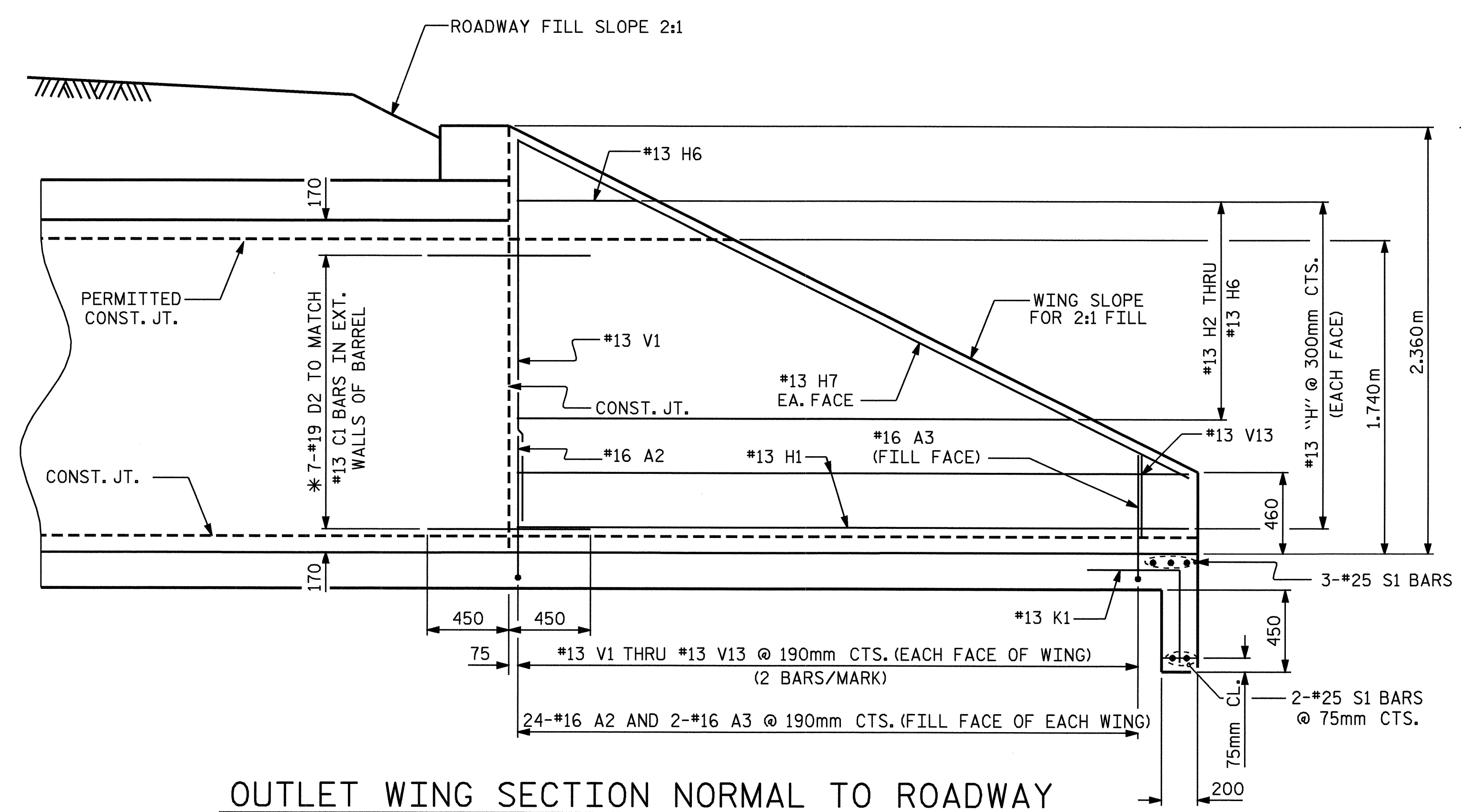

OUTLET WING SECTION NORMAL TO ROADWAY

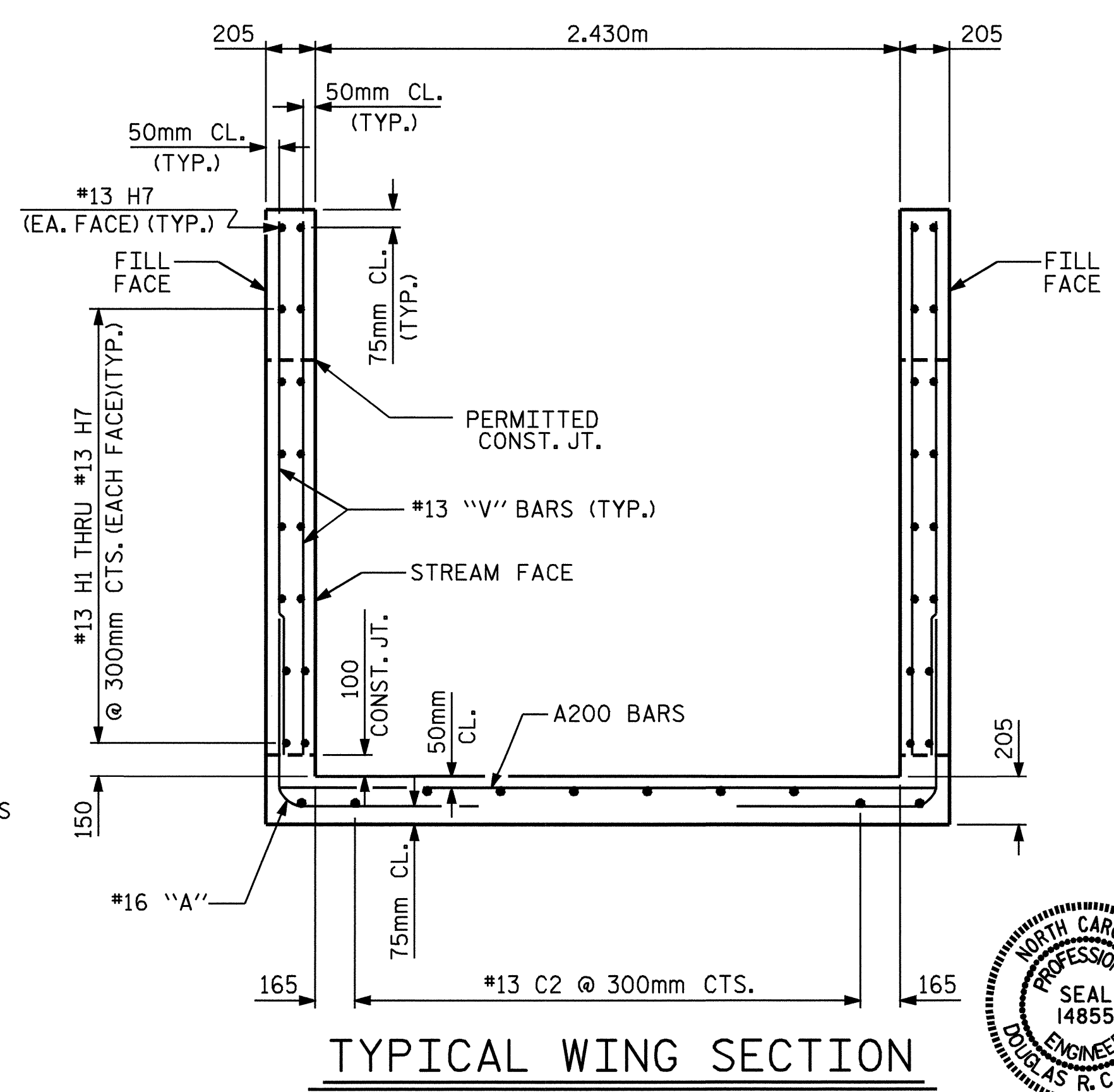

TYPICAL WING SECTION

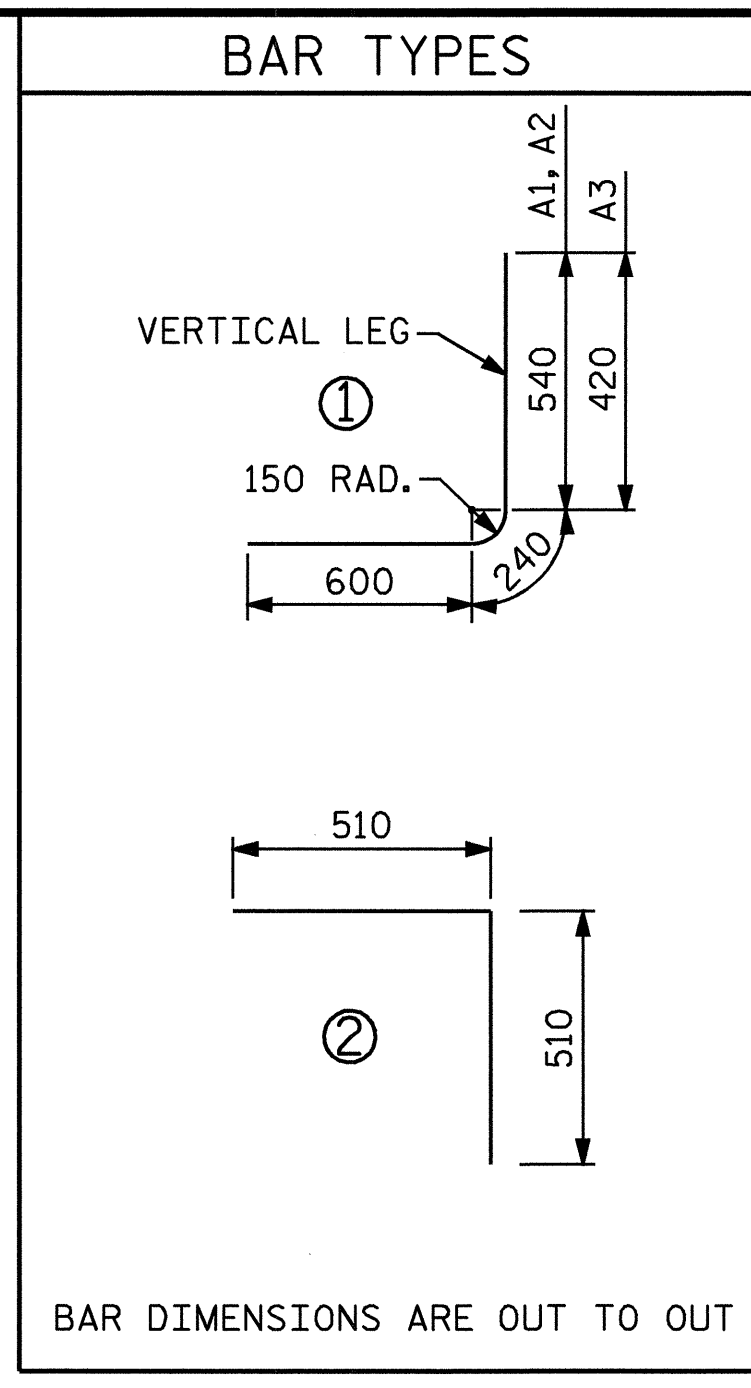

REINFORCING STEEL BAR SCHEDULE											
RIGHT EXTENSION											
BARREL AND OUTLET WINGS											
BAR	NO	SIZE	TYPE	LENGTH	WEIGHT	BAR	NO	SIZE	TYPE	LENGTH	WEIGHT
A1	82	13		1380	112	V3	8	13	STR	1800	14
A2	130	16		1380	278	V4	8	13	STR	1660	13
A3	4	16		1260	8	V5	8	13	STR	1520	12
A100	32	19	STR	2700	193	V6	8	13	STR	1360	11
A101	4	19	STR	2280	20	V7	8	13	STR	1220	10
A102	4	19	STR	1880	17	V8	8	13	STR	1080	9
A103	4	19	STR	1480	13	V9	8	13	STR	940	7
A104	4	19	STR	1060	9	V10	8	13	STR	780	6
A105	4	19	STR	660	6	V11	8	13	STR	640	5
A200	64	19	STR	2700	386	V12	8	13	STR	500	4
A201	6	19	STR	2100	28	V13	8	13	STR	340	3
A202	6	19	STR	1540	21						
A203	6	19	STR	960	13						
B1	52	13	STR	2080	108						
B2	82	16	STR	1620	206						
C1	24	13	STR	7640	182						
C2	20	13	STR	6620	132						
D1	18	19	STR	760	31						
D2	14	19	STR	900	28						
G1	2	13	STR	3560	7						
H1	8	13	STR	4860	39						
H2	4	13	STR	4000	16						
H3	4	13	STR	3220	13						
H4	4	13	STR	2440	10						
H5	4	13	STR	1660	7						
H6	4	13	STR	880	3						
H7	4	13	STR	5200	21						
K1	5	13	2	1020	5						
S1	14	25	STR	3560	198						
V1	8	13	STR	2100	17						
V2	8	13	STR	1960	16						
REINFORCING STEEL Kg 2250											
CLASS A CONCRETE											
BARREL @ 1.95 C.M./M 15.2 m³											
HEADWALL 0.4 m³											
2 EDGE BEAMS 0.7 m³											
2 WINGS 2.8 m³											
WING SLAB 3.1 m³											
END CURTAIN WALL 0.3 m³											
TOTAL 22.5 m³											
SPlice LENGTHS CHART											
BAR	SIZE	SPlice LENGTH									
B1	13	540									
C2	13	590									

PROJECT NO. R-2552C
 JOHNSTON COUNTY
 STATION: 154+38.598 -L2-
 SHEET 4 OF 5

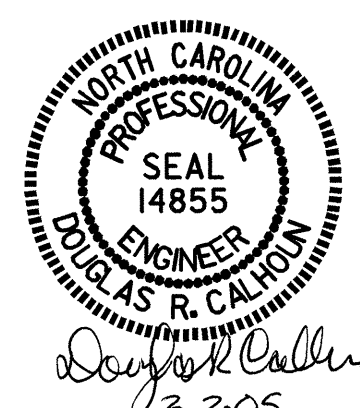

STATE OF NORTH CAROLINA
 DEPARTMENT OF TRANSPORTATION
 RALEIGH
OUTLET WINGS
SINGLE 2.430m X 1.840m
CONCRETE BOX CULVERT
RIGHT EXTENSION
50° SKEW

REVISIONS						SHEET NO.	
NO.	BY:	DATE:	NO.	BY:	DATE:	C-29	
1			3			TOTAL SHEETS 42	
2			4				

DRAWN BY : A. K. PATEL/TLC DATE : 11-10-03
 CHECKED BY : T. A. HARRIS DATE : 12-5-03

02-MAR-2005 12:05
 W:\squad04\25520\TCELLER\N\MICROS\N\R-2552C\R-2552-2.DGN
 Tceller