

78+00 78+10 78+20 78+30 78+40 78+50 78+60 78+70

+1.9000% Δ -1.5005%
-L- GRADE DATA
 P.I. STA. = 77+94.000
 ELEV. = 104.822
 V.C. = 550m

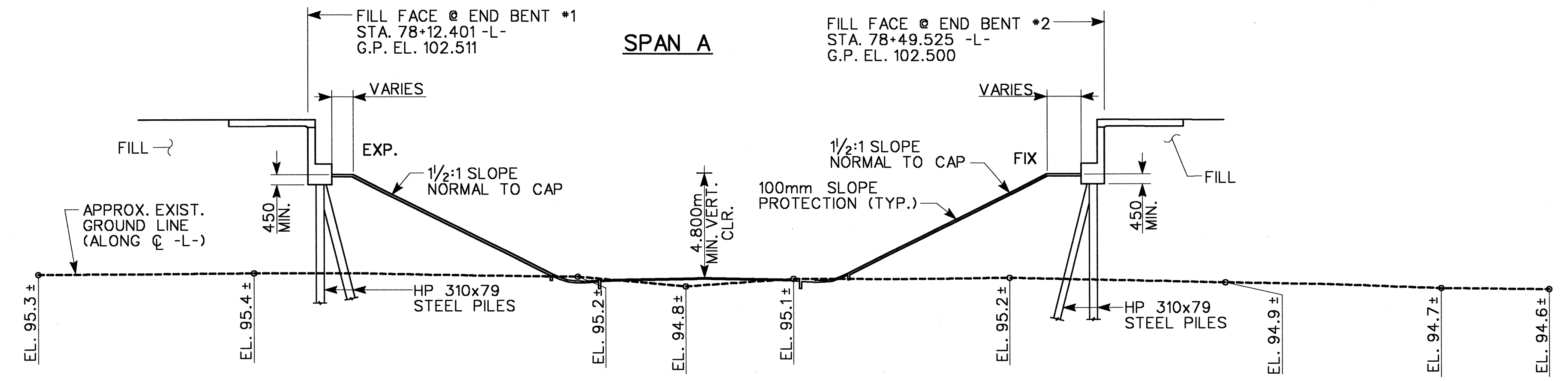

SECTION ALONG GRADE LINE (LEFT LANE)
 (BENTS ON SECTION AT RIGHT ANGLES TO BENTS)

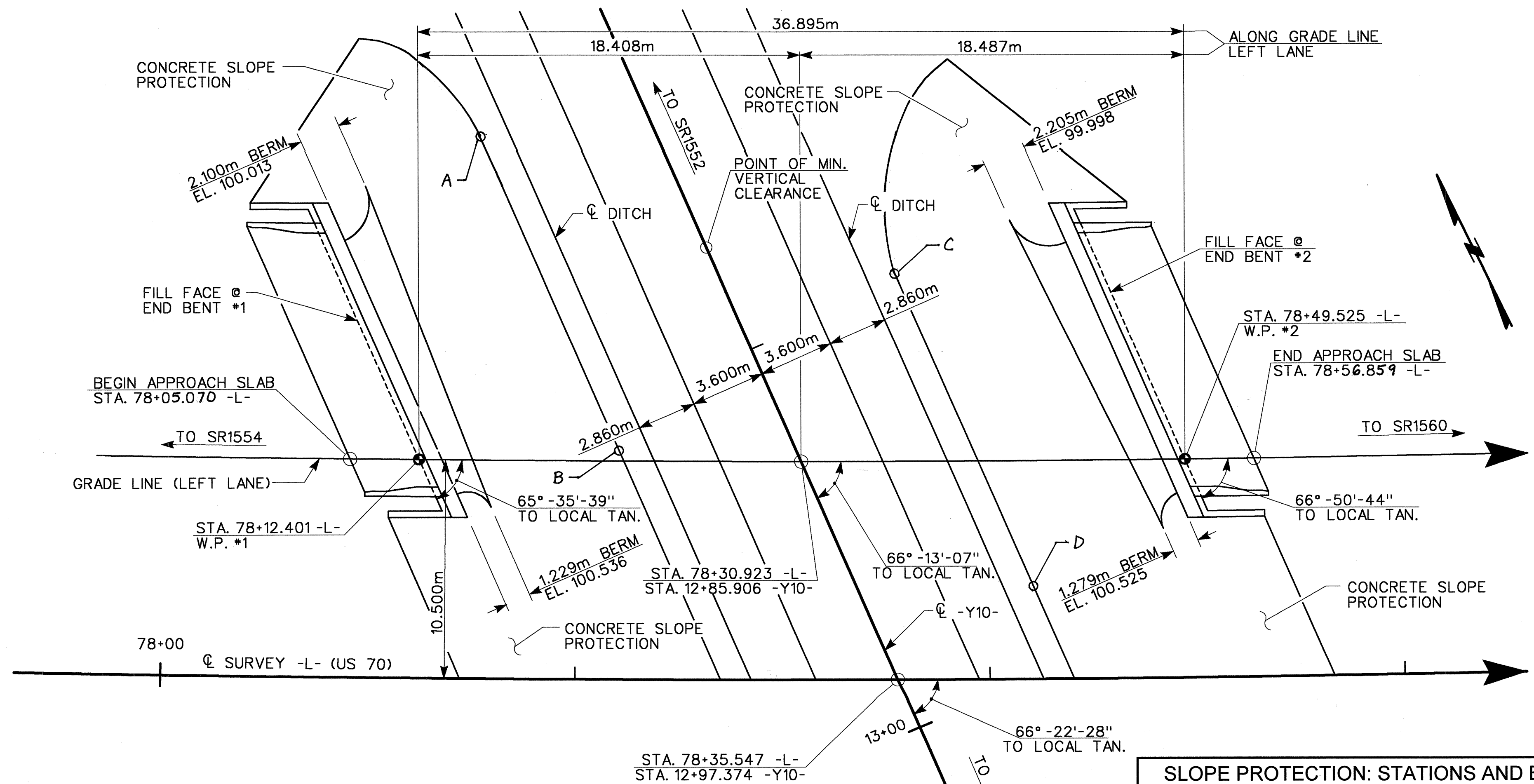

PLAN
 (PILES NOT SHOWN IN PLAN VIEW)

SLOPE PROTECTION: STATIONS AND ELEVATIONS

POINT	STATION	OFFSET	ELEVATION
A	12+65.326 -Y10-	7.825 m RT.	ELEV. 96.014
B	12+81.892 -Y10-	7.825 m RT.	ELEV. 95.941
C	12+79.322 -Y10-	7.825 m LT.	ELEV. 95.945
D	12+95.888 -Y10-	7.825 m LT.	ELEV. 95.858

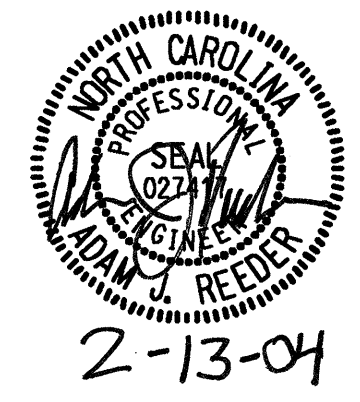

PROJECT NO. R-2552B
 JOHNSTON COUNTY
 STATION: 78+35.547 -L-
12+97.374 -Y10-
 SHEET 1 of 4 BRIDGE NO. 583

STATE OF NORTH CAROLINA
 DEPARTMENT OF TRANSPORTATION
 RALEIGH
 GENERAL DRAWING
 FOR BRIDGE ON
 US 70 BYPASS OVER SR1555
 BETWEEN SR1554 AND SR1560
 (LEFT LANE)

REVISIONS						SHEET NO.
NO.	BY:	DATE:	NO.	BY:	DATE:	TOTAL SHEETS
1			3			5-30
2			4			431



DRAWN BY: AR DATE: 6/01
 CHECKED BY: LB DATE: 6/01