

\* ELEVATIONS BETWEEN BRIDGE SEAT BUILD-UPS ARE TAKEN AT THIS POINT.

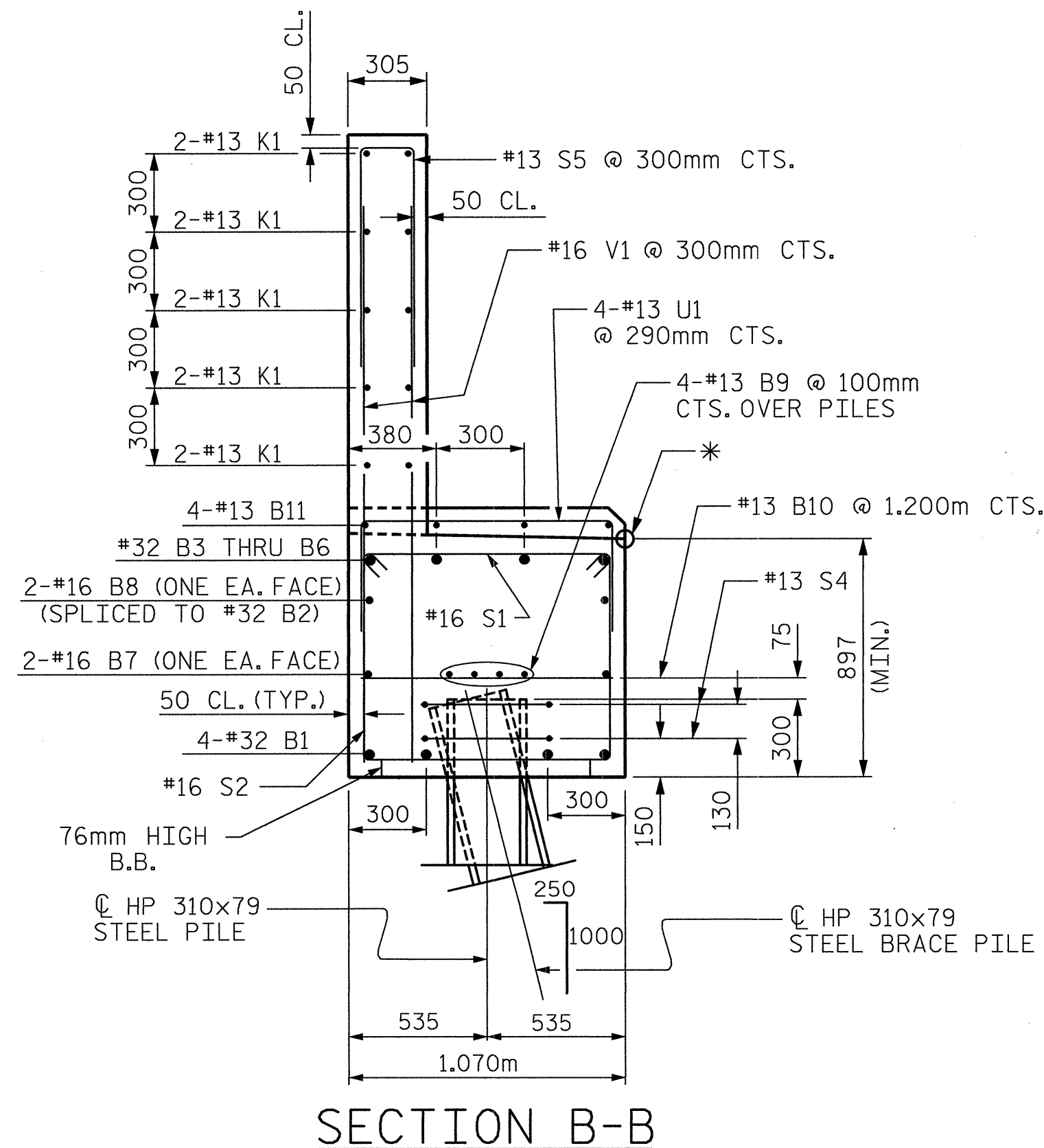

\* ELEVATIONS BETWEEN BRIDGE SEAT BUILD-UPS ARE TAKEN AT THIS POINT.

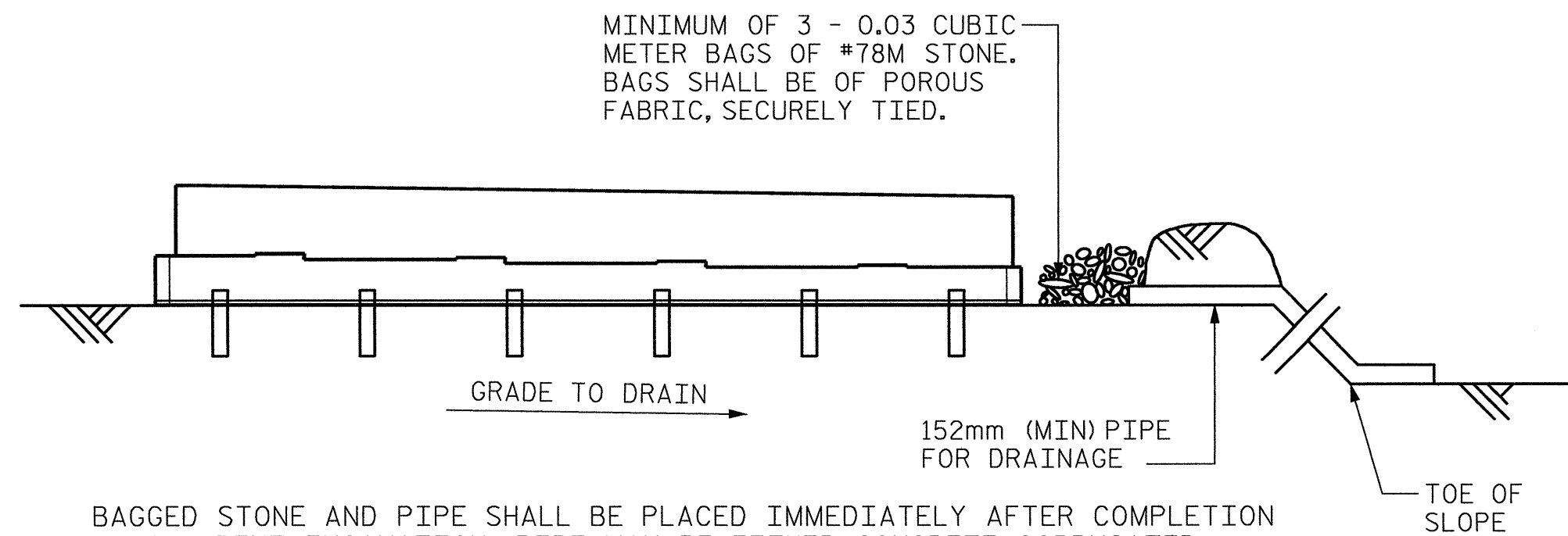

BAGGED STONE AND PIPE SHALL BE PLACED IMMEDIATELY AFTER COMPLETION OF END BENT EXCAVATION. PIPE MAY BE EITHER CONCRETE, CORRUGATED STEEL, CORRUGATED ALUMINUM ALLOY, OR CORRUGATED PLASTIC. PERFORATED PIPE WILL NOT BE ALLOWED.

BAGGED STONE SHALL REMAIN IN PLACE UNTIL THE ENGINEER DIRECTS THAT IT BE REMOVED. THE CONTRACTOR SHALL REMOVE AND DISPOSE OF SILT ACCUMULATIONS AT BAGGED STONE WHEN SO DIRECTED BY THE ENGINEER. BAGS SHALL BE REMOVED AND REPLACED WHENEVER THE ENGINEER DETERMINES THAT THEY HAVE DETERIORATED AND LOST THEIR EFFECTIVENESS.

NO SEPARATE PAYMENT WILL BE MADE FOR THIS WORK AND THE ENTIRE COST OF THIS WORK SHALL BE INCLUDED IN THE UNIT CONTRACT PRICE FOR THE SEVERAL PAY ITEMS.

### TEMPORARY DRAINAGE AT END BENT

### BAR TYPES

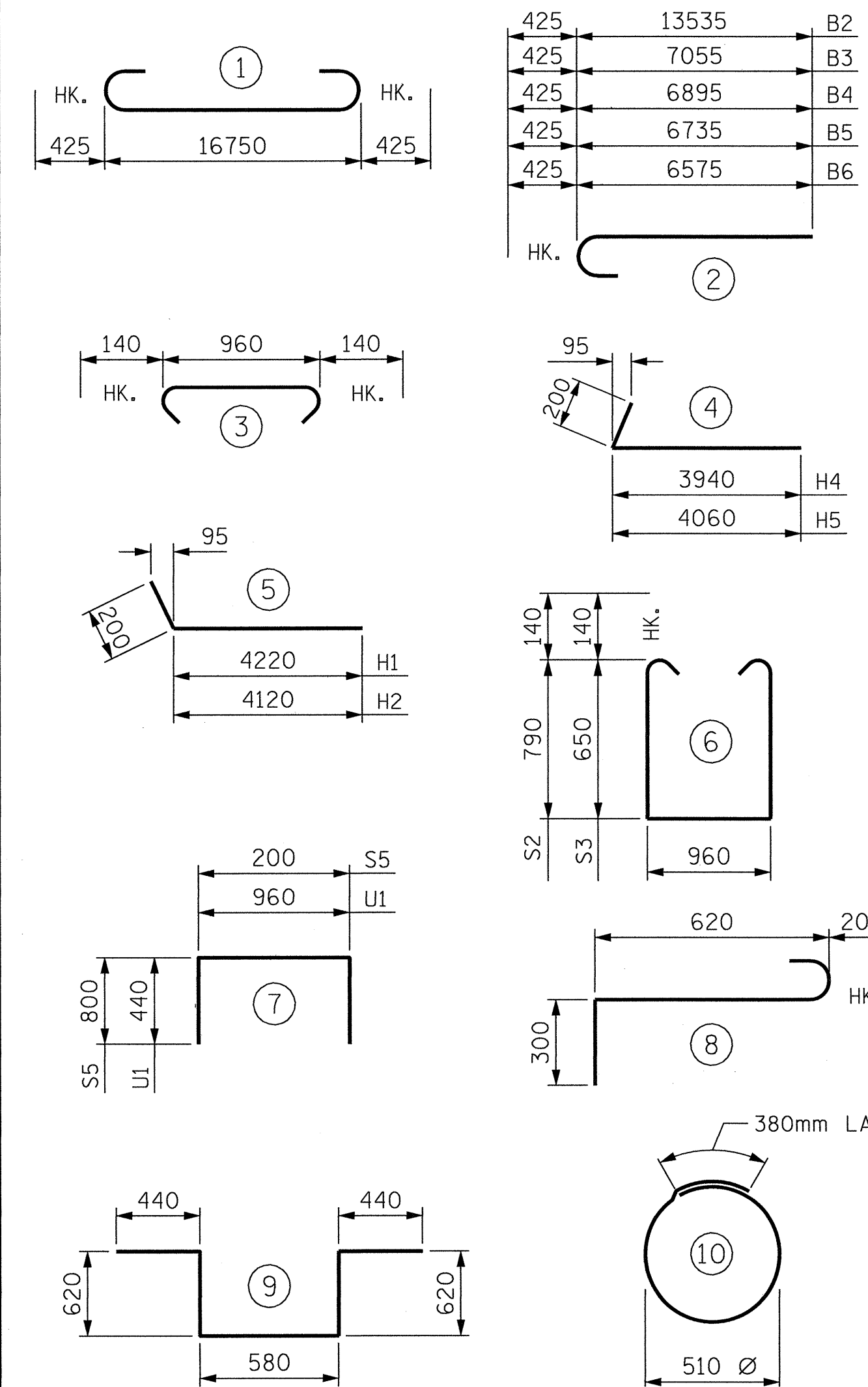

ALL BARS DIMENSIONS ARE OUT TO OUT.

### BILL OF MATERIAL

#### END BENT #2

BAR	NUMBER	SIZE	TYPE	LENGTH	WEIGHT
B1	4	32	1	17600	451
B2	4	32	2	13960	358
B3	1	32	2	7480	48
B4	1	32	2	7320	47
B5	1	32	2	7160	46
B6	1	32	2	7000	45
B7	2	16	STR.	16740	52
B8	2	16	STR.	3960	12
B9	8	13	STR.	8760	70
B10	14	13	STR.	960	13
B11	8	13	STR.	900	7
H1	11	16	5	4420	75
H2	11	16	5	4320	74
H3	8	16	STR.	1000	12
H4	10	16	4	4140	64
H5	10	16	4	4260	66
K1	20	13	STR.	8760	174
S1	61	16	3	1240	117
S2	26	16	6	2820	114
S3	35	16	6	2540	138
S4	12	13	10	1980	24
S5	49	13	7	1800	88
S6	2	19	9	2700	12
S7	6	19	8	1120	15
U1	8	13	7	1840	15
V1	98	16	STR.	2080	316
V2	36	16	STR.	2700	151
V3	36	16	STR.	2480	139

REINFORCING STEEL KG. 2743

CLASS A CONCRETE  
 POUR #1 CAP & LOWER PORTION OF WING CU. METERS 18.2  
 POUR #2 BACKWALL & UPPER PORTION OF WING CU. METERS 11.8

CLASS A CONCRETE CU. METERS 30.0

HP 310x79 STEEL PILES NO. 8 METERS 136.0

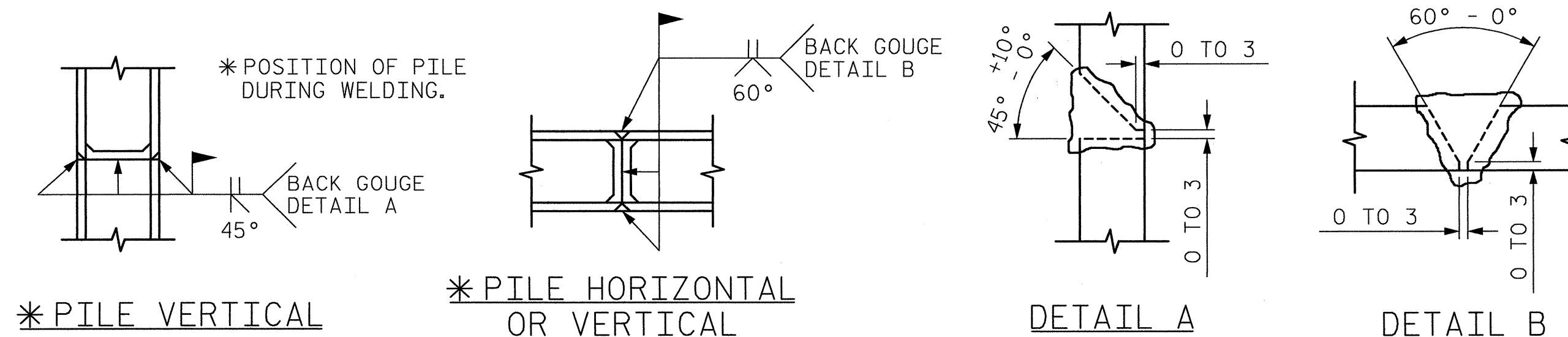

### PILE SPLICE DETAILS

PROJECT NO. **R-2552B**  
**JOHNSTON** COUNTY  
 STATION: **97+59.319-L-LT POC**

SHEET 3 OF 3

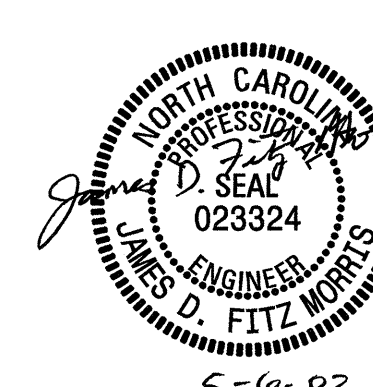

**CTE ENGINEERS**  
 CONSOER TOWNSEND ENVIRONMENTAL ENGINEERS, INC.  
 1325 SOUTH POINT BOULEVARD, SUITE 400  
 CHARLOTTE, NORTH CAROLINA 28273-5820  
 (704) 583-0902

STATE OF NORTH CAROLINA  
 DEPARTMENT OF TRANSPORTATION  
 RALEIGH  
**SUBSTRUCTURE**  
**END BENT 2**

REVISIONS						SHEET NO.
NO.	BY:	DATE:	NO.	BY:	DATE:	
1			3			5-107
2			4			TOTAL SHEETS (13)

DRAWN BY: MSB  
 CHECKED BY: JDF  
 DATE: 05/01/02  
 DATE: 05/01/02