

BENCH MARK: #BL-5 BL STA. 118+72.347
 144.943m RT.
 ELEV. 69.536 NGVD 1929

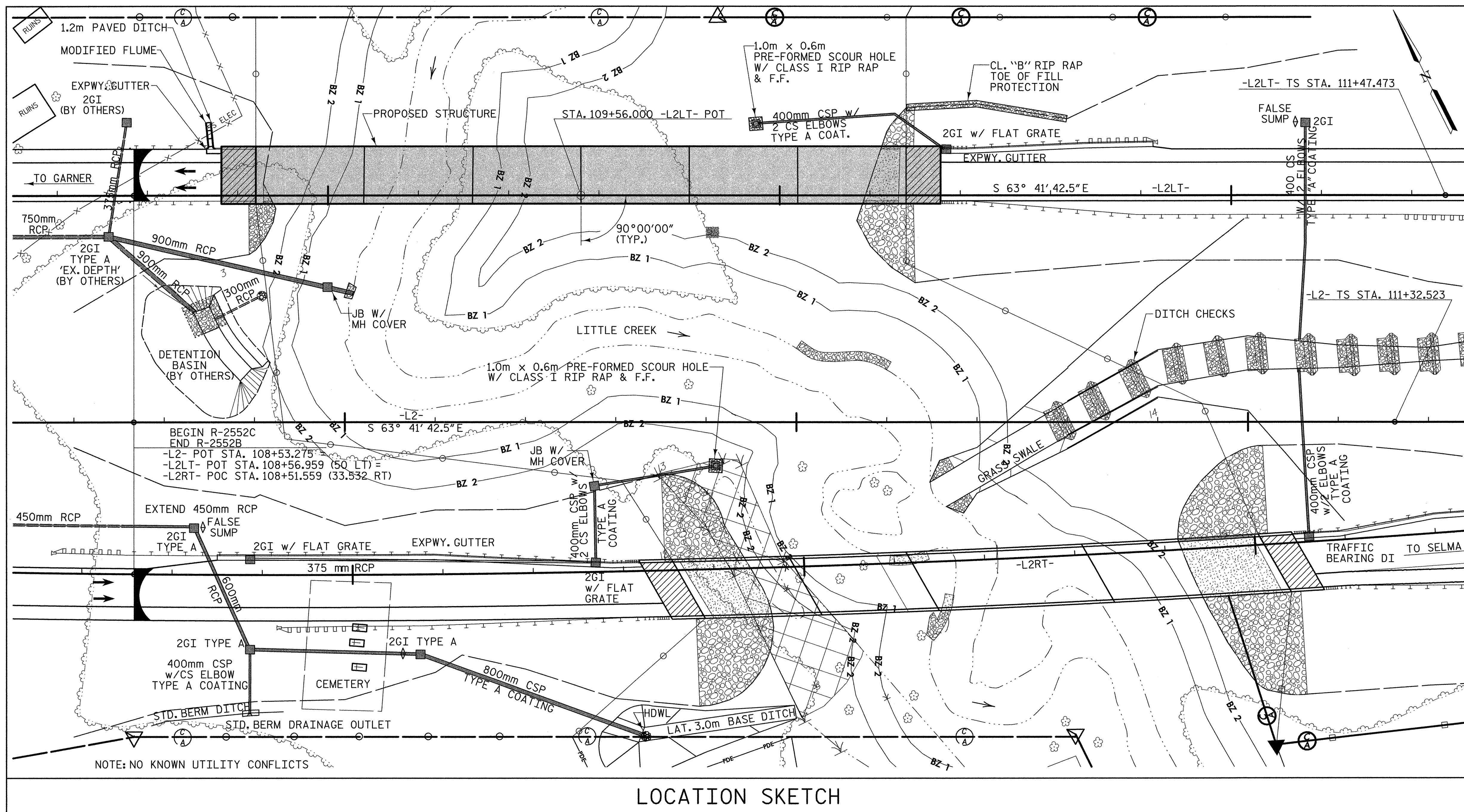

LOCATION SKETCH



PROJECT NO. R-2552C
JOHNSTON COUNTY
 STATION: 109+56.000 -L2LT- POT

SHEET 3 OF 4

STATE OF NORTH CAROLINA
 DEPARTMENT OF TRANSPORTATION
 RALEIGH

GENERAL DRAWING FOR
 BRIDGE ON US 70 BYPASS OVER
 LITTLE CREEK
 BETWEEN GARNER AND SELMA
 (LEFT LANE)

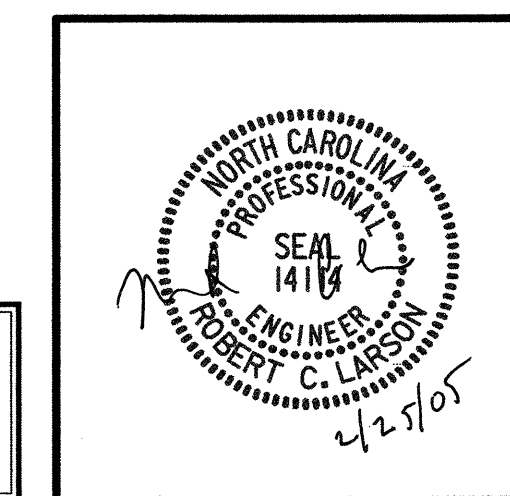

REVISIONS						SHEET NO.
NO.	BY:	DATE:	NO.	BY:	DATE:	TOTAL SHEETS
1			3			431
2			4			431

REFERENCE NO. BL-3

02/21/2005 06:55:05 AM F:\Structures\Site\NLeff\Lane\R2552C-SD_00.dgn

DRAWN BY: W. B. ALLEN DATE: 6/04
 CHECKED BY: R. C. LARSON DATE: 7/04