

PROJECT REFERENCE NO. R-2552C	SHEET NO. 2-E
R/W SHEET NO.	
ROADWAY DESIGN ENGINEER	STATE PAVEMENT DESIGN ENGINEER
CONST.REV.	
R/W REV.	

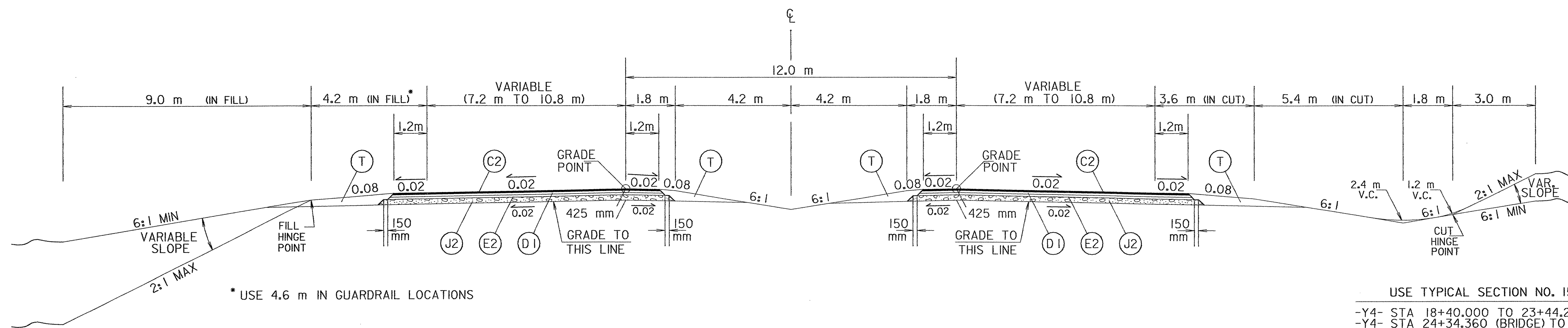

TYPICAL SECTION NO. 15

USE TYPICAL SECTION NO. 15 AS FOLLOWS:  
 -Y4- STA 18+40.000 TO 23+44.253 (BRIDGE) (RT)  
 -Y4- STA 24+34.360 (BRIDGE) TO 29+20.000 (RT)  
 -Y4- STA 17+60.000 TO 23+58.627 (BRIDGE) (LT)  
 -Y4- STA 24+48.692 (BRIDGE) TO 26+90.000 (LT)

(C1)	40mm S9.5C
(C2)	80 mm S9.5C
(C3)	100mm S12.5C
(C4)	60mm SF9.5A
(C5)	VAR S9.5C
(C6)	VAR. S12.5C
(C7)	VAR. SF9.5A
(D1)	65mm 119.0C
(D2)	80mm 119.0C
(D3)	100mm 119.0C
(D4)	Var. 119.0C
(E1)	75mm B25.0C
(E2)	80mm B25.0C
(E3)	100mm B25.0B
(E4)	140mm B25.0B
(E5)	200mm B25.0C
(E6)	VAR B25.0B
(E7)	VAR B25.0C
(E8)	170mm B25.0C
(J1)	150mm ABC
(J2)	200mm ABC
(J3)	250mm ABC
(J4)	150mm INCD. STONE
(K)	200mm LIME SUBBASE (OR) 180mm CEMENT SUBBASE
(P)	PRIME COAT
(R1)	750mm CURB & GUTTER
(R2)	SHOULDER BERM GUTTER
(R3)	175mm MONO. ISLAND
(T)	EARTH MATERIAL
(U)	EXIST. PAVEMENT
(W)	ASPH. WEDGING

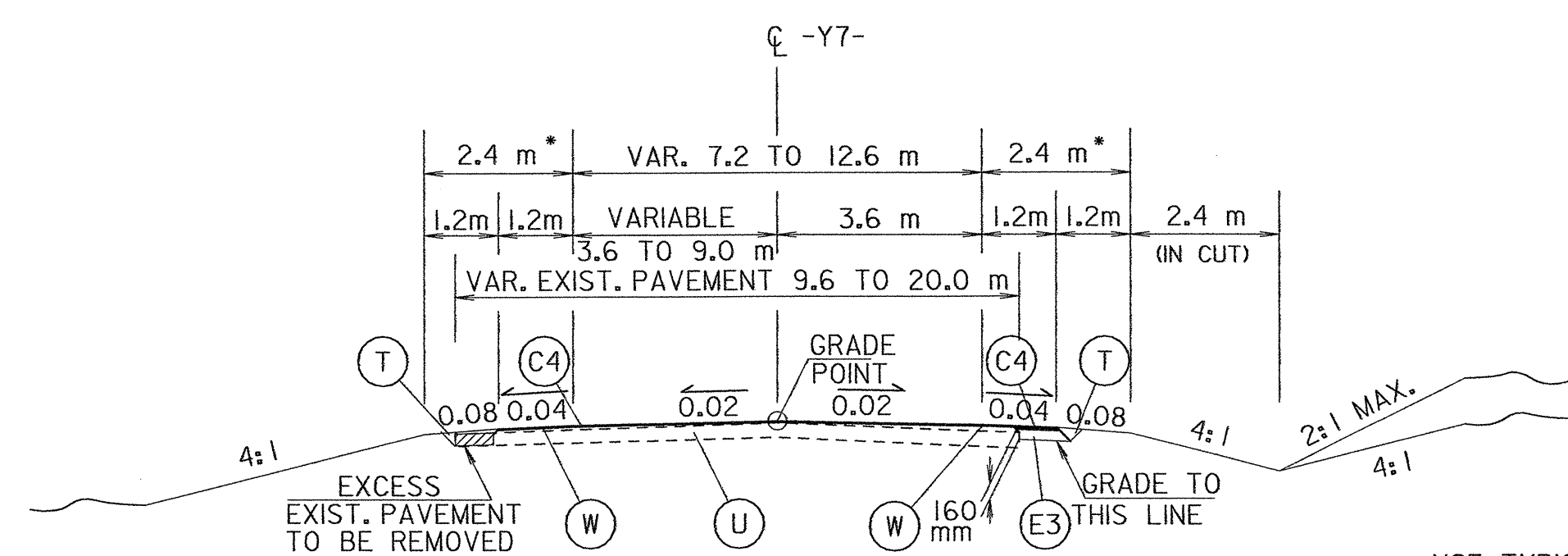

TYPICAL SECTION NO. 16

USE TYPICAL SECTION NO. 16 AS FOLLOWS:  
 -Y7- STA 10+59.100 TO 12+30.000  
 \* (NOTE: SOME LOCATIONS HAVE THE PROPOSED GRADE WITH SHOULDER CONSTRUCTION ONLY - SEE CROSS-SECTIONS)

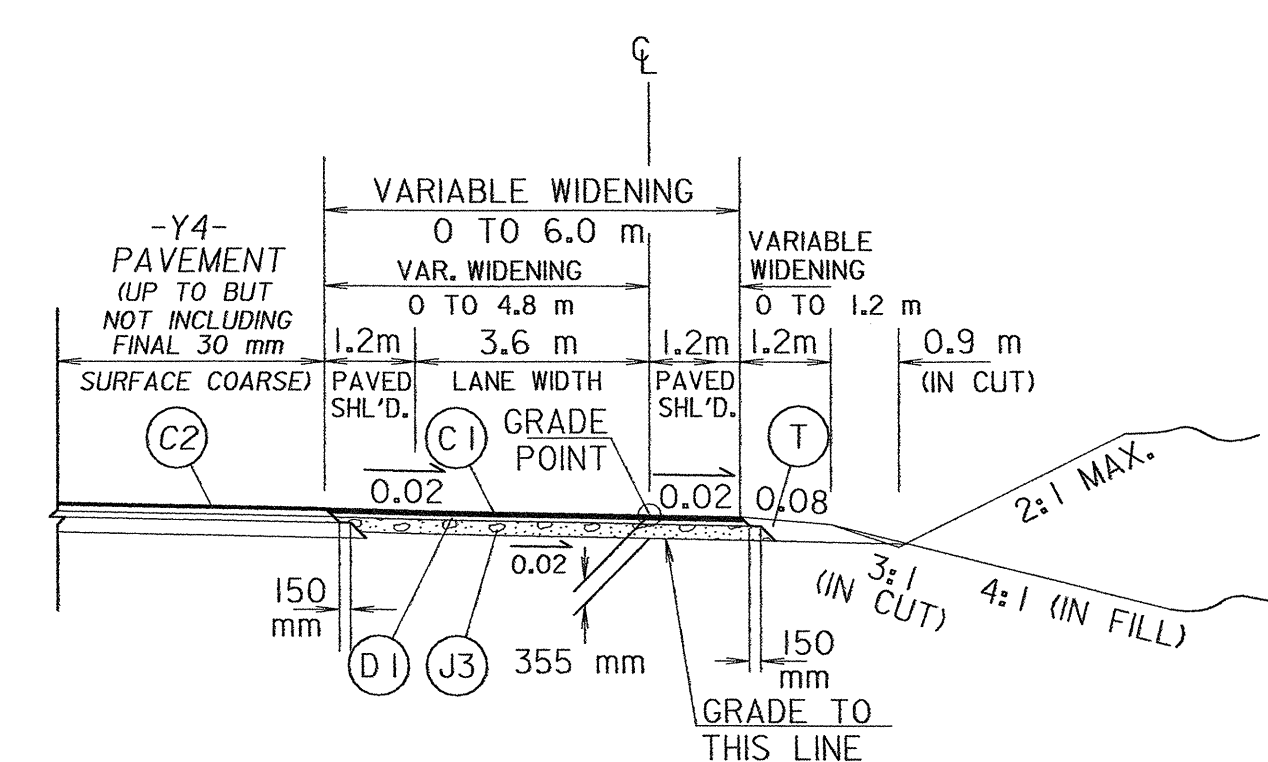

TYPICAL SECTION NO. 17

USE TYPICAL SECTION NO. 17 AS FOLLOWS:  
 -Y4A- STA 26+23.592 TO 29+32.066  
 -Y4B- STA 38+10.740 TO 40+52.538  
 -Y4- TEMPORARY WIDENING AT STA 25+10.000 TO 27+02.7  
 SEE PLAN SHEETS 15 & 16  
 (USE IN CONJUNCTION WITH -Y4- TYP. SECT'S.)

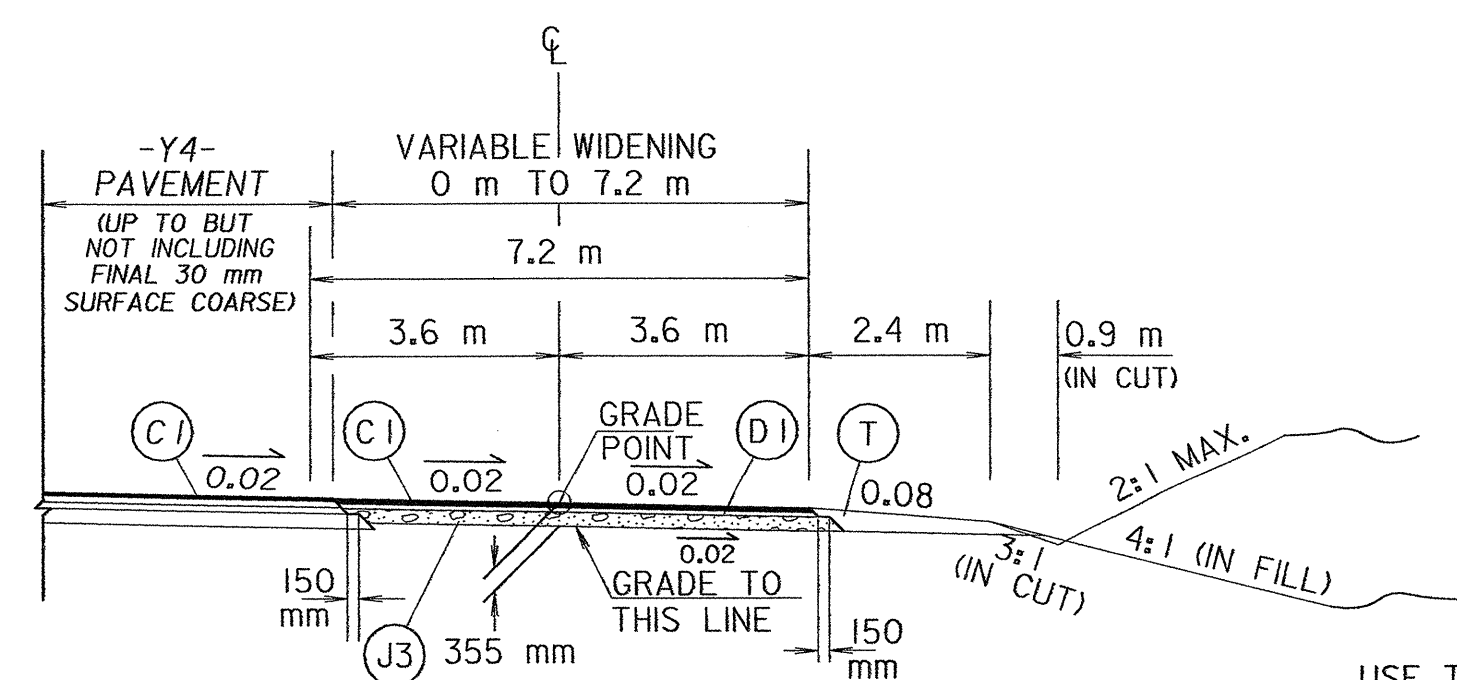

TYPICAL SECTION NO. 18

USE TYPICAL SECTION NO. 18 AS FOLLOWS:  
 -Y4DET- STA 23+80.000 TO 28+00.000  
 (USE IN CONJUNCTION WITH -Y4- TYP. SECT'S.)

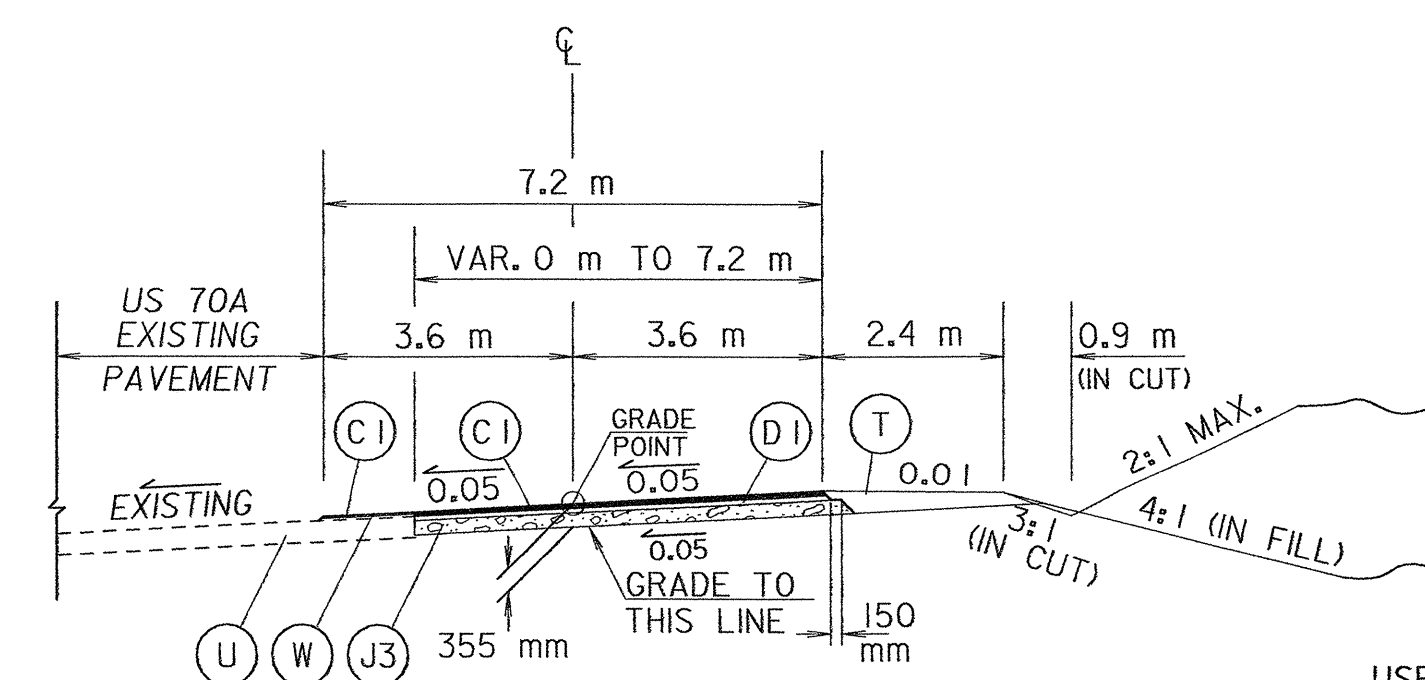

TYPICAL SECTION NO. 19

USE TYPICAL SECTION NO. 19 AS FOLLOWS:  
 -Y4DET- STA 28+00.000 TO 29+47.032

12-MAR-2006 10:34 AM  
 4512755.DWG  
 R-2552C-RDY-TYP.DGN  
 5/21/05