

REVISIONS

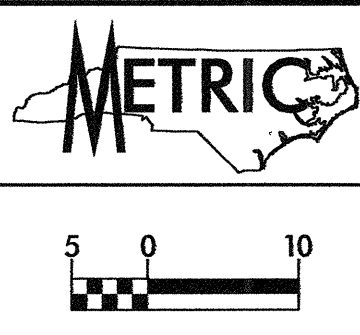

PROJECT REFERENCE NO. R-2552C	SHEET NO. 27
R/W SHEET NO.	
ROADWAY DESIGN ENGINEER	HYDRAULICS ENGINEER
CONST. REV.	
R/W REV.	

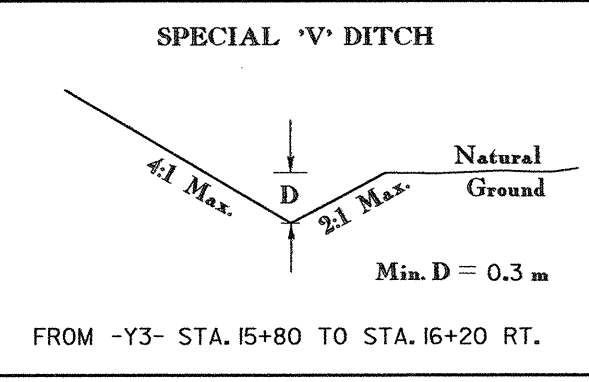
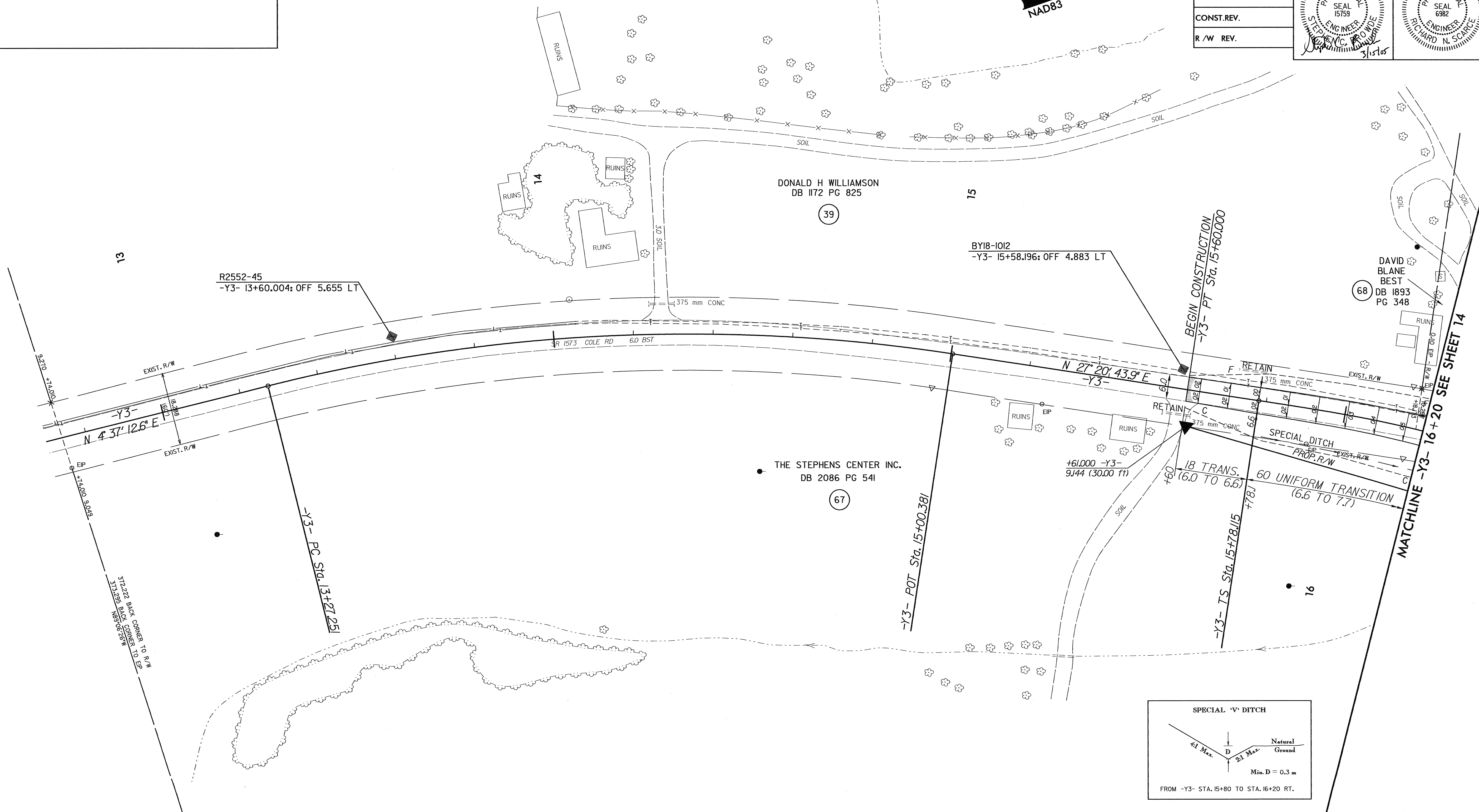

-Y3-
PI Sta 14+14.969
Δ = 22° 43' 31.3" (RT)
L = 173.130
T = 87.718
R = 436.5
SE = Existing
Runoff = Existing
DS = 65 km/h

Pis Sta 16+18.199
Δ = 11° 27' 33.0"
Ls = 60.000
LT = 40.084
ST = 20.077

-Y3-
PI Sta 17+59.785
Δ = 78° 05' 35.3" (RT)
L = 204.447
T = 121.670
R = 150.000
SE = 0.08
DS = 65 km/h

Pis Sta 18+62.639
Δ = 11° 27' 33.0"
Ls = 60.000
LT = 40.084
ST = 20.077

-Y3- GRADE SEE
PROFILE SHEET 52

LOCHNER
H. W. LOCHNER, INC.
2840 PLAZA PLACE, SUITE 202
RALEIGH, NC 27612

18-15182-C02E-1046-R2552C-BODY-PSH27.DGN
3/15/2018 9:41:11 AM WSRAL-RENO