

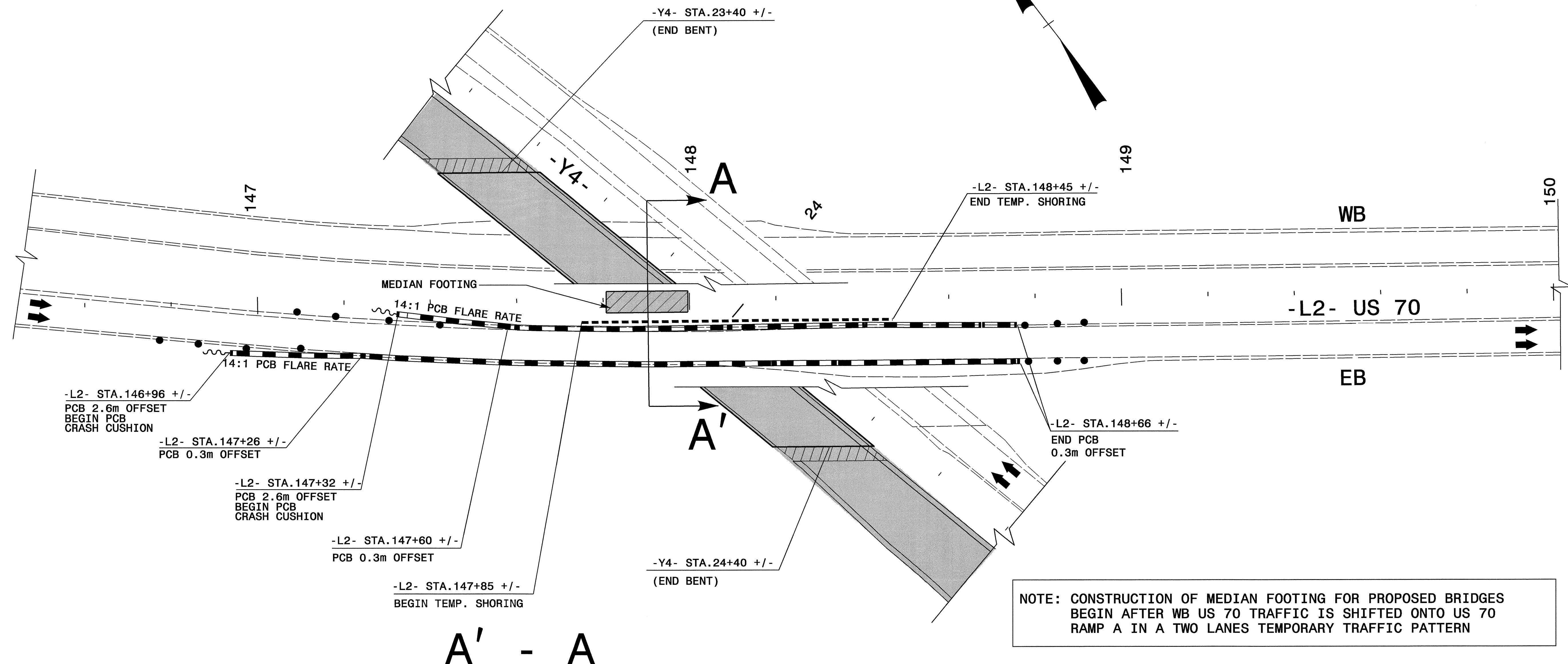

PROJ. REFERENCE NO.	SHEET NO.
R-2552B&C	TCP-18



NOTE: CONSTRUCTION OF MEDIAN FOOTING FOR PROPOSED BRIDGES BEGIN AFTER WB US 70 TRAFFIC IS SHIFTED ONTO US 70 RAMP A IN A TWO LANES TEMPORARY TRAFFIC PATTERN

A' - A

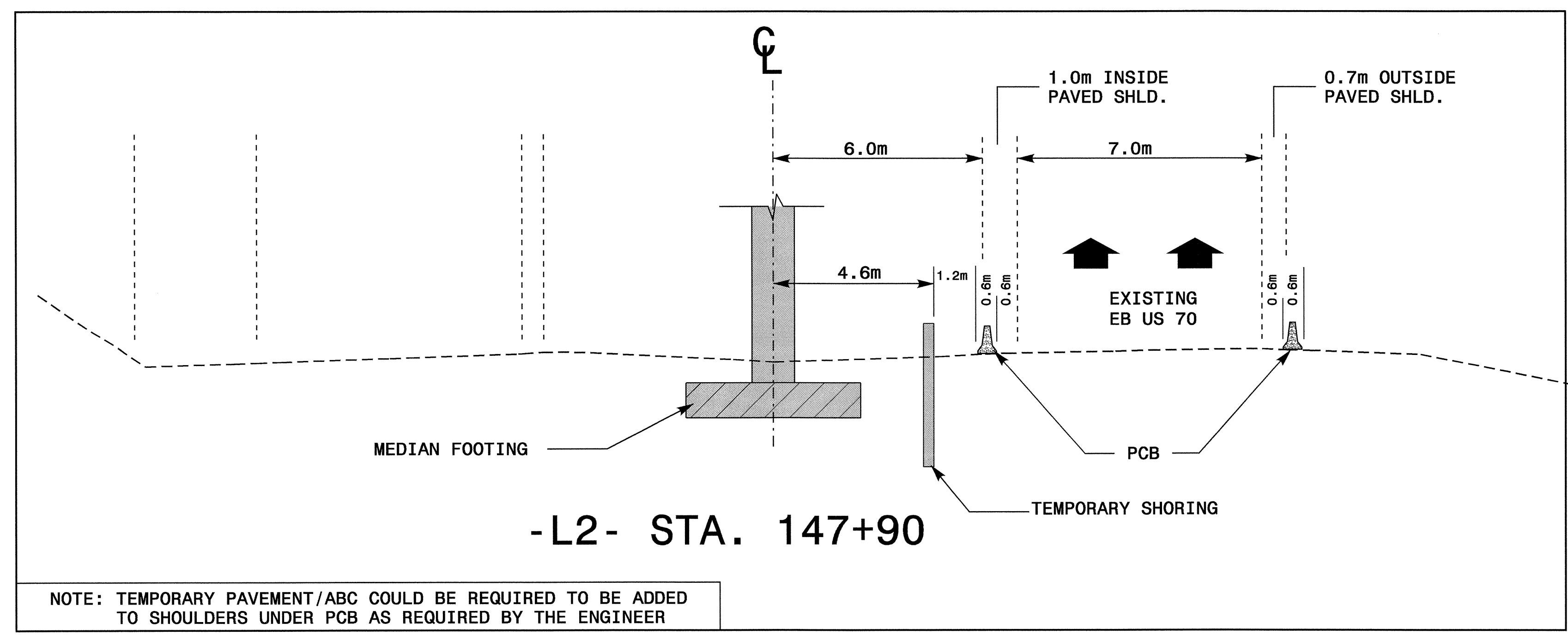

"FOR DESIGN OF TEMPORARY SHORING, USE THE FOLLOWING SOIL PARAMETERS:
 UNIT WEIGHT OF SOIL ABOVE WATER TABLE, $\gamma = 120$ pcf
 UNIT WEIGHT OF SOIL BELOW WATER TABLE, $\gamma' = 60$ pcf
 FRICTION ANGLE, $\phi = 30^\circ$
 COHESION, $c = 0$ psf"

NOTE: TEMPORARY PAVEMENT/ABC COULD BE REQUIRED TO BE ADDED TO SHOULDERS UNDER PCB AS REQUIRED BY THE ENGINEER

APPROVED: *Joseph Ishak* DATE: 2/2/05

SEAL
 PROFESSIONAL ENGINEER
 JOSEPH ISHAK

AREA IV, PHASE I DETAIL 3

SCALE:	NONE		<table border="1"> <tr> <th colspan="2">REVISIONS</th> </tr> <tr> <td> </td> <td> </td> </tr> <tr> <td> </td> <td> </td> </tr> <tr> <td> </td> <td> </td> </tr> </table>	REVISIONS							
REVISIONS											
DATE:	JAN. 2005										
DWG. BY:	HAL										
DESIGN BY:	HAL										
REVIEWED BY:	JLP	<table border="1"> <tr> <td> </td> <td> </td> </tr> <tr> <td> </td> <td> </td> </tr> </table>									

01-FEB-2005 07:14
 \\sfs-cgts01\p2552B&C\TCP\AREA\IV R-2552B&C.TC.BTop.dgn
 halawindos AT 11/22/04