

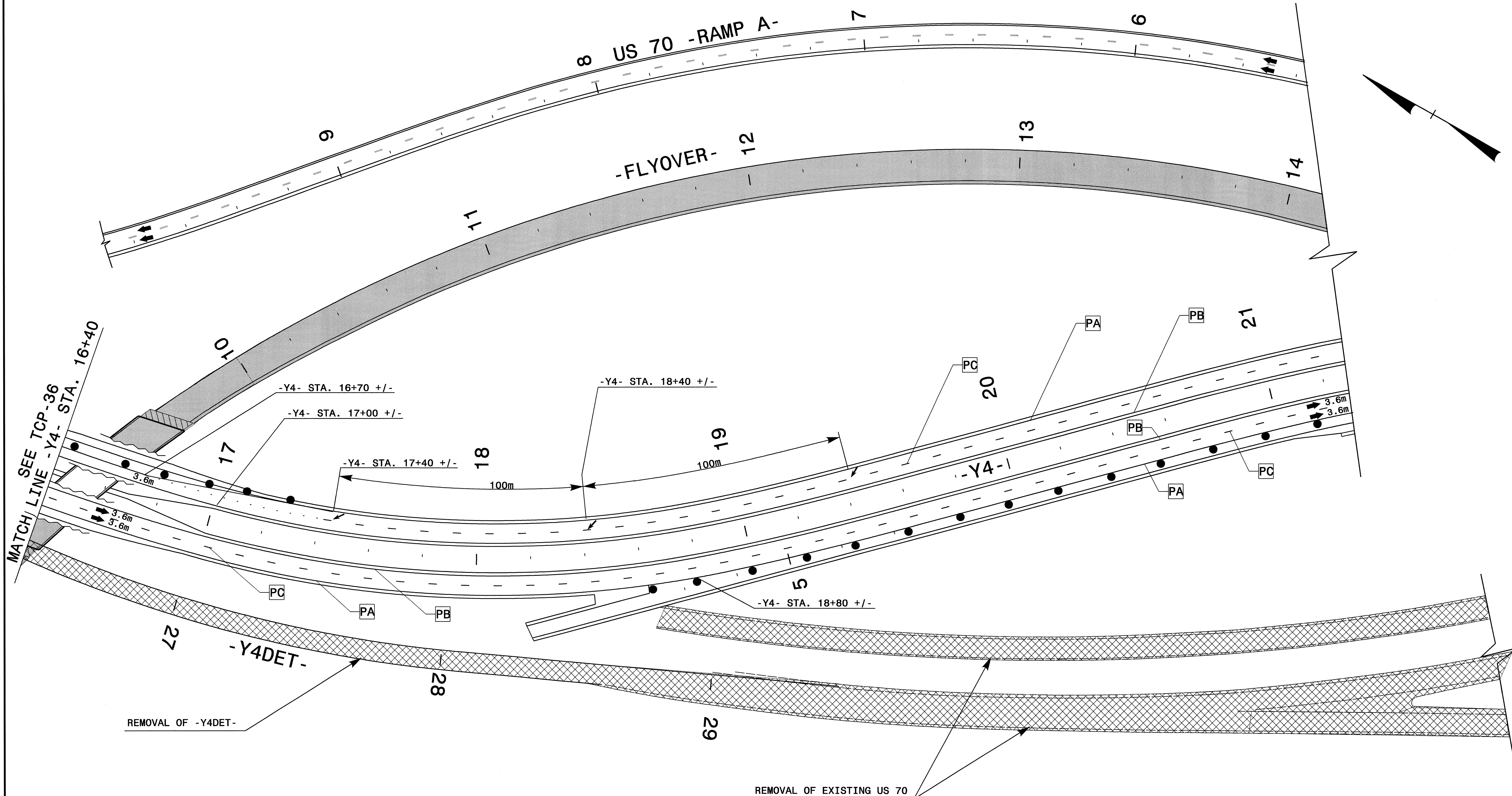

PROJ. REFERENCE NO. R-2552B&C	SHEET NO. TCP-37
----------------------------------	---------------------



REFER TO TCP- 3 FOR TEMPORARY PAVEMENT MARKINGS SCHEDULE

TEMPORARY MARKINGS PLACED IN PREVIOUS PHASES/ EXISTING MARKINGS

**LEGEND**

APPROVED: *Joseph Ishak* DATE: 2/2/05

SEAL

**AREA IV, PHASE III - DETAIL 2  
TEMPORARY PAVEMENT MARKING PLAN**

SCALE:	NONE
DATE:	JAN. 2005
DWG. BY:	HAL
DESIGN BY:	HAL
REVIEWED BY:	JLP

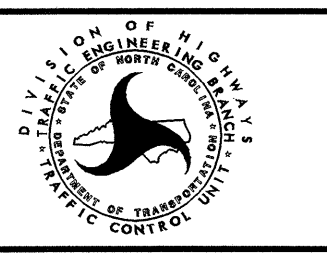

REVISIONS	

O:\FEB-2005\_07\06  
 \c:\fs01\2552B&C\TCP\AREAIV R-2552B&C.TC.BTCP.dgn  
 halwando AT TETC206424