

PROJECT REFERENCE NO.	SHEET NO.
R-2552B	I-A
LOCATION AND SURVEYS	

SURVEY CONTROL SHEET R2552B

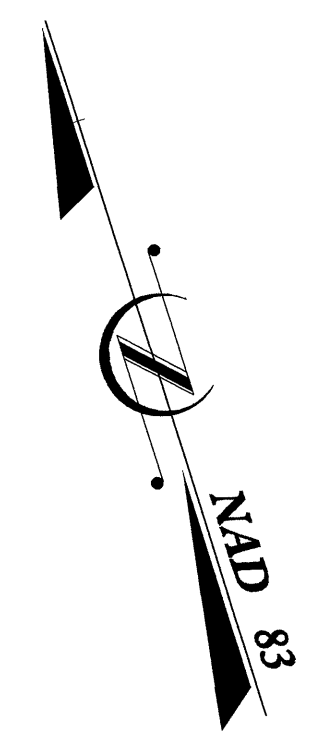

GPS CONTROL

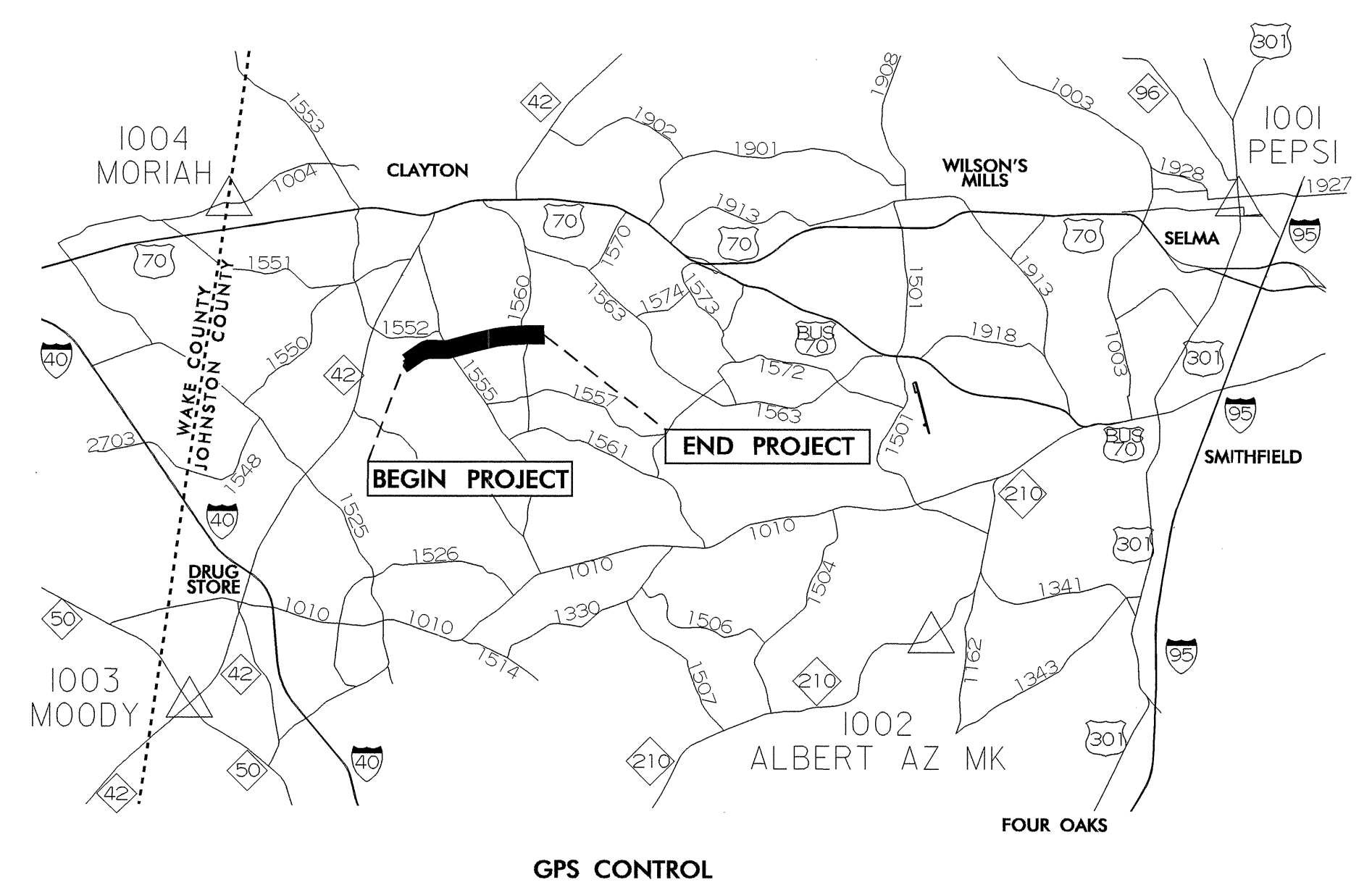
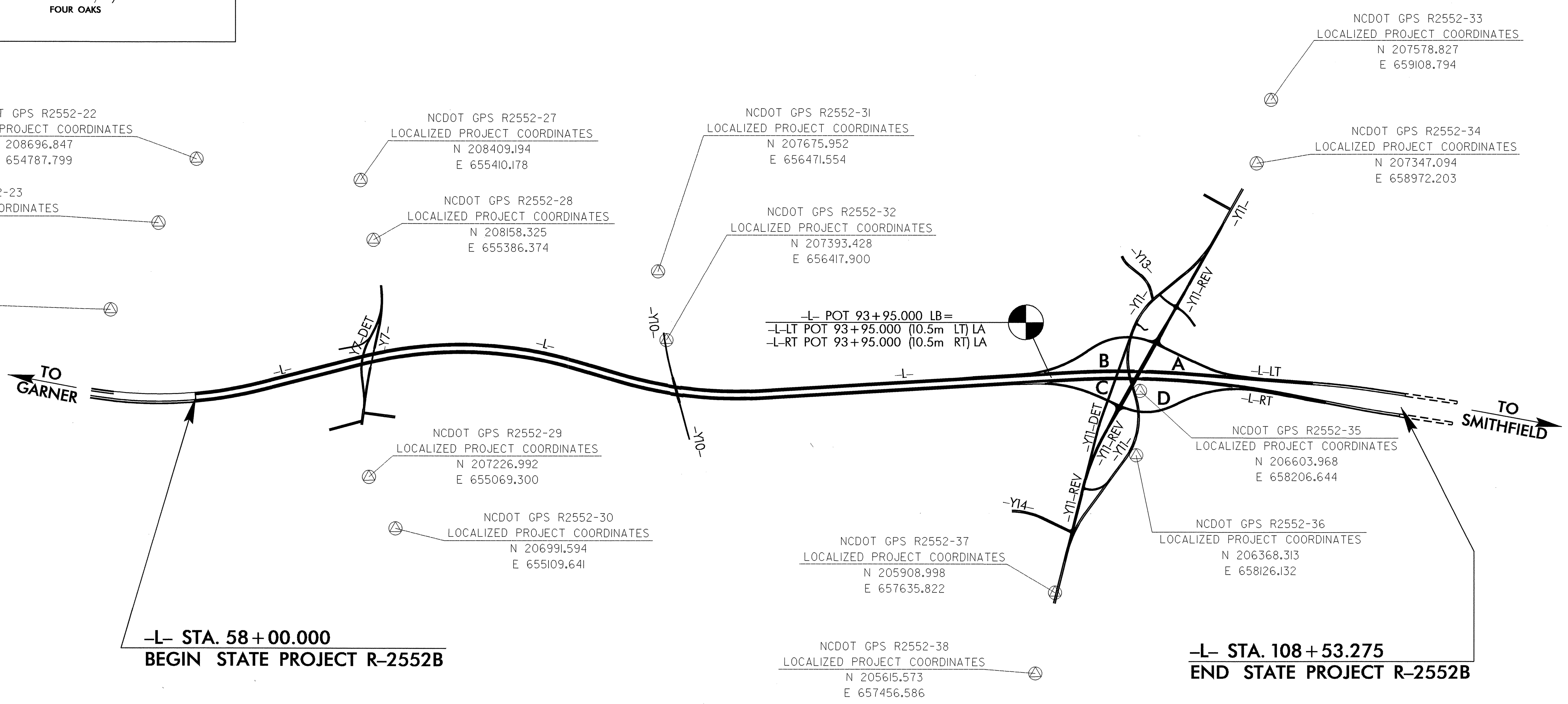

NCDOT GPS R2552-22
LOCALIZED PROJECT COORDINATES
N 208696.847
E 654787.799

NCDOT GPS R2552-23
LOCALIZED PROJECT COORDINATES
N 208495.212
E 654557.694

NCDOT GPS R2552-24
LOCALIZED PROJECT COORDINATES
N 208213.718
E 654259.332

NCDOT GPS R2552-25
LOCALIZED PROJECT COORDINATES
N 207523.632
E 653286.062

NCDOT GPS R2552-26
LOCALIZED PROJECT COORDINATES
N 207388.575
E 652885.212

NCDOT GPS R2552-27
LOCALIZED PROJECT COORDINATES
N 208409.194
E 655410.178

NCDOT GPS R2552-28
LOCALIZED PROJECT COORDINATES
N 208158.325
E 655386.374

NCDOT GPS R2552-29
LOCALIZED PROJECT COORDINATES
N 207226.992
E 655069.300

NCDOT GPS R2552-30
LOCALIZED PROJECT COORDINATES
N 206991.594
E 655109.641

NCDOT GPS R2552-31
LOCALIZED PROJECT COORDINATES
N 207675.952
E 656471.554

NCDOT GPS R2552-32
LOCALIZED PROJECT COORDINATES
N 207393.428
E 656417.900

-L- POT 93+95.000 LB=
-L-LT POT 93+95.000 (10.5m LT) LA
-L-RT POT 93+95.000 (10.5m RT) LA

NCDOT GPS R2552-37
LOCALIZED PROJECT COORDINATES
N 205908.998
E 657635.822

NCDOT GPS R2552-38
LOCALIZED PROJECT COORDINATES
N 205615.573
E 657456.586

NCDOT GPS R2552-33
LOCALIZED PROJECT COORDINATES
N 207578.827
E 659108.794

NCDOT GPS R2552-34
LOCALIZED PROJECT COORDINATES
N 207347.094
E 658972.203

NCDOT GPS R2552-35
LOCALIZED PROJECT COORDINATES
N 206603.968
E 658206.644

NCDOT GPS R2552-36
LOCALIZED PROJECT COORDINATES
N 206368.313
E 658126.132

DATUM DESCRIPTION

THE LOCALIZED COORDINATE SYSTEM DEVELOPED FOR THIS PROJECT IS BASED ON THE STATE PLANE COORDINATES ESTABLISHED BY NCGS FOR MONUMENT "LAKE DAM"
WITH NAD 83 STATE PLANE GRID COORDINATES OF
NORTHING: 222085.5690(m) EASTING: 636096.3610(m)
THE AVERAGE COMBINED GRID FACTOR USED ON THIS PROJECT (GROUND TO GRID) IS: 0.999893375
THE N.C. LAMBERT GRID BEARING AND LOCALIZED HORIZONTAL GROUND DISTANCE FROM "LAKE DAM" TO -L- STATION 58+00.000 IS
S 52°04'44.86" E 23,310.5113m
ALL LINEAR DIMENSIONS ARE LOCALIZED HORIZONTAL DISTANCES
VERTICAL DATUM USED IS NGVD 29

NOTES:

- THE CONTROL DATA FOR THIS PROJECT CAN BE FOUND ELECTRONICALLY BY SELECTING PROJECT CONTROL DATA AT:
[HTTP://WWW.DOH.DOT.STATE.NC.US/PRECONSTRUCTHIGHWAYLOCATIONPROJECT](http://www.doh.dot.state.nc.us/preconstructhighwaylocationproject)
FILES : R2552B_LS_CONTROL_041021.TXT & R2552B_LS_BASELINE_041021.TXT
- INDICATES GEODETIC CONTROL MONUMENTS USED OR SET FOR HORIZONTAL PROJECT CONTROL BY THE NCDOT LOCATION AND SURVEYS UNIT.
- PROJECT CONTROL ESTABLISHED UTILIZING GLOBAL POSITIONING SYSTEM.
- CONTROL NETWORK ESTABLISHED USING STATIC GPS FROM EXISTING NCGS MONUMENTATION.
- SITE CALIBRATION INFORMATION HAS NOT BEEN PROVIDED FOR THIS PROJECT.
- IF FURTHER INFORMATION IS NEEDED, PLEASE CONTACT THE LOCATION AND SURVEYS UNIT.

NOTE: DRAWING NOT TO SCALE