



CONST. REV.

R / W REV.

PROJECT REFERENCE NO.

R-2552B

ROADWAY DESIGN ENGINEER

ENGINEER

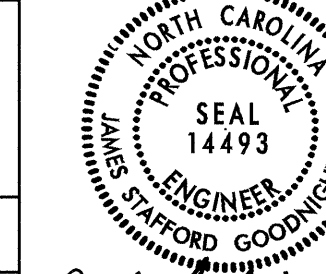

3-17-05

SHEET NO.

27

HYDRAULICS ENGINEER

ENGINEER



3-17-05

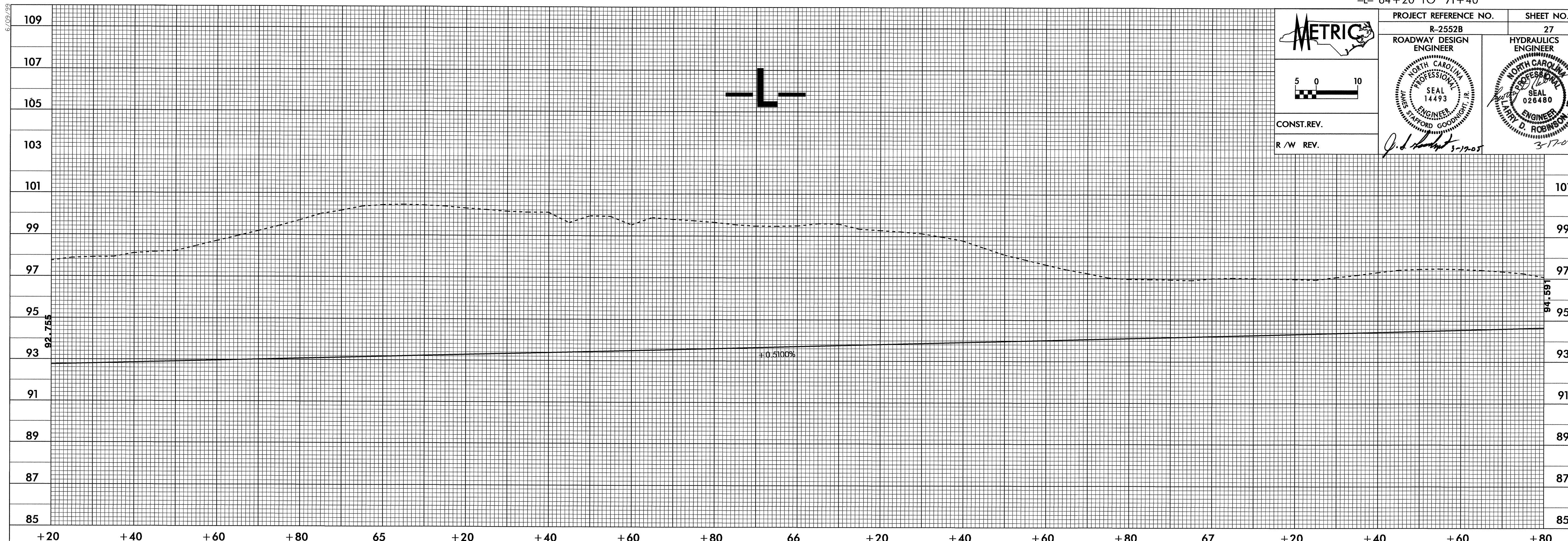

BM BL-1 VERTICAL RR SPIKE IN ROOT OF 0.25m WALNUT TREE 127.860m RT -BL- STA 71+19.382 EL 123.990m

PIPE HYDRAULIC DATA	
DRAINAGE STRUCTURE NO. 23	
DRAINAGE AREA	= 35.2 ha
DESIGN FREQUENCY	= 50 yrs
DESIGN DISCHARGE	= 4.51 cms
DESIGN HW ELEVATION	= 93.440 m
100 YEAR DISCHARGE	= 5.25 cms
100 YEAR HW ELEVATION	= 93.570 m
OVERTOPPING FREQUENCY	= - yrs
OVERTOPPING DISCHARGE	= - cms
OVERTOPPING ELEVATION	= - m

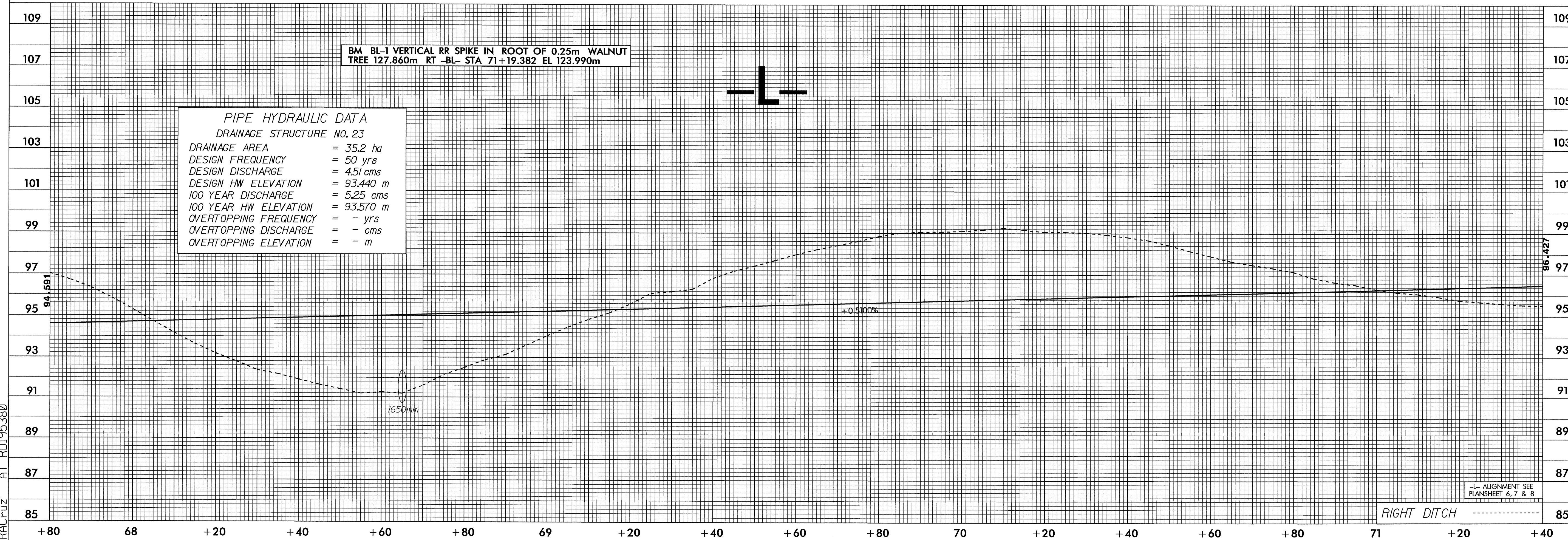

31-JAN-2005 15:03  
 RACRUZ AT RD195380

-L- ALIGNMENT SEE PLANSHEET 6.7 & 8

RIGHT DITCH