

6/09/99

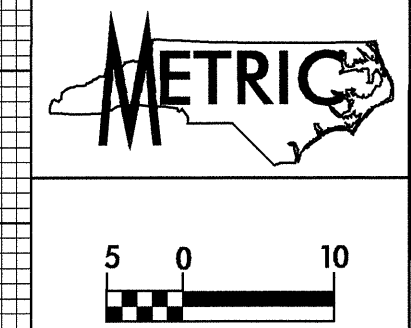

PROJECT REFERENCE NO. R-2552B	SHEET NO. 39
ROADWAY DESIGN ENGINEER SEAL 14493	HYDRAULICS ENGINEER SEAL 026480
NORTH CAROLINA PROFESSIONAL ENGINEERS WALTER S. AFFORD GOODRIGHT LARRY D. ROBINSON 3-17-05	

-Y11REV-

STRUCTURE HYDRAULIC DATA	
DESIGN DISCHARGE	= 95 cms
DESIGN FREQUENCY	= 25 yrs
DESIGN HW ELEVATION	= 61.61 m
BASE DISCHARGE	= 119 cms
BASE FREQUENCY	= 100 yrs
BASE HW ELEVATION	= 61.87 m
OVERTOPPING DISCHARGE	= -- cms
OVERTOPPING FREQUENCY	= >500 yrs
OVERTOPPING ELEVATION	= 63.21 m

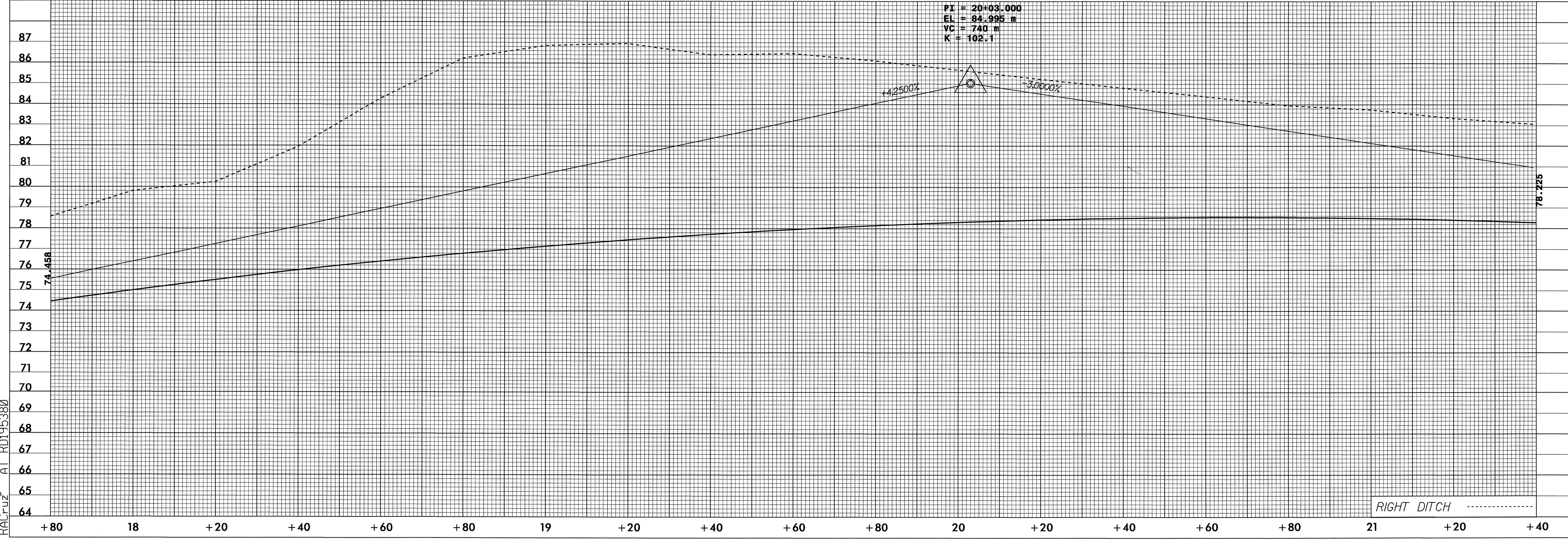
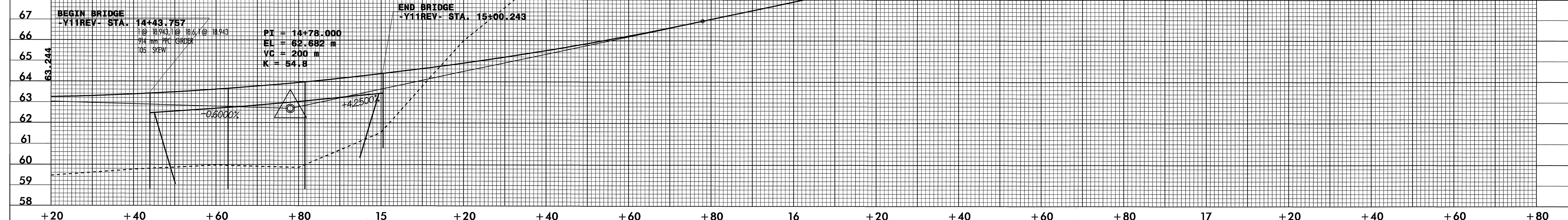

31-JAN-2005 14:57
 RACruz AL RD195380