

PHASE TWO

STEP 1

- a) USING TEMPORARY LANE CLOSURES AND NCDOT STANDARDS 1101.02, SHEET 1 OF 7, INSTALL TEMPORARY PAVEMENT MARKINGS AT THE FOLLOWING LOCATIONS:
 -L- STA. 17+85 +/- TO -L- STA. 30+50 +/-
- b) INSTALL PORTABLE CONCRETE BARRIER WHICH CAN BE PLACED AWAY FROM TRAFFIC.
- c) REMOVE CONFLICTING PAVEMENT MARKINGS AND SHIFT TRAFFIC INTO TEMPORARY TRAFFIC PATTERN OF ONE-LANE, TWO-WAY TRAFFIC. COMPLETE PLACEMENT OF PORTABLE CONCRETE BARRIER.

STEP 2

- REMOVE THE SOUTH HALF OF EXISTING BRIDGE AT -L- STA. 23+67 +/- TO -L- STA. 24+63 +/- OVER COREYS DITCH

STEP 3

- a) CONSTRUCT THE SOUTHERN HALF OF PROPOSED BRIDGE OVER COREYS DITCH FROM -L- STA. 23+28 +/- TO -L- STA. 25+08 +/-
- b) CONSTRUCT UNDERCUT, ROADWAY, PAVED SHOULDER, TEMPORARY SHORING, GUARDRAIL AND PARKING AREA UP TO BUT NOT INCLUDING THE FINAL LAYER OF SURFACE COURSE, OF PROPOSED NC 615 (-L-) AS SHOWN BELOW.

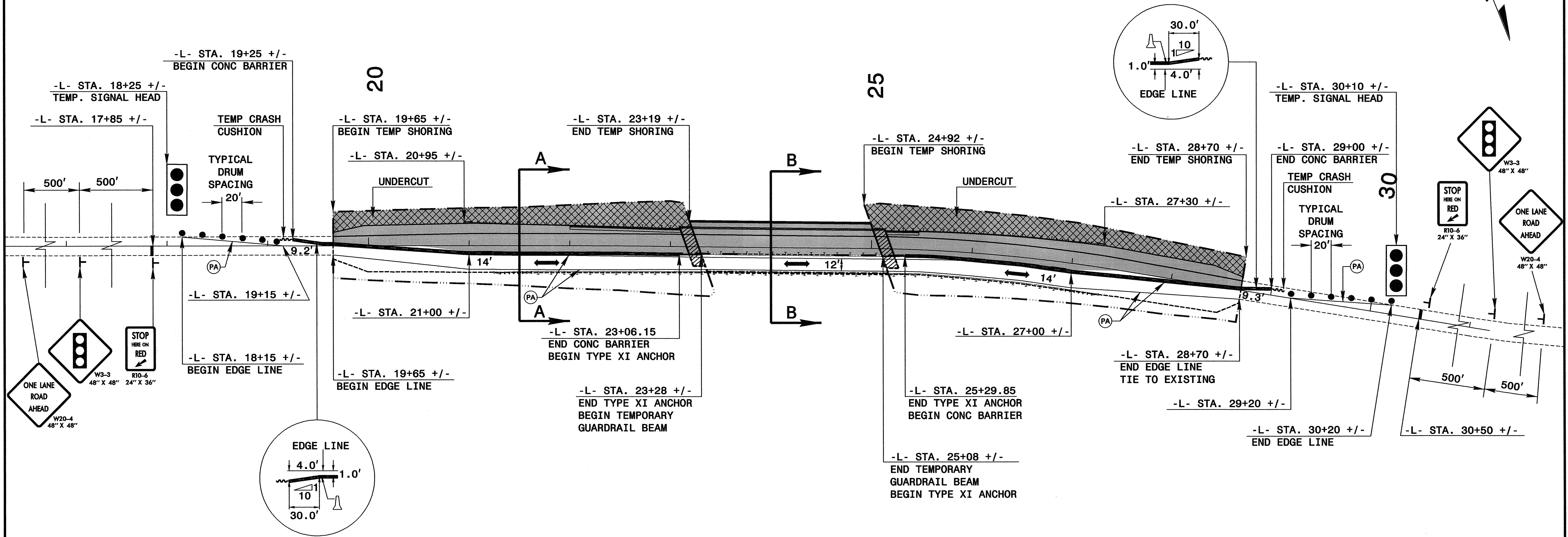

SECTION A-A
-L- STA. 21+50

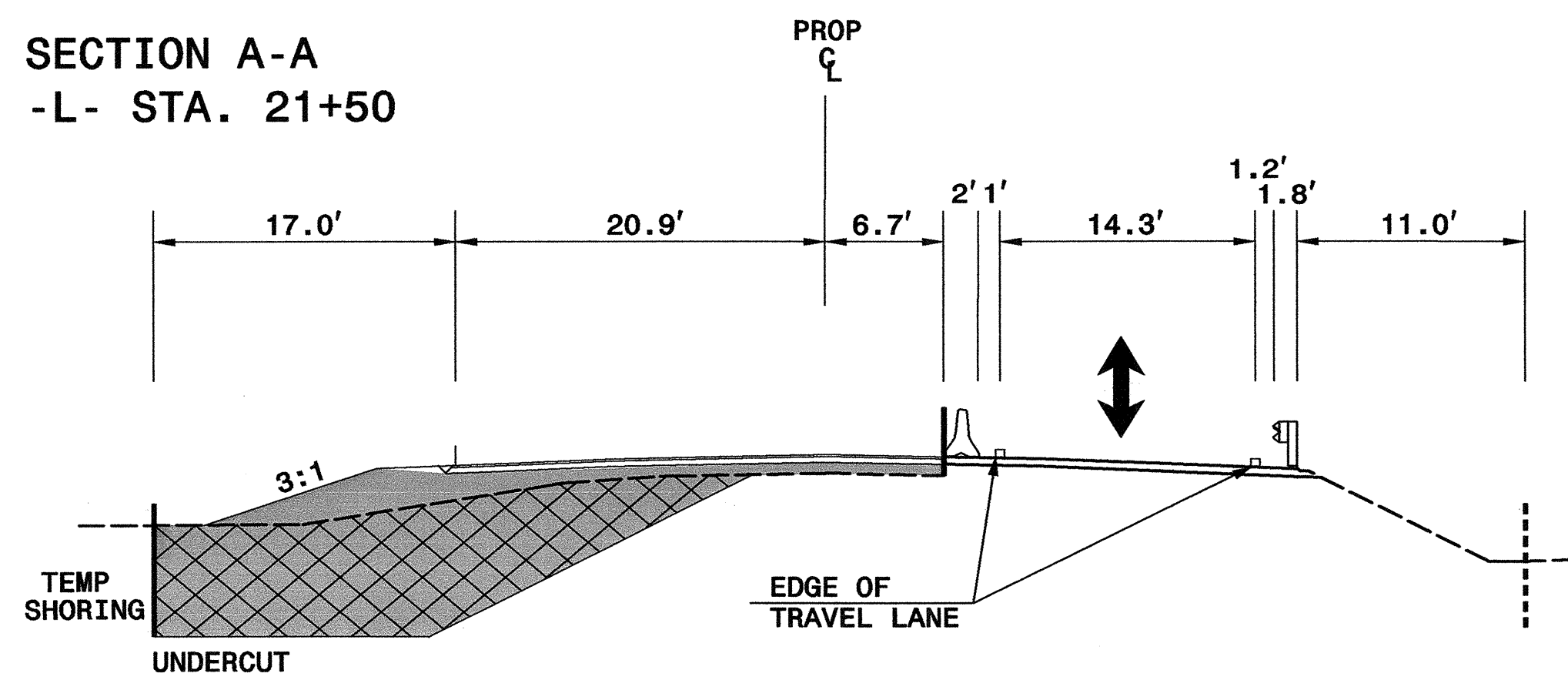

SECTION B-B
-L- STA. 24+00

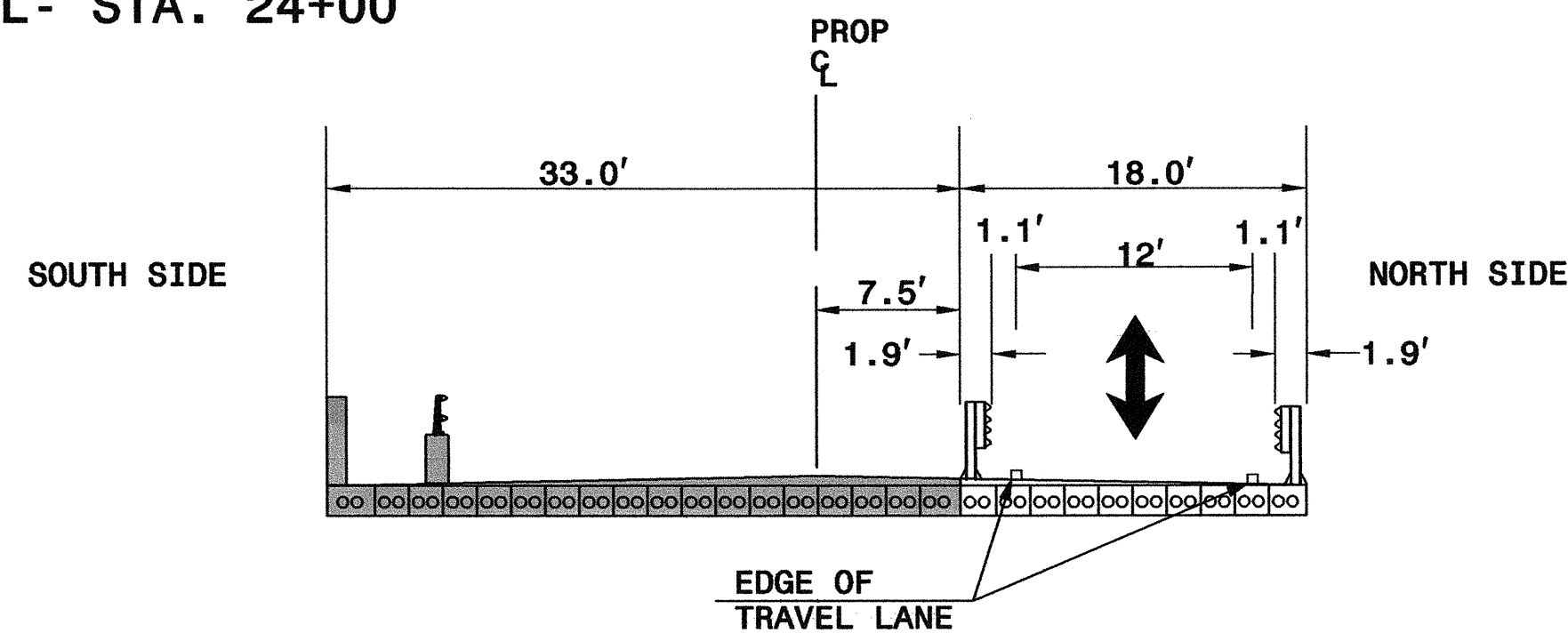

11/03/2004
 06:47:56 AM
 P:\tcp\B3445\tcp4.psh

APPROVED: SHANE D. YORK DATE: 11/03/04

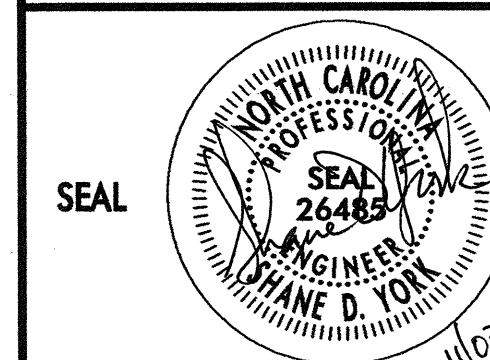

PHASE TWO

SCALE: N.A.
 DATE: 11/03/04
 DWG. BY: S. YORK
 DESIGN BY: S. YORK
 REVIEWED BY: C. HYATT

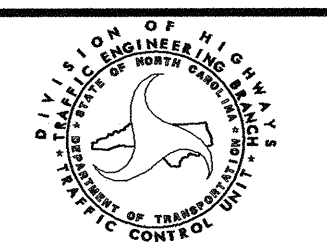

NO.	REVISIONS