

See Sheet 1-A For Index of Sheets
See Sheet 1-B For Conventional Symbols

T.I.P. NO.	SHEET NO.
B-2905	UO-1

STATE OF NORTH CAROLINA
DIVISION OF HIGHWAYS

**UTILITY BY OTHERS PLANS
ASHE COUNTY**

**LOCATION: BRIDGE NO. 113 OVER SOUTH FORK
NEW RIVER ON SR 1179**

**TYPE OF WORK: GRADING, DRAINAGE,
PAVING AND STRUCTURE**

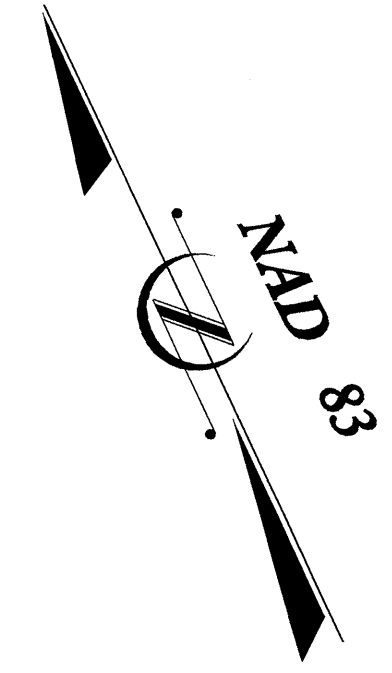
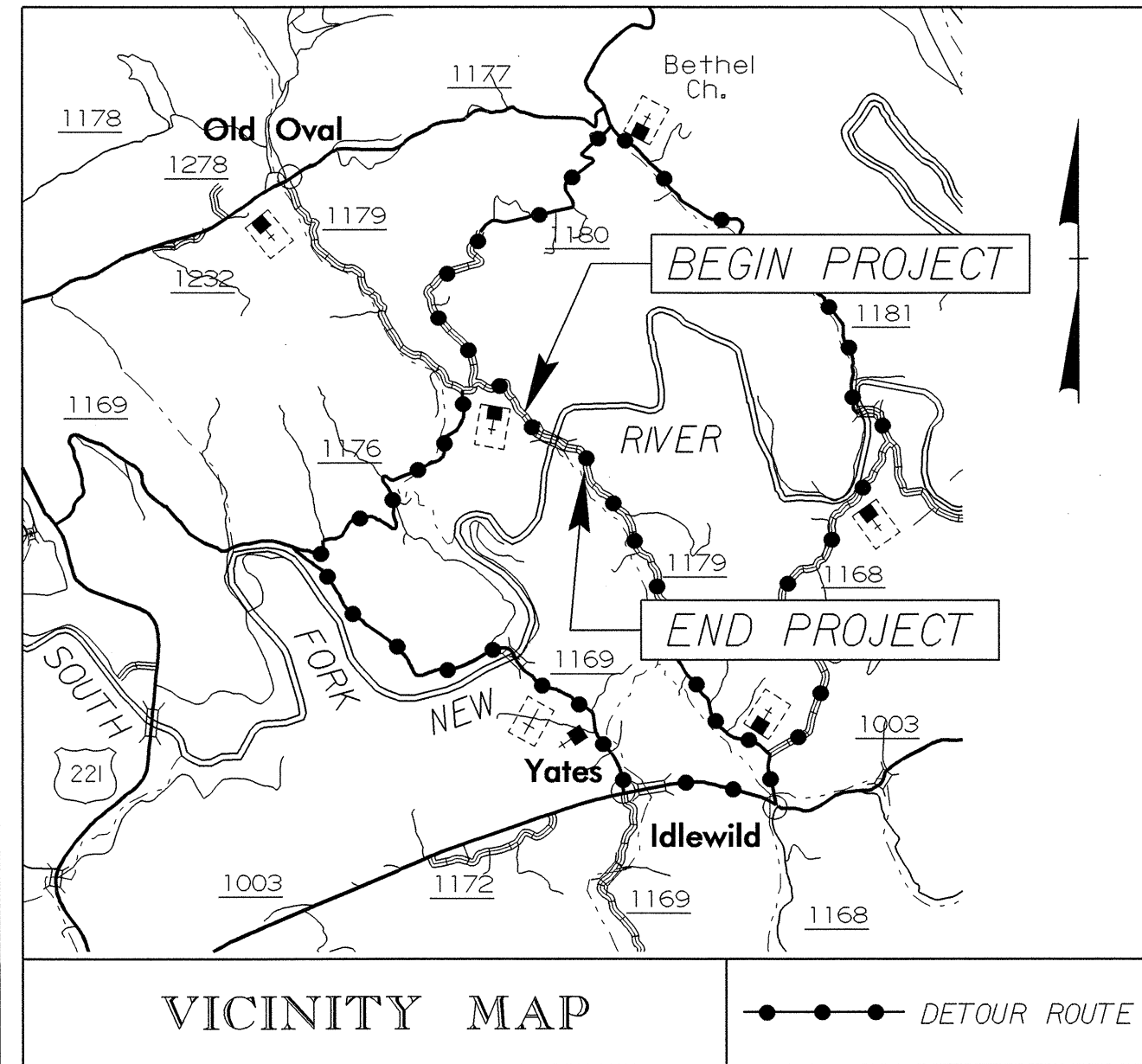

TIP: B-2905

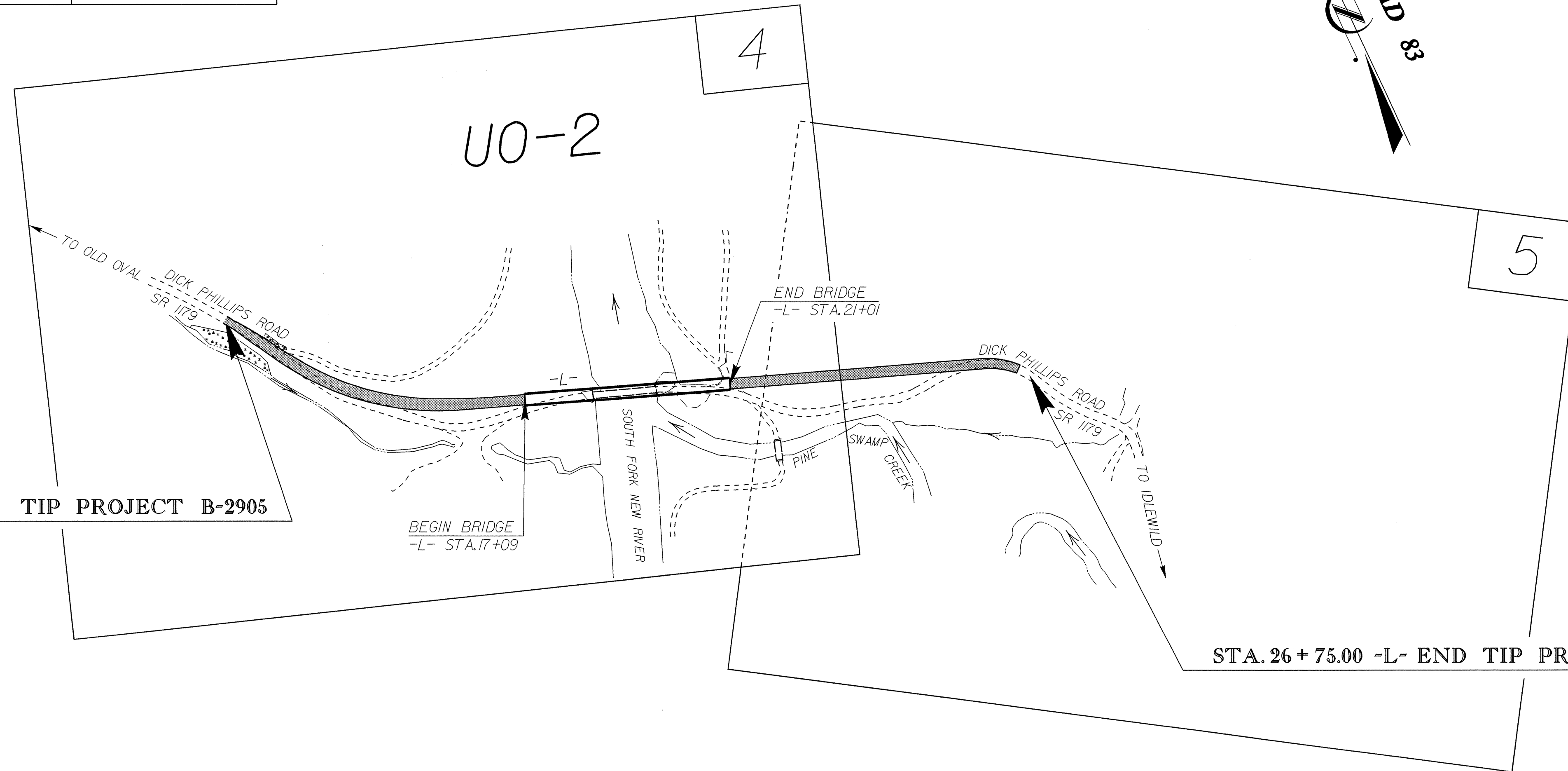

INDEX OF SHEETS	
SHEET NO.	DESCRIPTION
UO-1	TITLE SHEET
UO-2	UTILITY BY OTHERS PLAN SHEETS

POWER AND TELEPHONE OWNERS ON PROJECT
(1) POWER: BLUE RIDGE EMC
(2) TELEPHONE: SKI LINE TELEPHONE MEMBERSHIP CORPORATION