

**CONTRACT: C201199**      **TIP PROJECT: B-2905**

**STRUCTURE**

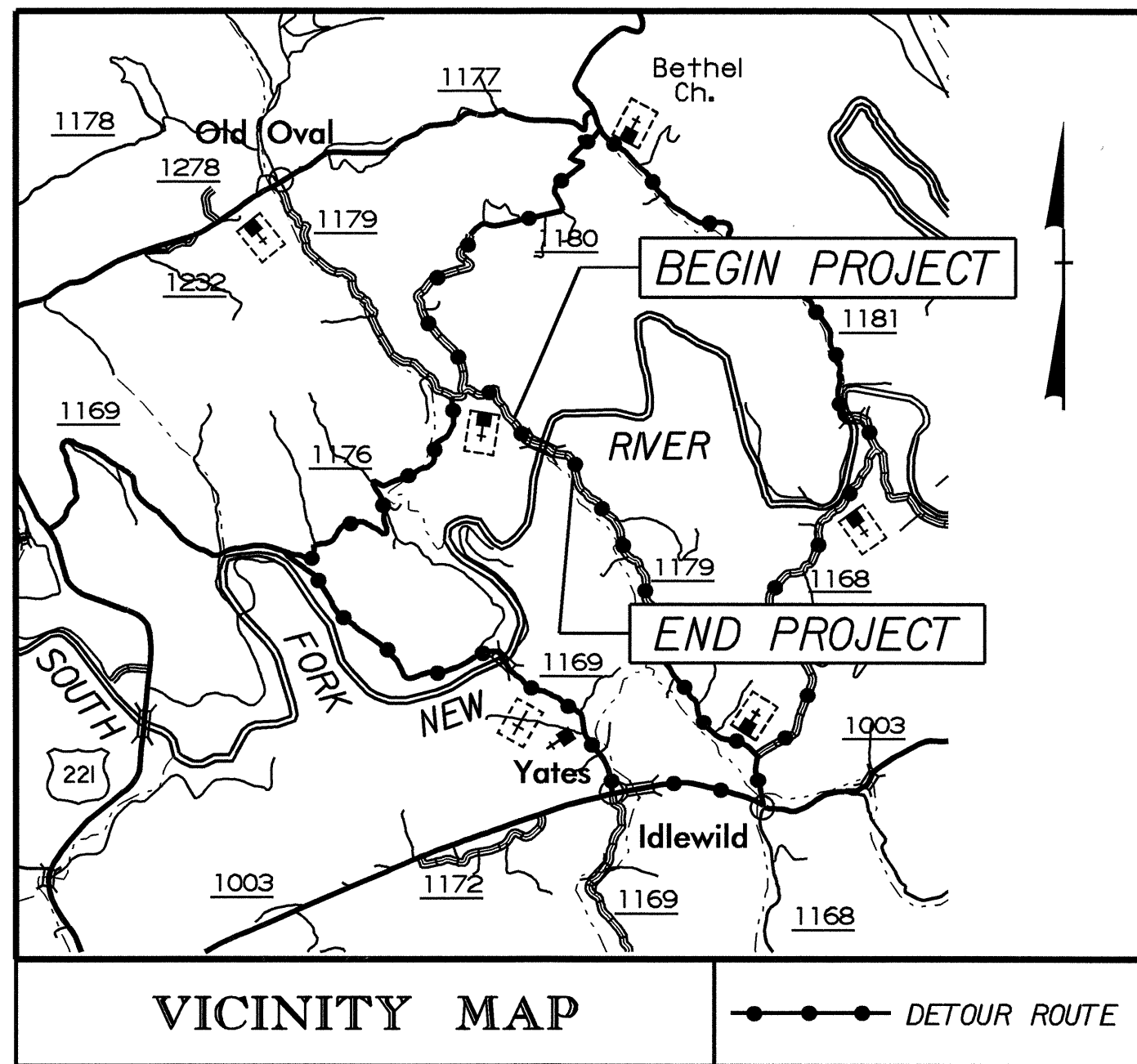

STATE OF NORTH CAROLINA  
 DIVISION OF HIGHWAYS  



---

**ASHE COUNTY**

**LOCATION: BRIDGE NO. 113 OVER SOUTH FORK NEW RIVER  
 ON SR 1179**

**TYPE OF WORK: GRADING, DRAINAGE, PAVING AND STRUCTURE**

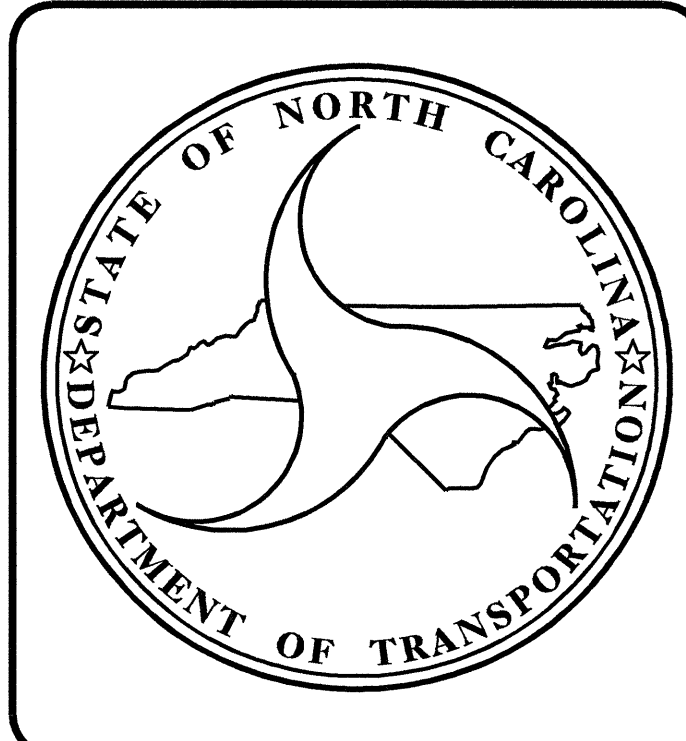
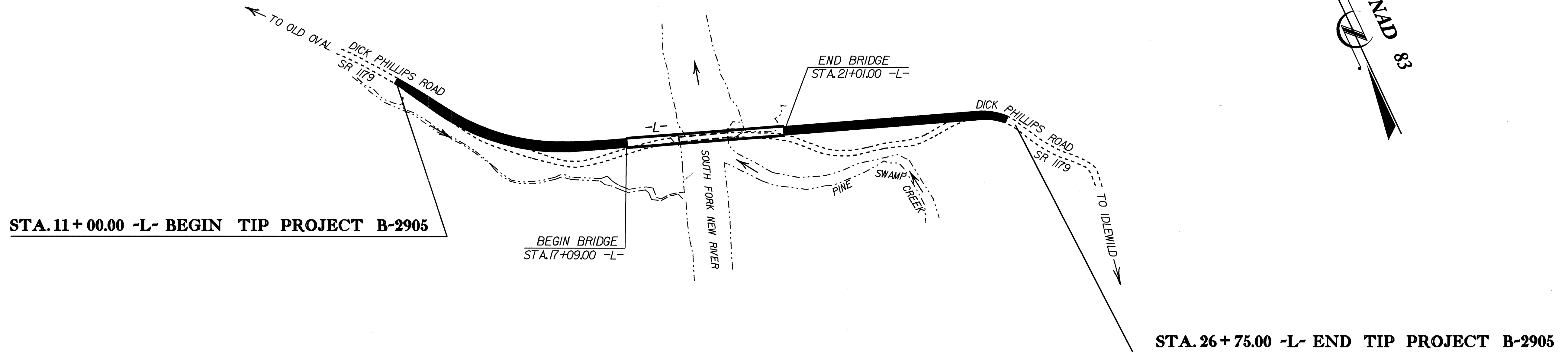
STATE	STATE PROJECT REFERENCE NO.	SHEET NO.	TOTAL SHEETS
N.C.	B-2905		
STATE PROJ. NO.	F.A. PROJ. NO.	DESCRIPTION	
32751.1.1	BRZ-1179(1)	PE	
32751.2.2	BRZ-1179(2)	R/W, UTIL	
32751.3.2	BRZ-1179(3)	CONST.	



**DESIGN DATA**

ADT 2004 = 200
ADT 2030 = 400
DHV = 15 %
D = 65 %
T = 4 % *
V = 40 MPH **
FUNC. CLASS. = LOCAL
* TTST 2% DUAL 2%

**PROJECT LENGTH**

LENGTH ROADWAY OF TIP PROJECT B-2905 = 0.224 mile
LENGTH STRUCTURE OF TIP PROJECT B-2905 = 0.074 mile
TOTAL LENGTH OF TIP PROJECT B-2905 = 0.298 mile

Prepared In the Office of:

**DIVISION OF HIGHWAYS**

2002 STANDARD SPECIFICATIONS

LETTING DATE : MAY 17, 2005	Q. H. NGUYEN, PE <small>PROJECT ENGINEER</small> <hr/> MARC G. CHEEK, PE <small>PROJECT DESIGN ENGINEER</small>
--------------------------------	--

**STRUCTURE DESIGN UNIT**  
 1000 BIRCH RIDGE DR.  
 RALEIGH, N.C. 27610

3.4.05

DIVISION OF HIGHWAYS  
 STATE OF NORTH CAROLINA

STATE DESIGN ENGINEER  
 DEPARTMENT OF TRANSPORTATION  
 FEDERAL HIGHWAY ADMINISTRATION

APPROVED  
 DIVISION ADMINISTRATOR

DATE