

5/28/99

BM-2 RR SPIKE SET IN 15" SWEET GUM TREE
N = 725692 E = 2248585
32.5' RT OF -L- STA. 27+16.99
ELEV. = 164.806

-L-

STRUCTURE HYDRAULIC DATA

DESIGN DISCHARGE = 3600 CFS
 DESIGN FREQUENCY = 25 YRS
 DESIGN HW ELEVATION = 150.4 FT
 BASE DISCHARGE = 5500 CFS
 BASE FREQUENCY = 100 YRS
 BASE HW ELEVATION = 151.3 FT
 OVERTOPPING DISCHARGE = 13850 CFS
 OVERTOPPING FREQUENCY = 500 YRS
 OVERTOPPING ELEVATION = 154J FT

PROJECT REFERENCE NO. B-4327	SHEET NO. 5
ROADWAY DESIGN ENGINEER	HYDRAULICS ENGINEER

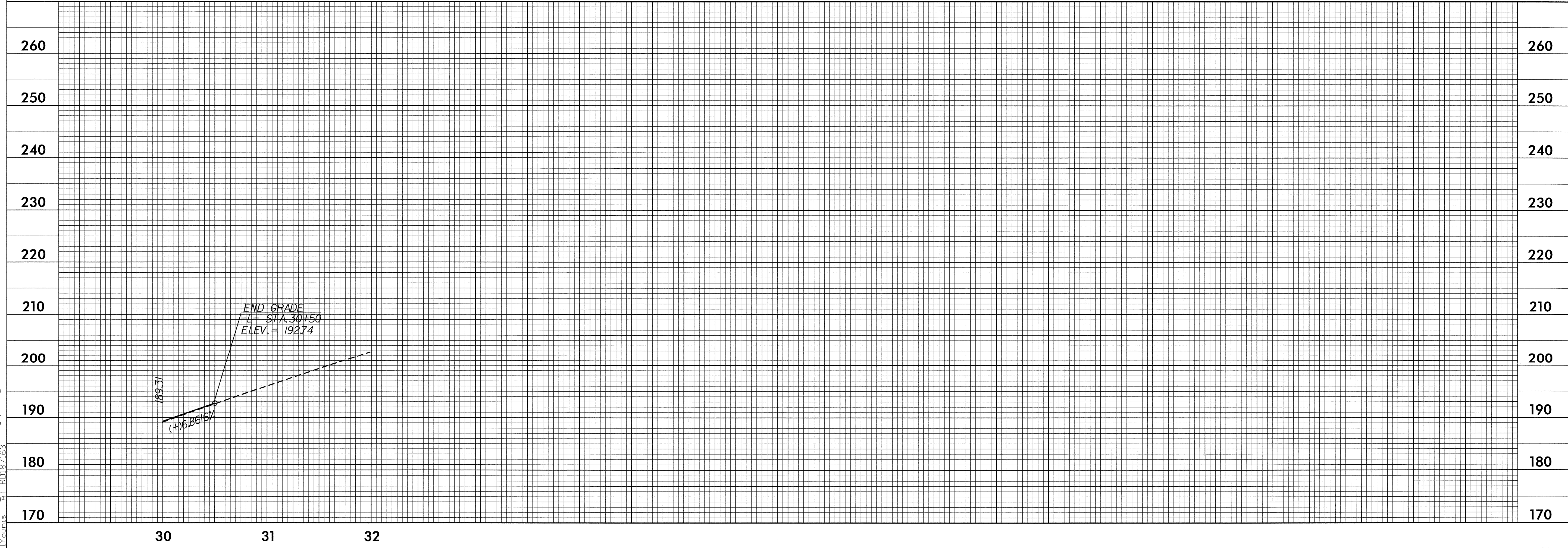
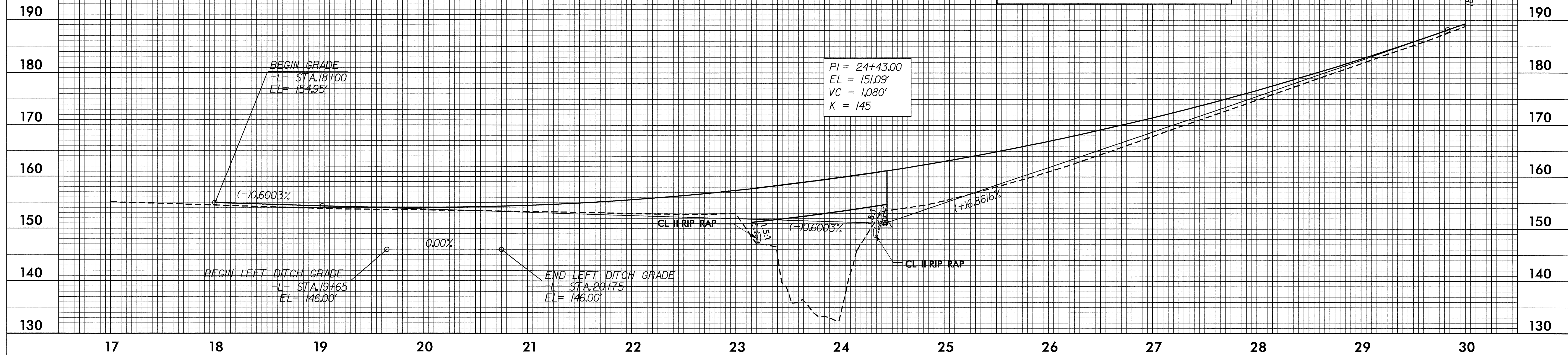

07-DEC-2004 13:35
R:\Roadway\Proj\B4327_rdy_pf1.dgn
Younis At 80187163