

### PHASE I

PLACE WORK ZONE ADVANCE WARNING SIGNS ON ALL APPROACHES TO THE PROJECT, (SEE THIS SHEET).

STEP 1: AWAY FROM TRAFFIC AND USING ROADWAY STANDARD DRAWING NOS. 1101.02 SHEET 1 OF 7 AND 1101.05, CONSTRUCT THE TEMPORARY DETOURS -DET1-, -DET2- (21' WIDTH), UP TO THE EXISTING EDGE AND ELEVATION OF SR 1340, TEMPORARY DRAINAGE, GUARDRAIL, APPROACHES AND DRIVEWAY TIE-INS FROM STA. 10+00 +/- -DET1- TO STA. 12+95 +/- -DET1- AND FROM STA. 10+00 -DET2- TO STA. 14+00 +/- -DET2-, AS SHOWN IN THE ROADWAY PLANS. AT THE END OF THE WORK DAY SR 1340 TRAFFIC SHALL BE RESTORED TO ITS TWO-WAY TWO-LANE TRAFFIC PATTERN, (SEE SHEET TCP-2A LOCAL NOTE 1):

- USING FLAGGERS AND ROADWAY STANDARD DRAWING NO. 1101.02 SHEET 1 OF 7, INSTALL THE PROPOSED 18" DRAINAGE PIPE AT STA. 25+50 +/- -L1-. AT THE END OF THE WORK DAY SR 1340 TRAFFIC WILL BE RESTORED TO ITS TWO-WAY TWO-LANE TRAFFIC PATTERN.
- AWAY FROM SR 1340 TRAFFIC INSTALL TEMPORARY SOIL FABRIC WALL ALONG TEMPORARY DETOUR 1 FROM STA. 11+08 +/- -DET1- TO STA. 11+24 +/- -DET1-, AT LOCATIONS SHOWN ON THIS SHEET.
- AWAY FROM SR 1340 TRAFFIC PLACE PORTABLE CONCRETE BARRIER AND TEMPORARY CRASH CUSHIONS OFFSET 5' FROM A LANE OF TRAVEL ALONG NORTHBOUND TEMPORARY DETOUR 1 FROM STA. 10+75 +/- -DET1- TO STA. 12+20 +/- -DET1- AND ALONG SOUTHBOUND TEMPORARY DETOUR 2 FROM STA. 11+00 +/- -DET2- TO STA. 12+40 +/- -DET2-, AS SHOWN ON THIS SHEET.

NOTE: MAINTAIN EGRESS/INGRESS TO ALL PROPERTIES DURING CONSTRUCTION WITH INCIDENTAL STONE BASE OR MATERIAL SUITABLE AND APPROVED BY THE ENGINEER.

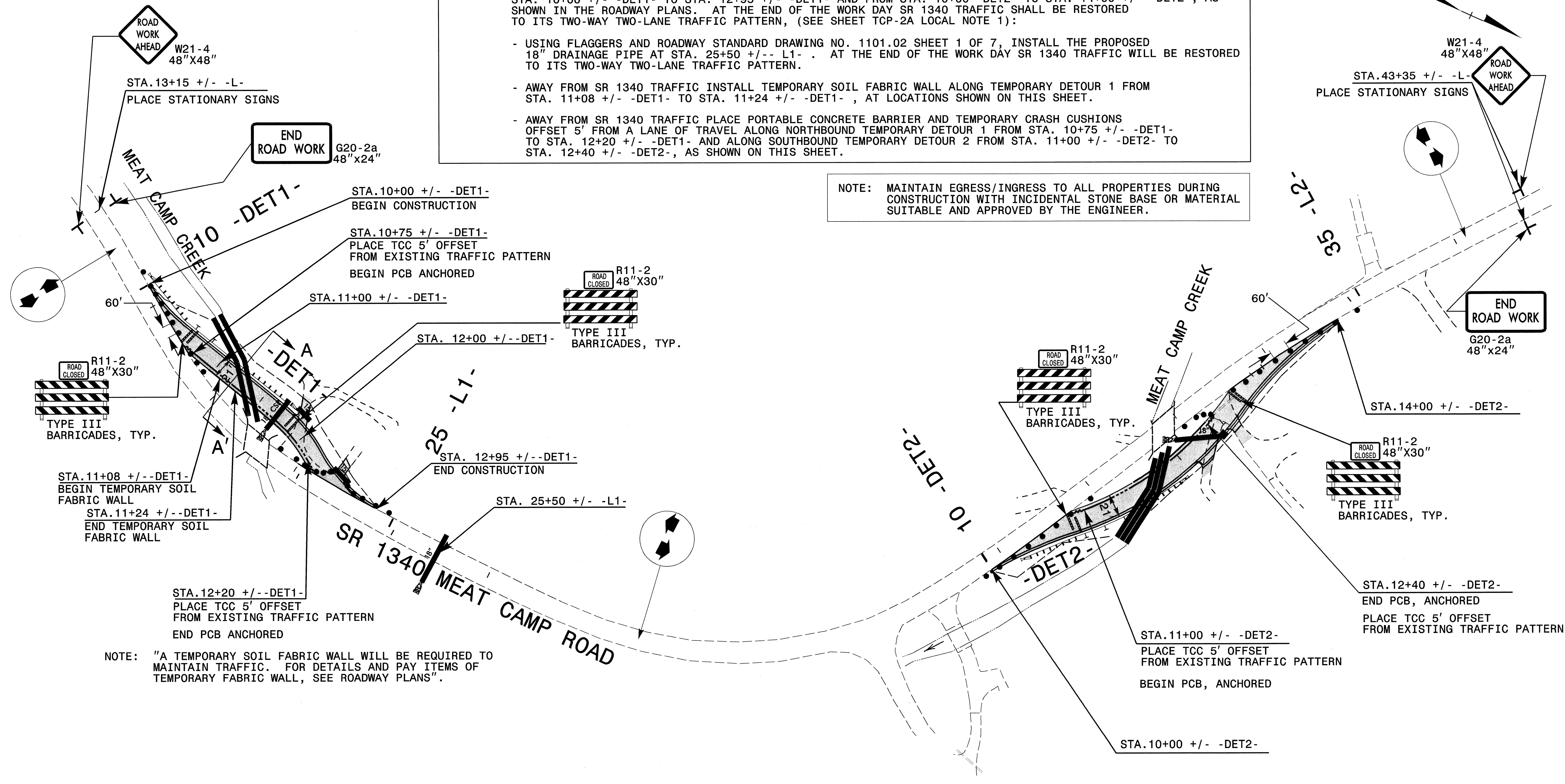

NOTE: "A TEMPORARY SOIL FABRIC WALL WILL BE REQUIRED TO MAINTAIN TRAFFIC. FOR DETAILS AND PAY ITEMS OF TEMPORARY FABRIC WALL, SEE ROADWAY PLANS".

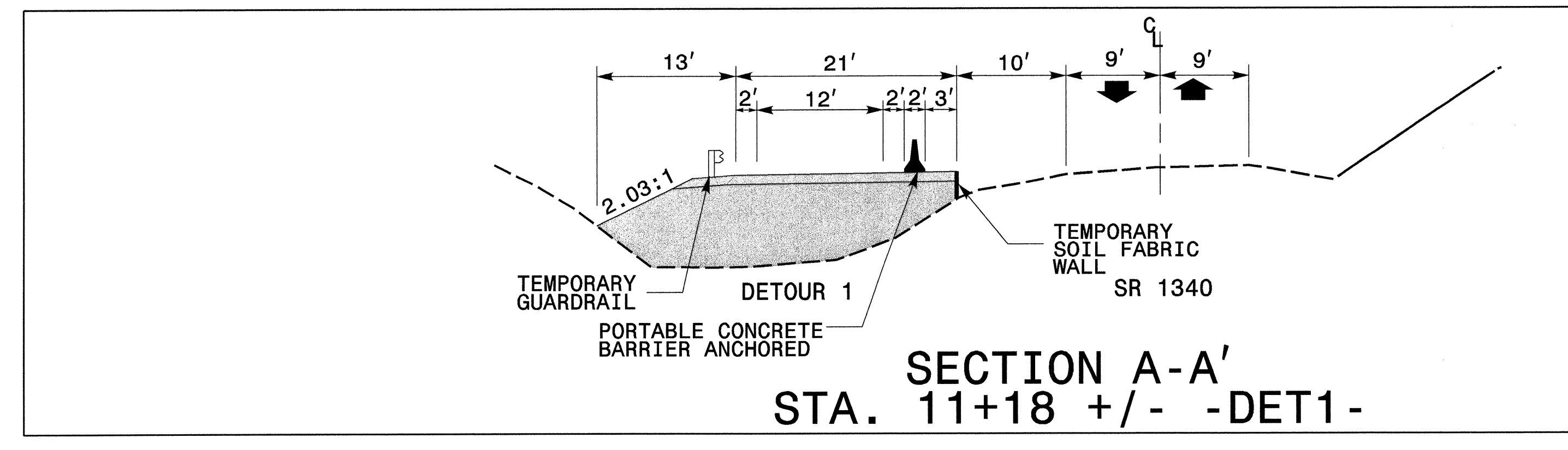

**PLANS PREPARED BY :**  
**RUMMEL KLEPPER & KAHL, LLP**  
*consulting engineers*  
 5800 FARINGDON PLACE SUITE 105  
 RALEIGH, NORTH CAROLINA 27609-3960  
 FOR  
**DIVISION OF HIGHWAYS**

SEAL  
  
 R. Keith Skinner 8/11/04

<b>PHASE I</b>	
SCALE: NONE	REVISIONS
DATE: 09-03	
DWG. BY: MAC	
DESIGN BY: MAC	
REVIEWED BY: BKS	
CADD FILE: TCP03.DGN	