

UTILITIES BY OTHERS

NOTE:
ALL PROPOSED UTILITY WORK
SHOWN ON THIS SHEET WILL
BE DONE BY OTHERS

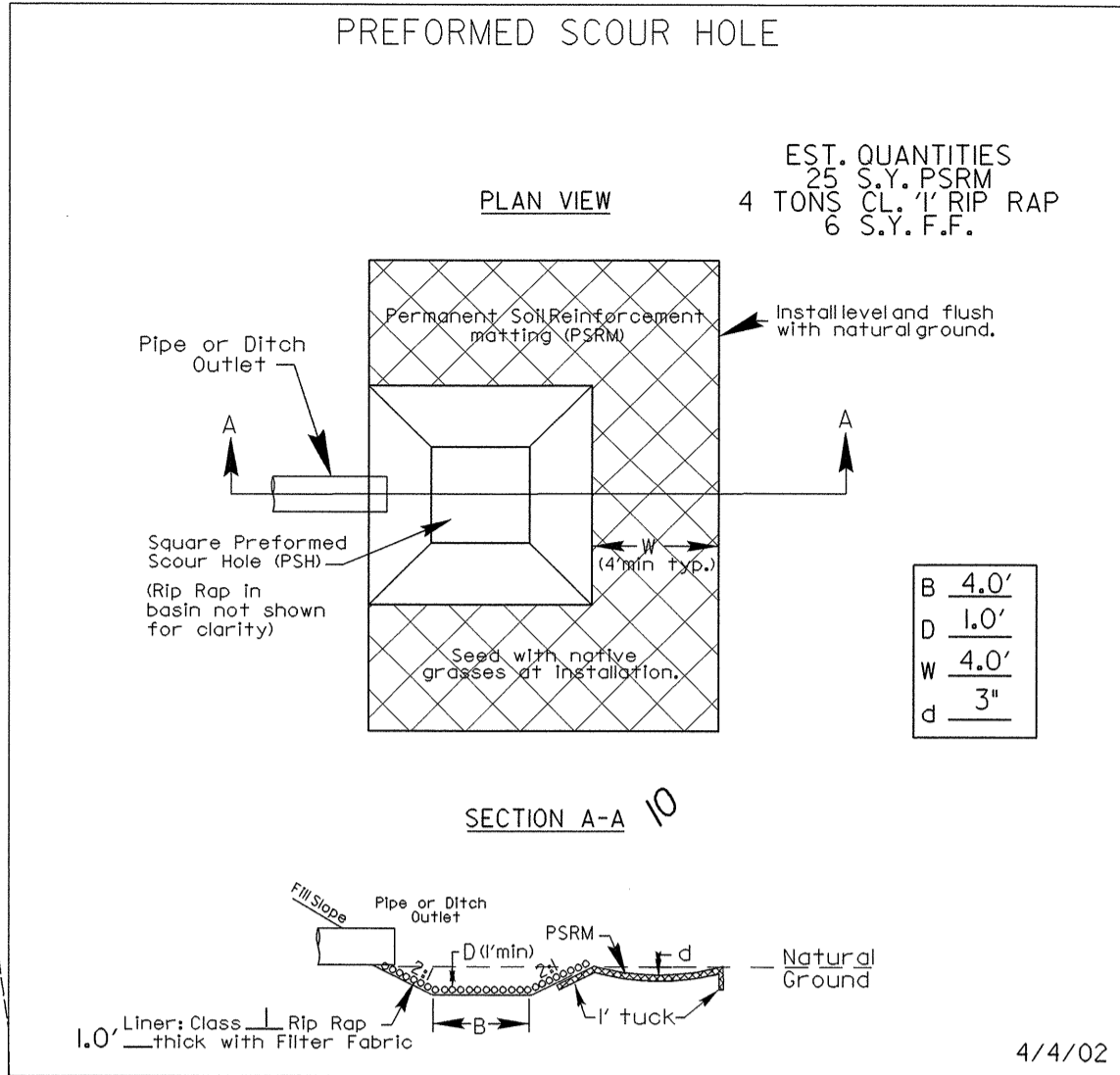

-L-
PI Sta 12+09.70
Δ = 45° 0' 49.9" (LT)
D = 16' 5' 06.1"
L = 267.22'
T = 140.94'
R = 340.00'

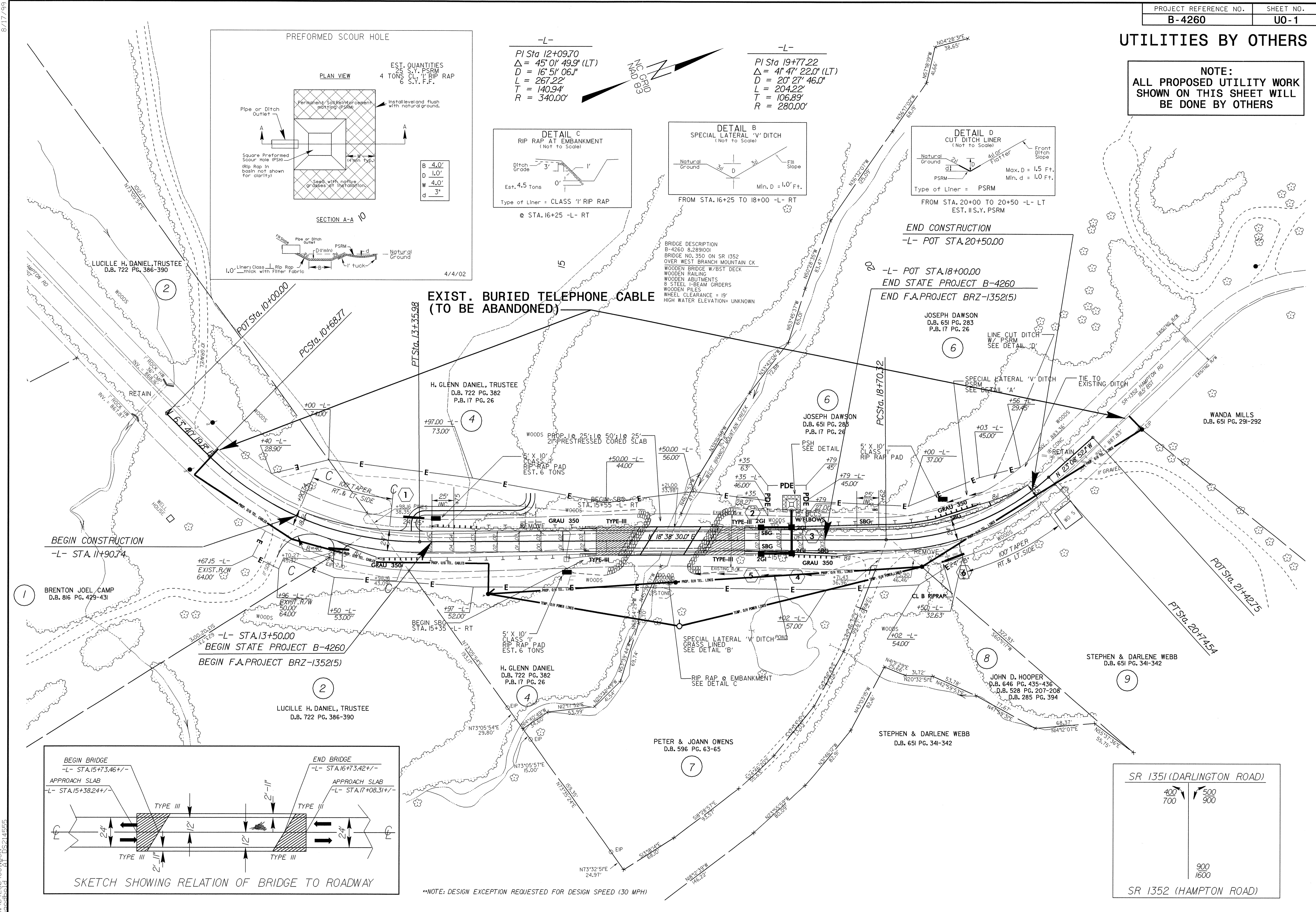
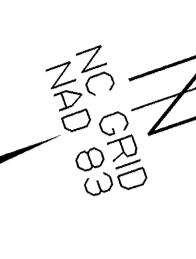

-L-
PI Sta 19+77.22
Δ = 4° 47' 22.0" (LT)
D = 20' 27' 46.0"
L = 204.22'
T = 106.89'
R = 280.00'

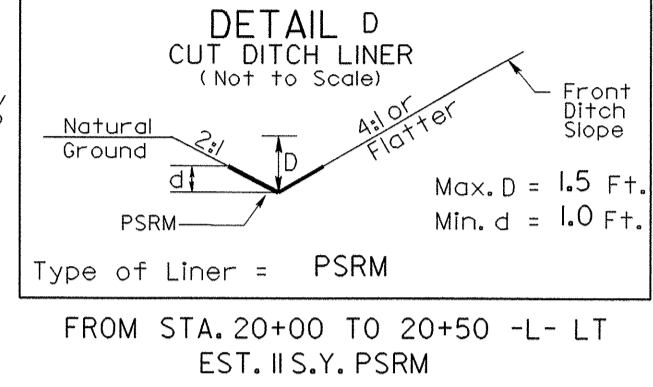
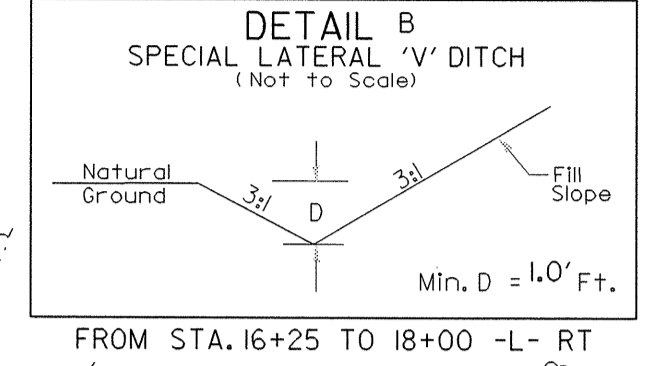
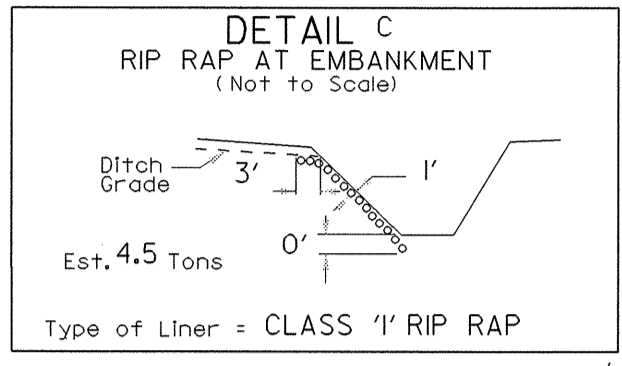

BRIDGE DESCRIPTION
B-4260 S.291001
BRIDGE NO. 350 ON SR 1352
OVER WEST BRANCH MOUNTAIN CK
WOODEN BRIDGE W/BST DECK
WOODEN RAILING
WOODEN ABUTMENTS
8" STEEL I-BEAM GIRDERS
WOODEN PILES
WHEEL CLEARANCE = 19'
HIGH WATER ELEVATION= UNKNOWN

END CONSTRUCTION
-L- POT STA. 20+50.00

-L- POT STA. 18+00.00
END STATE PROJECT B-4260
END F.A. PROJECT BRZ-1352(5)

BEGIN CONSTRUCTION
-L- STA. 11+90.74

-L- STA. 13+50.00
BEGIN STATE PROJECT B-4260
BEGIN F.A. PROJECT BRZ-1352(5)

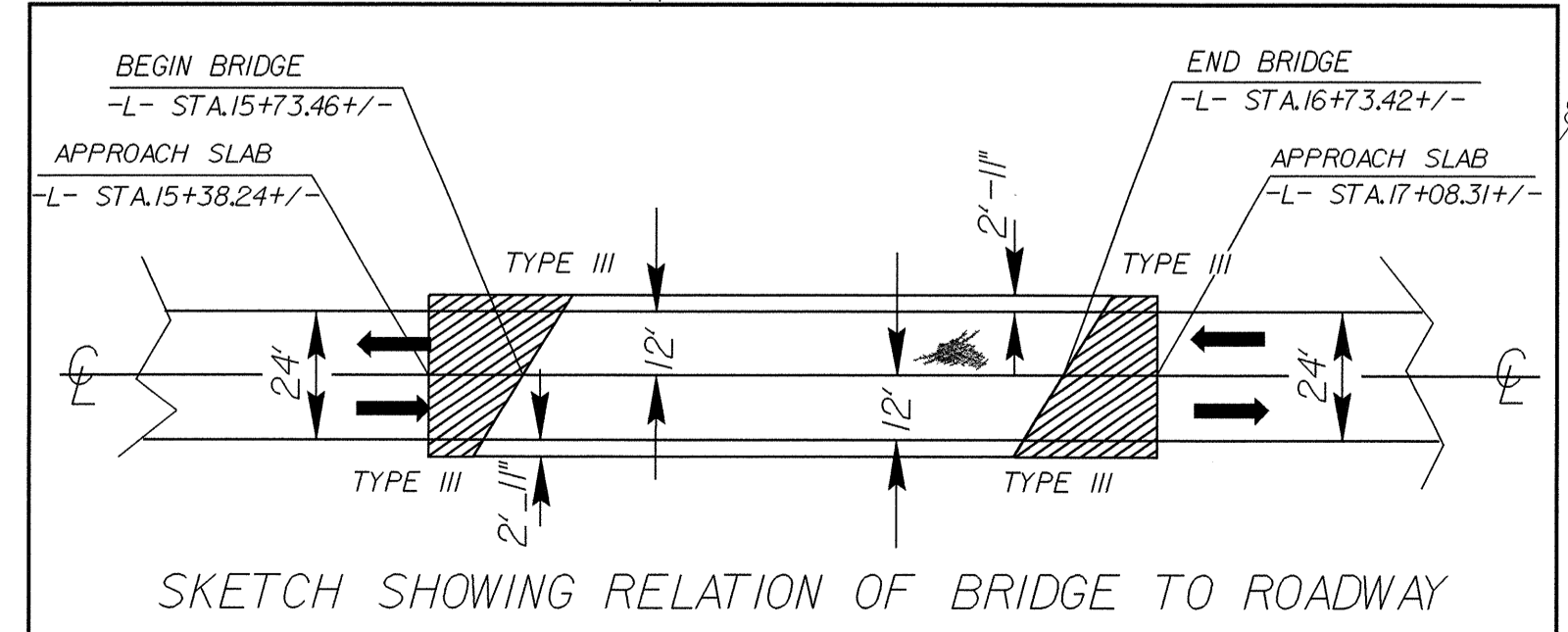

**NOTE: DESIGN EXCEPTION REQUESTED FOR DESIGN SPEED (30 MPH)

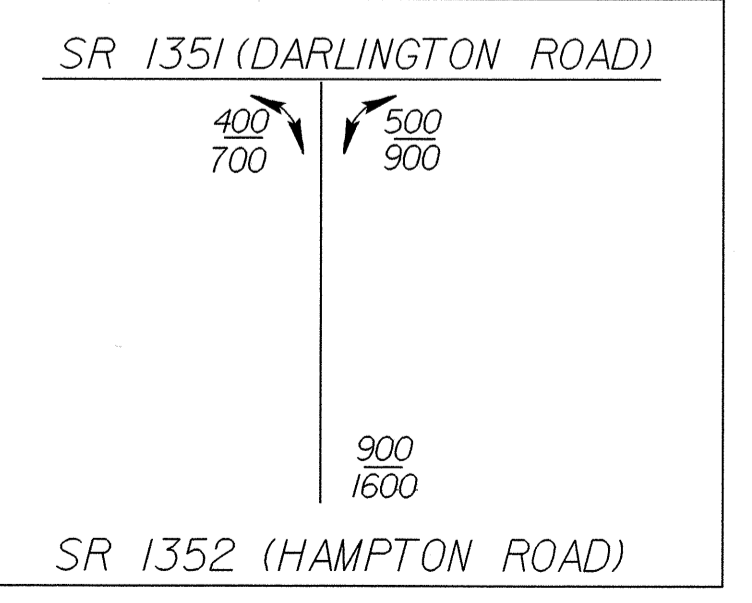

8/17/99
04-JAN-2005 08:53
S:\PROJECTS\2005\UO\UO-1.DWG
DS214555