

SURVEY CONTROL SHEET

| | | |
|-----------------------------|-----------------------------|-----------|
| STATE | STATE PROJECT REFERENCE NO. | SHEET NO. |
| N.C. | B-3875 | 1-C |
| LOCATION AND SURVEYS | | |

| BL | POINT | DESC. | NORTH | EAST | ELEVATION | L STATION | OFFSET |
|----|-------|--------|-------------|--------------|-----------|-----------|----------|
| | 101 | BL-101 | 632327.2930 | 1821623.0940 | 390.92 | 12+19.27 | 14.78 RT |
| | 102 | BL-102 | 632774.0930 | 1821831.7440 | 370.44 | 17+10.85 | 13.76 LT |
| | 103 | BL-103 | 633291.7440 | 1822132.7050 | 395.96 | 23+08.32 | 16.61 RT |

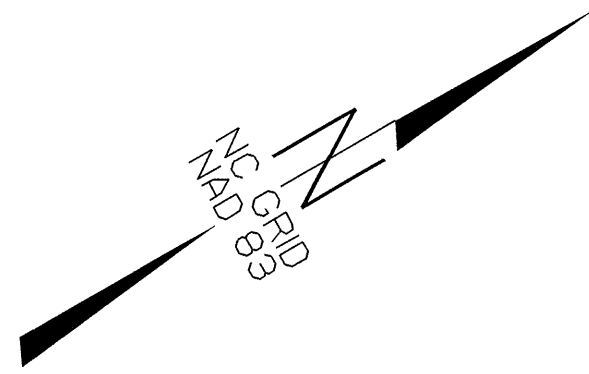

 BM1 ELEVATION = 405.79
 N 632227 E 1821471
 L STATION 10+49 53 LEFT
 RR SPIKE IN BASE OF POWER POLE

 BM2 ELEVATION = 380.07
 N 633230 E 1821909
 L STATION 21+51 156 LEFT
 RR SPIKE IN BASE OF POWER POLE

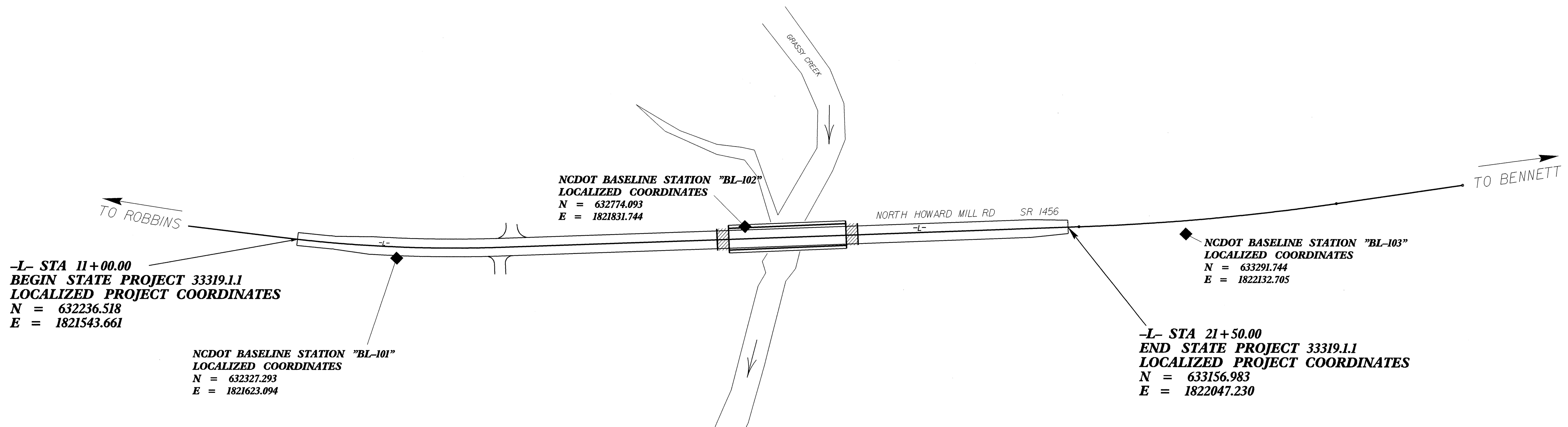

DATUM DESCRIPTION

THE LOCALIZED COORDINATE SYSTEM DEVELOPED FOR THIS PROJECT IS BASED ON THE STATE PLANE COORDINATES ESTABLISHED BY NCDOT FOR MONUMENT "B3875-1" WITH NAD 83/95 STATE PLANE GRID COORDINATES OF NORTHING: 630399.874 (ft) EASTING: 1820696.073 (ft) THE AVERAGE COMBINED GRID FACTOR USED ON THIS PROJECT (GROUND TO GRID) IS: 0.99984295 THE N.C. LAMBERT GRID BEARING AND LOCALIZED HORIZONTAL GROUND DISTANCE FROM "B3875-1" TO -L- STATION 11+00.00 N 24°46'21.88" E 2022.787'

ALL LINEAR DIMENSIONS ARE LOCALIZED HORIZONTAL DISTANCES
 VERTICAL DATUM USED IS NAVD 88

◆ INDICATES CONTROL MONUMENTS SET FOR HORIZONTAL PROJECT CONTROL BY THE NCDOT LOCATION AND SURVEYS UNIT.

PROJECT CONTROL ESTABLISHED USING GLOBAL POSITIONING SYSTEM.

NETWORK ESTABLISHED FROM EXISTING NCGS NAD8395 MONUMENTATION.

NOTES

1. THE CONTROL DATA FOR THIS PROJECT CAN BE FOUND ELECTRONICALLY BY SELECTING PROJECT CONTROL DATA AT:

HTTP://WWW.DOH.DOT.STATE.NC.US/PRECONSTRUCT/HIGHWAY/LOCATION/PROJECT/
 FILE: B3875.LS.CONTROL_040924.TXT

SITE CALIBRATION INFORMATION HAS NOT BEEN PROVIDED FOR THIS PROJECT. IF FURTHER INFORMATION IS NEEDED, PLEASE CONTACT THE LOCATION AND SURVEYS UNIT.

NOTE: DRAWING NOT TO SCALE