

PLAN OF SPANS

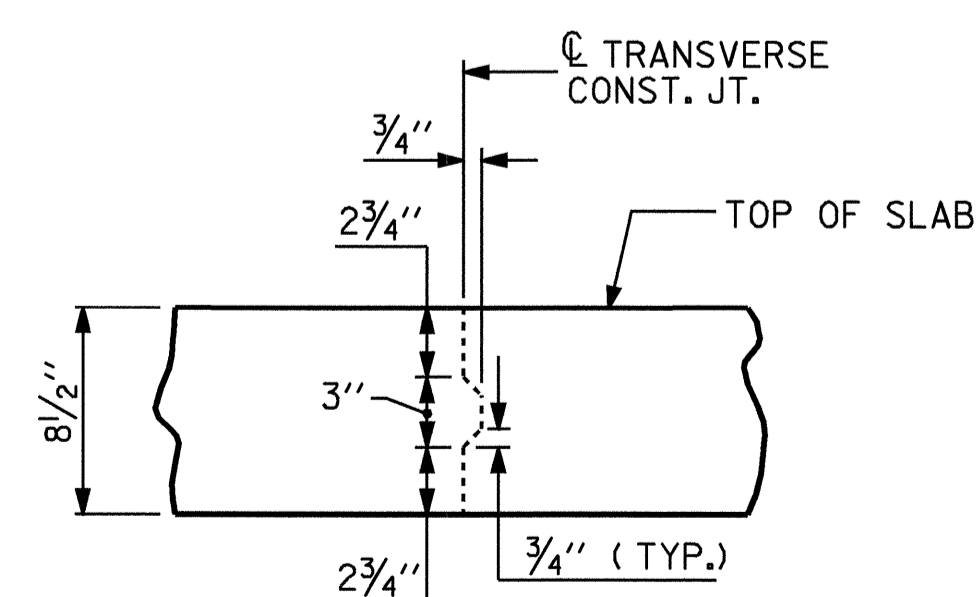

TRANSVERSE CONSTRUCTION JOINT DETAIL

NOTE: REINFORCING STEEL IN SLAB NOT SHOWN.
 LONGITUDINAL REINFORCING STEEL SHALL BE
 CONTINUOUS THRU JOINT

PROJECT NO. B-3875
 MOORE COUNTY
 STATION: 17+70.00 -L-

STATE OF NORTH CAROLINA
 DEPARTMENT OF TRANSPORTATION
 RALEIGH

SUPERSTRUCTURE
 PLAN OF SPANS

REVISIONS						SHEET NO.
NO.	BY:	DATE:	NO.	BY:	DATE:	S-6
1			3			TOTAL SHEETS
2			4			33



DRAWN BY: J.D. HAWK DATE: 8/03
 CHECKED BY: J.G. KHARVA DATE: 8/03