

SUGGESTED MESSAGES

CMS #1		CMS#2	
MESSAGE NO. 1	MESSAGE NO. 2	MESSAGE NO. 1	MESSAGE NO. 2
OFF RAMP CLOSED	AT MERRIMON AVENUE	MERRIMON AVENUE DETOUR	USE EXIT 5B
CHANGEABLE MESSAGE SIGN		CHANGEABLE MESSAGE SIGN	
CMS #3		CMS #4	
MESSAGE NO. 1	MESSAGE NO. 2	MESSAGE NO. 1	MESSAGE NO. 2
MERRIMON AVENUE DETOUR	NEXT RIGHT	I-240 EB TRAFFIC DETOUR	USE COLLEGE ROAD
CHANGEABLE MESSAGE SIGN		CHANGEABLE MESSAGE SIGN	

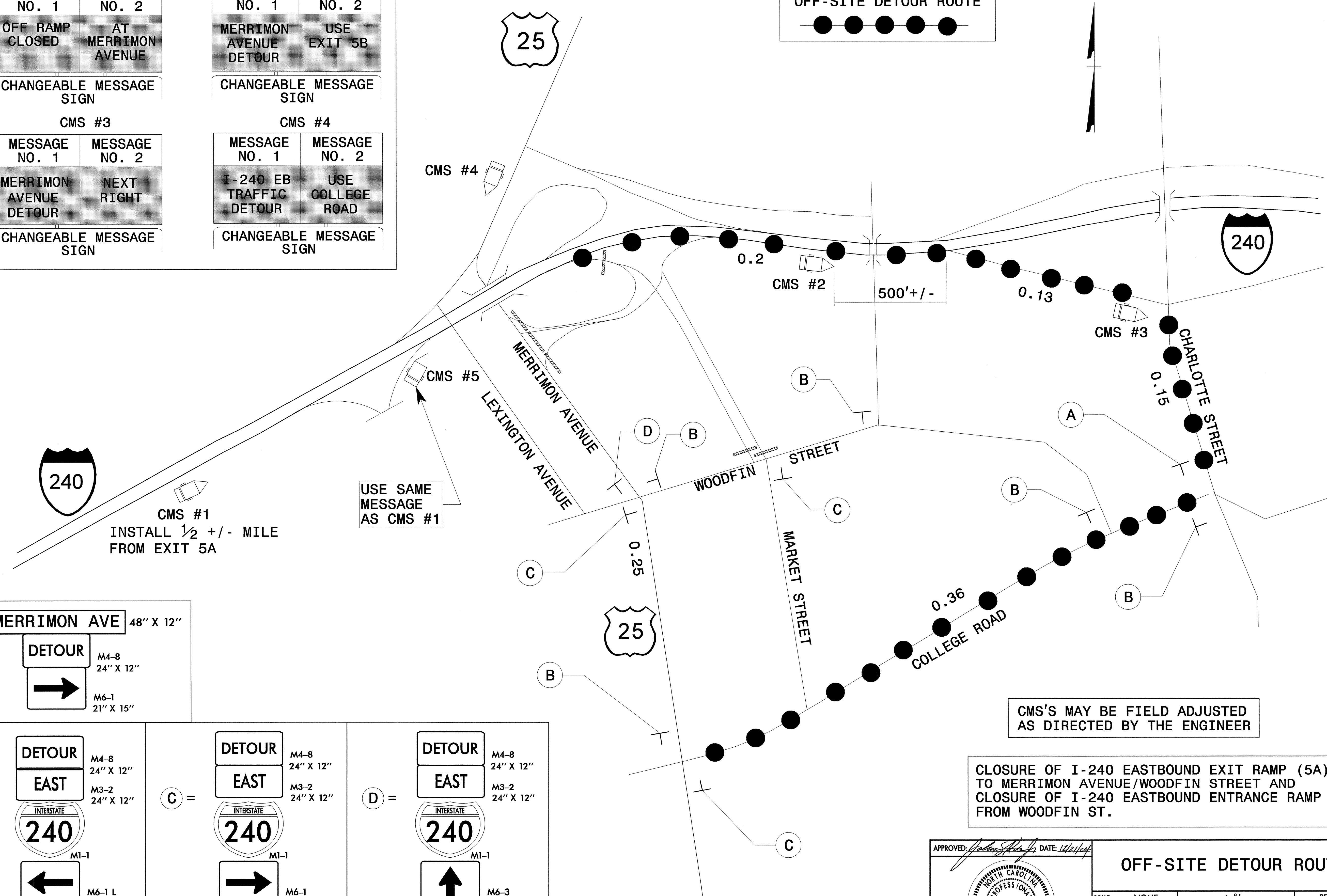
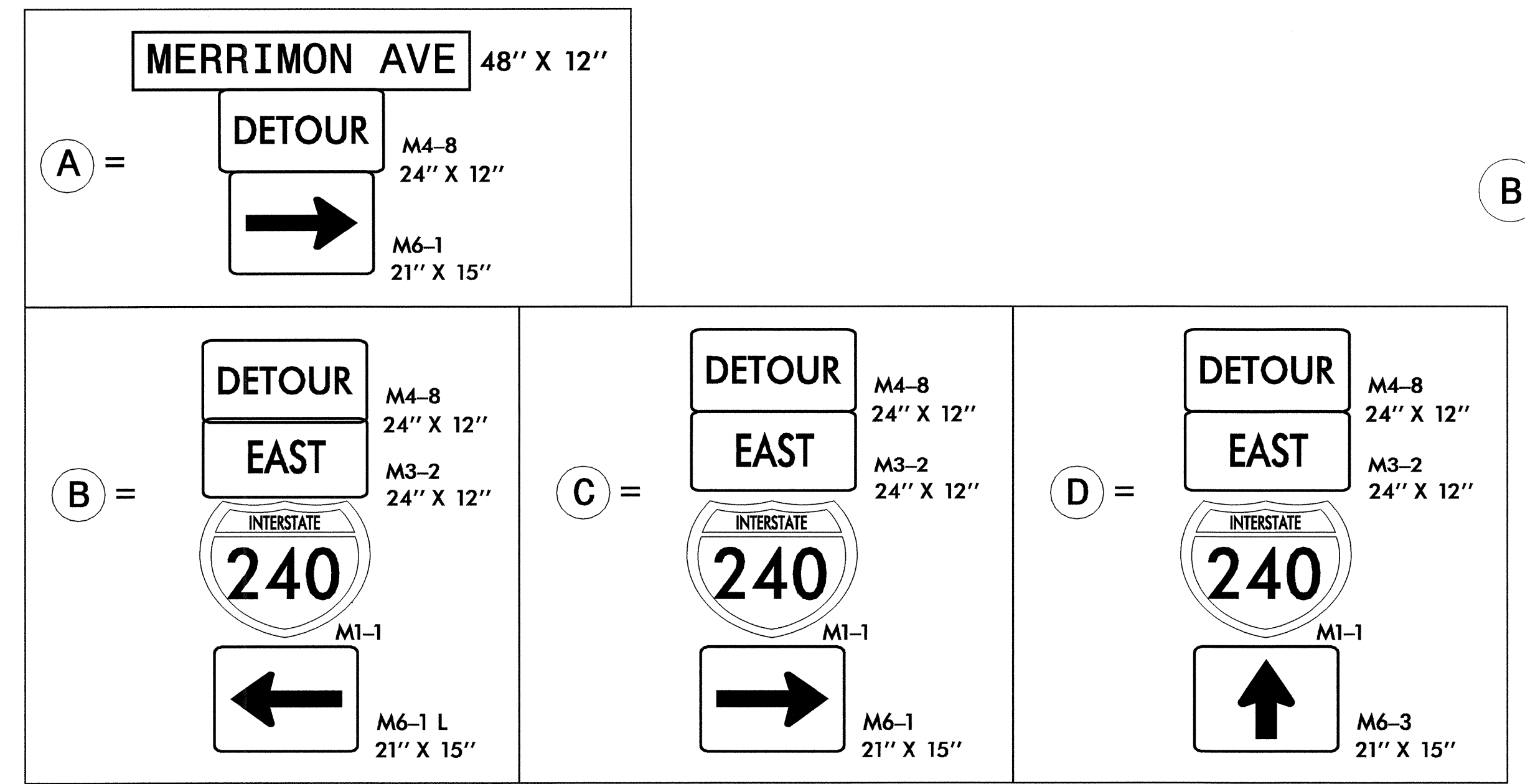
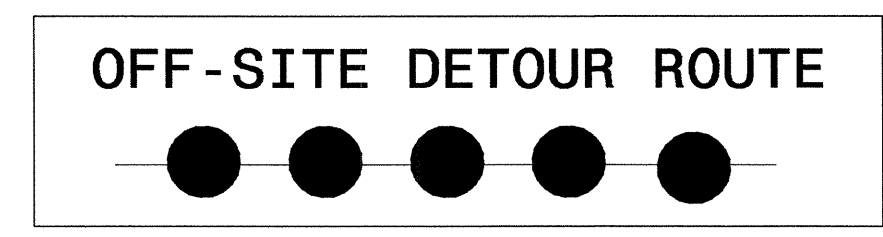

CMS'S MAY BE FIELD ADJUSTED AS DIRECTED BY THE ENGINEER

CLOSURE OF I-240 EASTBOUND EXIT RAMP (5A) TO MERRIMON AVENUE/WOODFIN STREET AND CLOSURE OF I-240 EASTBOUND ENTRANCE RAMP FROM WOODFIN ST.

APPROVED: <i>[Signature]</i> DATE: 12/21/04			OFF-SITE DETOUR ROUTE	
SEAL			SCALE: NONE	REVISIONS
	DATE: 08/03			
	DWG. BY: SJS			
	DESIGN BY: SJS			
	REVIEWED BY: CLM			CADD FILE

21-DEC-2004 07:16 \\efs-cfs01\U3302\$TCP\REVISED TCP\S\U3302_TC_TCP08.dgn msteelman AT TETC21231