

BRIDGE DATA
 BRIDGE #57
 OVER BUFFALO CREEK

DESIGN Q =	3,600 cfs
DESIGN FREQ =	50 yr
DESIGN EL =	2785.2 ft
BASE FLOOD Q =	4,300 cfs
BASE FLOOD FREQ =	100 yr
BASE FLOOD EL =	2786.5 ft
OT Q =	9,500 cfs
OT FREQ =	500+ yr
OT EL =	2793.0 ft

- BM#1 8" SPIKE IN ROOT 20" WHITE PINE TREE
 -BL- Sta. 8+82.68 ELEV. 2837.37 (NOT ON -L-)
- BM#2 PK NAIL IN NW CORNER OF CONC PAD FOR PH BOX
 -BYI- Sta. 8+66.41 ELEV. 2789.05 =
 -L- Sta. 15+61.9242 (428.22 ft RT)
- BM#3 8" SPIKE IN ROOT 48" MAPLE TREE
 -BL- Sta. 32+82.14 ELEV. 2772.07 (NOT ON -L-)

----- DITCH LEFT
 ----- DITCH RIGHT

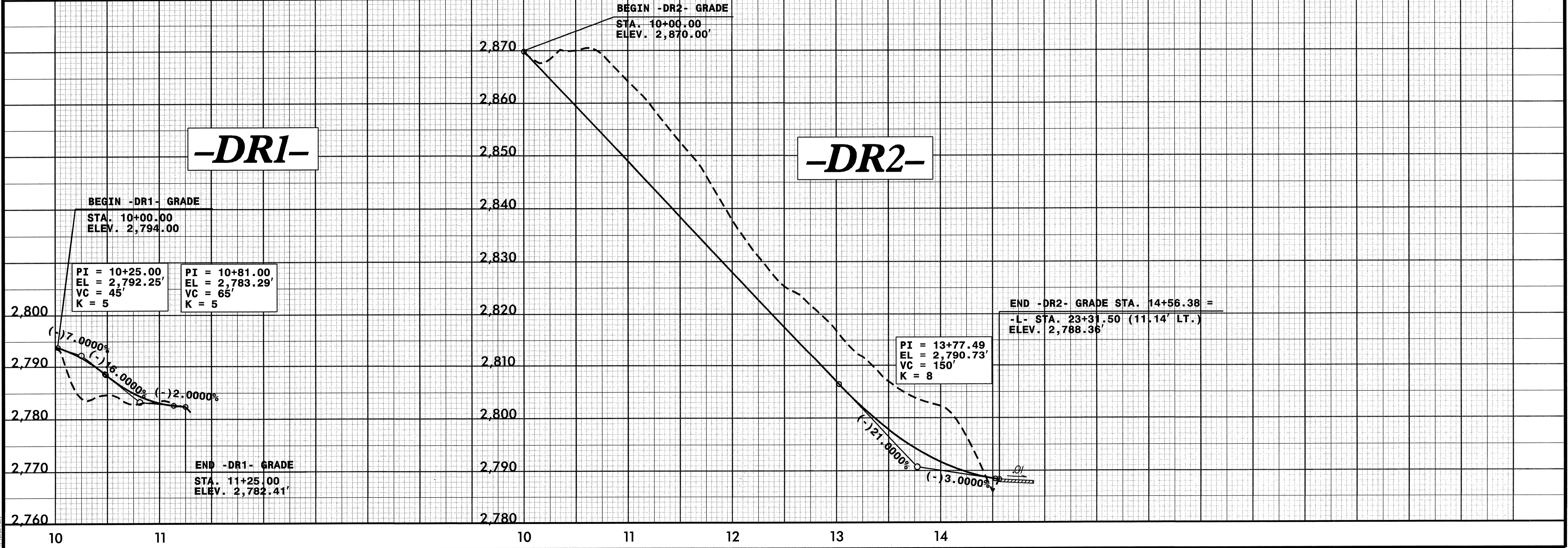
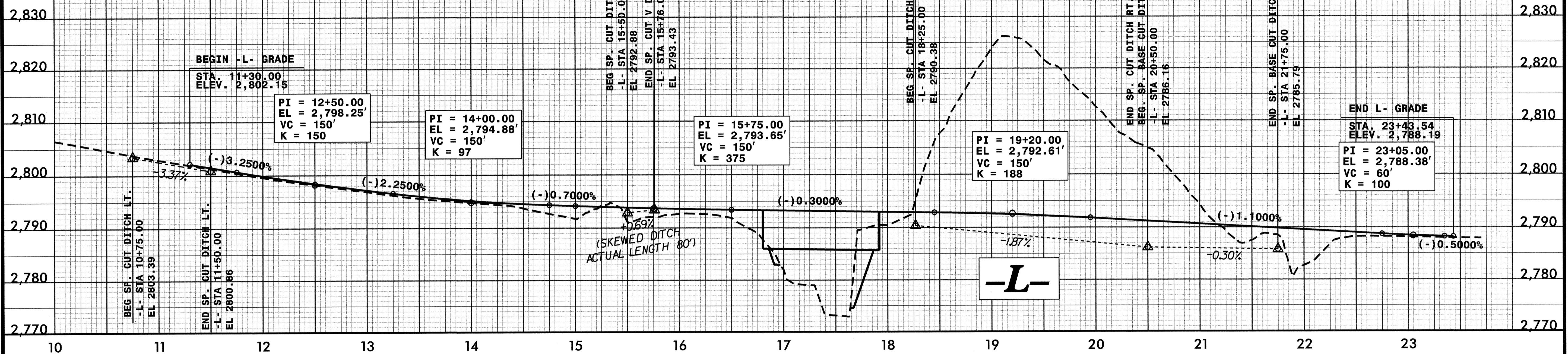

5/28/99
 07/21/2004
 P:\roadway\proj\B3300_rdy.pfl.dgn