

BAR SCHEDULE											
BAR	NO.	SIZE	TYPE	LENGTH	WEIGHT	BAR	NO.	SIZE	TYPE	LENGTH	WEIGHT
* A1	117	#5	STR	46'-11"	5725	A209	4	#5	STR	25'-0"	104
A2	117	#5	STR	46'-11"	5725	A210	4	#5	STR	22'-6"	94
						A211	4	#5	STR	20'-1"	84
* A101	4	#5	STR	44'-7"	186	A212	4	#5	STR	17'-8"	74
* A102	4	#5	STR	42'-2"	176	A213	4	#5	STR	15'-2"	63
* A103	4	#5	STR	39'-9"	166	A214	4	#5	STR	12'-9"	53
* A104	4	#5	STR	37'-3"	155	A215	4	#5	STR	10'-3"	43
* A105	4	#5	STR	34'-10"	145	A216	4	#5	STR	7'-10"	33
* A106	4	#5	STR	32'-4"	135	A217	4	#5	STR	5'-4"	22
* A107	4	#5	STR	29'-11"	125	A218	4	#5	STR	2'-11"	12
* A108	4	#5	STR	27'-5"	114						
* A109	4	#5	STR	25'-0"	104	* B1	132	#4	STR	28'-10"	2542
* A110	4	#5	STR	22'-6"	94	B2	93	#5	STR	37'-10"	3670
* A111	4	#5	STR	20'-1"	84						
* A112	4	#5	STR	17'-8"	74	* G1	2	#5	STR	28'-4"	113
* A113	4	#5	STR	15'-2"	63						
* A114	4	#5	STR	12'-9"	53	* K1	8	#8	1	13'-6"	288
* A115	4	#5	STR	10'-3"	43	* K2	16	#8	2	17'-8"	755
* A116	4	#5	STR	7'-10"	33	* K3	40	#6	STR	4'-5"	265
* A117	4	#5	STR	5'-4"	22	K4	40	#6	STR	7'-10"	471
* A118	4	#5	STR	2'-11"	12	K5	40	#5	STR	6'-10"	285
						K6	10	#5	5	6'-3"	65
A201	4	#5	STR	44'-7"	186						
A202	4	#5	STR	42'-2"	176	* S1	40	#5	3	6'-0"	250
A203	4	#5	STR	39'-9"	166	* S2	40	#4	6	5'-7"	149
A204	4	#5	STR	37'-3"	155	S3	20	#4	7	2'-11"	39
A205	4	#5	STR	34'-10"	145	S4	25	#4	4	9'-10"	164
A206	4	#5	STR	32'-4"	135						
A207	4	#5	STR	29'-11"	125						
A208	4	#5	STR	27'-5"	114						
						REINFORCING STEEL = 12203 LBS.					
						* EPOXY COATED REINF. STEEL = 11871 LBS.					

* THESE BARS ARE EPOXY COATED.

SUPERSTRUCTURE REINFORCING STEEL LENGTHS ARE BASED ON THE FOLLOWING MINIMUM SPLICE LENGTHS

BAR SIZE	SUPERSTRUCTURE EXCEPT APPROACH SLABS, PARAPET, AND BARRIER RAIL		APPROACH SLABS		PARAPET AND BARRIER RAIL
	EPOXY COATED	UNCOATED	EPOXY COATED	UNCOATED	
#4	2'-0"	1'-9"	2'-0"	1'-9"	2'-9"
#5	2'-6"	2'-2"	2'-6"	2'-2"	3'-5"
#6	3'-0"	2'-7"	3'-10"	2'-7"	4'-4"
#7	5'-3"	3'-6"			
#8	6'-10"	4'-7"			

GROOVING BRIDGE FLOORS

APPROACH SLABS	888	SQ.FT.
BRIDGE DECK	4422	SQ.FT.
TOTAL	5310	SQ.FT.

BILL OF MATERIAL

END BENT NO.	ELASTOMERIC CONCRETE *** (CU. FT.)
#1	7.6
#2	7.6
TOTAL	15.2

*** BASED ON THE MINIMUM BLOCKOUT.

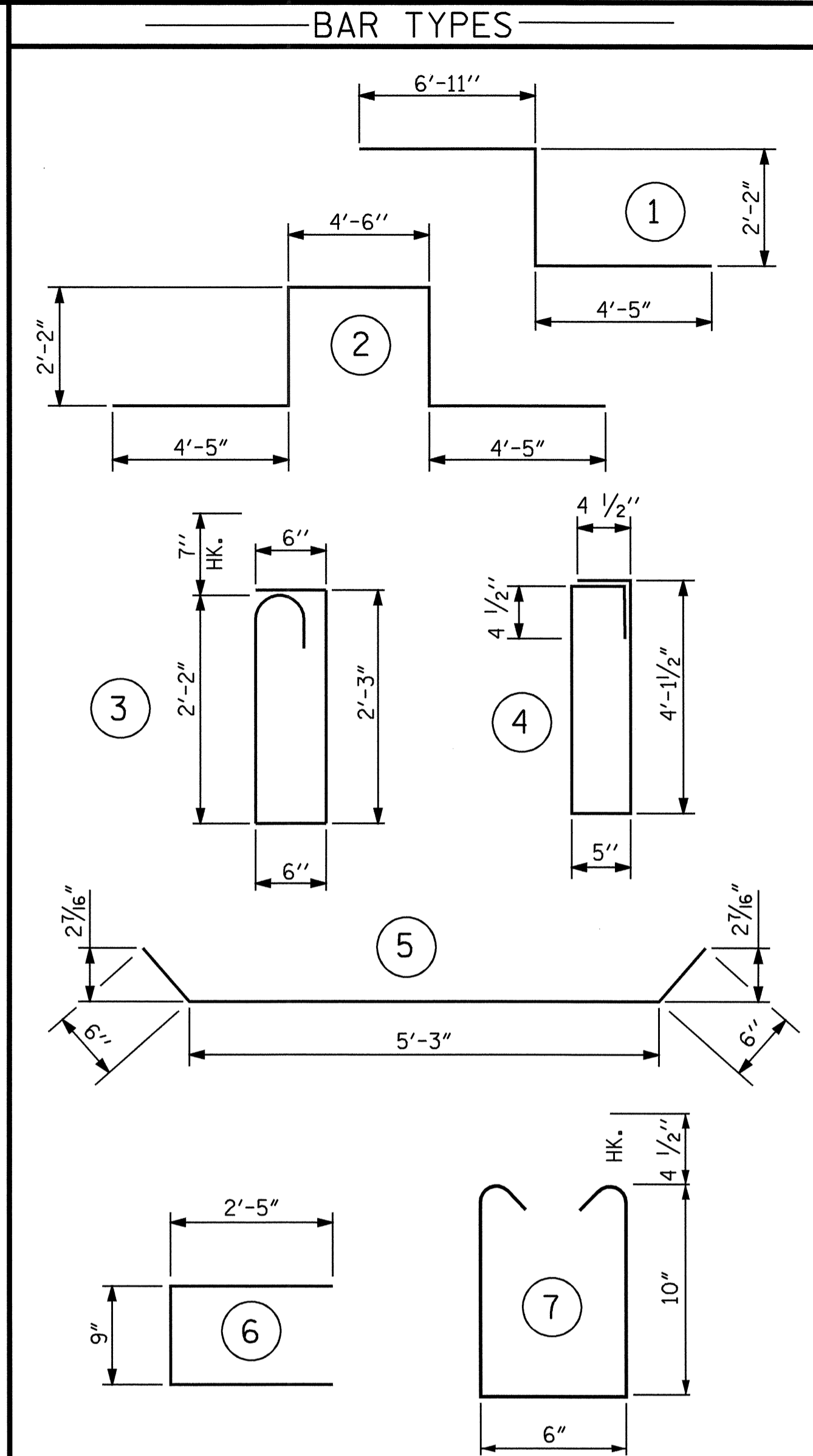

ALL BAR DIMENSIONS ARE OUT TO OUT

— SUPERSTRUCTURE BILL OF MATERIAL —

	CLASS AA CONCRETE (CU. YDS.)	REINFORCING STEEL (LBS.)	EPOXY COATED REINFORCING STEEL (LBS.)
SPAN "A"	179.9	12203	11744
TOTALS**	179.9	12203	11744

** QUANTITIES FOR BARRIER RAIL ARE NOT INCLUDED

PROJECT NO. B-3300
ASHE COUNTY
 STATION: 17+36.00-L-

STATE OF NORTH CAROLINA
 DEPARTMENT OF TRANSPORTATION
 RALEIGH

STANDARD
 SUPERSTRUCTURE
 BILL OF MATERIAL

OCTOBER 1987

REVISIONS						SHEET NO.
NO.	BY:	DATE:	NO.	BY:	DATE:	S-12
1			3			TOTAL SHEETS
2			4			23

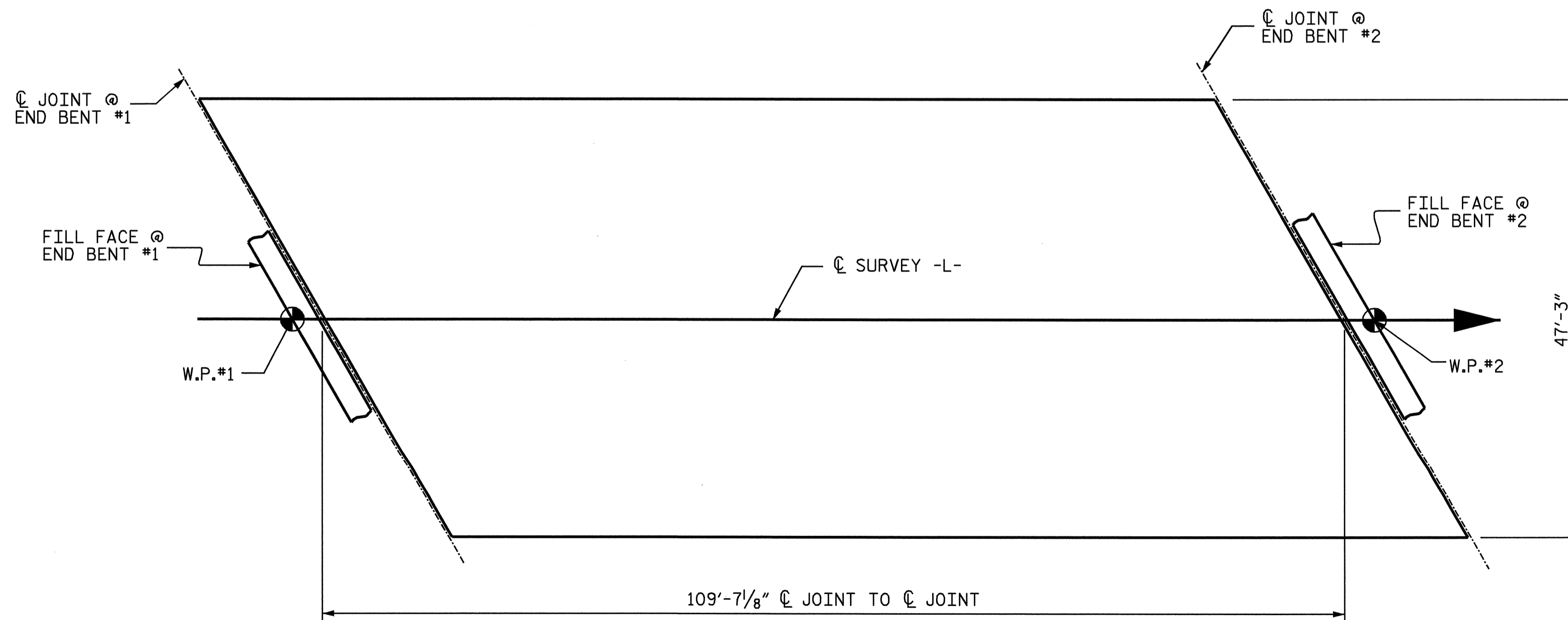
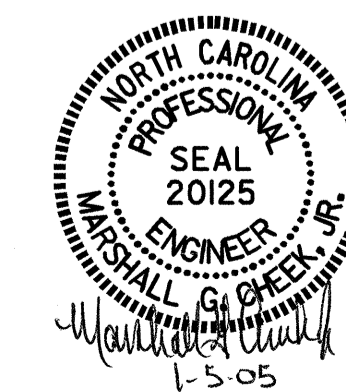

LAYOUT FOR COMPUTING AREA
 REINFORCED CONCRETE DECK SLAB
 (SQ. FT. = 5178)

ASSEMBLED BY : L.L. MURPHY	DATE : 10-04
CHECKED BY : V.X. NGUYEN	DATE : 12-04
DRAWN BY : JMB 5/87	REV. 6/1/94 EEM/GRP
CHECKED BY : SJD 9/87	REV. 8/16/99 RWW/LES