

CONTRACT: C201183 TIP PROJECT: B-3694

See Sheet 1-A For Index of Sheets
See Sheet 1-B For Conventional Symbols

STATE OF NORTH CAROLINA
DIVISION OF HIGHWAYS

ROCKINGHAM COUNTY

**LOCATION: BRIDGE NO. 55 OVER BELEWS LAKE
SPILLWAY ON SR 1138 (LINDSEY BRIDGE ROAD)**

TYPE OF WORK: GRADING, DRAINAGE, PAVING, AND STRUCTURE

STATE	STATE PROJECT REFERENCE NO.	SHEET NO.	TOTAL SHEETS
N.C.	B-3694	1	
STATE WBS NO.	F.A. PROJ. NO.	DESCRIPTION	
33234.1.1	BRZ-1138(9)	PE	
33234.2.2	BRZ-1138(9)	RW, UTIL.	
33234.3.1	BRZ-1138(14)	CONST.	

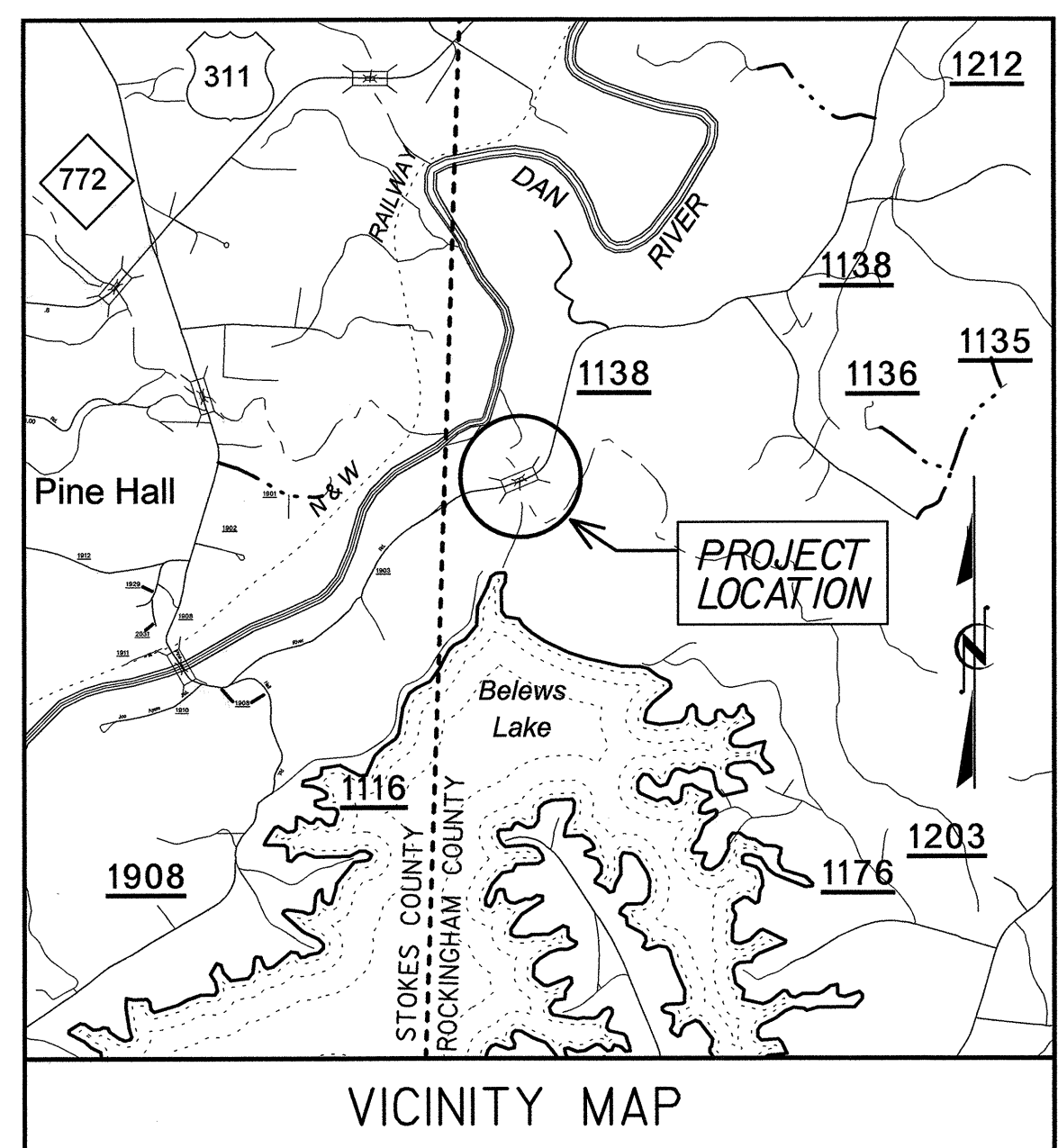

VICINITY MAP

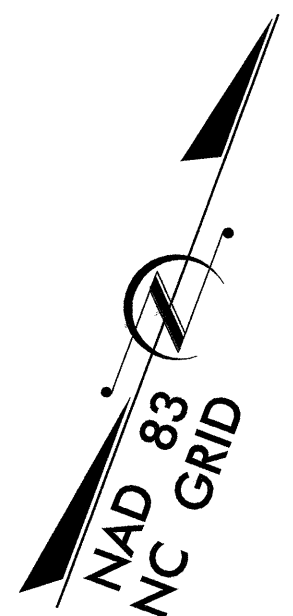
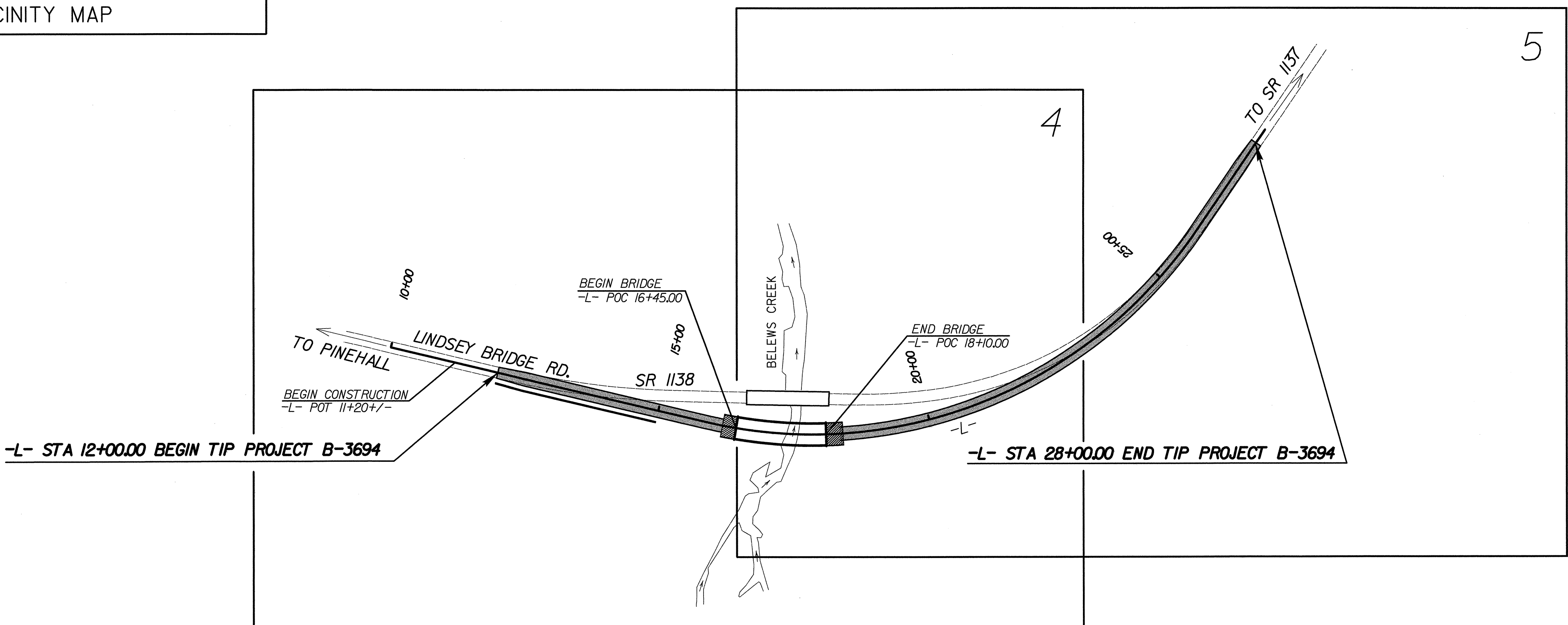

NOTE: BLASTING SHALL NOT BE PERMITTED ANYWHERE ON THIS PROJECT.

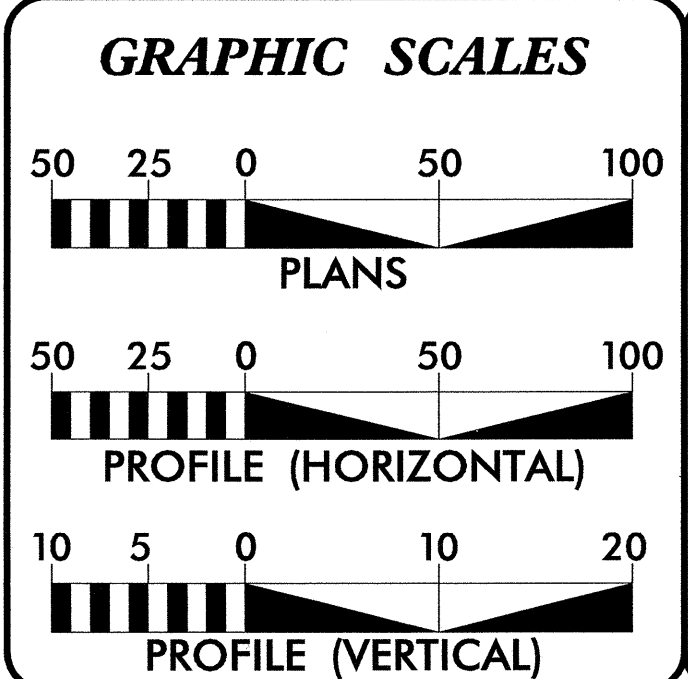

DESIGN DATA

ADT 2005	=	1,650
ADT 2025	=	2,500
DHV	=	10 %
D	=	60 %
T	=	3 % *
V	=	60 MPH

* (TTST 1% + DUAL 2%)

DESIGN EXCEPTION REQ'D FOR:
MAXIMUM GRADE, MIN. HORIZONTAL CURVE RADIUS, SAG & CREST VERTICAL CURVE K, HORIZONTAL SSD, & VERTICAL SSD

PROJECT LENGTH

LENGTH ROADWAY TIP PROJECT B-3694	=	0.272 MI
LENGTH STRUCTURE TIP PROJECT B-3694	=	0.031 MI
TOTAL LENGTH TIP PROJECT B-3694	=	0.303 MI

PLANS PREPARED BY:

TGS ENGINEERS
975 WALNUT STREET
CARY, NC 27511
PH (919) 319-8850

2002 STANDARD SPECIFICATIONS

RIGHT OF WAY DATE:
MARCH 31, 2004

LETTING DATE:
MARCH 15, 2005

NCDOT CONTACT:

PLANS PREPARED FOR:

DIVISION OF HIGHWAYS
1000 Birch Ridge Dr.
Raleigh, NC 27610

CHARLES L. FLOWE, PE
PROJECT ENGINEER

W. CRAIG PARKER, PE
PROJECT DESIGN ENGINEER

TERESA BRUTON, PE
PROJECT ENGINEER - DESIGN SERVICES

HYDRAULICS ENGINEER

William J. Stephens
SIGNATURE: 12-16-04

ROADWAY DESIGN ENGINEER

W. Craig Parker
SIGNATURE: 12-16-04

Professional Engineer seals for William J. Stephens (Seal 20754) and W. Craig Parker (Seal 25474).

**DIVISION OF HIGHWAYS
STATE OF NORTH CAROLINA**

Art McMillan
STATE DESIGN ENGINEER

**DEPARTMENT OF TRANSPORTATION
FEDERAL HIGHWAY ADMINISTRATION**

APPROVED
DIVISION ADMINISTRATOR

DATE