

SURVEY CONTROL SHEET B-3694

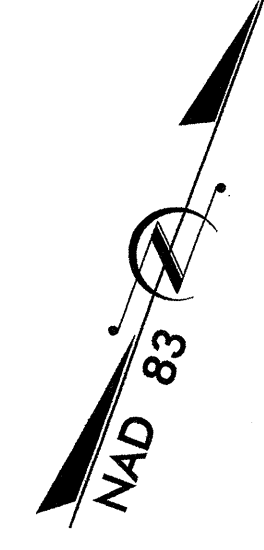

NOTES

L THE CONTROL DATA FOR THIS PROJECT CAN BE FOUND ELECTRONICALLY BY SELECTING PROJECT CONTROL DATA AT:

HTTP://WWW.DOH.DOT.STATE.NC.US/PRECONSTRUCT/HIGHWAY/LOCATION/PROJECT/

FILE: B3694_LS_CONTROL_03I2I5.TXT

SITE CALIBRATION INFORMATION HAS NOT BEEN PROVIDED FOR THIS PROJECT. IF FURTHER INFORMATION IS NEEDED, PLEASE CONTACT THE LOCATION AND SURVEYS UNIT.

DATUM DESCRIPTION

THE LOCALIZED COORDINATE SYSTEM DEVELOPED FOR THIS PROJECT IS BASED ON THE STATE PLANE COORDINATES ESTABLISHED BY NCGS FOR MONUMENT "RIVERCO"

WITH NAD 83 STATE PLANE GRID COORDINATES OF
NORTHING: 939853.3311 EASTING: 1695829.1611

THE AVERAGE COMBINED GRID FACTOR USED ON THIS PROJECT (GROUND TO GRID) IS: 1.000024394

THE N.C. LAMBERT GRID BEARING AND LOCALIZED HORIZONTAL GROUND DISTANCE FROM "RIVERCO" TO L- STATION 12+00.00 IS
N 77°41'49.8" E 778.48'

ALL LINEAR DIMENSIONS ARE LOCALIZED HORIZONTAL DISTANCES
VERTICAL DATUM USED IS NAVD 29

NCDOT BASELINE STATION "BL-1" (RIVERCO)
LOCALIZED PROJECT COORDINATES
N= 939853.3335
E= 1695829.1608

NCDOT BASELINE STATION "BL-2"
LOCALIZED PROJECT COORDINATES
N= 940005.3640
E= 1696374.7250

BL-3
BL- POC 16+90.10 =
L- POC 16+09.11
36.99' LT

NCDOT BASELINE STATION "BL-4"
LOCALIZED PROJECT COORDINATES
N= 940277.4950
E= 1697407.4510

NCDOT BASELINE STATION "BL-5"
LOCALIZED PROJECT COORDINATES
N= 941086.5840
E= 1697799.2570

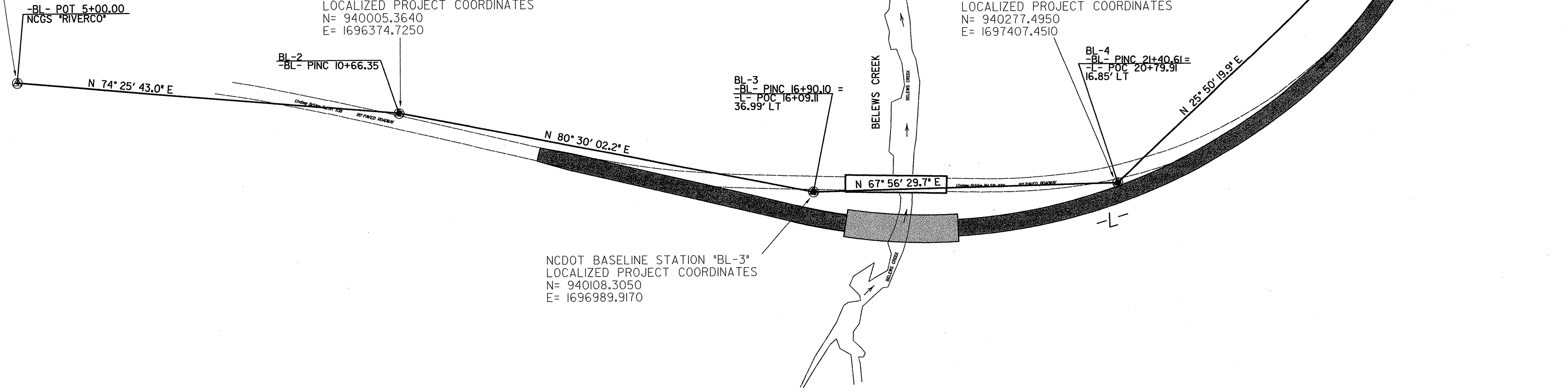

NCDOT BASELINE STATION "BL-3"
LOCALIZED PROJECT COORDINATES
N= 940108.3050
E= 1696989.9170

BL POINT	DESC.	NORTH	EAST	ELEVATION	L STATION	OFFSET
1	BL-1	939853.3335	1695829.1608	592.26	OUTSIDE PROJECT LIMITS	
2	BL-2	940005.3640	1696374.7250	596.87	OUTSIDE PROJECT LIMITS	
3	BL-3	940108.3050	1696989.9170	592.41	16+09.11	36.99 LT
4	BL-4	940277.4950	1697407.4510	595.99	20+79.91	16.85 LT
5	BL-5	941086.5840	1697799.2570	646.22	OUTSIDE PROJECT LIMITS	

DATUM DESCRIPTION

THE LOCALIZED COORDINATE SYSTEM DEVELOPED FOR THIS PROJECT IS BASED ON THE STATE PLANE COORDINATES ESTABLISHED BY NCGS FOR MONUMENT "RIVERCO"

WITH NAD 83 STATE PLANE GRID COORDINATES OF
NORTHING: 939853.3311 EASTING: 1695829.1611

THE AVERAGE COMBINED GRID FACTOR USED ON THIS PROJECT (GROUND TO GRID) IS: 1.000024394

THE N.C. LAMBERT GRID BEARING AND LOCALIZED HORIZONTAL GROUND DISTANCE FROM "RIVERCO" TO L- STATION 10+00 IS
N 75°59'19" E 579.49'

ALL LINEAR DIMENSIONS ARE LOCALIZED HORIZONTAL DISTANCES
VERTICAL DATUM USED IS NAVD 88

.....
40 ELEVATION = 595.15
N 940847 E 1696992
L STATION 16+02.24 RIGHT
R/R SPIKE IN BASE OF RED OAK
.....
41 ELEVATION = 628.30
N 940853 E 1697730
L STATION 25+68.51 RIGHT
R/R SPIKE IN ROOT OF YELLOW POPLAR
.....

Ⓢ INDICATES GEODETIC CONTROL MONUMENTS USED OR SET FOR HORIZONTAL PROJECT CONTROL BY THE NCDOT LOCATION AND SURVEYS UNIT.

PROJECT CONTROL ESTABLISHED USING GLOBAL POSITIONING SYSTEM.

NETWORK ESTABLISHED FROM NGS ONLINE POSITIONING USER SERVICE (OPUS)

SEE GPS CALIBRATION SHEET FOR HORIZONTAL AND VERTICAL COORDINATE VALUES.

NOTE: DRAWING NOT TO SCALE

5/14/95
1
2
3
4
5
6
7
8
9
10
11
12
13
14
15
16
17
18
19
20
21
22
23
24
25
26
27
28
29
30
31
32
33
34
35
36
37
38
39
40
41
42
43
44
45
46
47
48
49
50
51
52
53
54
55
56
57
58
59
60
61
62
63
64
65
66
67
68
69
70
71
72
73
74
75
76
77
78
79
80
81
82
83
84
85
86
87
88
89
90
91
92
93
94
95
96
97
98
99
100

\\p01\proj\133594_LC.dgn 09/02/2004 11:27:56 AM