

TIP: B-3682 & W-3413

STATE OF NORTH CAROLINA
DIVISION OF HIGHWAYS

T.I.P. NO.	SHEET NO.
B-3682 & W-3413	UC-1

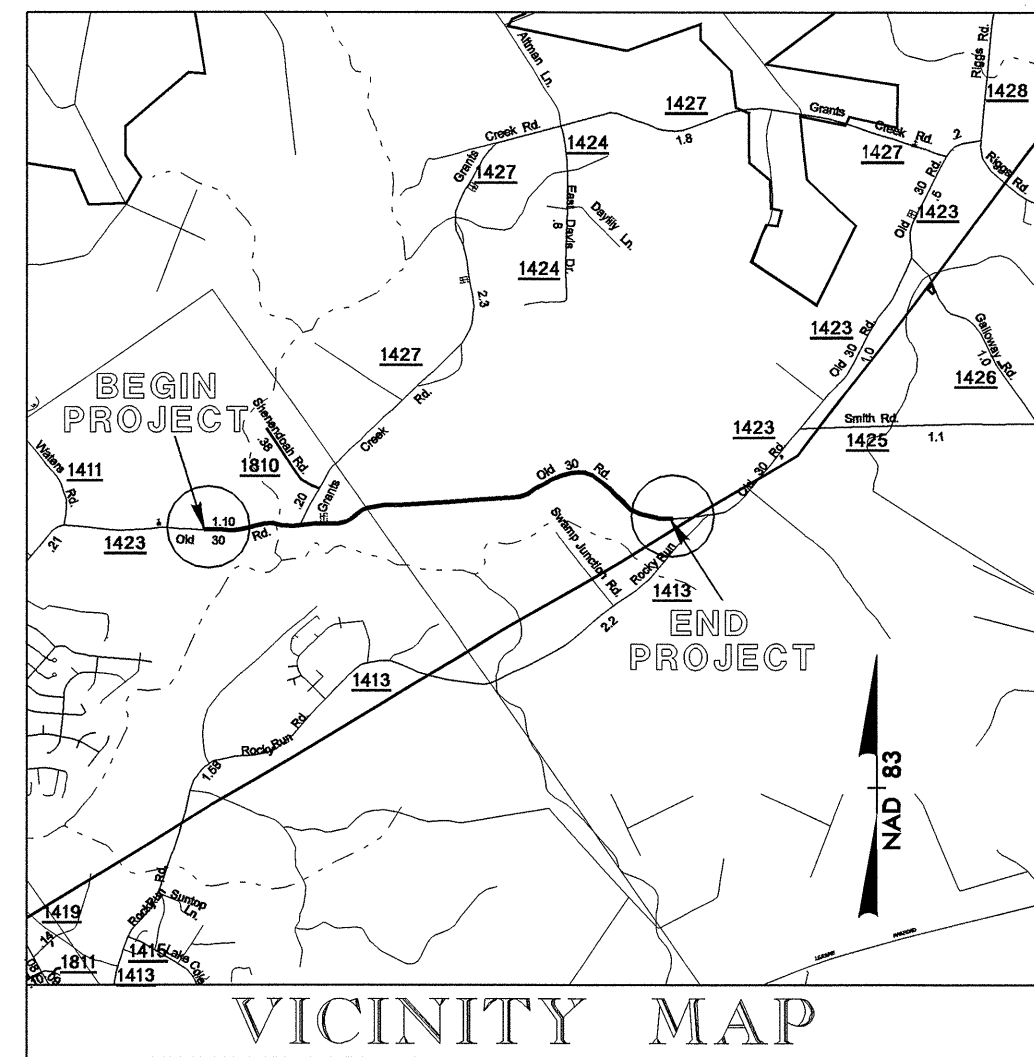

**UTILITY CONSTRUCTION PLANS
OWNSLOW COUNTY**

**LOCATION: B-3682 - BRIDGE NO.3 OVER LITTLE NORTHEAST CREEK ON SR 1423
W-3413 - SR 1423 FROM SR 1427 TO SR 1413**

TYPE OF WORK: WATER LINE RELOCATION

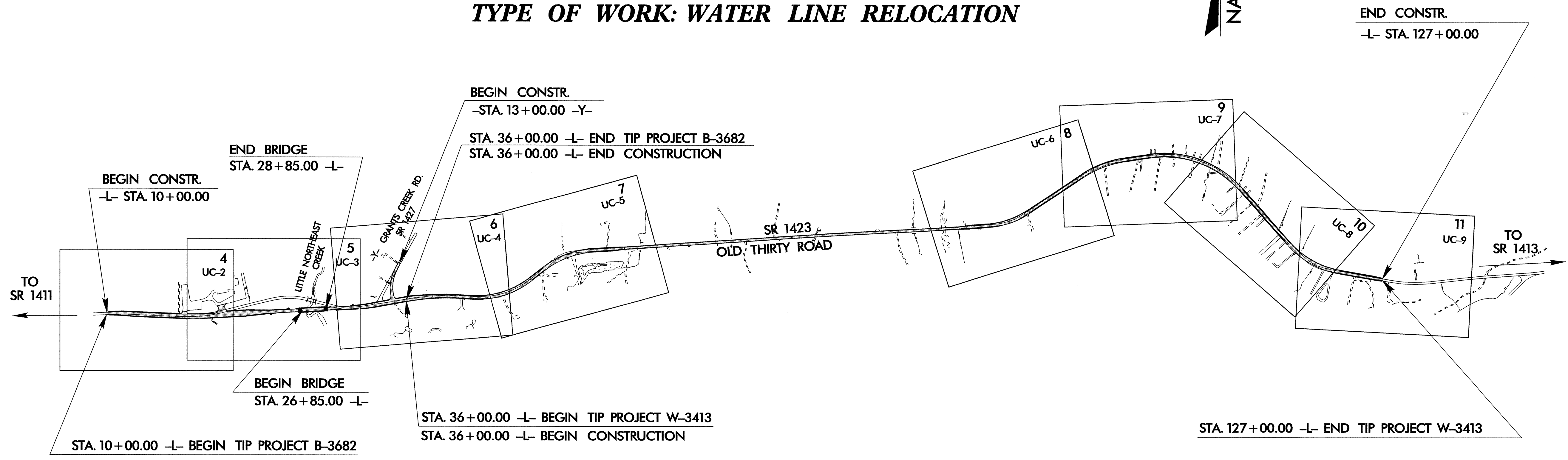
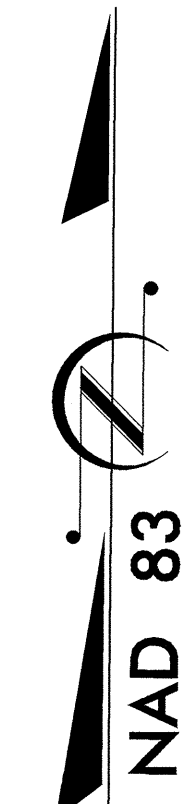

THIS PROJECT IS NOT WITHIN ANY MUNICIPAL BOUNDARIES
CLEARING ON THIS PROJECT SHALL BE PERFORMED TO THE
LIMITS ESTABLISHED BY METHOD III

2002 STANDARD SPECIFICATIONS

INDEX OF SHEETS	
SHEET NO.	DESCRIPTION
UC-1	TITLE SHEET
UC-2 THRU UC-9	UTILITY CONSTRUCTION PLAN SHEETS
UC-10	DETAIL SHEET

WATER AND SEWER OWNERS ON PROJECT

(1) ONSLOW COUNTY PUBLIC UTILITIES



PREPARED IN THE OFFICE OF:
**DIVISION OF HIGHWAYS
PROJECT SERVICES
UTILITY SECTION**

1591 MAIL SERVICES CENTER
RALEIGH NC 27699-1591
PHONE (919) 250-4128
FAX (919) 250-4119

R. G. WORTHINGTON, JR., P.E. UTILITIES SECTION ENGINEER
G. Y. STEVENS, P.E. UTILITIES SQUAD LEADER PROJECT ENGINEER
V. MOUA UTILITIES PROJECT DESIGNER