

NOTE: USE RSD 1101.02, SHEET 1 OF 7, FOR ANY LANE CLOSURE ON EXISTING -L- AND PROPOSED -L-. SEE SHEET TCP-4, STEP 4.

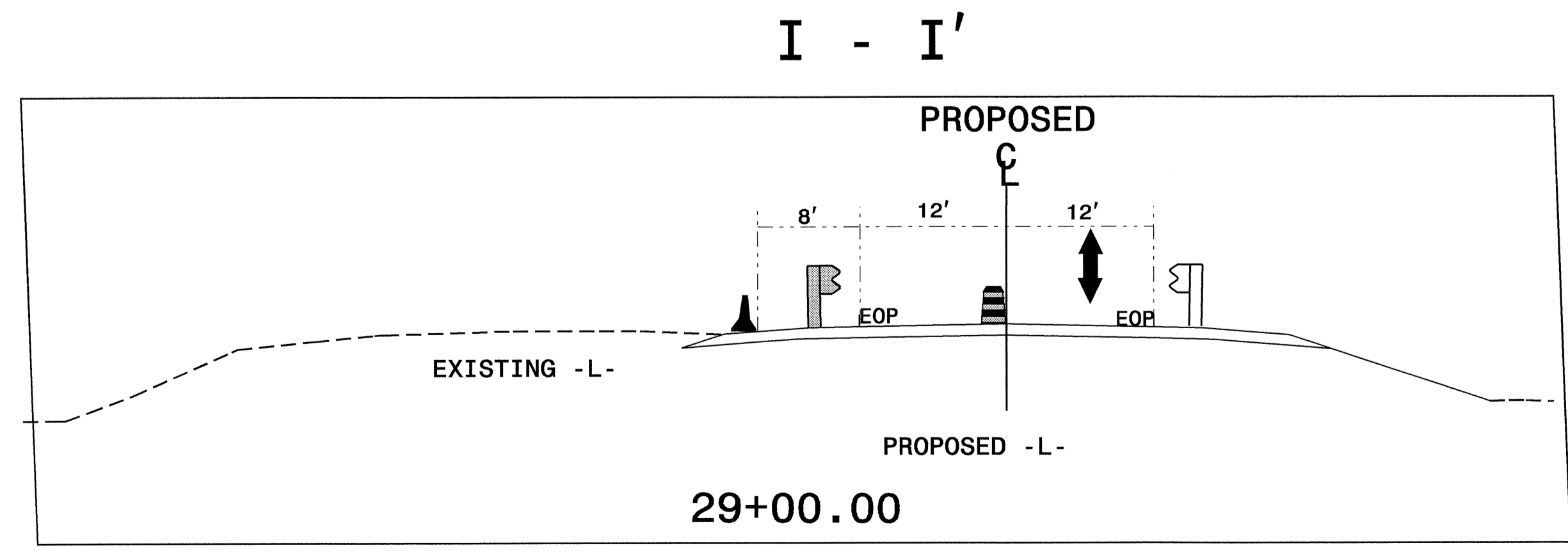
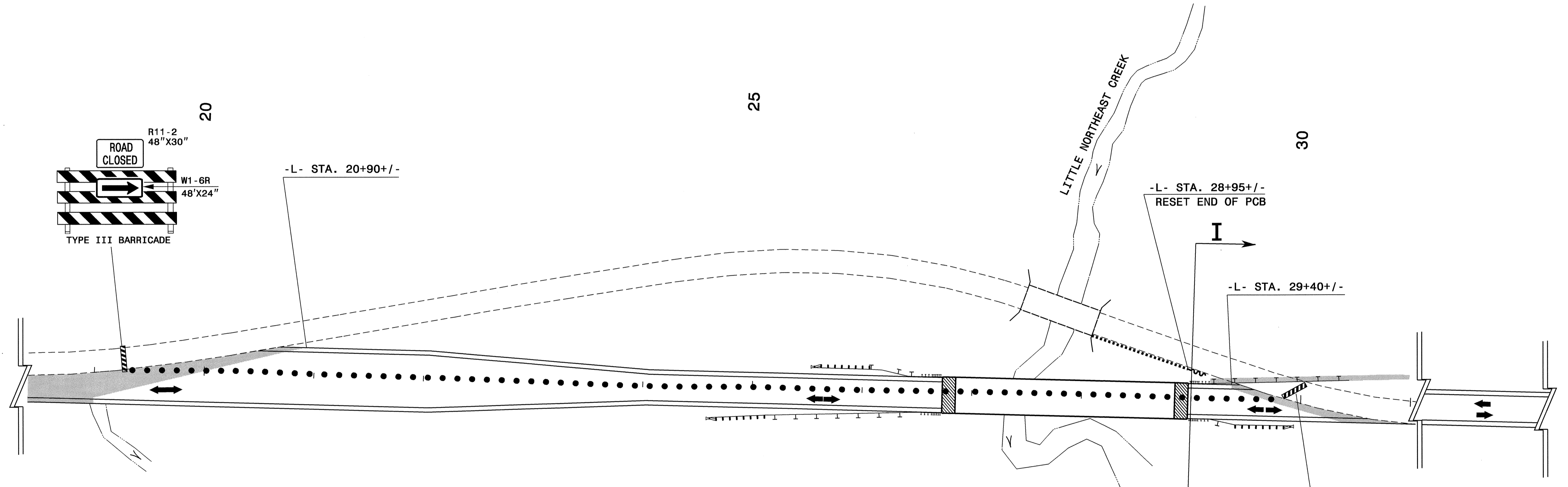

APPROVED: <i>Joseph Ishak</i> DATE: 12/02/04	<b>DETAIL 2: PROPOSED -L- TIE-INS</b>							
	SCALE: NONE							
	DATE: 12/02/04							
	DESIGN BY: CLL							
	REVIEWED BY: JI							
		<table border="1"> <thead> <tr> <th colspan="2">REVISIONS</th> </tr> </thead> <tbody> <tr> <td> </td> <td> </td> </tr> <tr> <td> </td> <td> </td> </tr> </tbody> </table>	REVISIONS					
REVISIONS								

06-DEC-2004 09:08  
 \\e:\s-ccts\01\B-3682\A\TCP\B3682ANDW3413TCP.DGN  
 cldm\ford AT 12/02/04