

09/08/99

CONTRACT: C201182A TIP PROJECT: B-3682

CONTRACT: C201182 TIP PROJECT: W-3413

See Sheet 1-A For Index of Sheets
See Sheet 1-B For Conventional Symbols

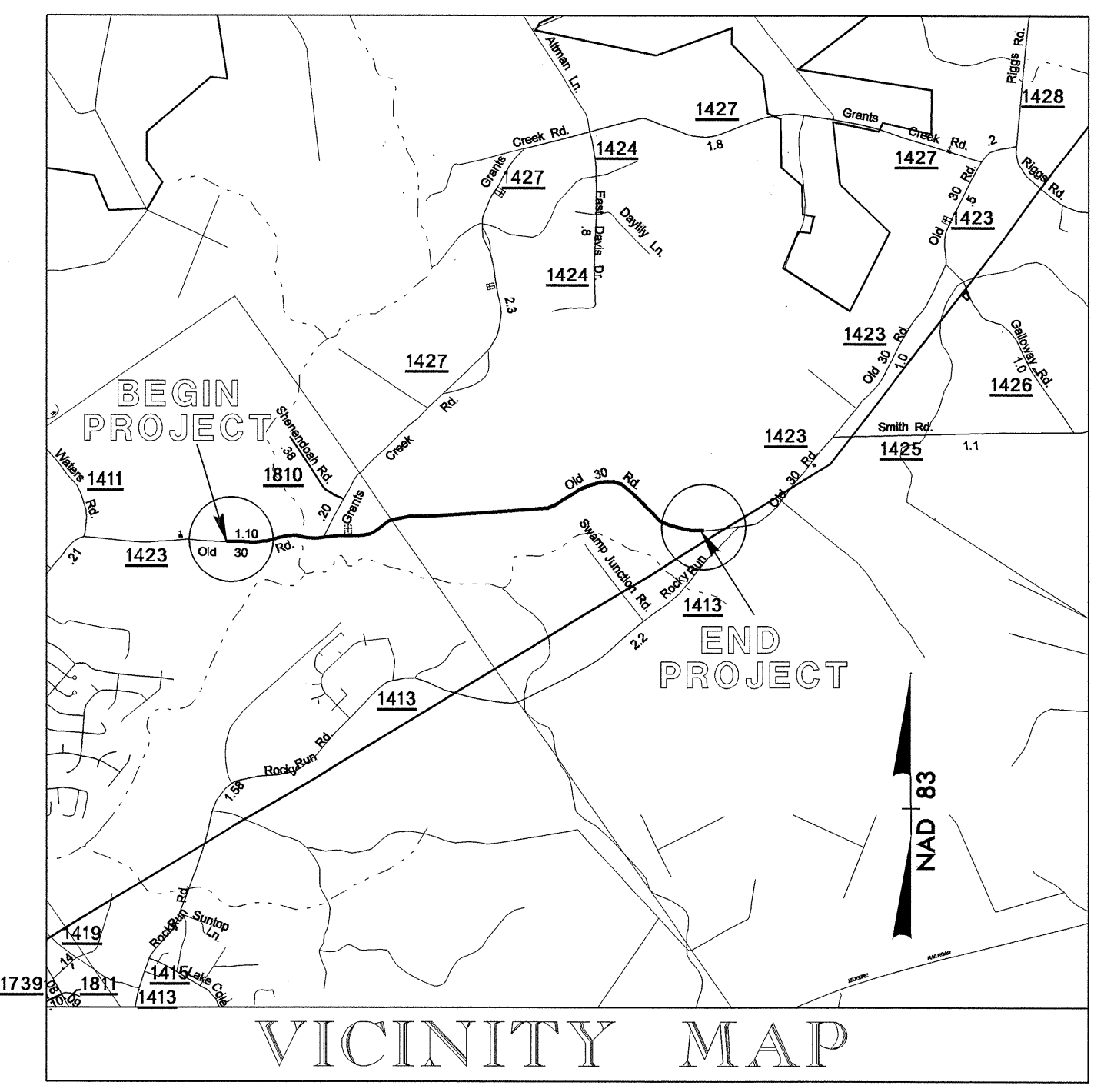

STATE OF NORTH CAROLINA
DIVISION OF HIGHWAYS
ONSLOW COUNTY

LOCATION: B-3682 - BRIDGE NO. 3 OVER LITTLE NORTHEAST CREEK ON SR 1423
W-3413 - SR 1423 FROM SR 1427 TO SR 1413
TYPE OF WORK: GRADING, PAVING, WIDENING, RESURFACING DRAINAGE AND STRUCTURE.

STATE	STATE PROJECT REFERENCE NO.	SHEET NO.	TOTAL SHEETS
N.C.	B-3682 & W-3413	1	
STATE PROJ. NO.	F.A. PROJ. NO.	DESCRIPTION	
33224.1.1	BRSTP-1423 (2)	P.E.	
33224.1.1	BRSTP-1423 (3)	ROW,UTIL.	
33224.3.2	BRSTP-1423 (5)	CONST.	
35052.1.1	STP-1423 (2)	P.E.,ROW,UTIL.	
35052.3.1	STP-1423 (2)	CONST.	

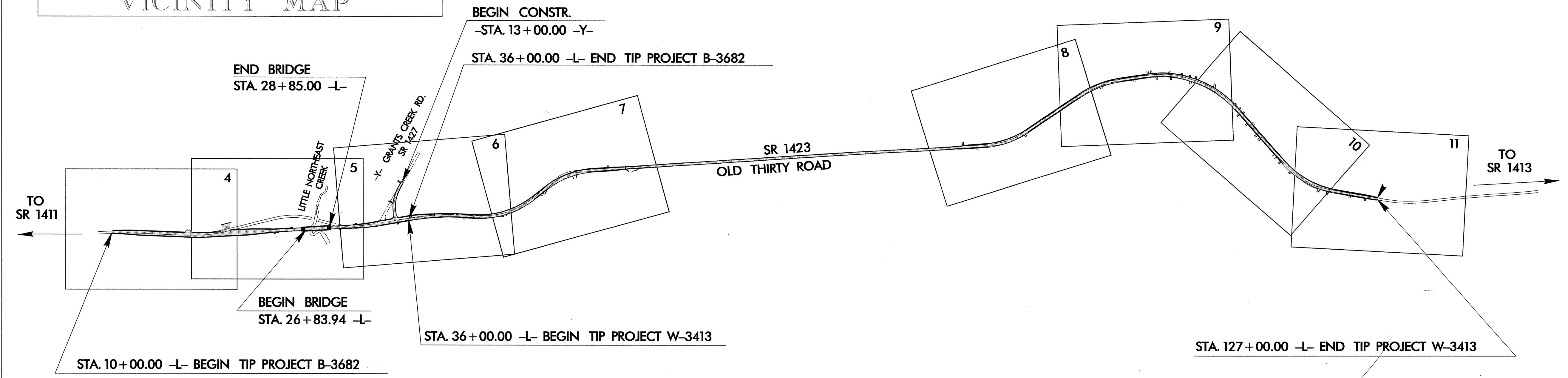
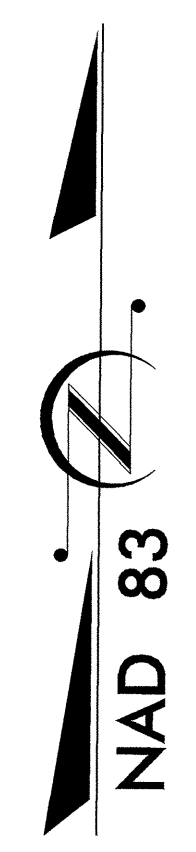

GRAPHIC SCALES

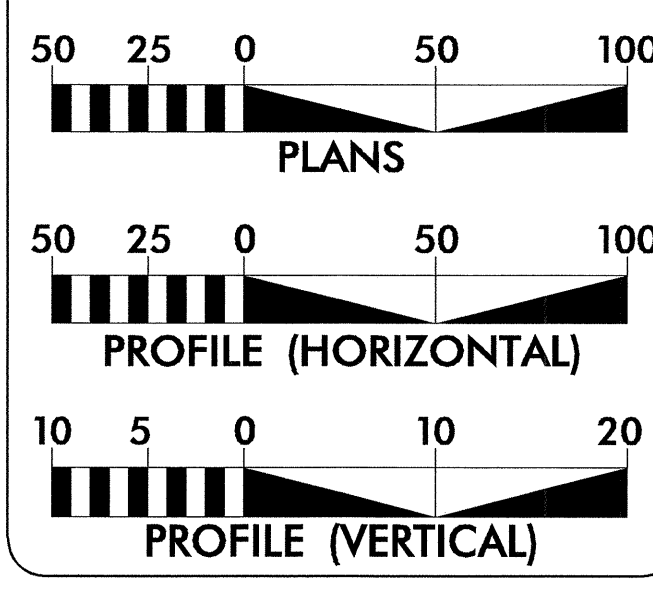

DESIGN DATA

ADT 2004 = 3,680
ADT 2024 = 6,080
DHV = 9 %
D = 55 %
T = 3 % *
V = 50 MPH
* TTST 1 % DUAL 2 %
FUNC CLASS = LOCAL

PROJECT LENGTH

LENGTH ROADWAY B-3682 = 0.454 mi
LENGTH STRUCTURE B-3682 = 0.038 mi
TOTAL LENGTH STATE PROJECT B-3682 = 0.492 mi
LENGTH ROADWAY W-3413 = 1.723 mi
TOTAL LENGTH STATE PROJECT W-3413 = 1.723 mi
TOTAL LENGTH PROJECTS B-3682 AND W-3413 = 2.215 mi

Prepared in the Office of:
DIVISION OF HIGHWAYS
1000 Birch Ridge Dr., NC, 27610

2002 STANDARD SPECIFICATIONS

RIGHT OF WAY DATE: JIMMY S. GOODNIGHT
September 30, 2003 PROJECT ENGINEER

LETTING DATE: TIM GOINS
March 15, 2005 PROJECT DESIGN ENGINEER

HYDRAULICS ENGINEER

Professional Engineer Seal: Max S. Price, No. 023993

SIGNATURE: [Signature] P.E.

ROADWAY DESIGN ENGINEER

Professional Engineer Seal: Tim Goins, No. 14493

SIGNATURE: [Signature] P.E.

DIVISION OF HIGHWAYS
STATE OF NORTH CAROLINA

Professional Engineer Seal: [Blank]

SIGNATURE: [Blank] P.E.

STATE DESIGN ENGINEER

DEPARTMENT OF TRANSPORTATION
FEDERAL HIGHWAY ADMINISTRATION

APPROVED DIVISION ADMINISTRATOR DATE

26-JAN-2005 15:18
T:\proj\B3682\Tsh
TDGoins AT