

**VIEW X-X**

(TYP. EACH END FOR BENTS NO. 1, 2, 3, & 4)

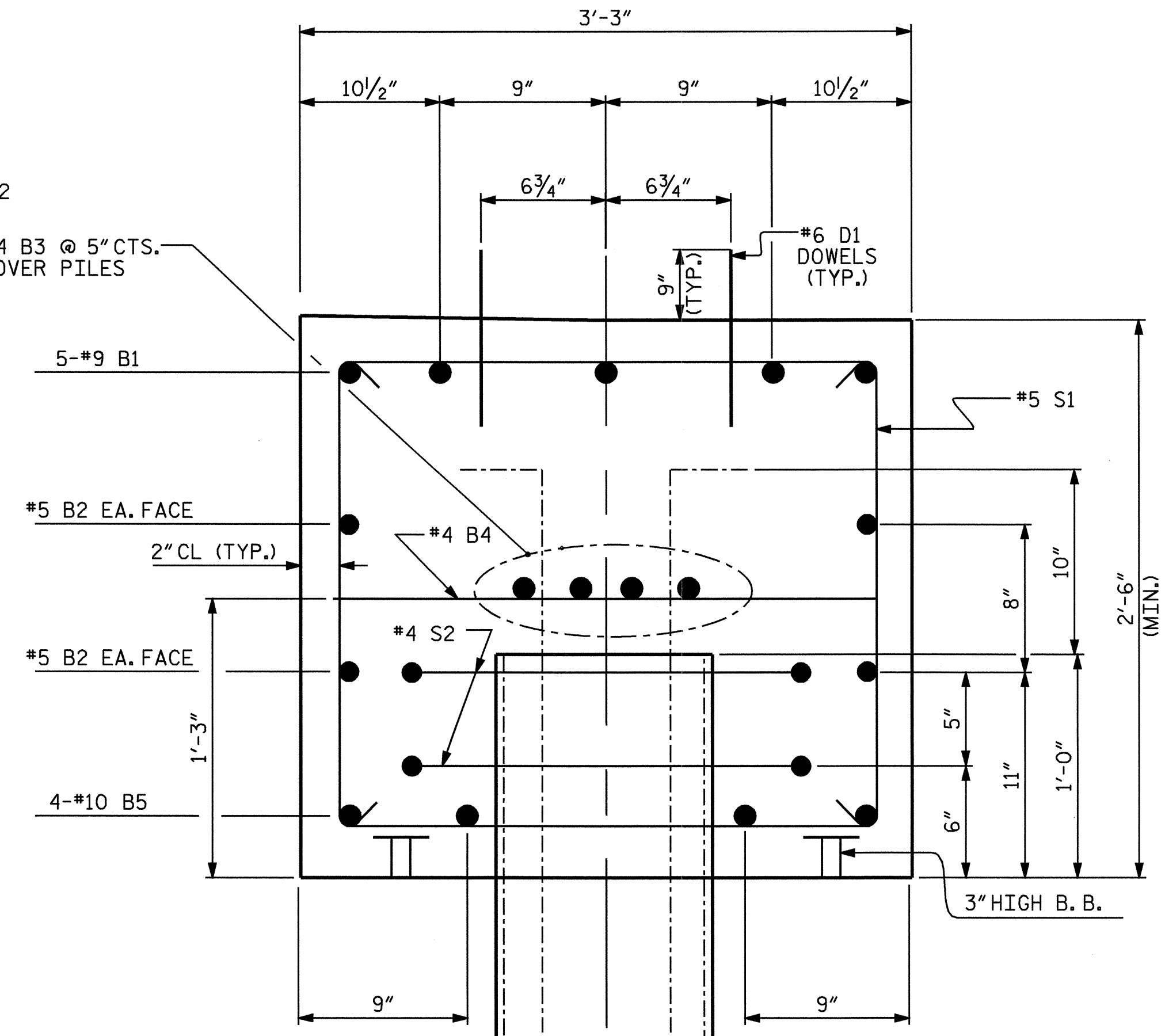

**SECTION A-A**

FOR REINFORCING STEEL IN STEEL PIPE PILES, SEE 18" STEEL PIPE PILE SHEET FOR DETAILS.

PP 18 X 0.5 STEEL PILE

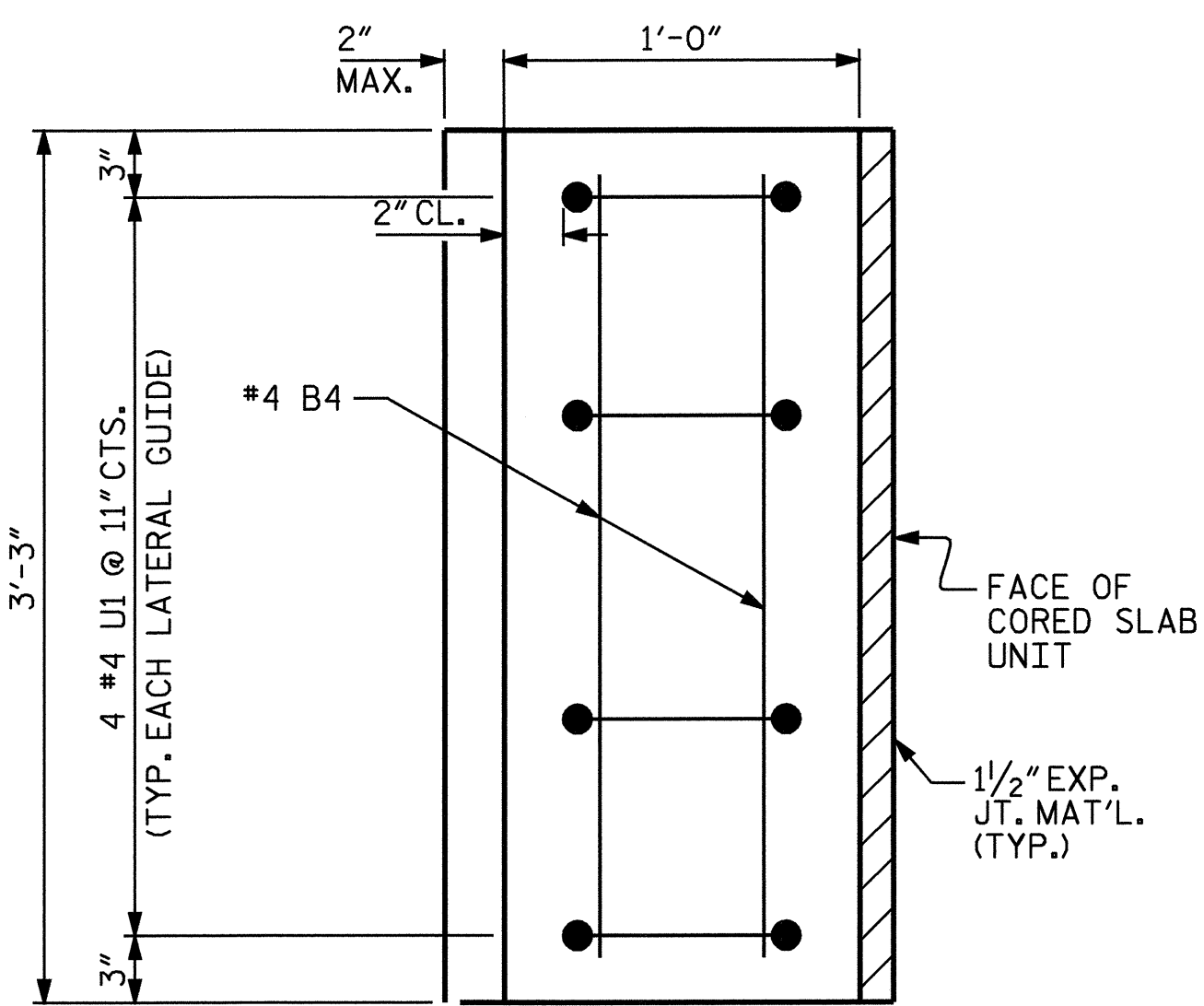

**LATERAL GUIDE DETAIL**

(TYP. EACH END AND EACH BENT)

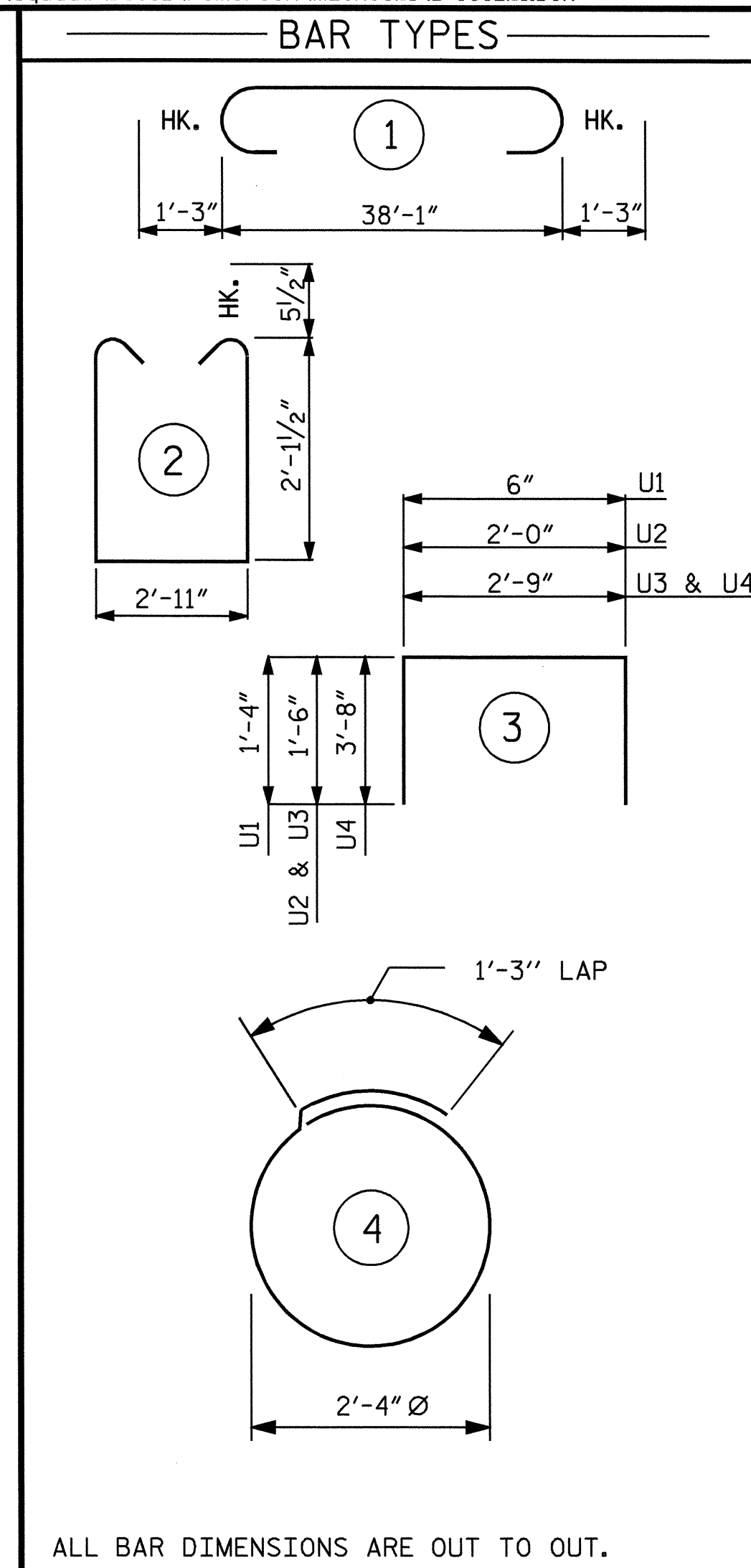

ALL BAR DIMENSIONS ARE OUT TO OUT.

**BILL OF MATERIAL FOR ONE BENT (4 BENTS REQUIRED)**

BAR NO.	SIZE	TYPE	LENGTH	WEIGHT	
B1	5	9	1	40'-7"	690
B2	4	5	STR	38'-3"	160
B3	8	4	STR	20'-4"	109
B4	14	4	STR	2'-11"	27
B5	4	10	STR	38'-3"	658
D1	48	6	STR	1'-6"	108
S1	41	5	2	8'-1"	346
S2	12	4	4	8'-7"	69
U1	8	4	3	3'-2"	17
U2	6	4	3	5'-0"	20
U3	4	4	3	5'-9"	15
U4	2	9	3	10'-1"	69
TOTAL REINFORCING STEEL				LBS.	2288

CLASS A CONCRETE BREAKDOWN:  
 POUR #1 (CAP) 11.6 C. Y.  
 POUR #2 (LATERAL GUIDE) 0.1 C. Y.  
 TOTAL CLASS A CONCRETE 11.7 C. Y.

PP 18 X 0.5 STEEL PILE:

BENT No.	No.	LIN. FT.
BENT No. 1	No. 6	LIN. FT. 210
BENT No. 2	No. 6	LIN. FT. 210
BENT No. 3	No. 6	LIN. FT. 210
BENT No. 4	No. 6	LIN. FT. 210

PROJECT NO. B-3682  
ONSLOW COUNTY  
 STATION: 27+84.47 -L-

SHEET 2 OF 3

STATE OF NORTH CAROLINA  
 DEPARTMENT OF TRANSPORTATION  
 RALEIGH  
 SUBSTRUCTURE  
 BENT No. 1, 2, 3, & 4

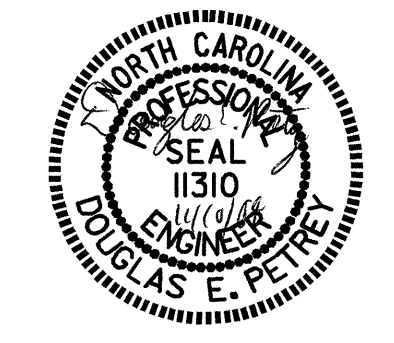

REVISIONS						SHEET NO.
NO.	BY:	DATE:	NO.	BY:	DATE:	S-19
1			3			TOTAL SHEETS
2			4			26

DRAWN BY: R. G. EMERSON DATE: 06/04  
 CHECKED BY: S. B. WILLIAMS DATE: 06/04