

PROJECT REFERENCE NO.	SHEET NO.
B-3682 & W-3413	EC-14/CONST.7
RW SHEET NO.	
ROADWAY DESIGN ENGINEER	HYDRAULICS ENGINEER

-L-

PI Sta 44+62.75
 $\Delta = 41^{\circ}03'44.6"$ (LT)
 $D = 7^{\circ}30'00.0"$
 $L = 547.50'$
 $T = 286.10'$
 $R = 763.94'$
 SE = SEE PLANS

-L-

PI Sta 51+04.53
 $\Delta = 34^{\circ}19'40.3"$ (RT)
 $D = 7^{\circ}30'00.0"$
 $L = 457.70'$
 $T = 235.95'$
 $R = 763.94'$
 SE = SEE PLANS

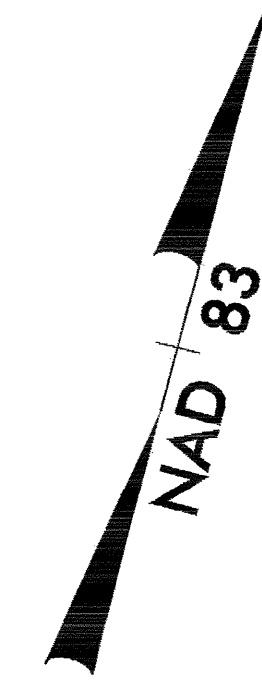

RESURFACE AND WIDEN
 FROM STA. 56+50 TO STA. 84+50
 (SEE TYPICAL SECTION #5)

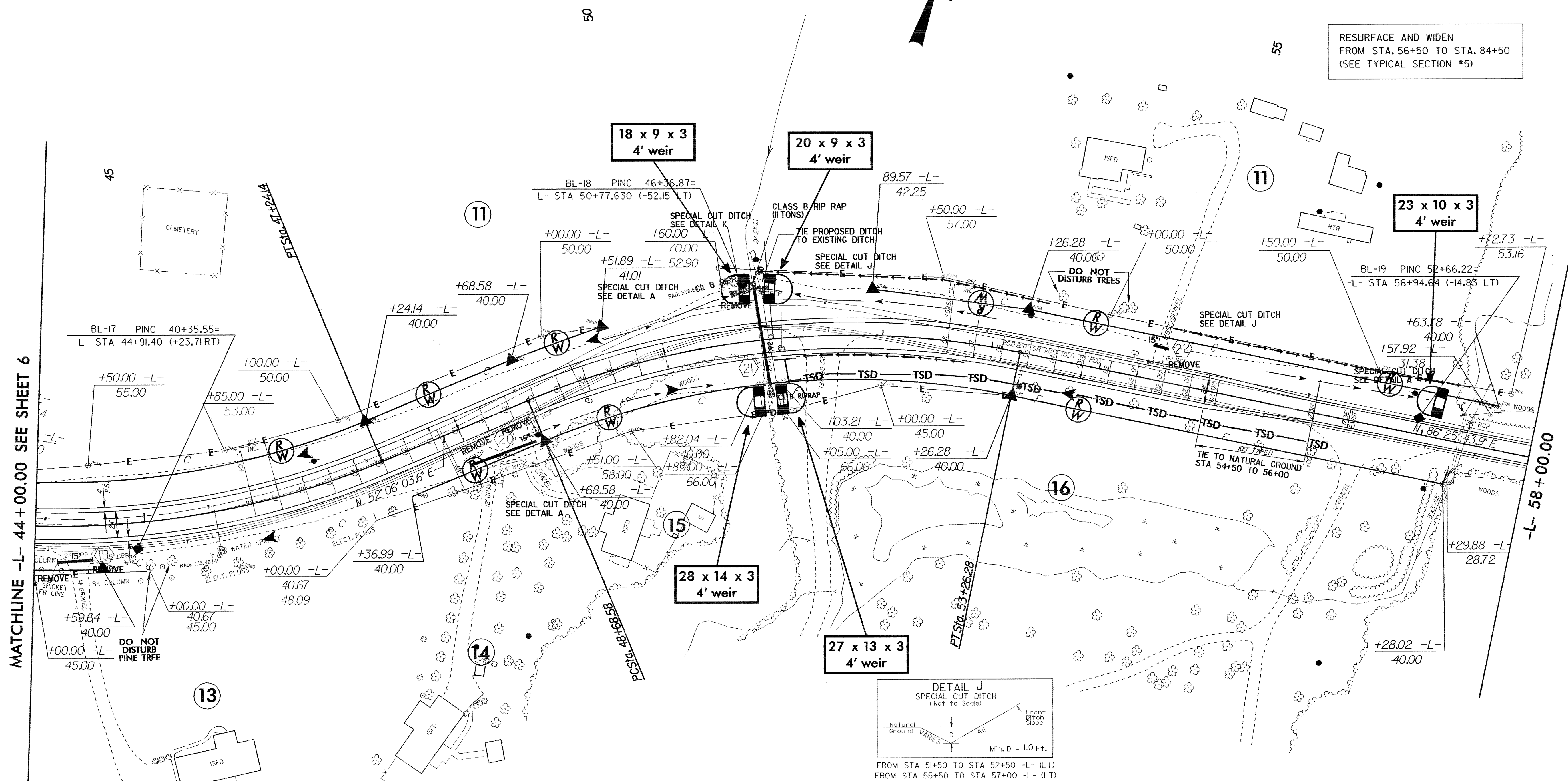

MATCHLINE -L- 44+00.00 SEE SHEET 6

-L- 58+00.00

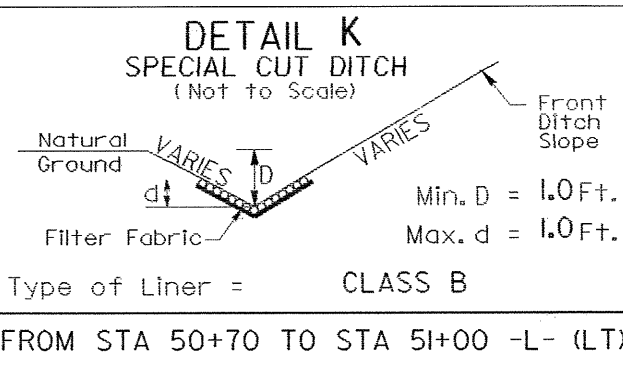
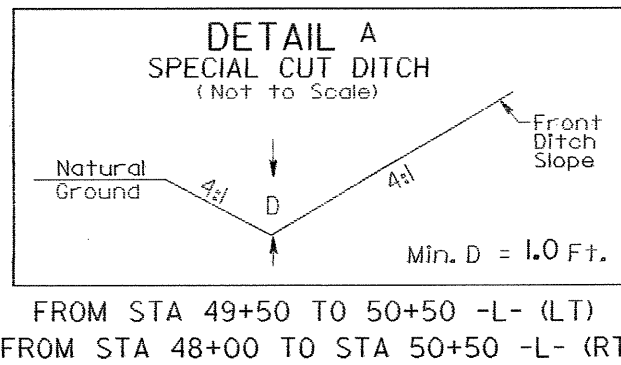
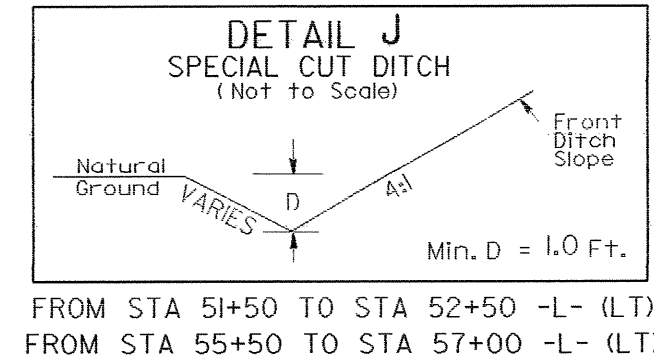

See sheet 13 for -L- Profile

8/17/99
 09-FEB-2005 16:02
 d:\v\j\p\3682\3682.dwg
 AL PERU221507