

SURVEY CONTROL SHEET B-3182

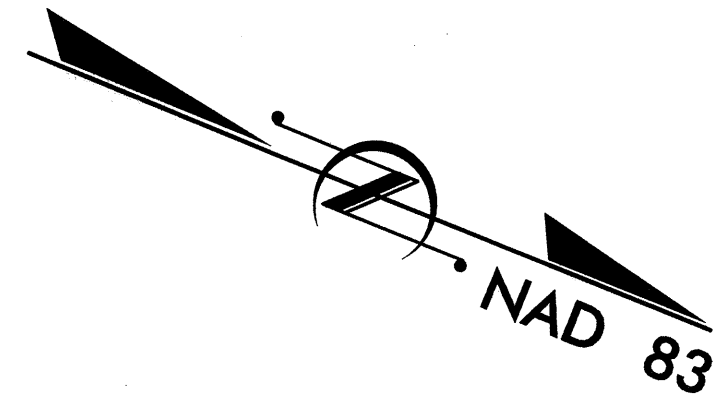

BENCHMARK DATA

```

.....
BM117 ELEVATION = 239.15
N 905680 E 2310739
L STATION 10+00
N 07°47'30.1" W DIST 135.69
RR SPIKE IN BASE OF 24' PINE
.....
BM116 ELEVATION = 212.45
N 906230 E 2310533
L STATION 14+54.92 25 LEFT
RR SPIKE IN BASE OF 20' TWIN PINE
.....
BM118 ELEVATION = 228.81
N 906783 E 2310308
L STATION 10+00
S 23°02'12.5" E DIST 1052.60
RR SPIKE IN BASE OF 12' PINE
.....

```

BL	POINT	DESC.	NORTH	EAST	ELEVATION	L STATION	OFFSET
2		GPS B3182-2	905746.6390	2310774.8120	237.07	OUTSIDE PROJECT LIMITS	
101		BL-101	906263.1430	2310564.2570	213.54	14+74.98	15.79 RT
3		GPS B3182-3	906999.9890	2310281.5750	236.43	OUTSIDE PROJECT LIMITS	

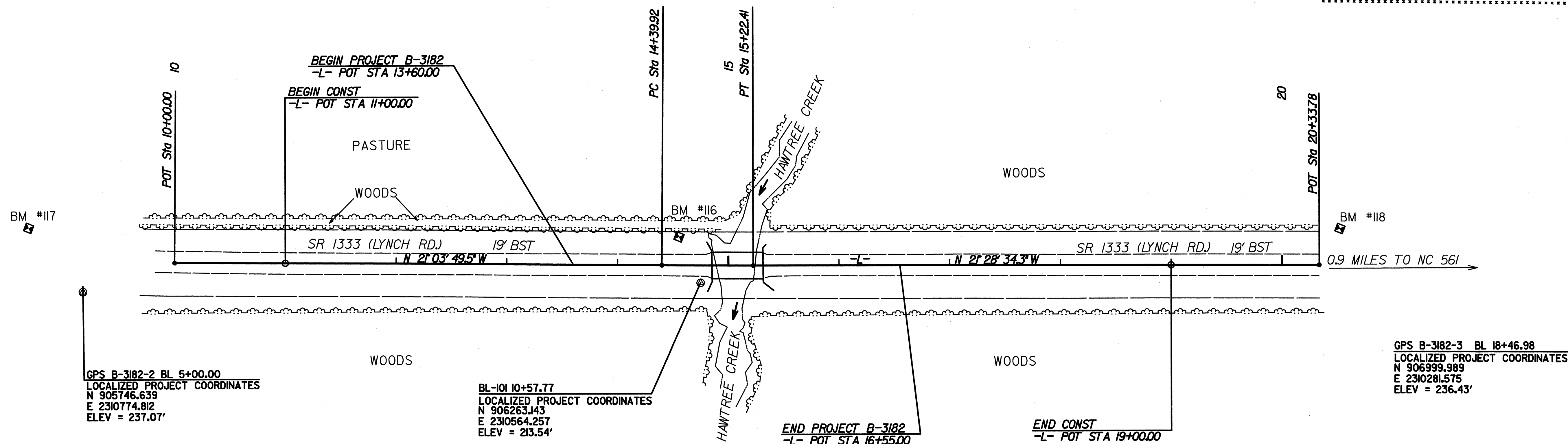

DATUM DESCRIPTION

THE LOCALIZED COORDINATE SYSTEM DEVELOPED FOR THIS PROJECT IS BASED ON THE STATE PLANE COORDINATES ESTABLISHED BY NCDOT FOR MONUMENT "B-3182-1"

WITH NAD 1983/95 STATE PLANE GRID COORDINATES OF
 NORTHING: 904664.103(ft) EASTING: 2310809.687(ft)

THE AVERAGE COMBINED GRID FACTOR USED ON THIS PROJECT (GROUND TO GRID) IS: 1.00001358

THE N.C. LAMBERT GRID BEARING AND LOCALIZED HORIZONTAL GROUND DISTANCE FROM "B-3182-1" TO -L- STATION 10+00.00 IS
 N 4° 26' 40.0" W 1,153.57(ft)

ALL LINEAR DIMENSIONS ARE LOCALIZED HORIZONTAL DISTANCES
 VERTICAL DATUM USED IS NAVD 88

NOTES:

- THE CONTROL DATA FOR THIS PROJECT CAN BE FOUND ELECTRONICALLY BY SELECTING PROJECT CONTROL DATA AT:
[HTTP://WWW.DOH.DOT.STATE.NC.US/PRECONSTRUCT/HIGHWAY/LOCATION/PROJECT](http://www.doh.dot.state.nc.us/preconstruct/highway/location/project)
 FILE : B3182_LS_CONTROL_040130.TXT.
- SITE CALIBRATION INFORMATION HAS NOT BEEN PROVIDED FOR THIS PROJECT. IF FURTHER INFORMATION IS NEEDED, PLEASE CONTACT THE LOCATION AND SURVEYS UNIT.
- ⊙ INDICATES GEODETIC CONTROL MONUMENTS USED OR SET FOR HORIZONTAL PROJECT CONTROL BY THE NCDOT LOCATION AND SURVEYS UNIT.
- PROJECT CONTROL ESTABLISHED USING GLOBAL POSITIONING SYSTEM.
- CONTROL NETWORK ESTABLISHED USING STATIC GPS FROM NCGS HARN MONUMENTATION.

NOTE: DRAWING NOT TO SCALE