

PHASING

- STEP 1: - USING ROADWAY STANDARD DRAWING, SHEET 1 OF 7, INSTALL THERMOPLASTIC PAVEMENT MARKINGS AND PERMANENT RAISED PAVEMENT MARKERS ON THE OFF-SITE DETOUR ROUTE (SR 1237 AND US 401) PRIOR TO CLOSING SR 1235 (DYKING ROAD)
- STEP 2: - USING ROADWAY STANDARD DRAWING NO. 1101.03, SHEET 1 OF 9, CLOSE SR 1235 DYKING RD. (-L-) AT STA. 10+00 +/- -L-, STA. STA. 11+20+/- -L-, STA. 17+90 +/- -L- AND STA. 20+50+/- -L-.
- NOTE: MAINTAIN TRAFFIC ACCESS TO DRIVEWAY LOCATED WITHIN THE PROJECT LIMITS UTILIZING DRUMS TO DELINEATE THE TRAVELWAY.
- STEP 3: - REMOVE THE EXISTING STRUCTURE AND CONSTRUCT THE PROPOSED STRUCTURE AND APPROACHES UP TO AND INCLUDING THE FINAL LAYER OF SURFACE COURSE (SEE THE CONSTRUCTION PLANS).
- PLACE THE FINAL PAVEMENT MARKINGS (THERMOPLASTIC) AND PAVEMENT MARKERS (PERMANENT RAISED) ON SR 1235 (DYKING RD.) (-L-).
- NOTE: MAINTAIN TRAFFIC ACCESS TO DRIVEWAY LOCATED WITHIN THE PROJECT LIMITS UTILIZING DRUMS TO DELINEATE THE TRAVELWAY.
- STEP 4: - REMOVE ALL TRAFFIC CONTROL DEVICES. REOPEN SR 1235 (DYKING RD.) (-L-) TO THE FINAL TRAFFIC PATTERN.

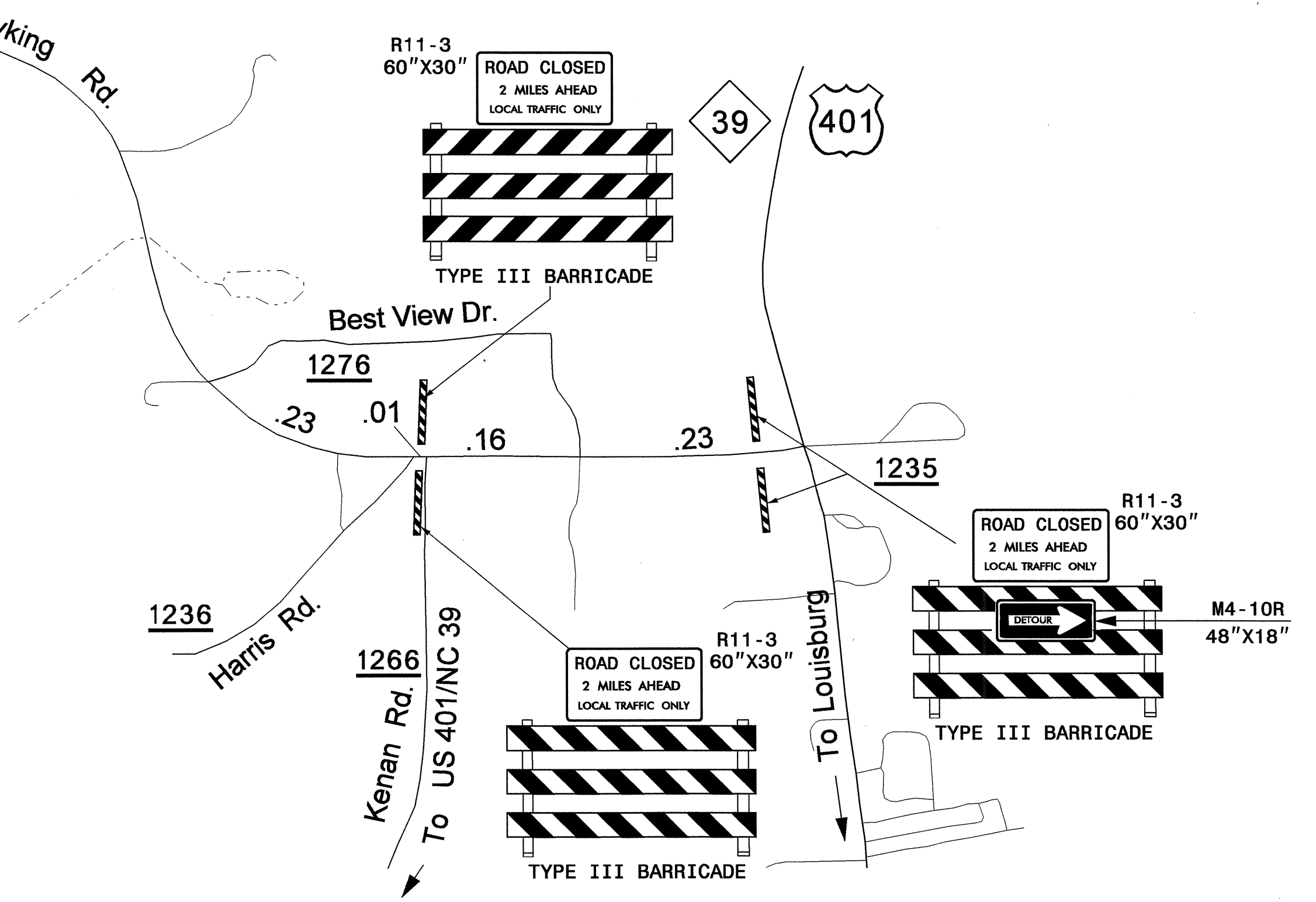
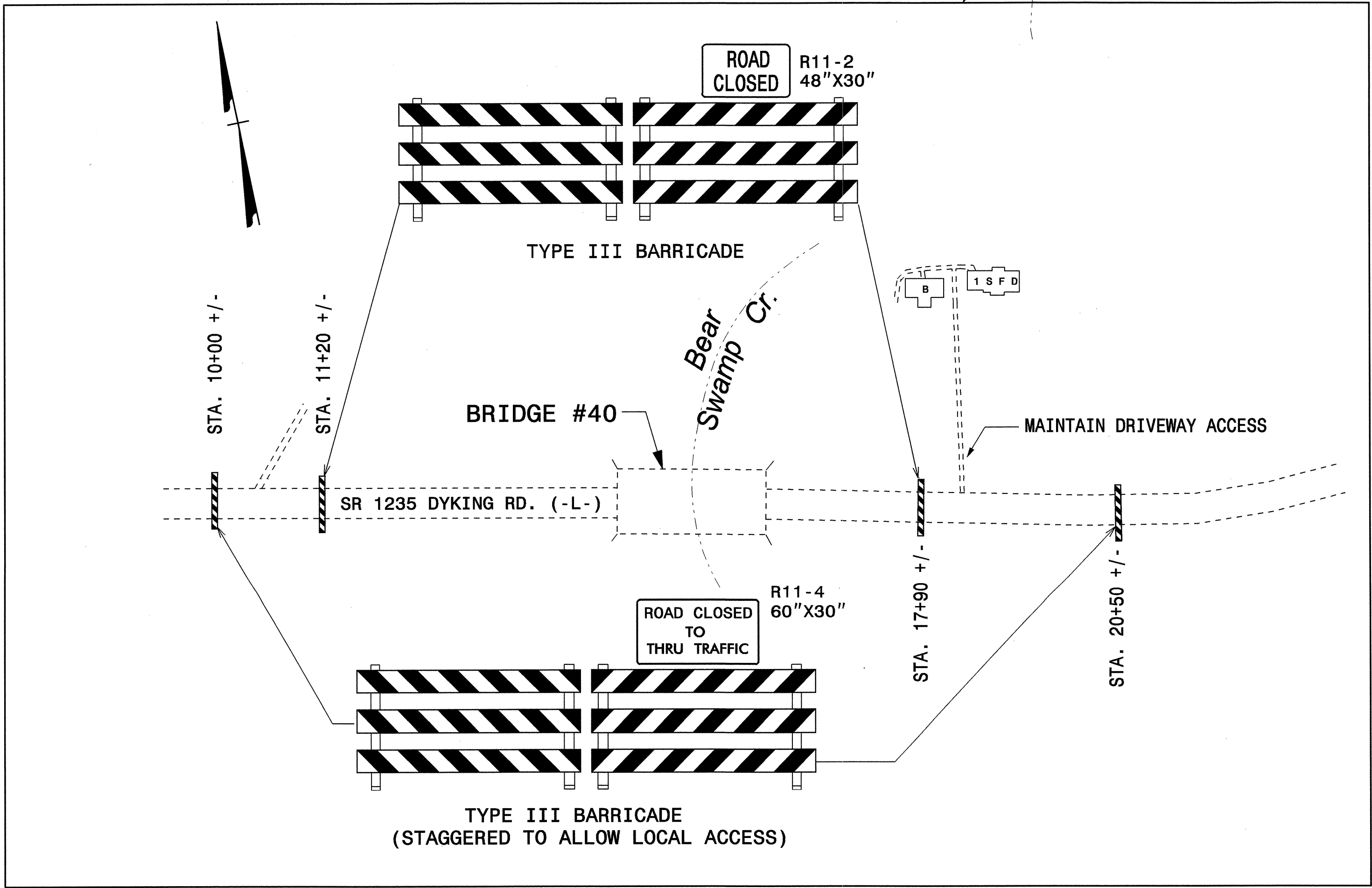
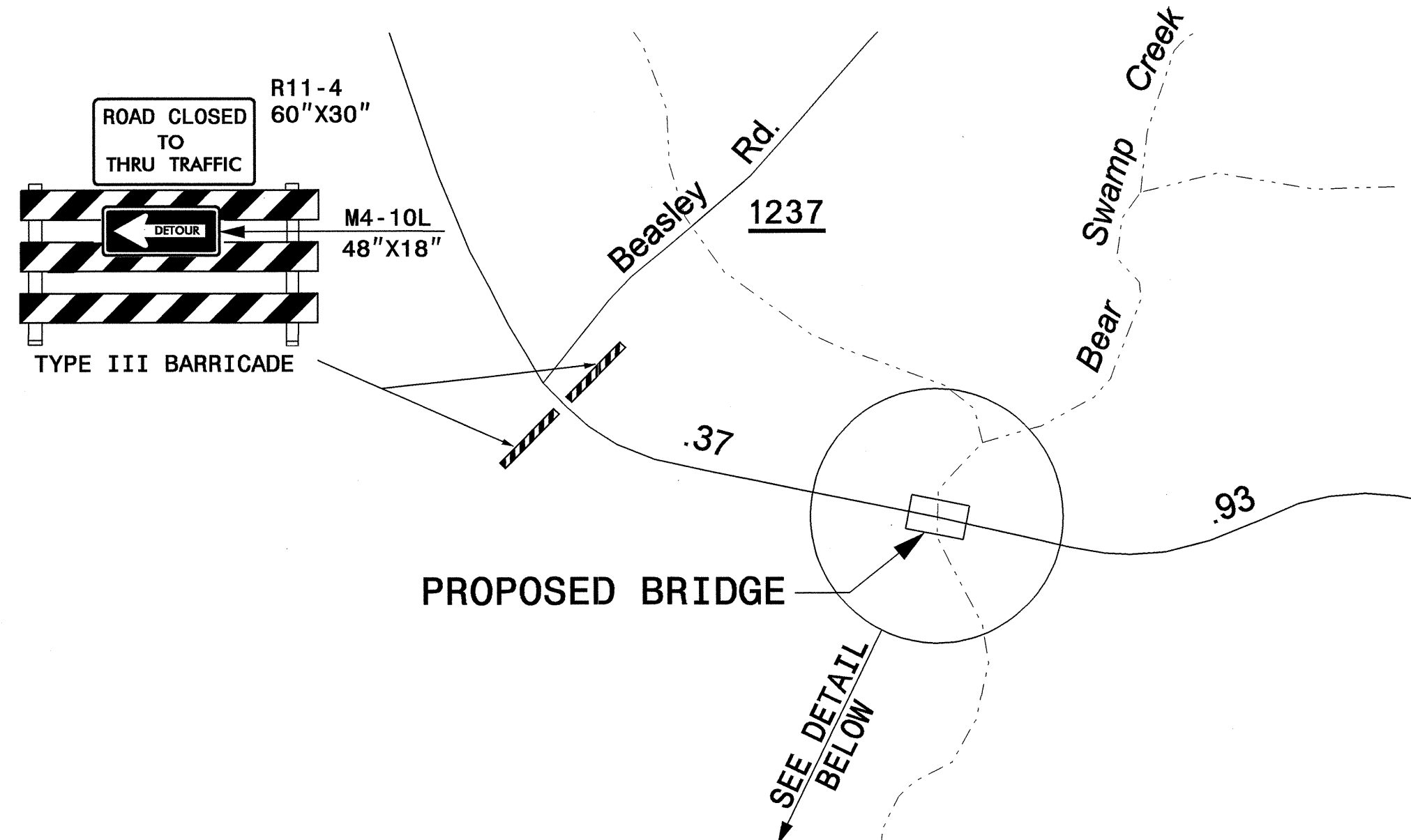
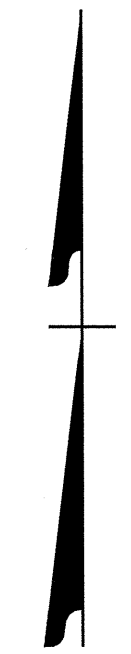

NOTE: SEE ROADWAY STANDARD DRAWING NO. 1101.03 SHEET 1 OF 9 FOR ADDITIONAL WORK ZONE SIGNS ON SR 1235 DYKING RD. (-L-).

APPROVED:	DATE: 12/16/02	PHASING AND DETAILS							
SCALE: NONE	DATE: 12/16/02								
DESIGN BY: KPB	REVIEWED BY: JWG								
DESIGN BY: KPB									
		<table border="1"> <tr> <th colspan="2">REVISIONS</th> </tr> <tr> <td> </td> <td> </td> </tr> <tr> <td> </td> <td> </td> </tr> </table>		REVISIONS					
REVISIONS									

21-SEP-2004 08:59
 H:\TCP\B-4515-TC-TCP2.dgn
 Tgermiller AT TET21233