

14+50

15+00

15+50

16+00

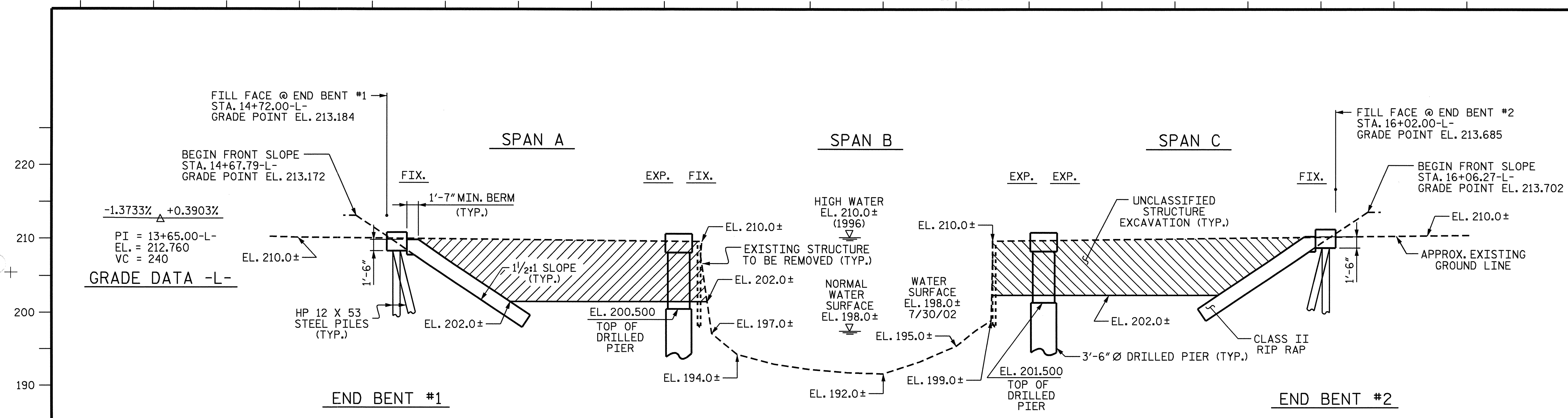

SECTION ALONG C -L-

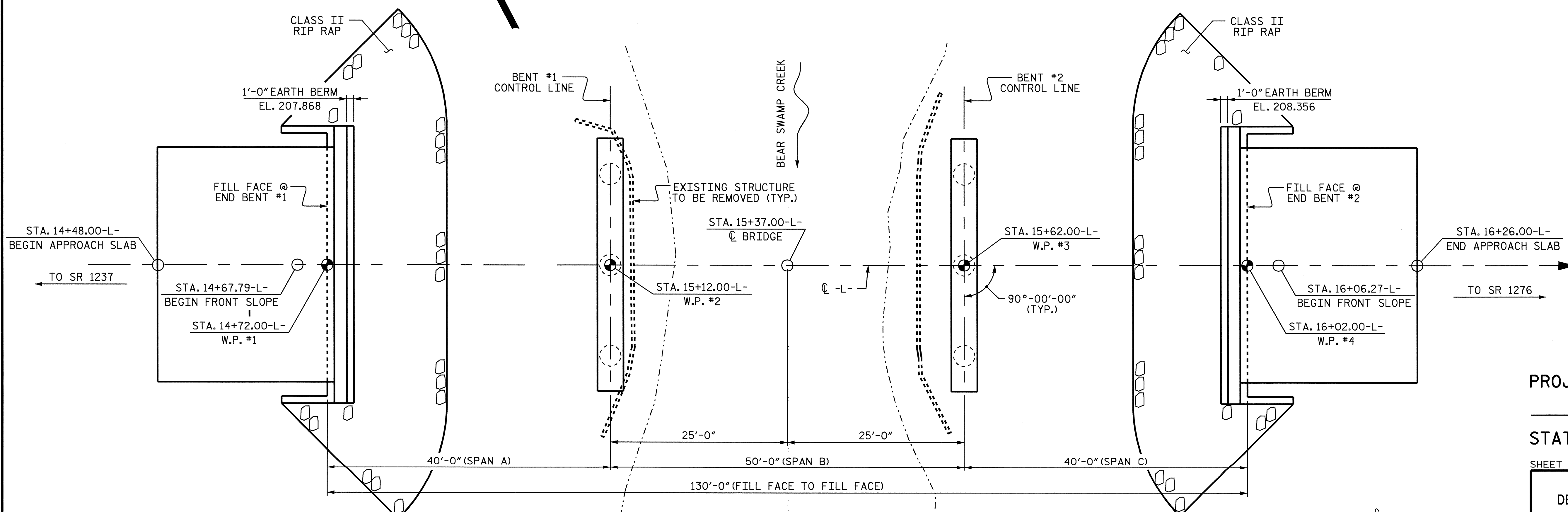

PROJECT NO. B-4515
FRANKLIN COUNTY
 STATION: 15+37.00-L-
 SHEET 1 OF 3 REPLACES BRIDGE #40

STATE OF NORTH CAROLINA
 DEPARTMENT OF TRANSPORTATION
 RALEIGH

GENERAL DRAWING
 FOR BRIDGE OVER
 BEAR SWAMP CREEK ON
 SR 1235 AND SR 1276

John M. ...
 2/11/05

NORTH CAROLINA
 PROFESSIONAL
 SEAL
 10730
 ENGINEER
 JOHN M. ...

DRAWN BY : B.N. GRADY / DAD DATE : 12/02
 CHECKED BY : H.T. BARBOUR DATE : 8/02

REVISIONS				SHEET NO.	
NO.	BY:	DATE:	NO.	BY:	DATE:
1			3		
2			4		

TOTAL SHEETS 24